



**TAYLOR'S  
RESIDENCE**

Respect • Care • Inclusion

# **TAYLOR'S RESIDENCE OFF-CAMPUS ACCOMMODATION**

**Discover The Best Student Living Experience**

# WELCOME

to our Off-Campus Accommodation

Dear Parents & Students,

Welcome to Taylor's Residence, and thank you for entrusting us to provide the best living experience.

At Taylor's Residence, we offer more than just a place to stay. Our residents' well-being and safety are our top priorities, and we are dedicated to ensuring everyone receives the support needed throughout their educational journey. We believe that a supportive and nurturing environment is key to success.

To achieve this, our curated living program facilitates a smooth integration into the new living and learning environment. Residents are provided with essential tools and skills to adapt successfully. Additionally, our program offers opportunities to participate in community outreach, fostering a sense of belonging and purpose.

By engaging in these activities, residents develop lifelong learning and leadership skills, ensuring both personal and academic growth. We strive to create an enriching experience, helping our residents thrive in all aspects of life.

I look forward to welcoming you here at Taylor's Residence soon.

Warmest regards,



Yap Elaine  
Senior Vice President

## OUR ACHIEVEMENTS & RECOGNITIONS



Accommodation



Facilities & Services



Student Welfare Support



# BENEFITS FOR TAYLOR'S RESIDENTS

At Taylor's Residence, we put the student residents' experience first, while off-campus students may not be physically staying on-campus, we ensure off-campus students enjoy the support and benefits as and when they need it:

Enjoy same on-campus residents' benefits.



## On-Campus Residents Facilities

UniGym,  
24/7 Reception &  
Study Lounge

Taylor's program supports student wellbeing with on-campus training, workshops, and activities.



## Academic Support Services

Intellectual enrichment  
workshops



## Life Skills

Life skills training  
& workshops



## Student Welfare Support

Counselling  
Support

# R!SE RESIDENTIAL LIVING PROGRAM

This curated, structured program fosters a Relevant, Inclusive, Supportive, and Engaged (R!SE) community, building belonging, developing compassionate leaders, encouraging growth, and empowering residents to succeed personally and academically. It helps students adapt to changes in their new living and learning environment through four key psychosocial pillars:



## PHYSICAL WELLBEING

Positive physical well-being helps residents adapt and excel in new settings. We are dedicated to creating a welcoming environment that feels like home.

*\*While off-campus residents may not receive the same direct on-site physical wellbeing support as on-campus residents, they are encouraged to take necessary precautions for their personal safety. Our Wellbeing Ambassadors remain reachable should any support be needed.*



## EMOTIONAL WELLBEING

Positive mental & emotional health is vital for academic and personal growth. We focus on providing preventive care and a supportive system to help residents manage stress and build emotional resilience.

- Preventive Care - Initiatives to promote mental health awareness & resilience
- P.E.E.R.S Support System - A strong support system drives a strong sense of belonging and balanced mental health.



## SOCIAL WELLBEING

Positive social wellness involves building healthy relationships and fostering genuine connections with peers who can provide support during times of need.

- Social Connection
- Sense of Belongings
- Sociocultural Appreciation



## INTELLECTUAL WELLBEING

We support residents in expanding their knowledge, developing critical thinking, strengthening essential study skills, and encouraging learning beyond the classroom for academic and future success.

- Learning Skills
- Life Skills
- Leadership Skills
- Literacy Skills

# WATERFRONT RESIDENCE



 3.3km

 12 mins

 20 mins

 30 mins

Taylor's Residence offers top-quality student accommodation and has partnered with Sunway House to expand housing options. Located 3.3 km from Taylor's University Lakeside Campus, Waterfront Residence is an off-campus extension providing a shuttle bus service. It offers a safe, comfortable living environment with communal spaces for study and relaxation.

## Shuttle Bus Schedule

- Shuttle bus services are NOT AVAILABLE on Public Holidays & Replacement Public Holidays.
- Bus Fare - RM 1.50 per trip (Cashless payment by Touch 'n Go card only min credit RM5.00)
- You may purchase the Touch 'n Go card from the driver at RM30 (with RM10 credit) if you don't have it.
- Touch 'n Go reload service is not provided by the shuttle bus operator.
- Students are advised to be at the bus stop at least 10 minutes before the departure time.



Scan Here To View  
Detailed Schedule

# FACILITIES & AMENITIES

- Gym\*
- Swimming Pool\*
- Communal Kitchen & Dining Area
- Self-service Launderette



Swimming Pool\*



Gym\*

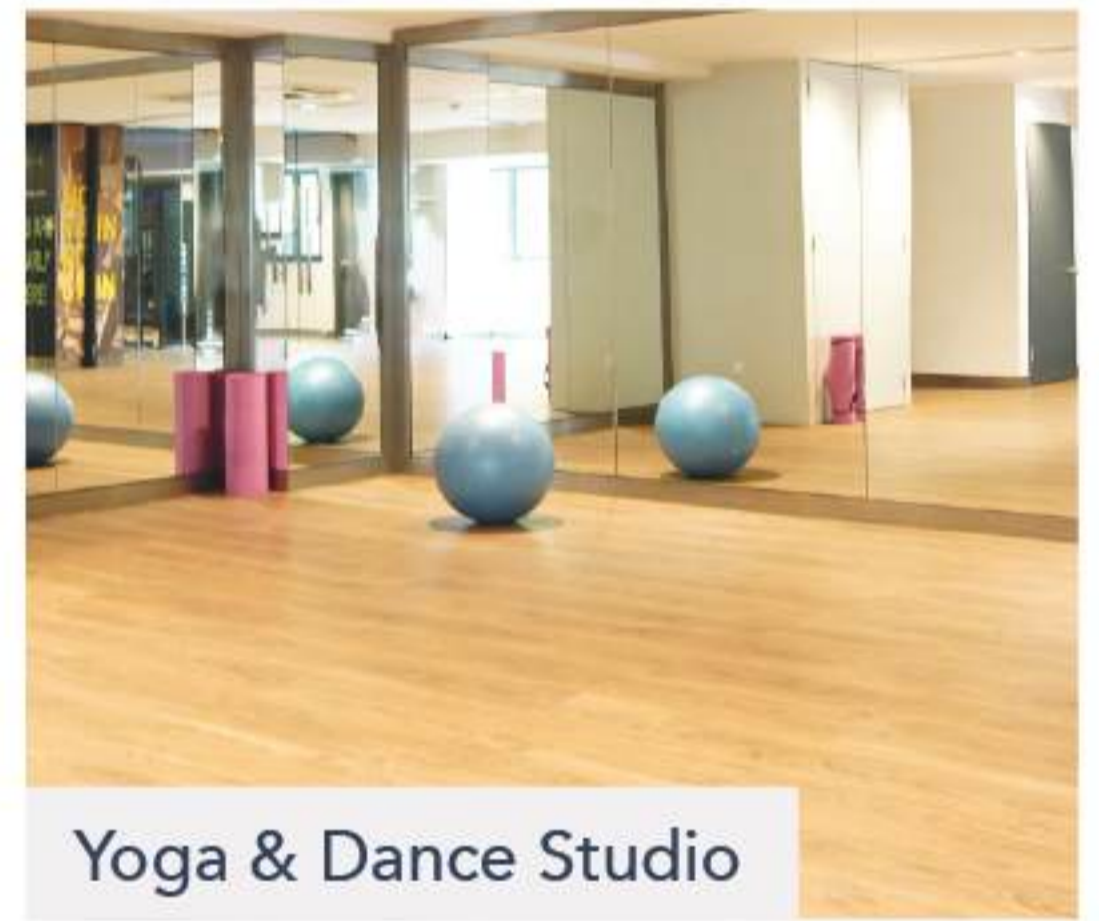

Yoga & Dance Studio



Communal Kitchen & Dining

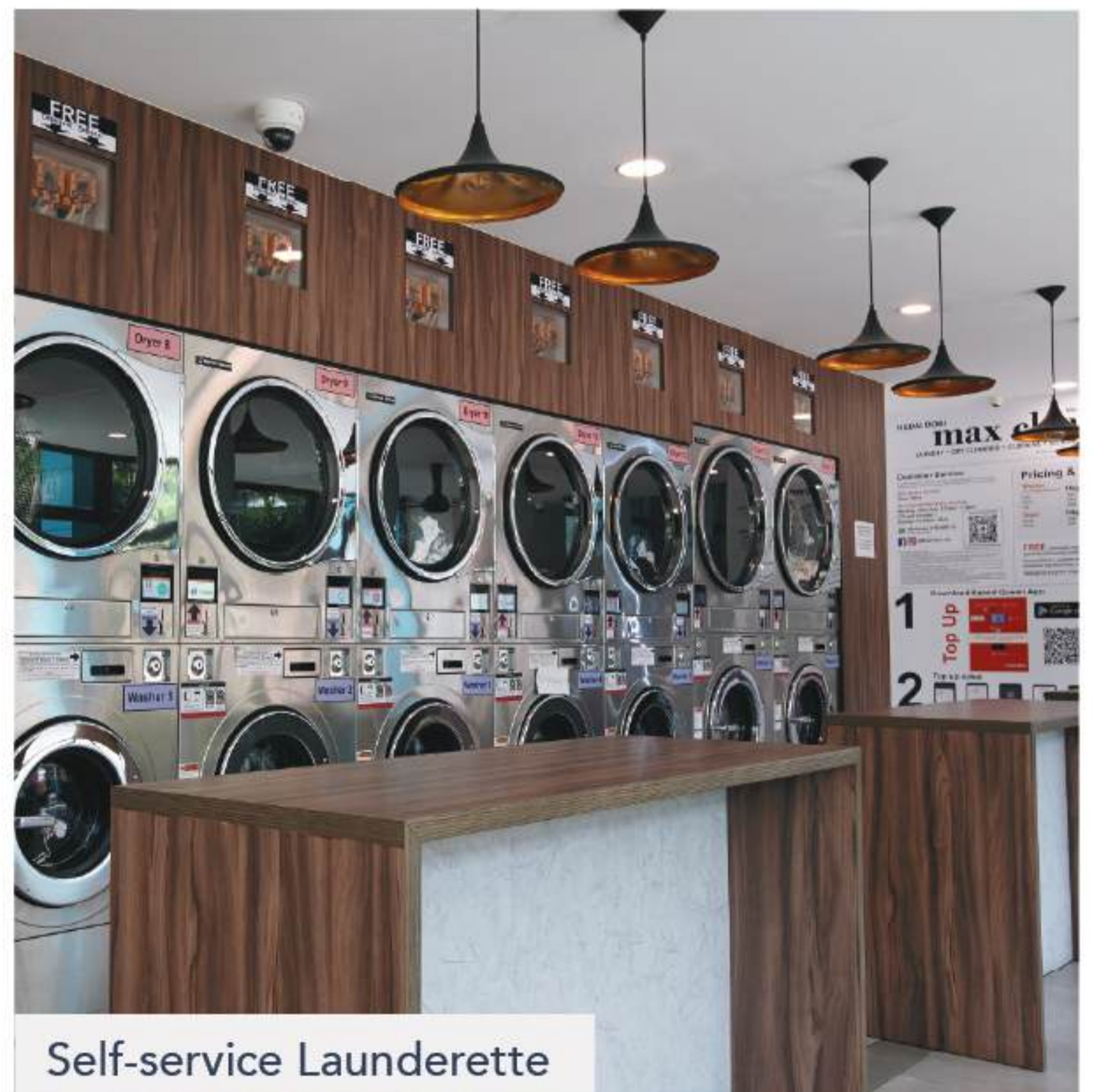

Self-service Launderette

\*Off-campus residents are welcome to use the on-campus UniGym and Swimming Pool by presenting their residence card.

# SOCIAL & LEARNING SPACES

- Learning Hub/Pods
- Student Lounge
- Movie Room
- Atrium



Learning Hub/Pods



Student Lounge



Movie Room



Atrium

# SECURITY & SERVICES

- 24-hr Security
- Convenience Store
- Shuttle Bus
- Cafeteria & F&B Outlets



24-hr Security



Convenience Store



Shuttle Bus



Cafeteria & F&B Outlets

# BLOCK D - APARTMENT



**Ideal for residents seeking interaction, offering a balanced mix of personal space and communal living.**

## **FACILITIES WITHIN UNITS**

- Microwave
- Water dispenser
- Pantry with personal storage space
- Cooker hob & hood (available in Cooking Units only)
- Dining table and chairs
- Sofa set
- Shoe rack
- Shared bathroom

# ROOM RATES

## SEMI-PRIVATE STANDARD UNITS

- Single Room (single bed)
- Twin Sharing Room (single bed)
- Fully furnished with Fridge
- Rental inclusive of WiFi
- Room size: 100 - 130 sqft
- Bed size: 3 x 6.3 ft
- Cooking & Non-cooking units



Couch



Fan



Dining Table



Microwave



Hob & Hood  
(Cooking Units Only)



Water  
Dispenser



Shared Pantry  
Storage



Shared Shoes  
Storage



Shared  
Bathroom

Apartment Type	Room Type	Room Size (sqft)	Bed Size ft x ft	Monthly Rental (RM)	Deposit (RM)	6 Months Advance Rental (RM)	Stamp Duty (RM)	Total First Payment (RM & USD)
 Cooking Unit	Single	100	3 x 6.3	1,750	3,000	10,500	94	RM 14,094 USD 3,520
	Twin Sharing	130	3 x 6.3	1,250	3,000	7,500	70	RM 11,070 USD 2,770

### Terms & Conditions:

1. Rates are PER-PAX basis.
2. Complimentary bedding sets will be provided (pillow, pillowcase, duvet, duvet cover, bed sheet and mattress protector). Residents are required to bring their own towels, toilet linens, toiletries, cooking utensils and cutlery. OR you may purchase Move-in Kits (scan the QR at the back of the brochure for more info).
3. Applicants may submit the application form and await official written notification from Taylor's Hostel Management regarding room availability, as submission does not guarantee confirmation of the desired room type at the selected location. Upon receiving a room offer, applicants must decide whether to accept; if they accept, they are required to pay a RM500 non-refundable application fee and a RM3,000 deposit to secure the room. Once payment is made, the RM500 application fee is non-refundable in the event of cancellation.
4. Applicants must pay six (6) months advance rental prior to check-in. Thereafter, rental must be paid every six (6) months in advance.
5. All applicants are required to sign an initial tenancy agreement for one year (12 months).
6. In accordance with the Malaysian Stamp Act 1949, the stamp duty for the tenancy agreement shall be borne by the tenant and will be collected together with the rental payment.
7. All residents are expected to help maintain the general cleanliness of their respective apartments and all common areas.

# SINGLE ROOM

---



# TWIN SHARING

---



# SINGLE ROOM monthly rental from **RM1,750** per pax\*

-   
 Single-sized  
Bed
-   
 Air-  
Conditioner
-   
 Fan
-   
 Wardrobe  
with mirror
-   
 Shared  
Refrigerator
-   
 Work Station
-   
 Window

Apartment Type	Room Size (sqft)	Bed Size ft x ft	Monthly Rental (RM)	Deposit (RM)
 Cooking Unit	100	3 x 6.3	1,750	3,000

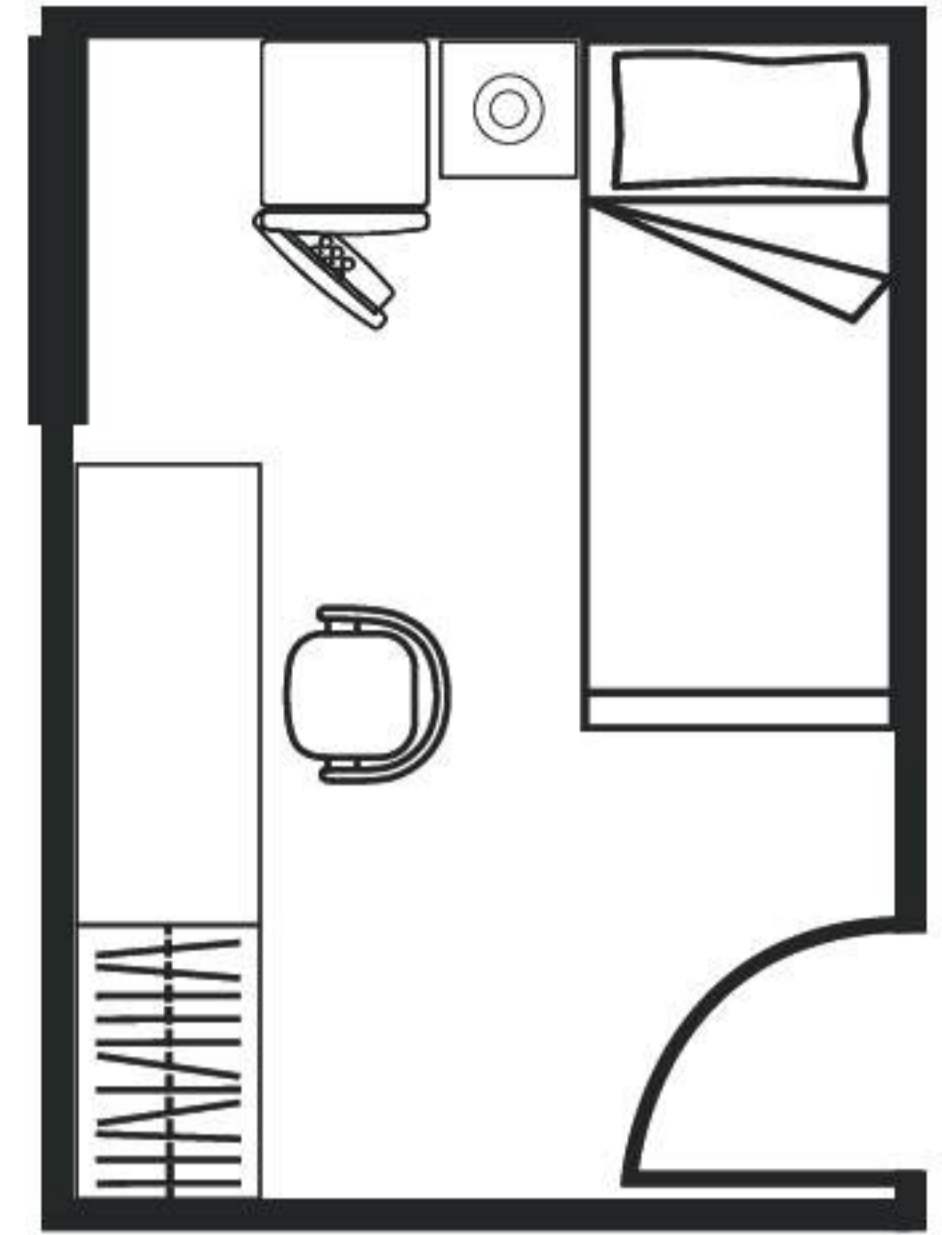

# TWIN SHARING monthly rental from **RM1,250** per pax\*

-   
 Single-sized  
Bed
-   
 Air-  
Conditioner
-   
 Fan
-   
 Wardrobe  
with mirror
-   
 Shared  
Refrigerator
-   
 Work Station
-   
 Window

Apartment Type	Room Size (sqft)	Bed Size ft x ft	Monthly Rental (RM)	Deposit (RM)
 Cooking Unit	130	3 x 6.3	1,250	3,000

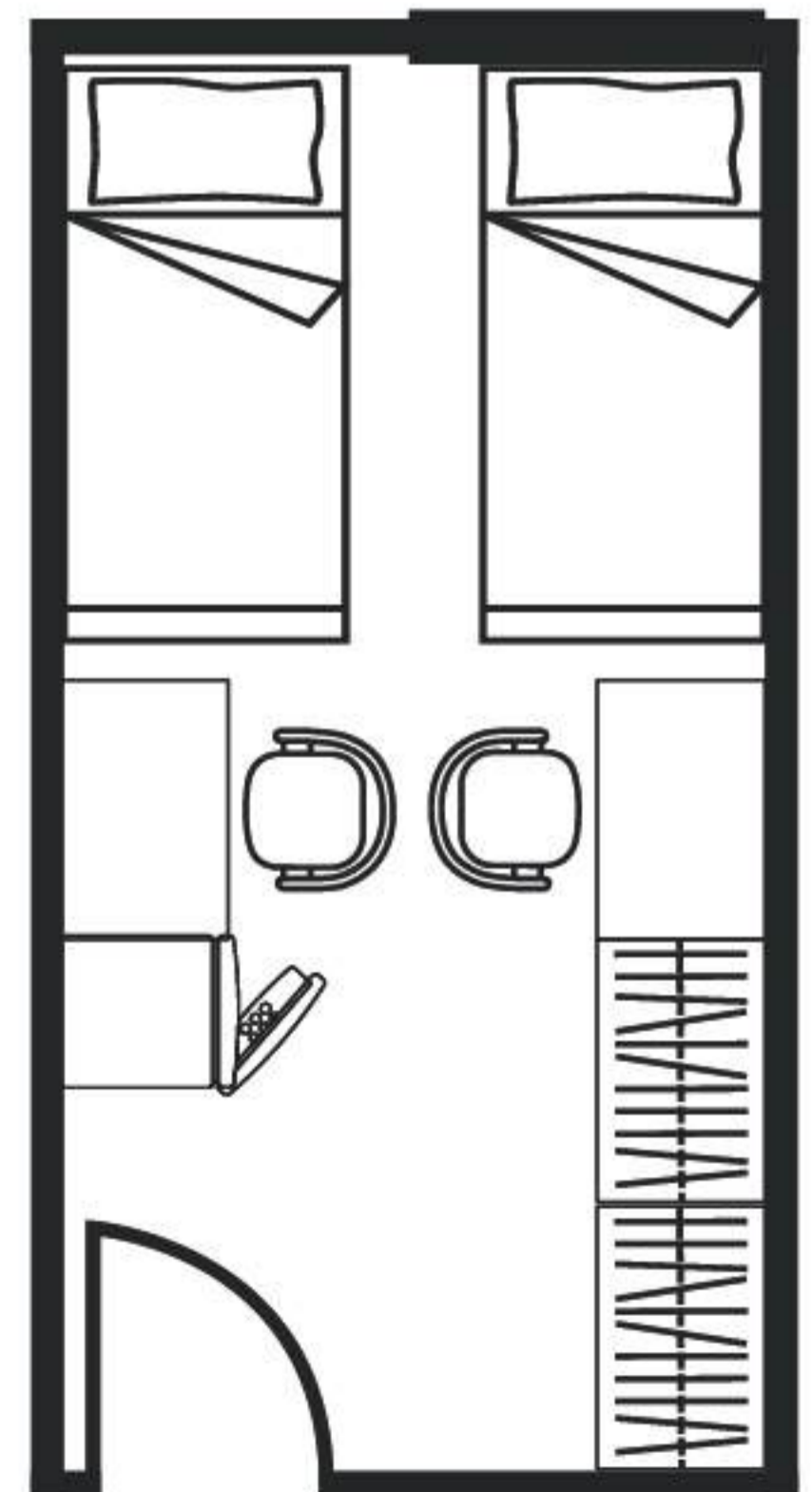

\*Residents of both single and twin sharing room types share an apartment with washroom, bathroom and pantry (including microwave, fridge & individual storage spaces).

Cooking is ONLY ALLOWED in COOKING UNITS. Communal Kitchen is available for all residents.



Taylor's Hostel Management Sdn Bhd 199301012302 (267040-A)  
Level 1, The Boardwalk, No.2, Jalan Taylor's,  
47500 Subang Jaya, Selangor, Malaysia.

☎ +603 5631 3400

🌐 [taylorshostel.taylors.edu.my](http://taylorshostel.taylors.edu.my)

✉ [taylorshostel@taylors.edu.my](mailto:taylorshostel@taylors.edu.my)

📘 [facebook.com/taylorsresidence](https://facebook.com/taylorsresidence)

📷 @taylors.residence

LEARN MORE

