

A man with a beard and glasses, wearing a dark blue t-shirt, is shown from the side, reaching up to install a white cylindrical audio speaker onto a track system on a ceiling. The ceiling has a curved, ribbed design. Another similar speaker is already installed further along the track. The background is slightly blurred, showing more of the ceiling and some green foliage in the bottom left corner.

SPOTTUNE

OMNIDIRECTIONAL AUDIO SYSTEM

Installation manual

Introduction to the Spottune Installation Manual

Welcome to the Spottune Installation Manual!

This guide is designed to help you get the most out of your new Spottune audio system, from understanding its components to installing and setting it up with ease. Whether you're experienced in audio equipment or this is your first time working with such technology, don't worry—this manual will walk you through every step of the process.

Spottune products are all about providing high-quality sound in a simple, hassle-free way. We've created this guide to be your companion throughout the installation. You'll learn how to set up the Spottune Stream transmitter and Spottune Omni speakers, how to connect everything smoothly, and how to make sure the system works perfectly in your space. We'll also cover some helpful tips and tricks for getting the best sound quality and optimizing the placement of your speakers.

Think of this manual as your partner—here to answer your questions, guide you step-by-step, and ensure that you can complete the setup without a hitch. By the end of this guide, you'll not only have a fully functioning Spottune audio system but also a clear understanding of how it works and how to get the best results for your environment.

Let's get started on bringing great sound to your space!

Table of content

2. Introduction to the Spottune Installation Manual
4. Spottune Stream transmitter - Get to know your system
5. Spottune Omni speaker - Get to know your system
6. Installation of speakers - Placement, signal tweaking and powering options
7. Stream transmitter installation - Placement, antennas angles and network connection
8. Paring of speakers - initial paring and addition of new speakers
9. Playing music - Choose and control music source, change zones and make announcements
10. Troubleshooting - LED status indicator explanation, issues and solutions
11. Complex Installations - Multiple Stream Setup
12. Pendant Kit Installation
13. Recessed Kit Installation
14. Advanced functions - Enable bluetooth and Spotify Connect.
15. Advanced functions - Changing the EQ settings of your audio zones
16. Advanced functions - Change speaker zone, set volume offset and check signal strength
17. Advanced functions - Read and set speaker settings
18. Advanced functions - Check firmware version, IP-address and CC-number on a Spottune Stream
19. Advanced functions - Reset Spottune Stream and Spottune Omni

Spottune Stream transmitter

Get to know your system

- | | | | |
|----|--|-----|-------------------------------|
| 1. | Power ON/OFF button | 9. | USB port |
| 2. | Power ON/OFF indicator light | 10. | Antenna 1 |
| 3. | Zone button | 11. | Ethernet port |
| 4. | Music source button | 12. | AUX IN |
| 5. | Display | 13. | MIC IN (AUX IN with priority) |
| 6. | Music navigation. Volume up/down, Previous/Forward, Play/pause | 14. | Antenna 2 |
| 7. | Microphone activation button | 15. | Power source inlet |
| 8. | Microphone | | |

FRONT

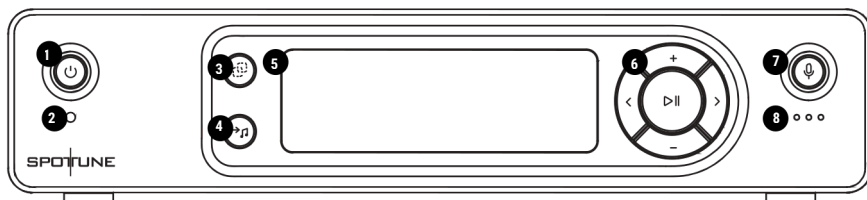

BACK

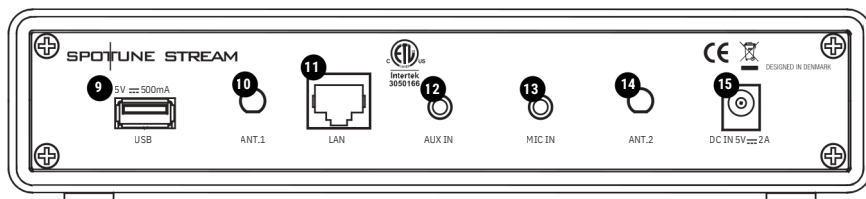

Spottune Omni speaker

Get to know your system

- | | | | |
|----|--|----|----------------------|
| 1. | USB port (service port, not for audio input) | 5. | Track adapter |
| 2. | Locking tap for track adapter | 6. | Phase wheel |
| 3. | Zone button | 7. | LED status indicator |
| 4. | Pair button | | |

The Spottune Omni speaker comes in two variants - **Track** and **Cord**, you can also get the **recessed kit** for in-celling installations. All speaker Spottune versions are essentially the same speaker with different top mounts. All instructions regarding signal tweaking, pairing, changing of zones, resetting the speaker etc. are thus universal.

TOP

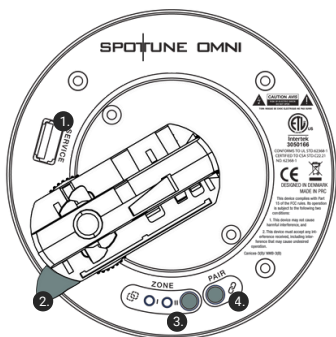

SIDE

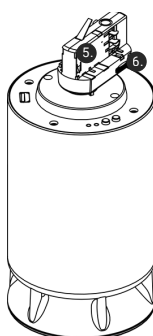

BOTTOM

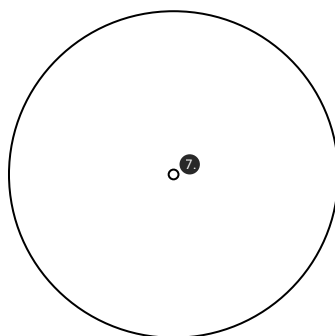

Installation of speakers

Placement

The Spottune Omni speaker is omnidirectional which means it disperses sound in 360-degrees around the speaker. The best audio coverage is achieved by placing the speakers evenly spaced out in the venue. **Tip:** The Spottune Sales Tool can help you create a map with coverage info along with recommendations for amount of speakers.

Installation

Before you start, please note that there is a raised edge on the track adapter, this should be opposite of the raised edge on the lighting track. **Tip:** If in doubt, check existing lighting fixtures in the track to see orientation.

To install the Omni Track speaker, simply put the track adapter (on the of the Omni speaker) into the lighting track (1.). Once in place, twist the "locking tab" to the other side to secure to the speaker to the lighting track (2.) **Tip:** You can choose which power phase should power the speaker by turning the phase wheel on the side of the track adapter (3.)

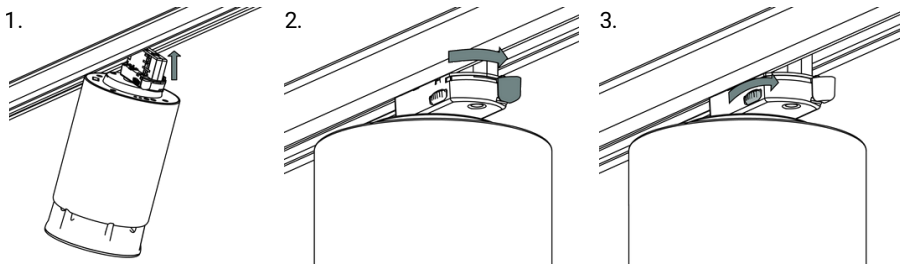

Signal tweaking

Once you're done installing the speaker in the track, make sure that the antenna side of the speaker is pointing toward the placement of the Spottune Stream. This will ensure best signal reception.

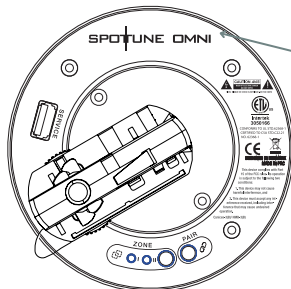

*Antenna side of the speaker
is the side beneath the
Spottune logo*

Stream transmitter installation

Placement

Avoid placing the Stream near or surrounded by metal materials that may obstruct the signal. To optimize the performance of the Spottune Stream transmitter, position it centrally within the area where the speakers will be located. The Spottune Stream transmits sound uniformly in all directions with a range of up to 50m (100m diameter). **Tip:** The Spottune Sales Tool can help you determine the best placement.

Installation

1. Place the Spottune Stream transmitter in a high, open, and unrestricted location.
2. Ensure the antennas are securely fastened, pointing upwards, and angled slightly towards the corners of the Stream. **Tip:** if your Stream is placed in a place where antennas might get hit, pushed, or in other ways risk having its antennas bend out of angle, you can purchase and add our antenna clips.
3. Connect the Spottune Stream to power.
4. **Optional step:** Connect the Stream to internet. Internet is needed if you wish to use Spottune Cloud to manage the Stream remotely or stream music from an online source.

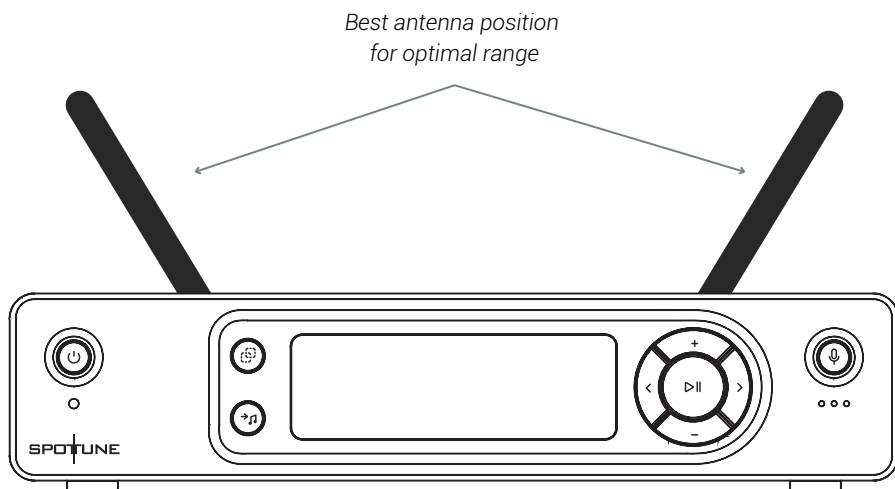



Pairing of speakers

Initial pairing

1. Start by powering the Spottune speakers, then power on the Spottune Stream transmitter. Both the Spottune Stream transmitter and the Spottune Omni speakers automatically starts in “pairing mode” when powering up for the first time. This is indicated by a flashing green status LED on the speaker and the text “LOOKING FOR SPEAKERS” on Stream.
2. The Stream will remain in “pairing mode” for three minutes. This is usually enough for the Stream to find and connect all speakers in a venue.
3. A successful connection is confirmed by a short audio signal (“beep”) from each speaker



Adding Spottune Omni speaker(s)

1. Place and power up the Spottune Omni speaker you wish to connect.
2. Your new Spottune Omni speaker will automatically be in “PAIRING MODE” when powering up for the first time, and “Status LED” will flash green. You can always manually activate “PAIRING MODE” on a Spottune Omni speaker by pressing  on top of the speaker for one second.
3. Enter “PAIRING MODE” on the Spottune Stream transmitter by pressing and holding  for five seconds.
4. The Spottune Omni speaker will provide audio feedback (beep) and change the “Status LED” color to solid green when paired.
5. When paired, the Spottune Stream will automatically exit “PAIRING MODE” after three minutes. **Do not** force-exit “PAIRING MODE” as this could potentially cause trouble if pairing is not complete.

Playing music

Choosing your audio source and controlling music

Spottune Stream supports the following inputs: **AUX (mini jack), MIC IN (mini jack), USB, Network, Bluetooth and Spotify Connect.**



Bluetooth and Spotify Connect are disabled from factory, but can be enabled in "WORKING MODE" of the Stream, you can find a guide under "Advanced functions" in this manual.

1. Select the source by pressing  till you reach the desired input.
2. Use Play/Pause, Previous/Forward and Plus/Minus buttons to control the music. Play/Pause will start or stop the music. Previous/Forward lets you change track and lastly Plus/Minus will adjust the volume up and down.



Changing music zones



The Spottune Stream has two different music zones. All Omni speakers are per default set to be part of "Zone 1" from factory. You can play the same music source in both zones or have different inputs in each zone. This is how you set up zones.

1. Set the zone of the Omni speaker by pressing  on the top of the speaker. The LED will show which zone the speaker is in.
2. After matching speakers to the desired zones. Select the zone you want to control by pressing  on the Stream. Choose between "ZONE 1", "ZONE 2" or "ZONE 1+2"

If you combine ZONE 1+2, the music input and volume of zone 1 will be broadcasted in both zones.

Adjusting volume

You can set the individual volume of ZONE 1 and ZONE 2. **BUT**, If your have ZONE 1+2 activated, the Stream will use input and volume settings from ZONE 1.

1. Select the zone you want to adjust pressing  on the Stream.
2. Make sure the correct input is set for this zone using 
3. Adjust volume of the zone using 

Announcements

1. Announcements can be made via the built-in microphone. You can also connect your existing PA system to the Spottune Stream transmitter via "MIC IN" input*.
*Prioritized 3,5mm minijack unbalanced stereo line input
2. Please note that Microphone announcements via the built-in microphone or "MIC IN" input will get priority and mute regular music playback. Music will resume once announcement is over.
3. Press and hold the  while speaking towards the microphone beneath the button.

Trouble shooting

If you encounter trouble, then have a look at this table to determine what might cause it.

Observed problem	Possible reason	Solution
No light on Omni speaker	No power/Phase wheel issue	Check power and phase wheel on track adapter.
	Overpowering (less likely)	Inspect for overpowering issues.
Red flash on Omni speaker	No connection to Stream	Ensure Stream is on; re-pair if necessary.
	Pairing is incorrect	Re-pair the devices.
Red solid on Omni speaker	Standby mode	Check if Stream is on and playing.
Green flash on Omni speaker	Pairing mode active	Ensure Stream is on; activate pairing on Stream.
	Pairing distance issue	Place Omni speaker closer to the Stream while pairing, make sure antenna side of the Omni speaker is facing the the direction of the Stream
Green solid on Omni speaker but no music	Wrong zone, bad audio input or volume turned down	Check Stream input, zones, and volume settings.
Omni speaker makes clicking/scratching noises	Bad/no connection between audio source and Stream	Inspect the audio source and cable.
The music played sounds like a it's coming from a robot or underwater	Speaker is receiving a weak signal from the transmitter	Make sure the antenna side of the speaker is facing the direction of the Spottune Stream and that Stream's antennas are pointed up and tilted slightly outwards.
White solid on Omni speaker	Booting up or booting error	Power off/on the Omni speaker. If unresolved, perform a reset.
LED switching between white and no light	Power issue	Ensure Omni speaker is powered properly.
Yellow flash on Omni speaker	The product is resetting	Wait for the reset to complete (less than 30 sec).
Omni speaker is stuck in yellow flash	Product was interrupted during a reset	Power off/on the Omni speaker; if unresolved, perform a reset.
No light on Stream	No power; display is dead	Check for power/PSU issues; inspect for drop damage.
Light on but no display on Stream	Defective display	Inspect for drop damage; if none, start an RMA case.

Complex Installations

Multiple Stream Setup

In large venues where more than two zones are needed or one Stream cannot provide sufficient coverage, multiple Streams can be installed. Each Stream controls its own group of Omni speakers, enabling extended coverage and flexible zone management.

Preparation

- Plan the installation using the Spottune Sales Tool or a detailed floor plan.
- Define clear groups of Omni speakers for each Stream.
- Assign one Stream per group and mark both the speakers and Stream with the group number.

Installation Steps

1. Install Group 1

- a. Mount and power only the Omni speakers belonging to Group 1.
- b. Confirm speakers are in pairing mode (LED flashing green).
- c. Install and power the Group 1 Stream. Confirm it is in pairing mode.
- d. Allow the Stream to connect to all Group 1 speakers (LED solid green and audible beep).
- e. Test audio playback to verify functionality.
- f. Power off Group 1 Stream before proceeding.

2. Install Group 2 and Additional Groups

- a. Repeat the same steps for Group 2 (and any additional groups).
- b. Ensure only the speakers for the active group are powered on and in pairing mode during installation.
- c. Test and verify each group individually.
- d. Power off each newly installed Stream before moving to the next group.

3. Final System Activation

- a. Once all groups have been installed and tested, power on all Streams.
- b. All Omni speakers will automatically reconnect to their designated Stream.
- c. Perform a full system test to confirm correct playback in all zones.

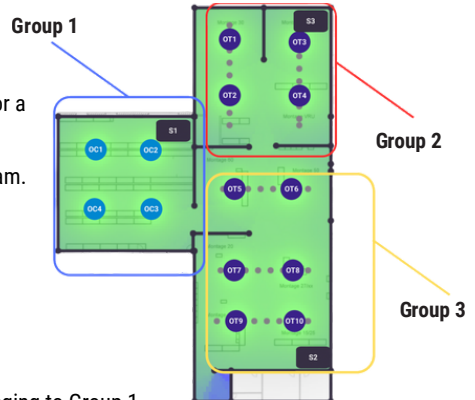

Important tips

- Install one group at a time – only power the Stream for the group you are working on.
- Prevent cross-pairing by ensuring other Streams are powered off during installation.
- Check signal strength in WORKING MODE after installation to confirm optimal placement.
- Walk the site after final activation to verify even coverage and stable playback.

Pendant Kit Installation

Please note: The electrical installations of Spottune Omni with either a Pendant Kit or Recessed Kit should only be done with the power disconnected and by people with sufficient electrical knowledge.

Conversion

To convert a Omni Track speaker to a pendant speaker, you need the **Spottune Pendant Kit**.

1. Unscrew the two screws holding the track adaptor and unclip its power cord underneath.
2. Connect the power cord of the Pendant Kit to the speaker.
3. Using the two screws from the track adaptor, attach the top plate of the Pendant Kit make sure not to overtighten the screws.
4. If needed shorten the cord.
5. Instal power plug or connect it directly in a lamp outlet.

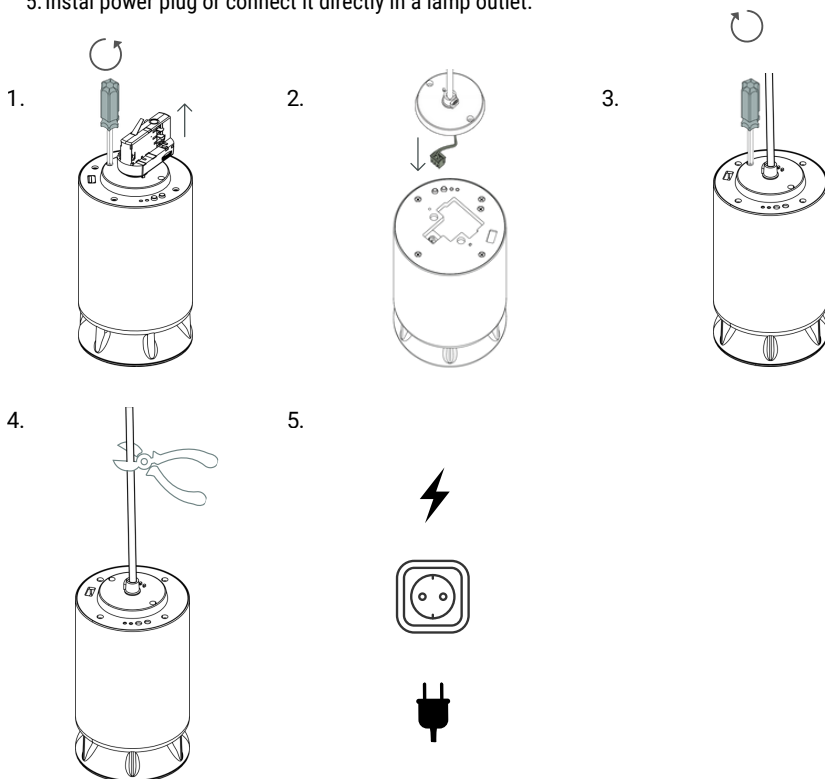

Recessed Kit Installation

Please note: The electrical installations of Spottune Omni with either a Pendant Kit or Recessed Kit should only be done with the power disconnected and by people with sufficient electrical knowledge.

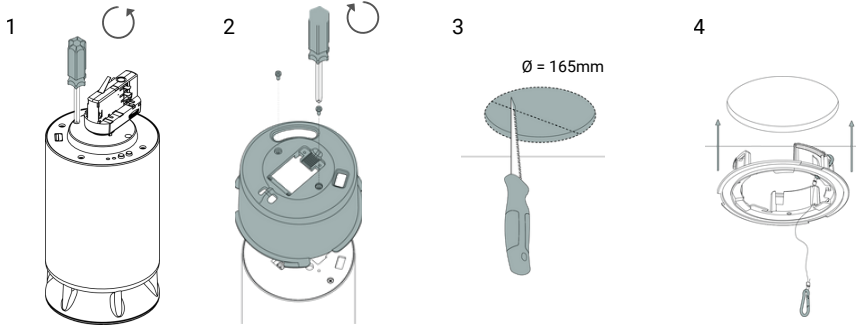

Unscrew the two screws holding the track adaptor, unclip the power cord and remove adaptor (1). Use the screws from the adaptor to fasten the chosen recessed ring (2). Cut a hole in the desired location for the speaker and place the mounting ring in the cutout (3 & 4).

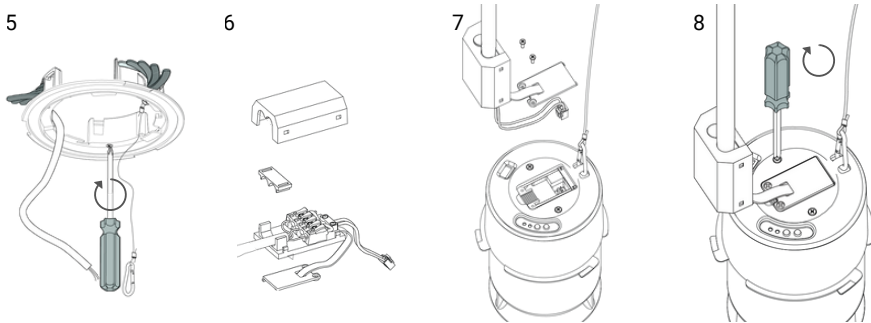

Fasten the mounting ring and pull out the installation cable from the hole (5). Connect the wires in the junction box (6). Attach the safety-wire to the housing and connect in the power cord to the speaker (7) and fasten the cover plate using two screws (8).

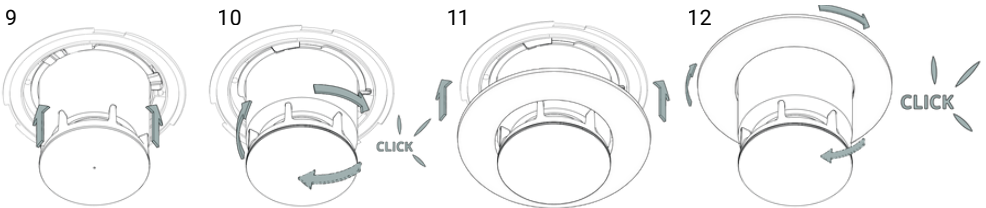









Push the speaker up and twist clockwise to lock it into place (9 & 10). Place the cover ring on the mounting ring and twist clockwise to lock it into place (11 & 12).

Advanced functions

Please note that the advanced functions found in **"WORKING MODE"** are intended for installers only. This mode should only be used by individuals with the necessary knowledge and expertise to operate it safely.









Enabling/disabling Bluetooth

Bluetooth has a very limited range and should only be used when other inputs are not available.









1. Enter "WORKING MODE" by pressing and holding  five seconds.
2. Enter "SETTINGS MAIN" by pressing  once.
3. Toggle down on  until you reach "Bluetooth".
4. Press  to activate the menu. With  toggle between "Enable" and "Disable."
5. Press  to save the setting.
6. Press the  to exit "SETTINGS MAIN" and press  for five seconds to exit "WORKING MODE"
7. To enter Bluetooth pairing mode on the Stream, choose BLUETOOTH as the source using  afterward press and hold the same button to activate Bluetooth pairing mode.

Enabling/disabling Spotify Connect

Be advised that Spotify is a consumer product, and any legal responsibility for its use lies solely with the company utilizing the service, not with Spottune. NB. Spotify Connect relies on local network routing to work.

1. Enter "WORKING MODE" by pressing and holding  for five seconds.
2. Enter "SETTINGS MAIN" by pressing  once.
3. Toggle down on  until you reach Spotify.
4. Press  to activate menu. With  toggle between "Enable" and "Disable".
5. Press  to save the setting.
6. Press the  to exit "SETTINGS MAIN" and hold down  for five seconds to exit "WORKING MODE".
7. From the Spotify app, you should now be able to see "SPOTTUNE A" and "SPOTTUNE B" corresponding to Zone 1 and Zone 2 under the wireless devices menu .

Changing the EQ settings of your audio zones

1. Enter "WORKING MODE" by pressing and holding  five seconds.
2. Enter "SETTINGS MAIN" by pressing  once.
3. Toggle down on  until you reach "ZONE1 PRESET/ZONE2 PRESET".
4. Press  to enter presets the menu. With  toggle between the different EQ presents.
5. Press  to save the setting.
6. Press the  to exit "SETTINGS MAIN" and press  for five seconds to exit "WORKING MODE"

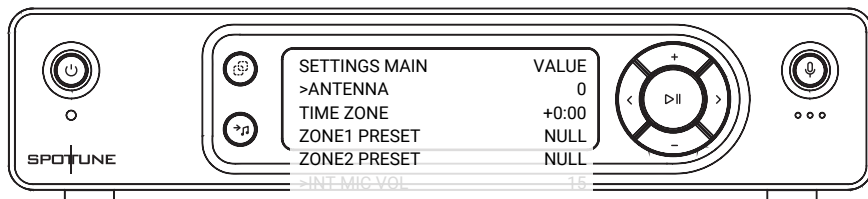

PRESET NULL

Regular EQ

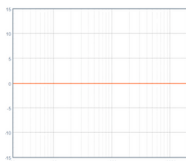

PRESET -1

Increased bass

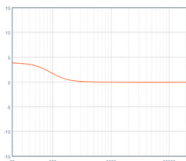

PRESET -2

Decreased bass

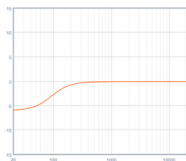

PRESET -3

Increased treble

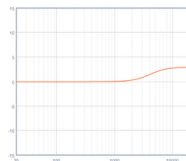

PRESET -4

Decreased treble

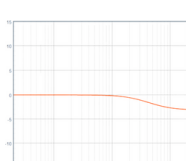

PRESET -5

Increased bass,
decreased treble

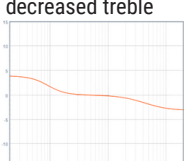

PRESET -6

Decreased bass,
increased treble

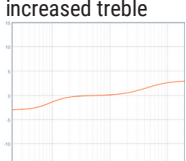

PRESET -7

Decreased treble
(spiked)

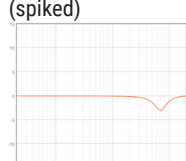

PRESET -8

Increased midrange

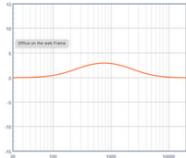

PRESET -9

Recessed mount

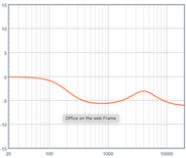



Change speaker zone, set volume offset and check signal strength

If you need to change zone or volume of one or more speakers individually, you can do so within "WORKING MODE" of the Spottune Stream transmitter. This is also where you can check signal strength of each speaker.

1. Enter "WORKING MODE" by pressing and holding  five seconds.

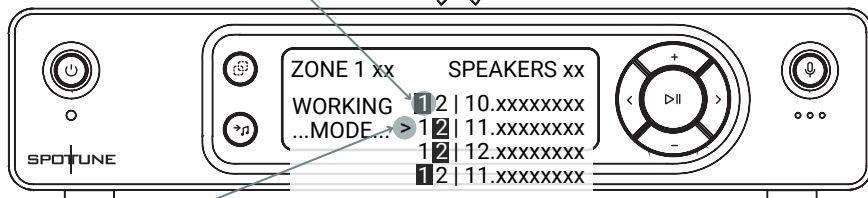
The "box" marks speaker zone, use   to change zone for selected speaker.



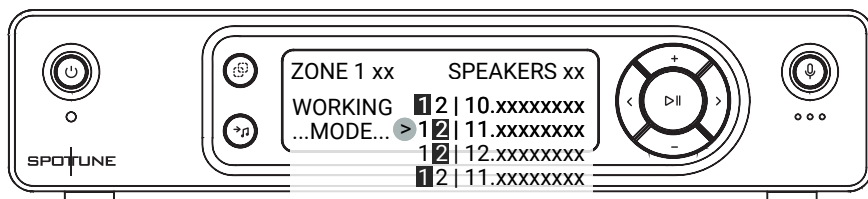

The > shows the selected speaker, use  to select a specific speaker.

2. Press  to enter/exit settings for selected speaker.

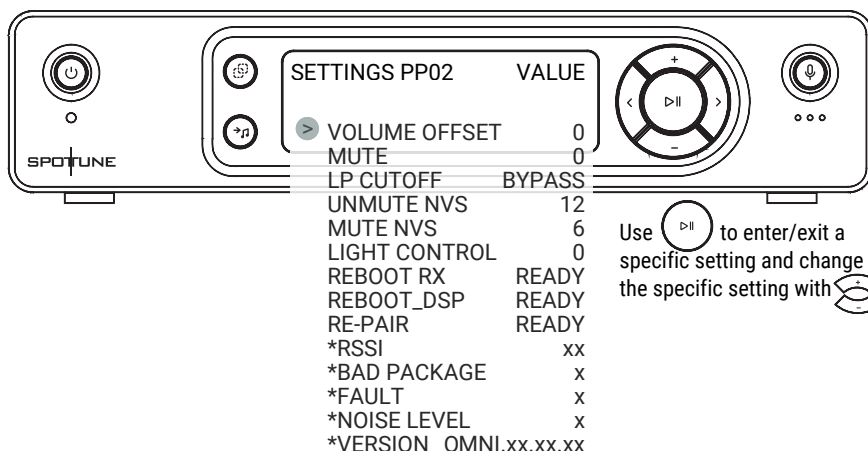

3. First use  to toggle between functions for the specific speaker.





Use  to enter/exit a specific setting and change the specific setting with .

Speaker settings - short explanation.

Don't change any parameters unless you know what you are doing. If you need help, please contact support@spottune.com



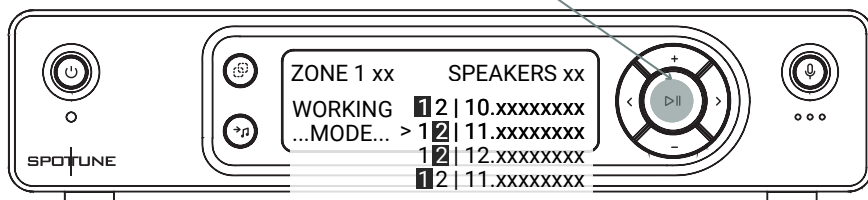

SETTINGS PP02	VALUE	
VOLUME OFFSET	0	Volume offset – if a speaker should play more or less than the zone volume.
MUTE	0	Activate / de-activate mute
LP CUTOFF	BYPASS	LowPass cutoff
UNMUTE NVS	12	Amount of good packages received by the speaker before unmuting
MUTE NVS	6	Amount of bad packages received by the speaker before muting
LIGHT CONTROL	0	Dim status LED on speaker
REBOOT_RX	READY	Reboot speaker
REBOOT_DSP	READY	Reboot DSP amplifier only
RE-PAIR	READY	Activate pairing-mode
*RSSI	xx	Signal strength
*BAD PACKAGE	x	
*FAULT	x	
*NOISE LEVEL	x	
*VERSION	OMNI.2703.28	

4. Take note of the speaker RSSI value; this indicates the signal strength. 40+ is excellent, 37-39 is good, 35-36 is weak, and < 34 is bad. Tweak the signal by turning the speaker. Its antenna is located on the side directly below the Spottune logo on top of the speaker, and this side should face the Stream.
5. Press  to exit settings for selected speaker.
6. Exit "WORKING MODE" by pressing and holding  for five seconds.





Check firmware version, IP-address and CC-number on a Spottune Stream

Firmware version

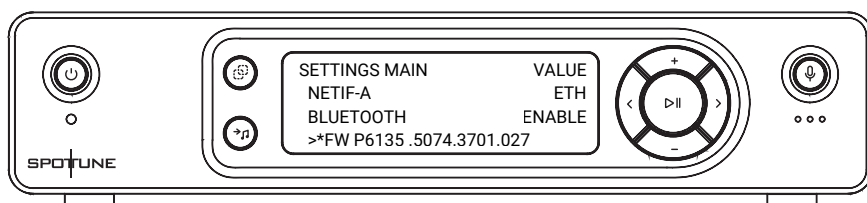
1. Enter "WORKING MODE" by pressing and holding  five seconds.
2. Enter "SETTINGS MAIN" by pressing  once.
3. Toggle down on  until you reach >*FW xxxx.... - this will be your firmware version.
4. Press the  to exit "SETTINGS MAIN" and press  for five seconds to exit "WORKING MODE"





IP-address and CC-number

1. To display the IP-address and CC-Number, simply press and holding both  and  on the Stream for 6 seconds.

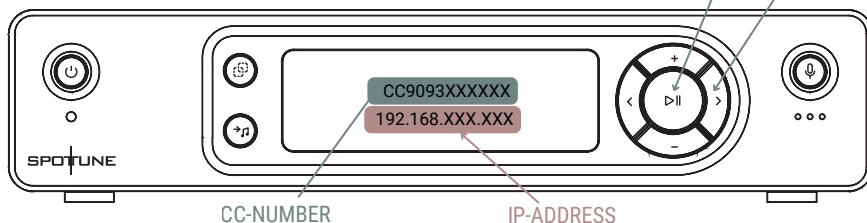
TIP: Have your mobile phone ready to snap an image of the numbers



Factory reset of the Spottune Stream and Spottune Omni

Spottune Stream factory reset - Resetting a Stream should only be used when all else fails. Reset the Stream by pressing and holding both  and  for 15 seconds.

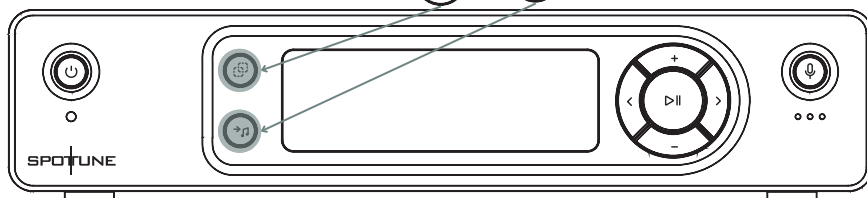

Spottune Omni speaker factory reset

Reset the Omni speaker by pressing and holding the  button on top of the speaker for 30 seconds. The speaker will now perform a factory reset indicated by a color change of the status LED to yellow followed by white, and after approximately 10 seconds, the LED will start flashing green, and this means that the speaker is reset and in pairing mode.

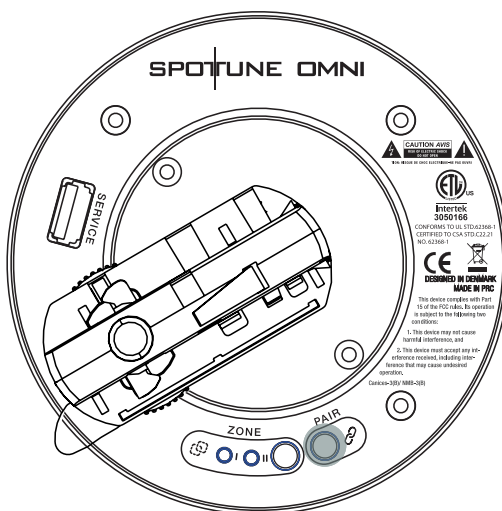



If you have any questions to this manual
please contact **support@spottune.com**