



# AFFORDABLE HOUSES

TRANSPORTABLE HOMES, LIVING SOLUTIONS

— 120m<sup>2</sup> - Four Bedroom —



Phone: 027 943 0077

Email: [info@affordablehouses.co.nz](mailto:info@affordablehouses.co.nz)

Web: [www.affordablehouses.co.nz](http://www.affordablehouses.co.nz)



# The Growing Family Home

Price: \$327,000.00 (Inclu GST)

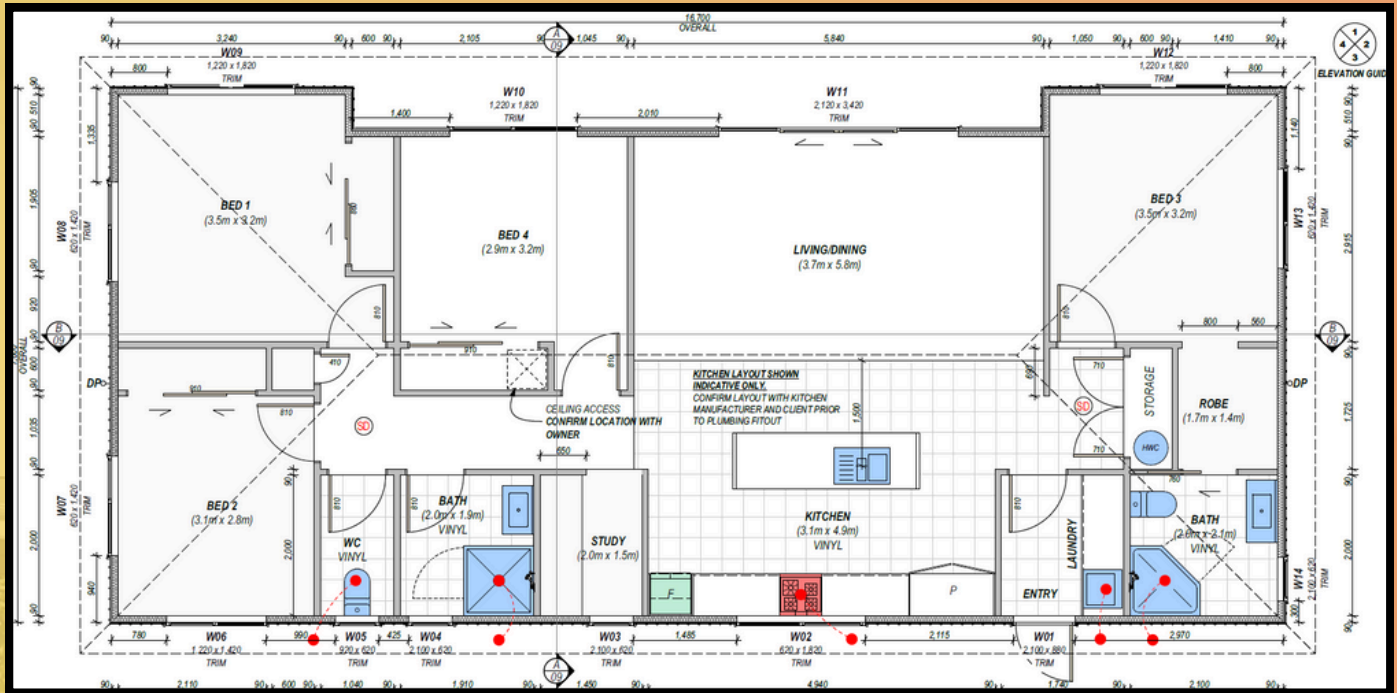

Phone: 027 943 0077

Email: [info@affordablehouses.co.nz](mailto:info@affordablehouses.co.nz)

Web: [www.affordablehouses.co.nz](http://www.affordablehouses.co.nz)



## Spec List

- Mitsubishi Heatpump
- LED Dovon Lights
- Stainless Oven and Ceramic Hob
- Stainless Range Hood
- Stainless Dishwasher
- Laundry Tub
- 900 X 900 Shower
- Vanity
- Toilet
- Poly Floor Vinyl Planking
- Belgotex Carpet
- Designed for very high wind zones
- Wall/Ceiling and Underfloor Insulation
- Designed for All Coastal Areas
- Califont or Hot water Cylinder
- Code of Compliance Certificate (Yard Consent)
- Shadow Clad/Timber Weather Board
- .55 Gage Colour Steel Max Roofing
- Double Glazed Aluminium Joinery

## Optional Extras

- Curtains
- All vinyl (no carpet)
- Transportaion/Piling
- Extra power points
- Site Consent
- Magnetic insect screens
- Fridge
- Decks
- Gas cooking upgrade
- Base Boards
- Engineer/Geotech



120m<sup>2</sup>

## Who We Are

We are a reputable company with a proven track record of delivering high-quality, affordable homes to our clients. Our team consists of skilled builders who are dedicated to providing exceptional customer service and ensuring that our clients receive the best value for their money.

Our goal is to make home ownership and the house building process, quicker and easier, while being as efficient and sustainable as we can be every step of the way.

## Other Options



**The Tiny Home**



1



1



35



**The Starter Home**



2



1



60



**The Investor Home**



2



2



80



**The First Home**



3



1



88



**The Family Home**



3



2



100



**The Growing Family Home**



4



2



120

## Quality Houses at Affordable Prices