

A photograph of a room interior. A light-colored roller shade is partially unrolled over a window. To the left of the window, a framed abstract artwork hangs on the wall. In the foreground, a dark wooden chair with a curved back is visible. To the right of the chair, a woven basket holds a white, fringed blanket. The floor is made of light-colored wood, and a patterned rug is partially visible in the bottom right corner.

EVERHEM

*Roller Shade  
Installation Guide  
Inside Mount – Motorized*



# The Tools You'll Need

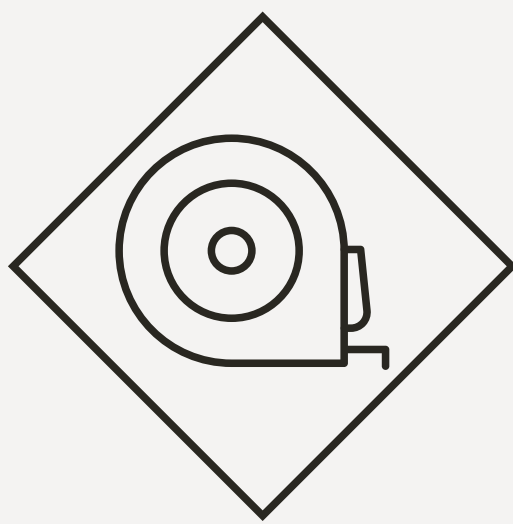

TAPE MEASURE



STEP LADDER

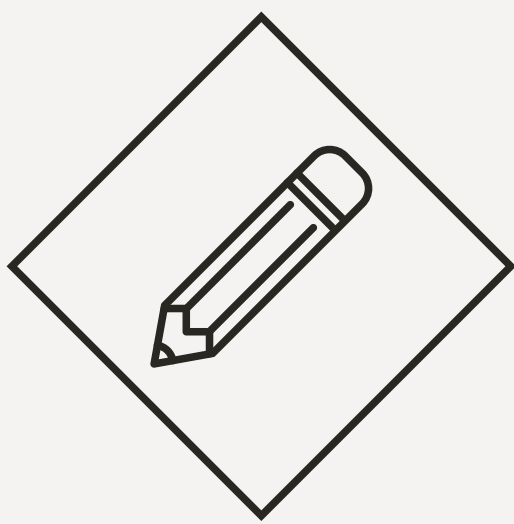

PENCIL

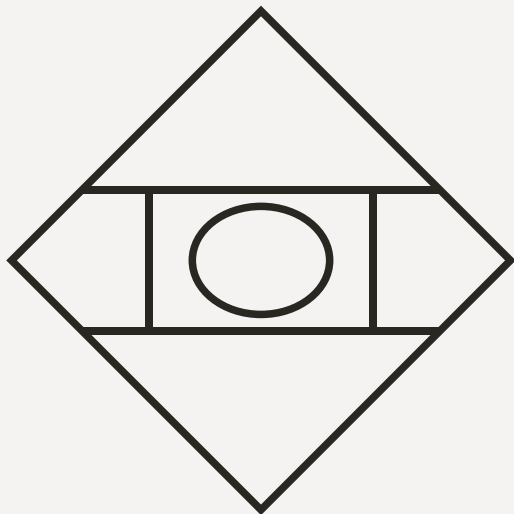

LEVEL

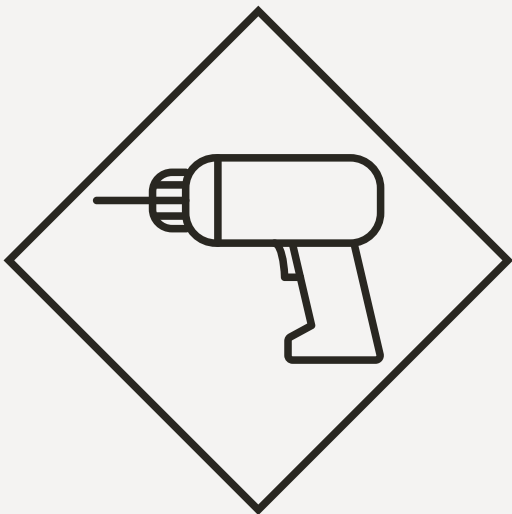

POWER  
DRILL

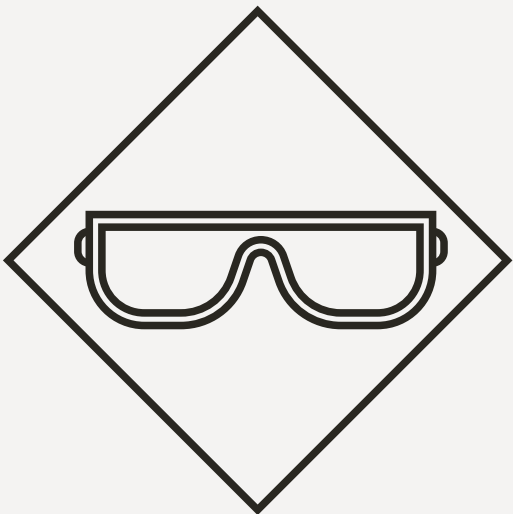

SAFETY  
GOGGLES

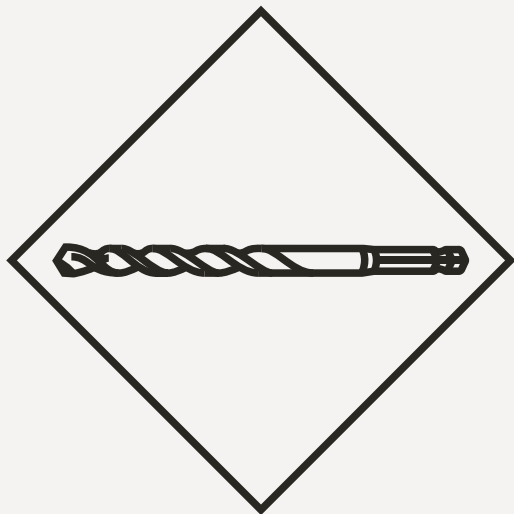

$\frac{7}{64}$ " DRILL  
BIT

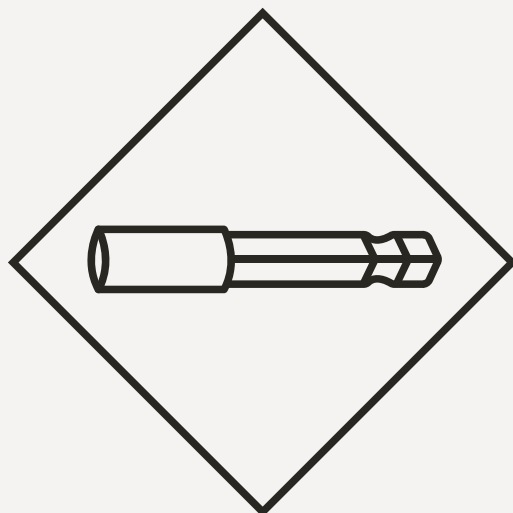

$\frac{1}{4}$  HEX  
SOCKET  
BIT

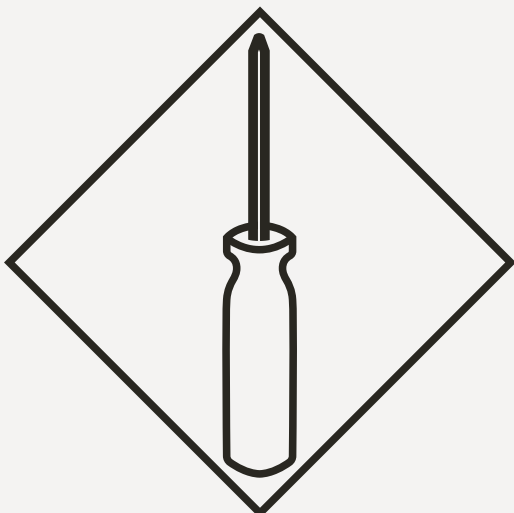

PHILLIPS  
HEAD  
SCREWDRIVER

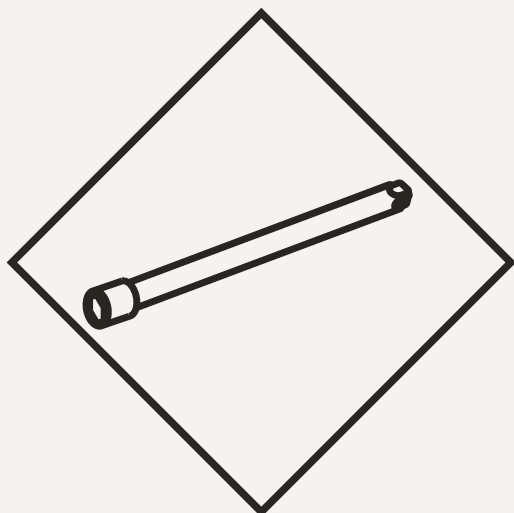

$\frac{1}{4}$  HEX  
EXTENDER  
TIP

# The Hardware We Provide

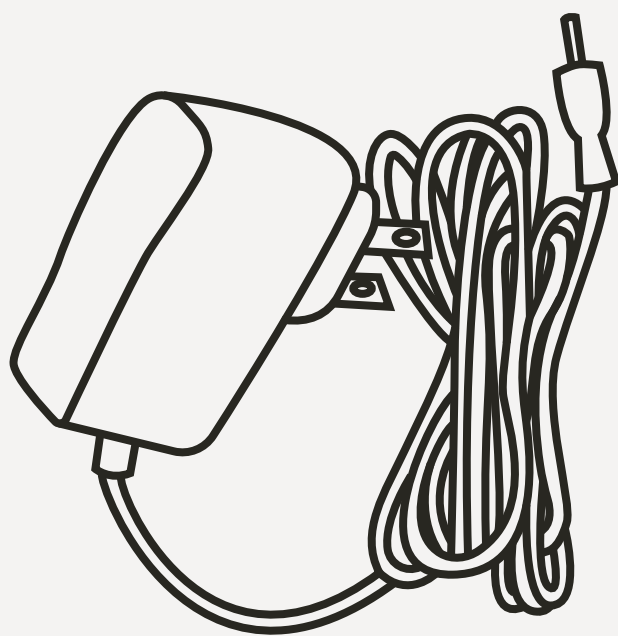

CHARGING  
CORD



HEADRAIL  
MOUNTING  
SCREWS

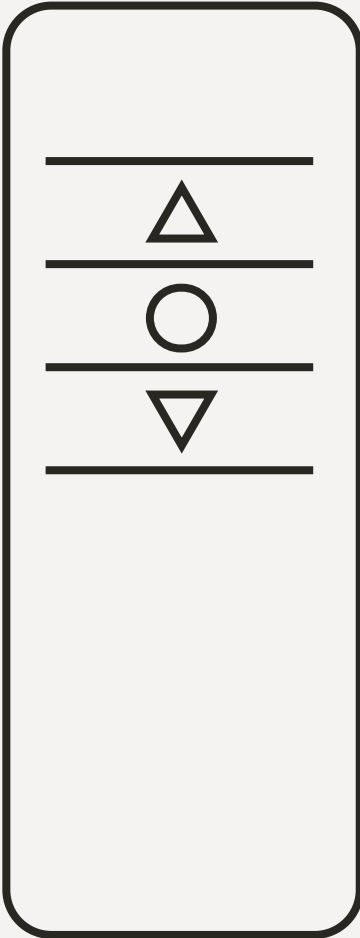

REMOTE  
CONTROL

# Step 1

Determine shade's mounting position.

Shades wider than 72" may require assistance. Center your shade's valance headrail inside the window casement horizontally. Then, make sure the valance of the shade is flush with the window trim and does not extend forward.

SIDE VIEW

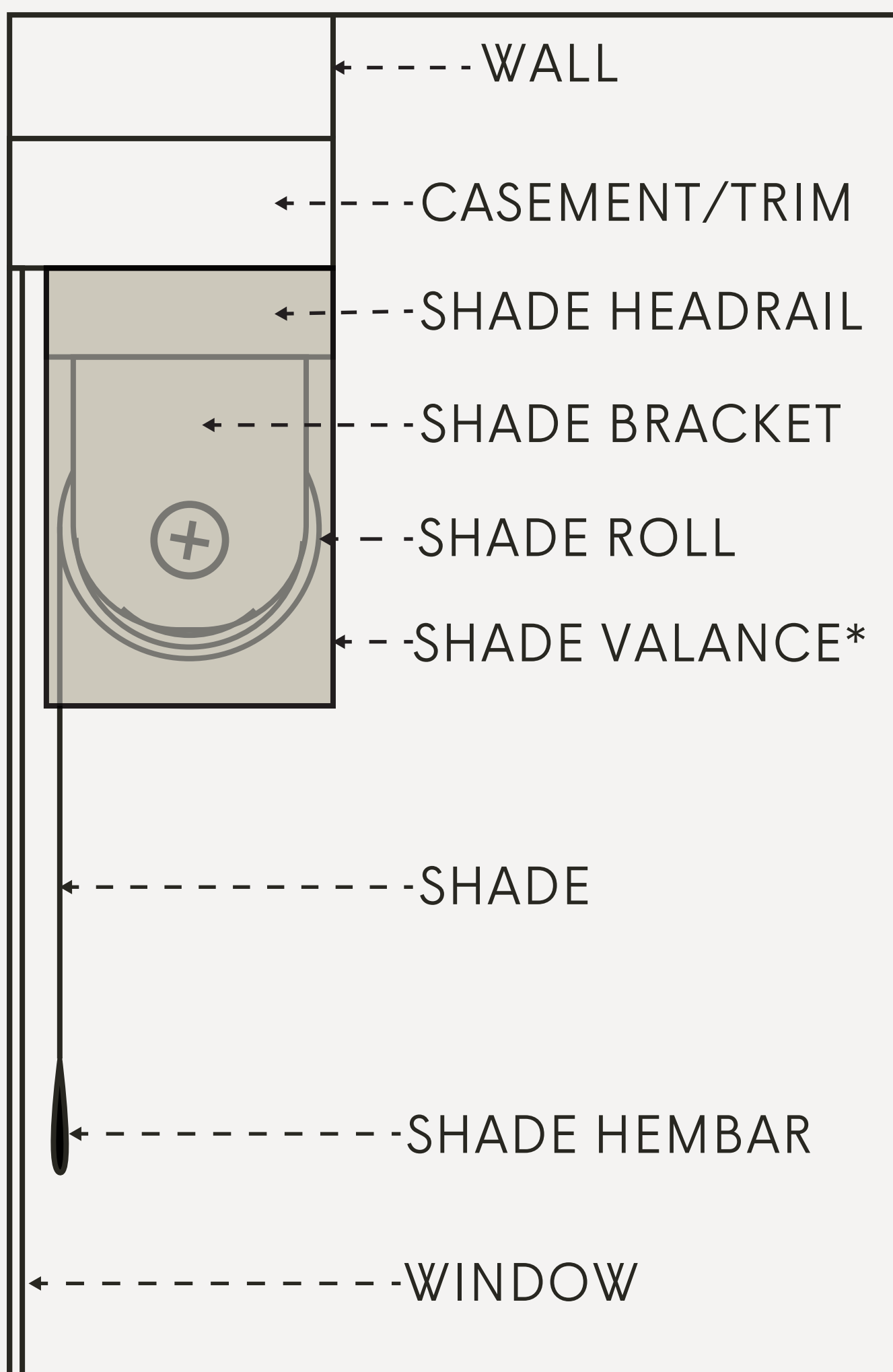

FRONT VIEW

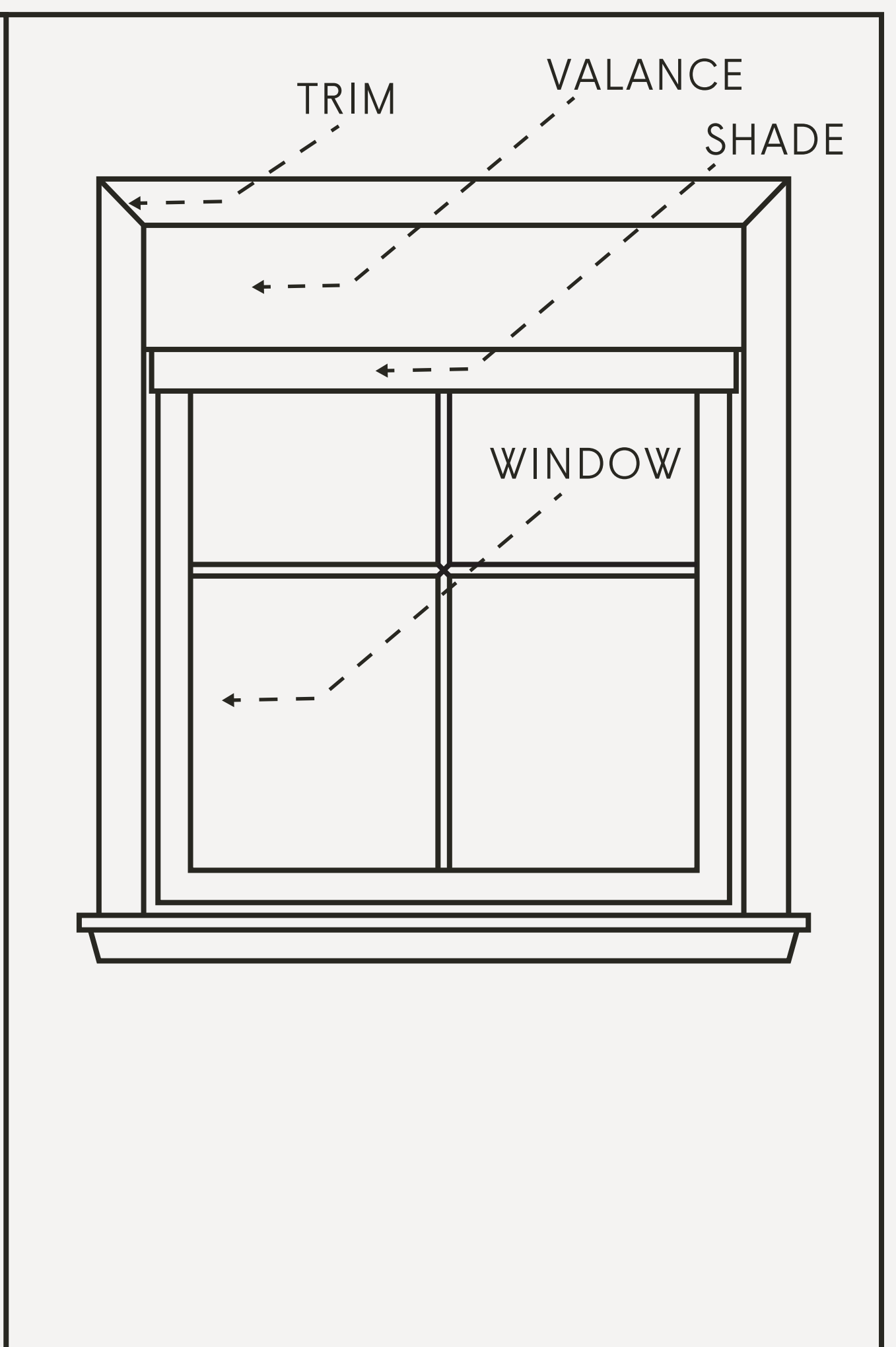

\*The valance illustration uses transparency to provide a clearer view of the shade's inner structure.

## Step 2

---

Find mounting screw holes. With the valance held firmly in place, carefully lift the valance and identify the brass-lined screw holes along the underside of the shade's headrail.

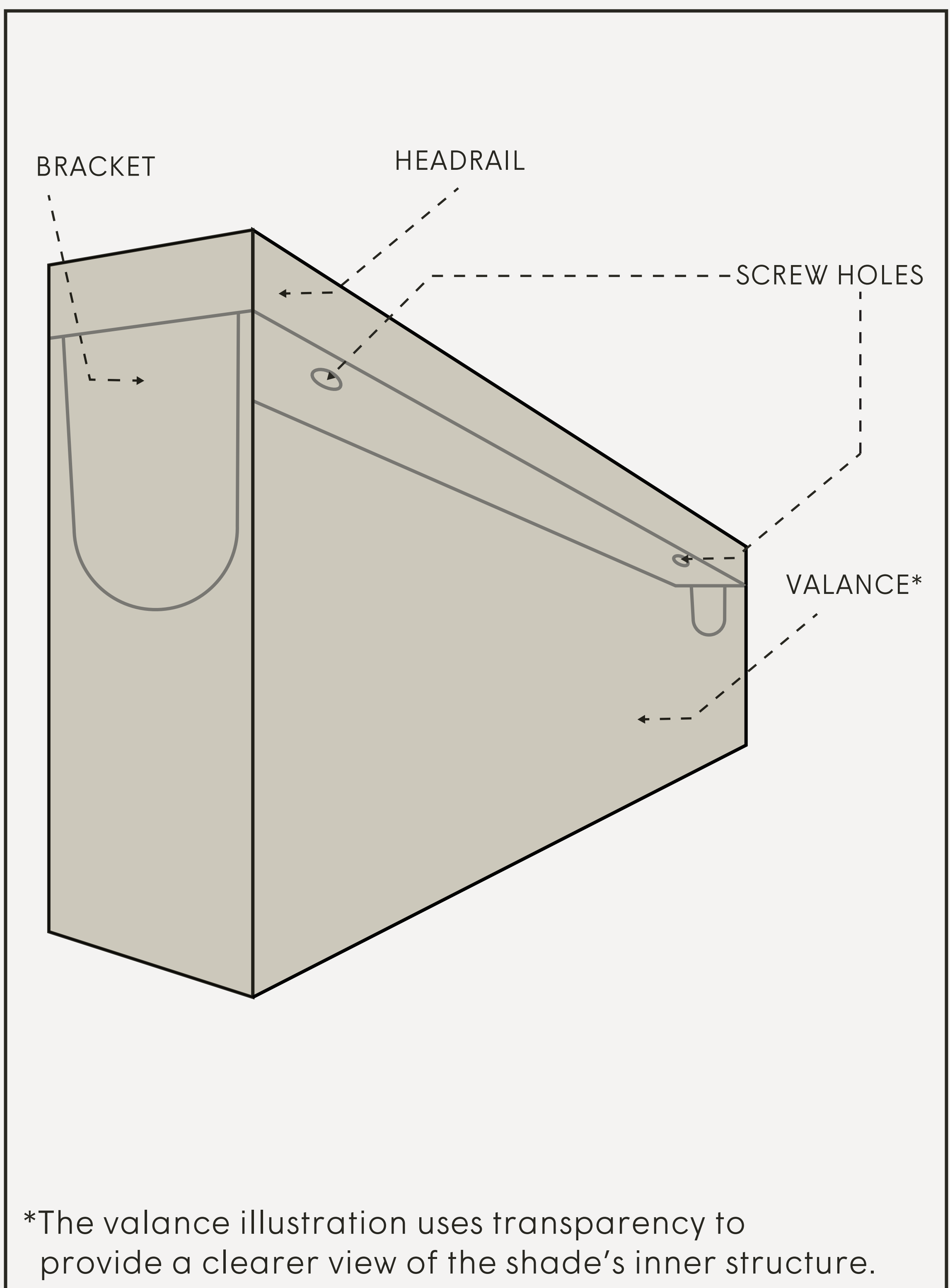

## Step 3

---

Drill mounting screw holes. With your valance still held firmly in place and starting from the centermost mounting screw hole found in STEP 2, use your power drill and the 7/64" drill bit to drill through the screw hole and into the window casement above.

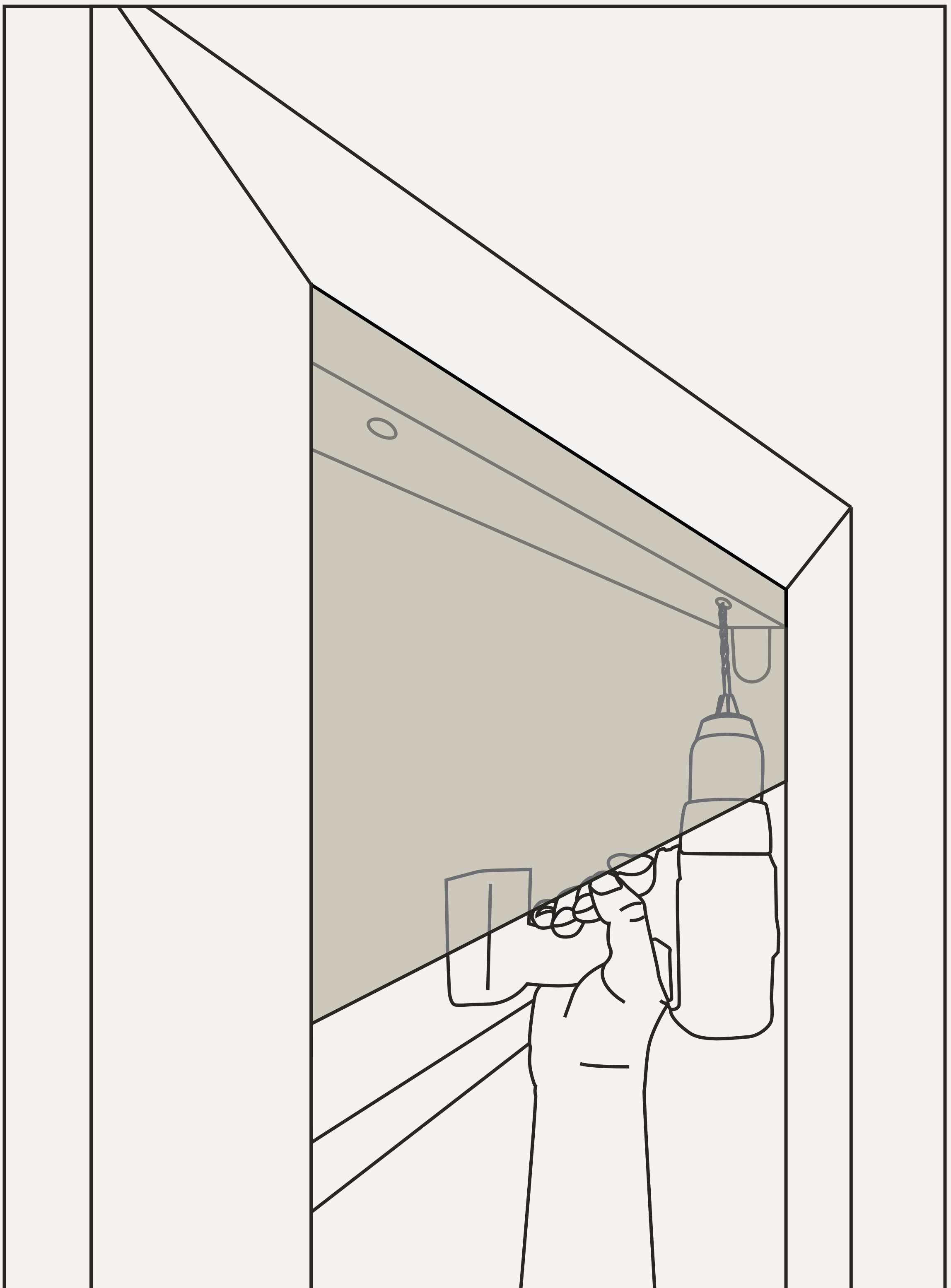

## Step 4

---

Secure Valance to window. Holding your valance in position and beginning with the centermost screw hole, use your power drill,  $\frac{1}{4}$  hex socket screw bit and the provided headrail mounting screw to secure the shade's headrail to the window casement. Repeat this process for each mounting screw hole drilled in STEP 3.

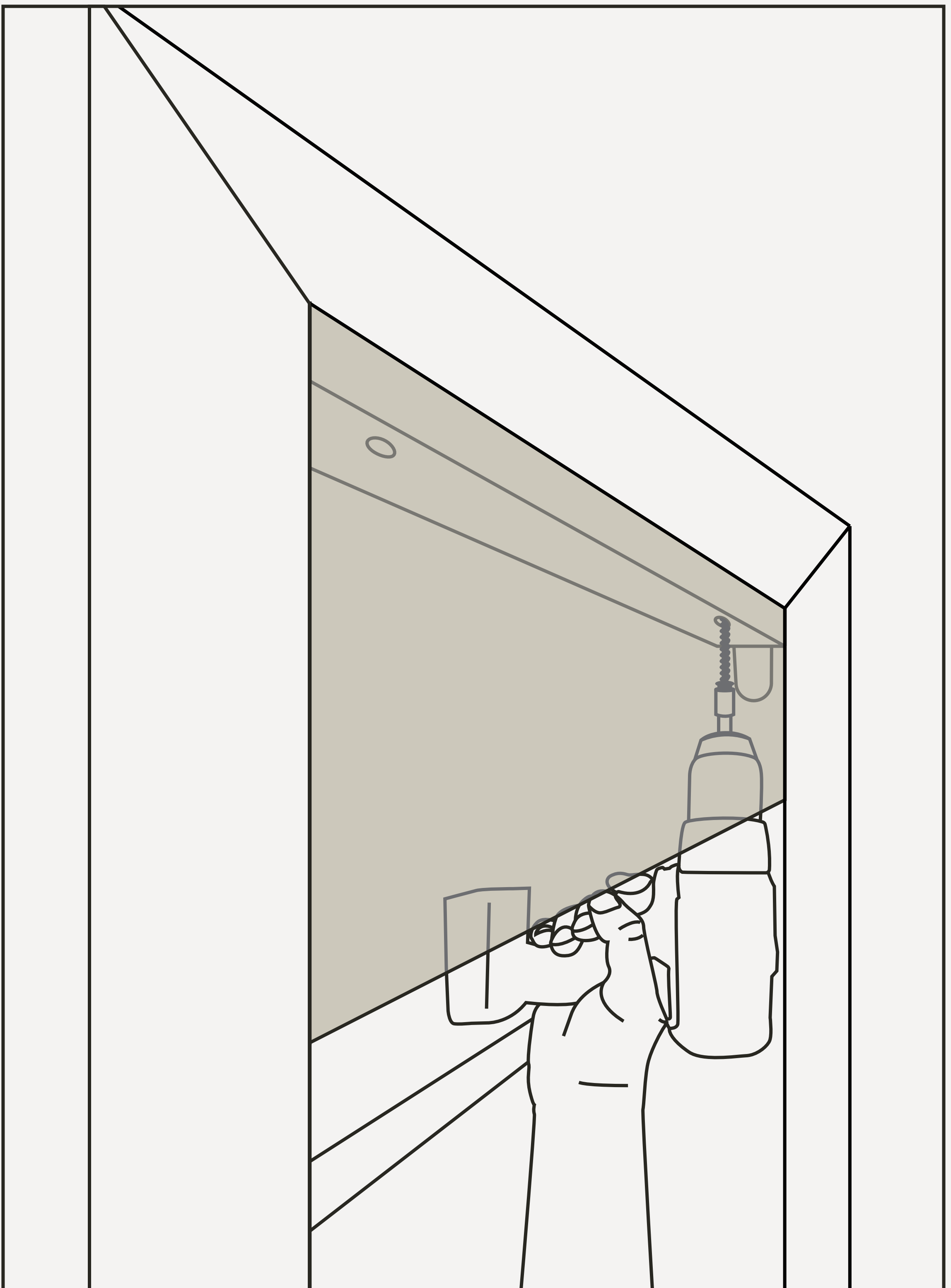

# Step 5

---

Locate Chain and Idler Position. Looking at the tube that corresponds to your window, determine which end has the short antenna exposed and the idler teeth - this is where your motor is located. Now on the other side of the tube, locate the idler spring that can collapse into the tube when pushed.

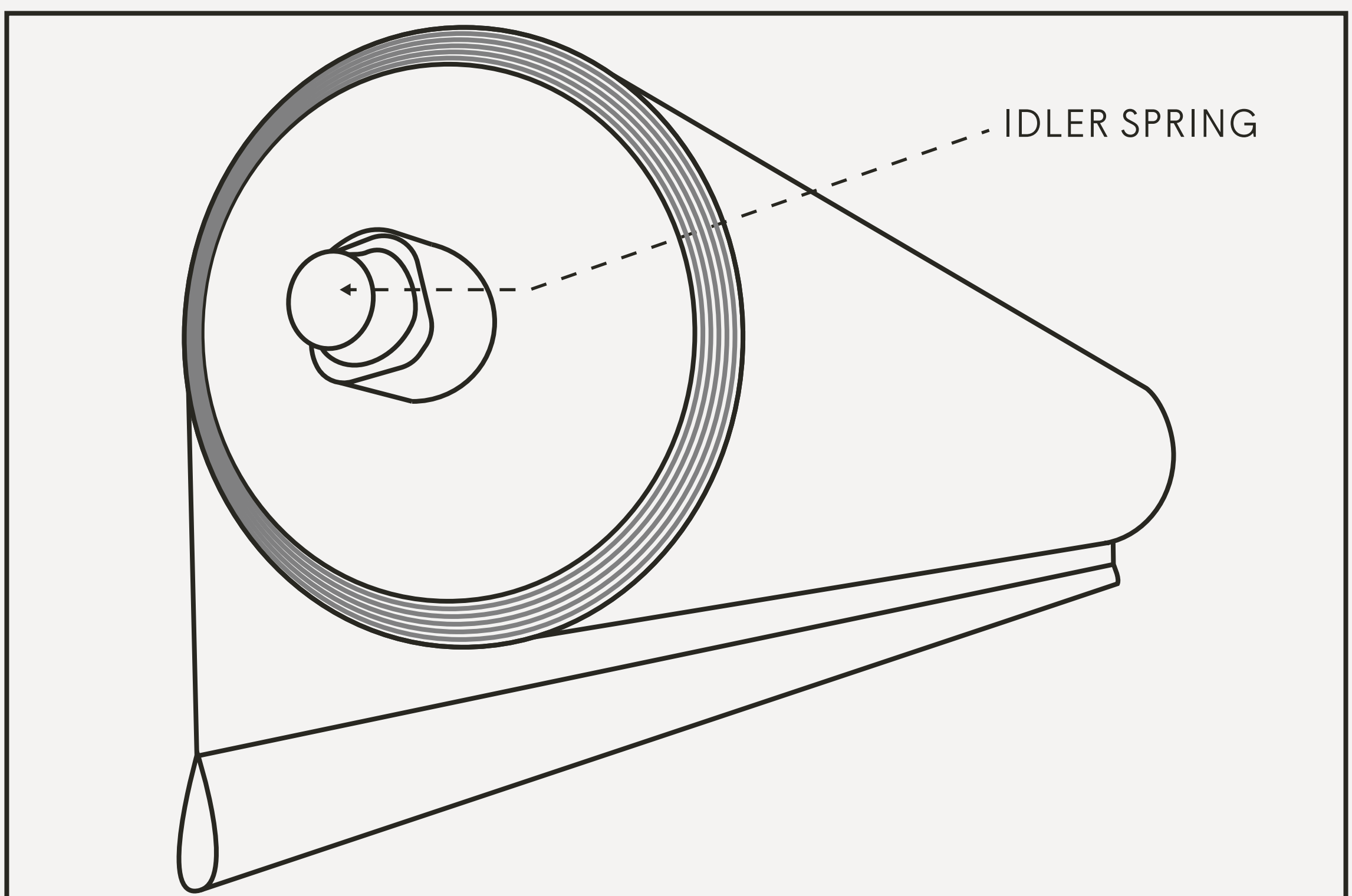
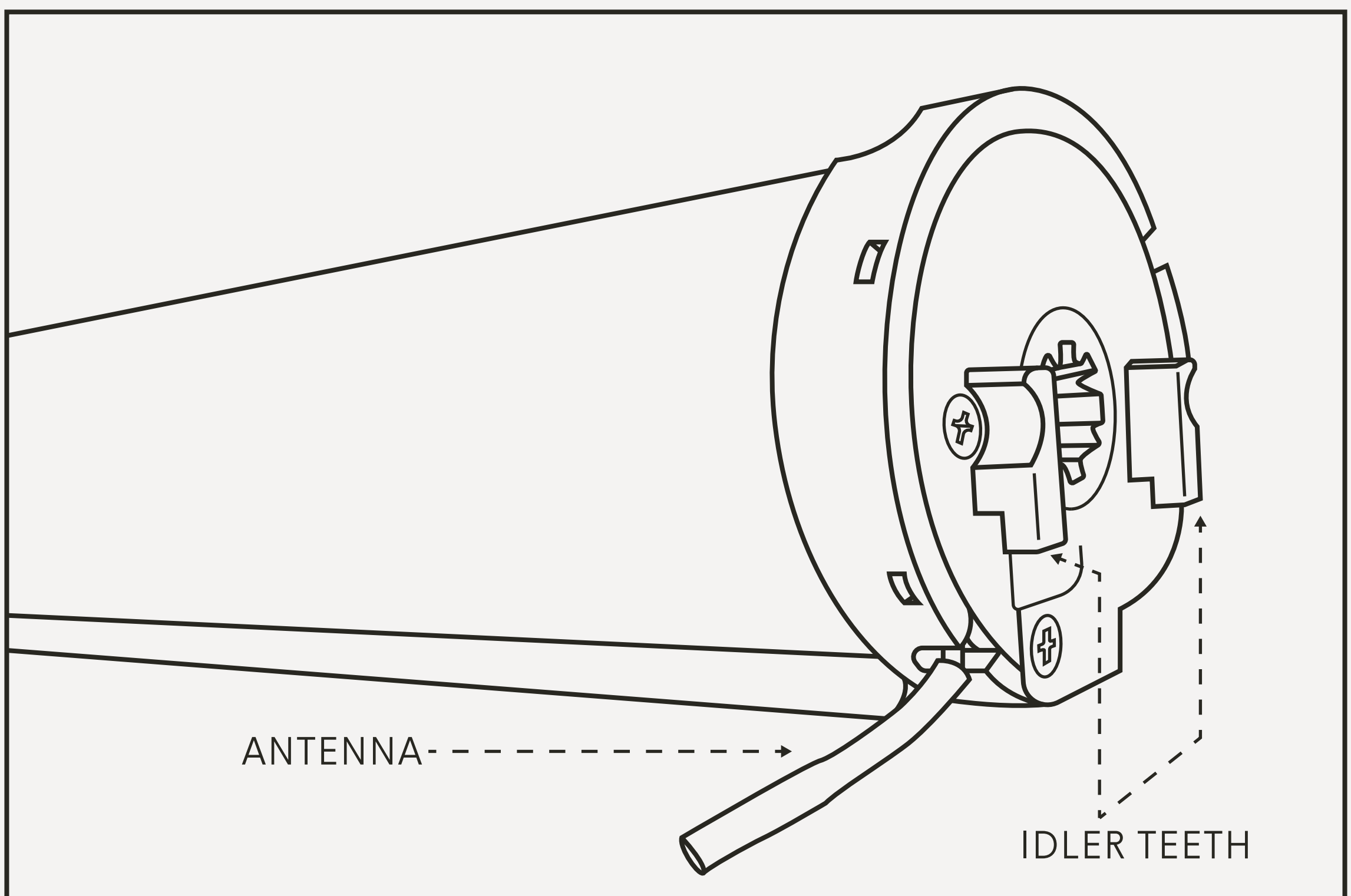



# Step 6

Place Shade into Valance. Position your shade to back roll or front roll accordingly, place the idler teeth on the motor side into the relevant vertical bracket slots then depress the idler spring and carefully slot it into the center hole of the opposite side bracket.

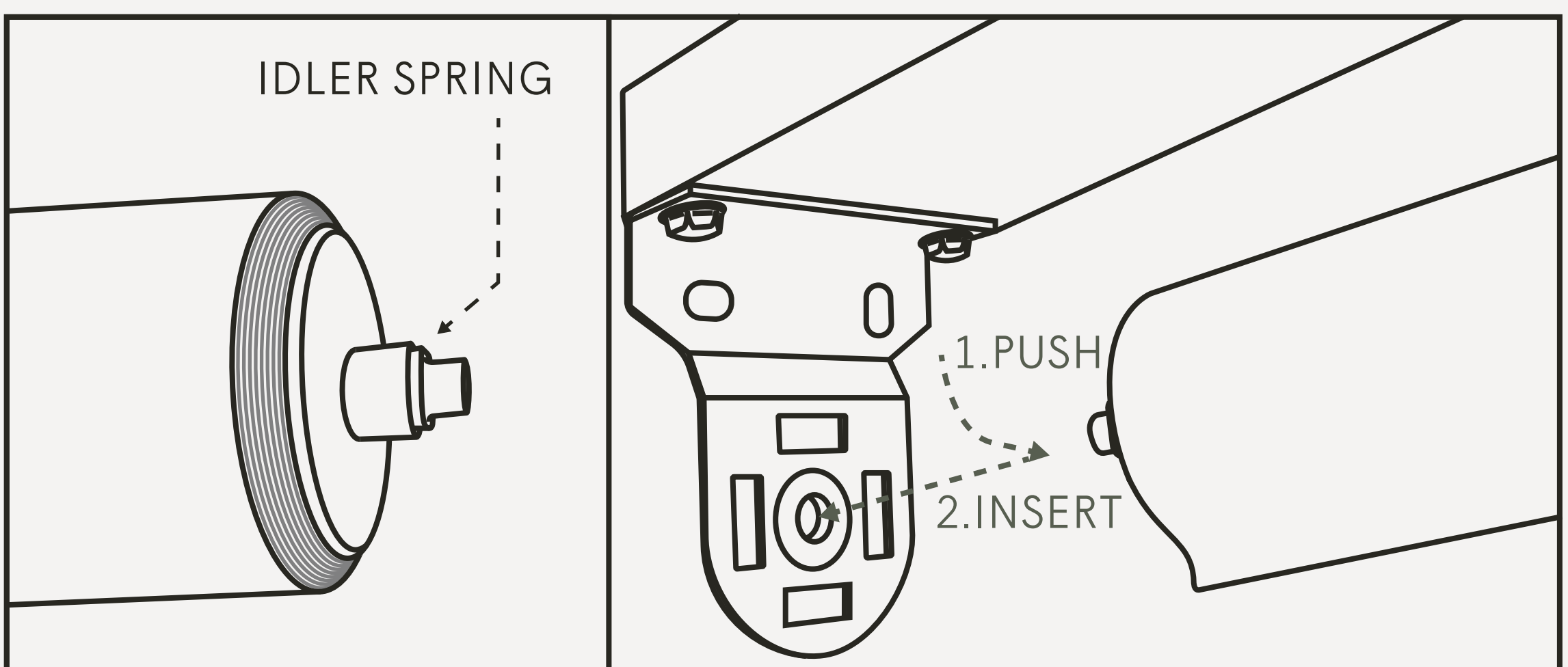
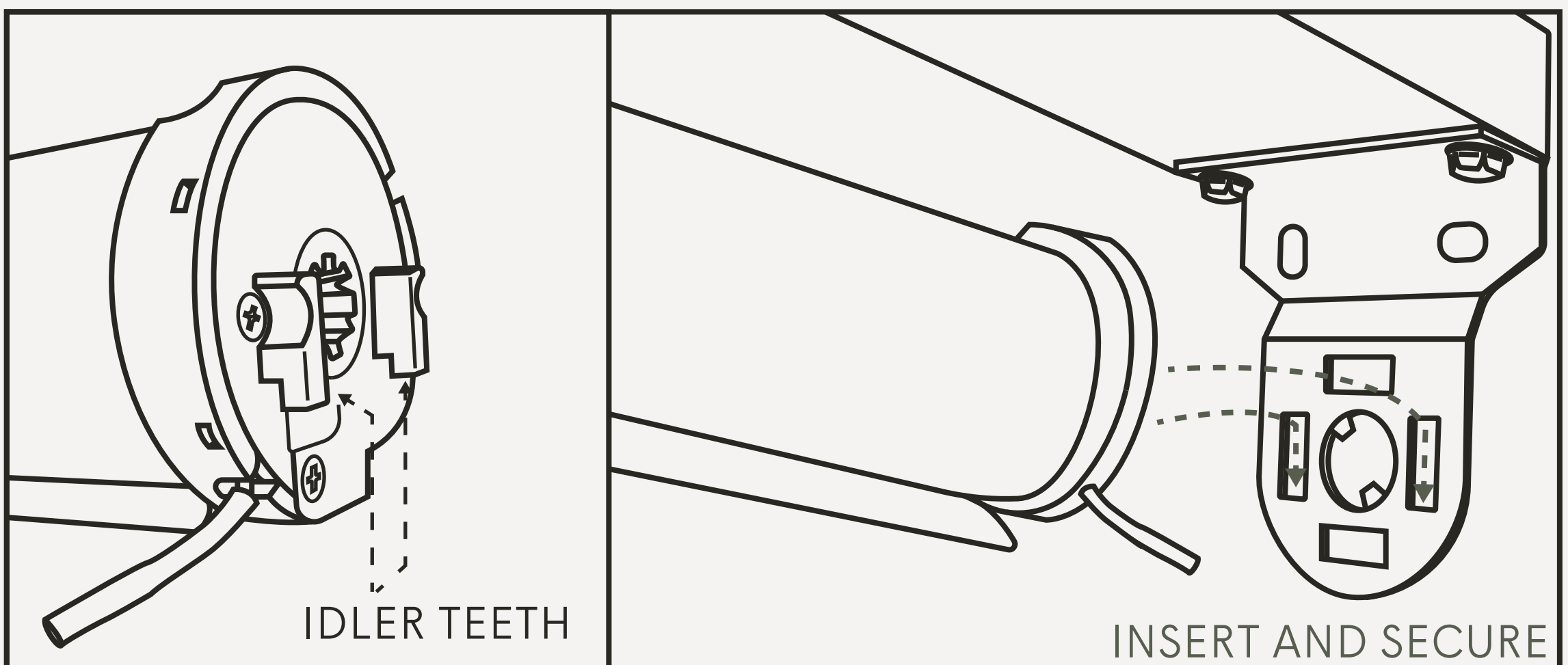
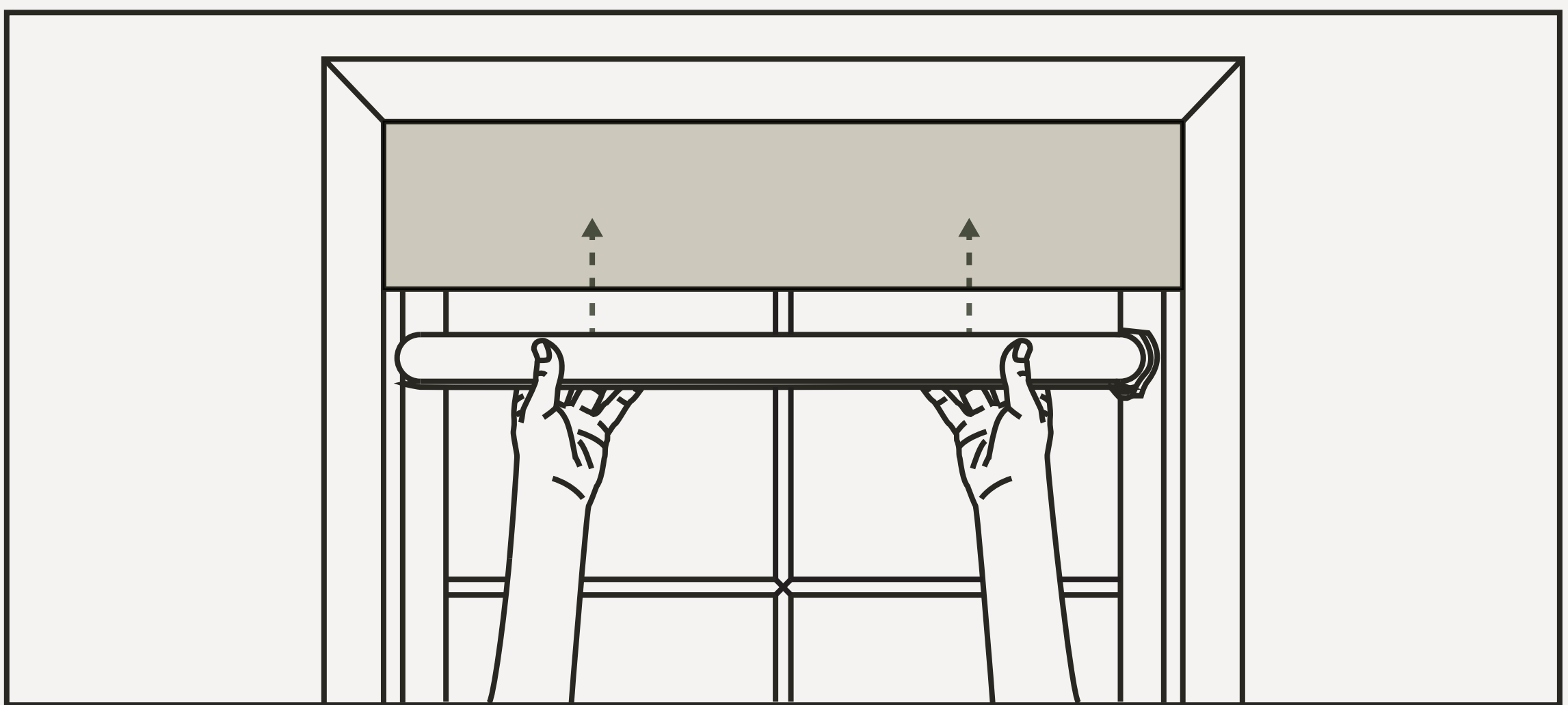



# Step 7

---

Activate the Motor. On the bottom of the tube endcap of the motor side, there is a white U-shaped button. Using a stylus-like tool, press the button 1 time quickly to activate the motor. You will see the tube rotate slightly forward and backward one time. Your motor is now activated.

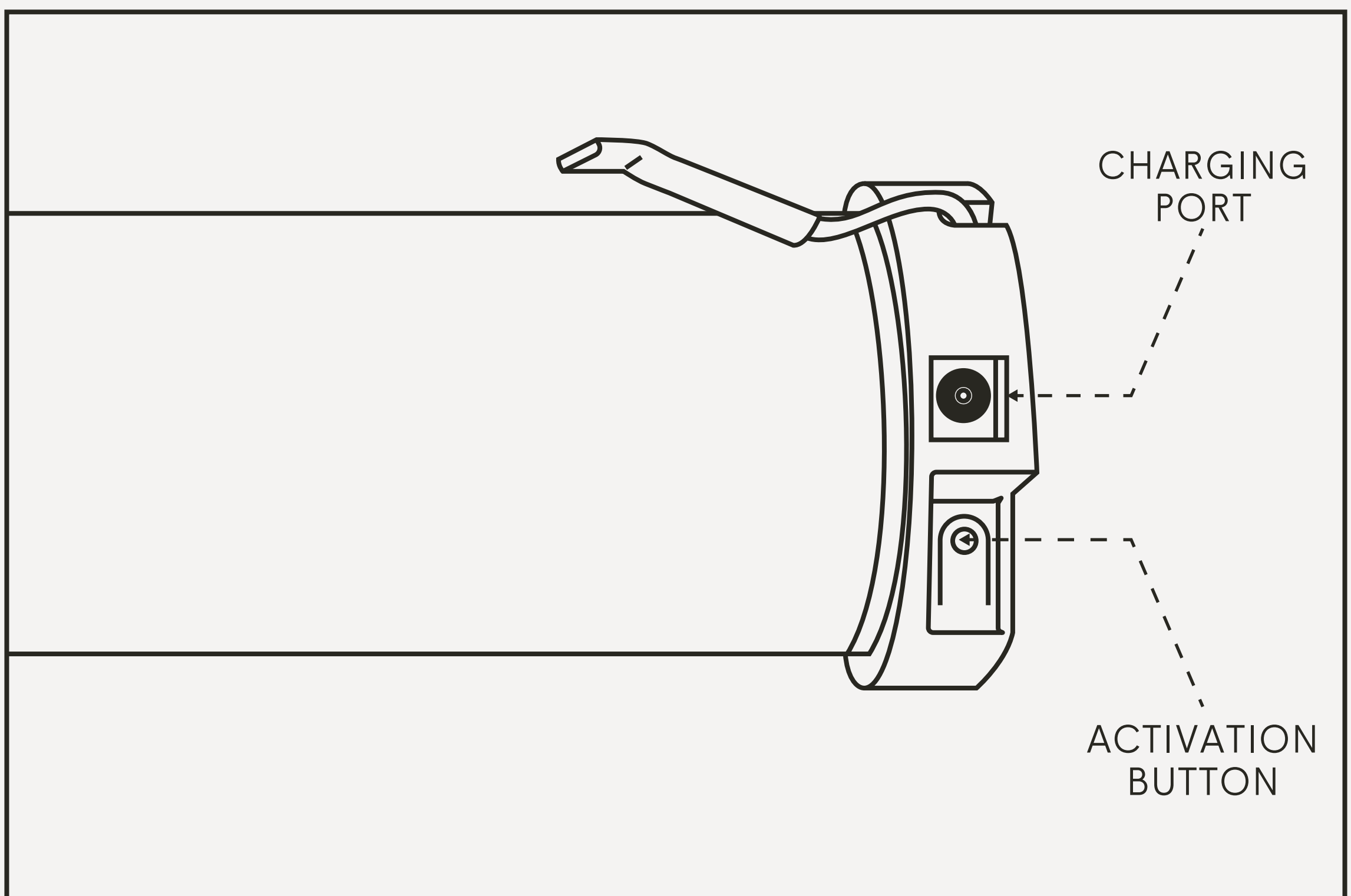

\*Please Note: Do not press the button more than once or hold the button down - this may cause your motor to erase all its pre-programmed settings and malfunction.

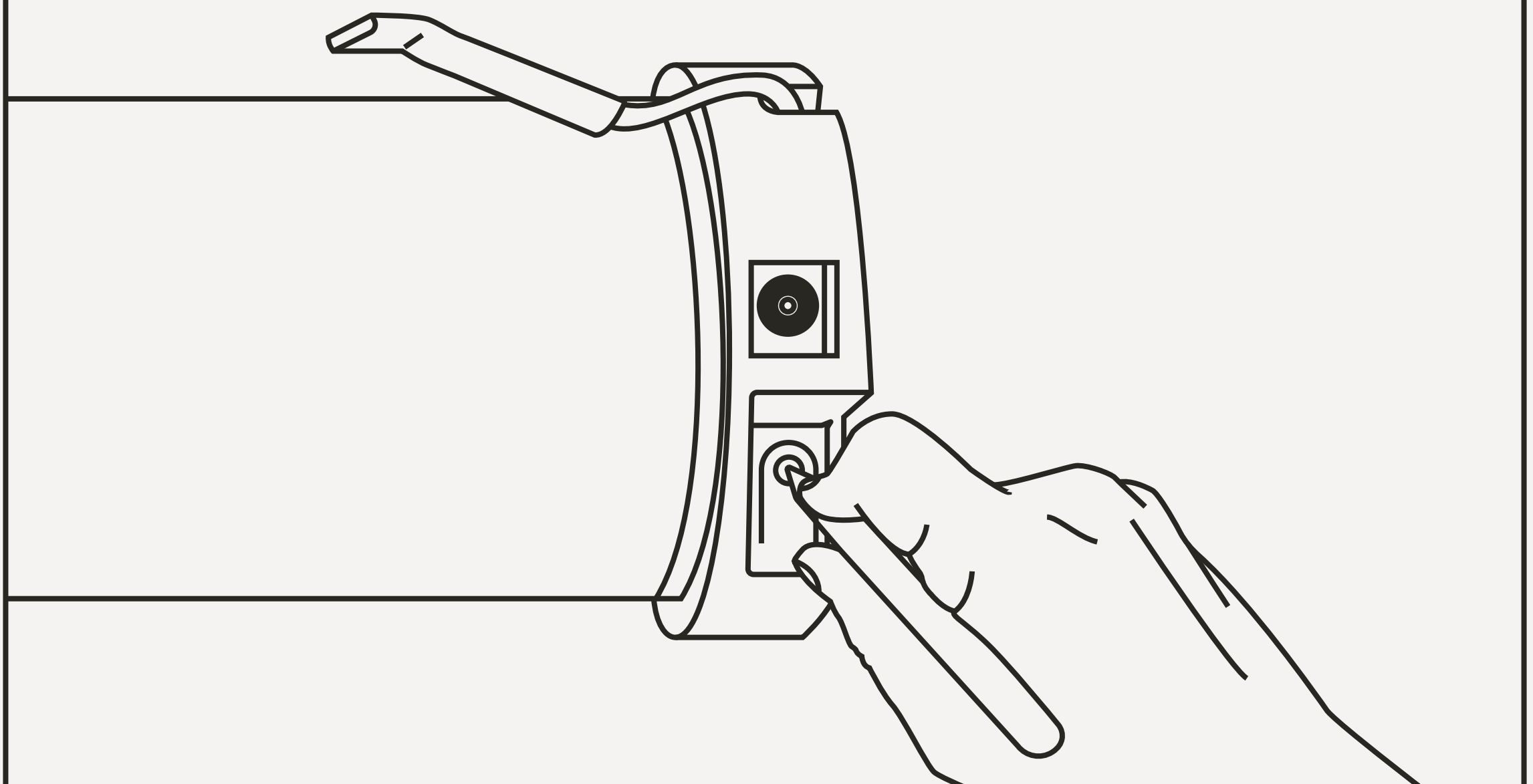



# Step 8

Use Your Remote Using the pre-programmed remote provided, operate your shade with the press of a button. If your shade is programmed to a specific channel of a multichannel remote, press the corresponding number first, then use the control buttons.

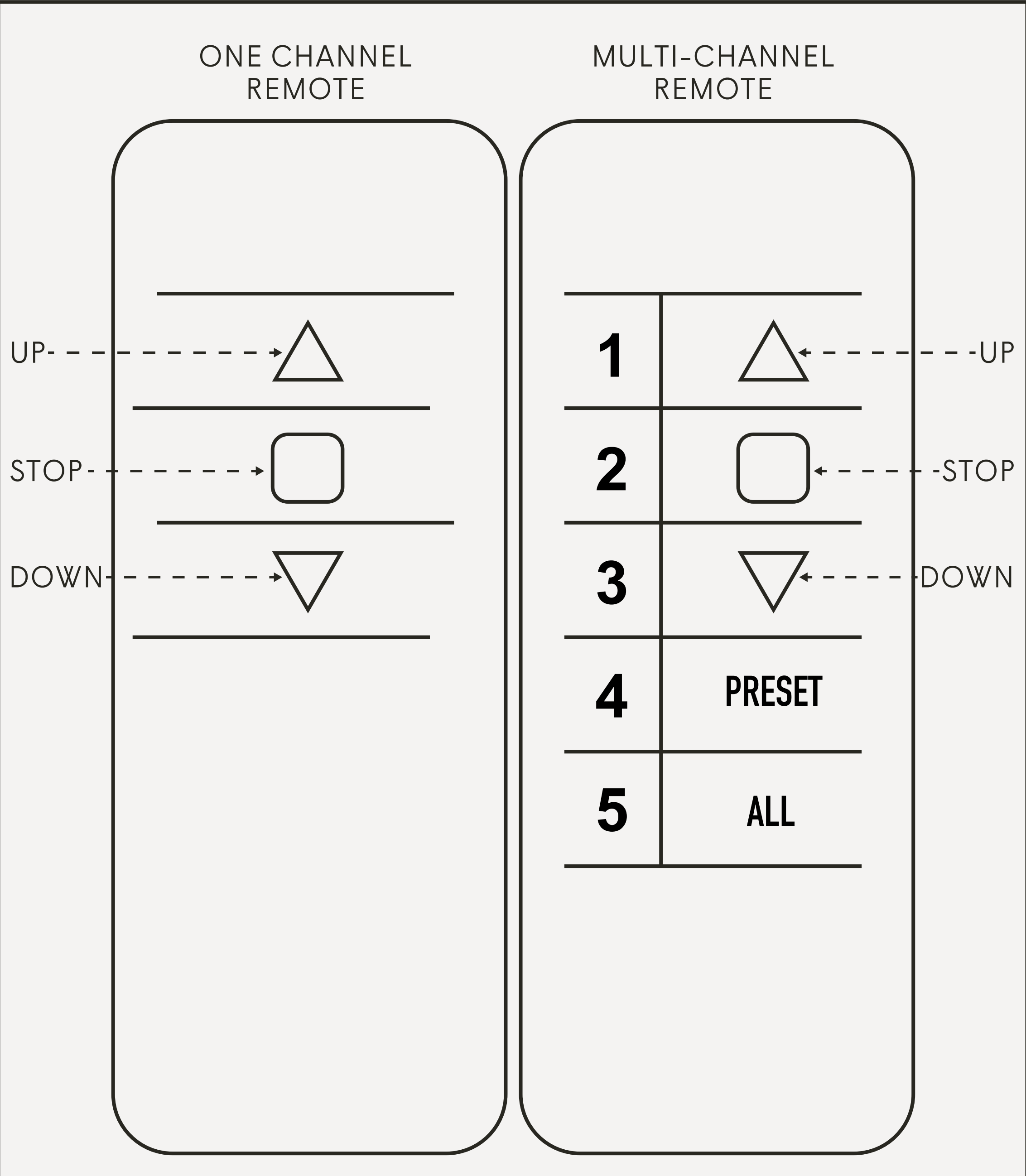

\*Please Note: On a multichannel remote, pushing the “ALL” button will enable all shades programmed to the remote to be operated simultaneously.



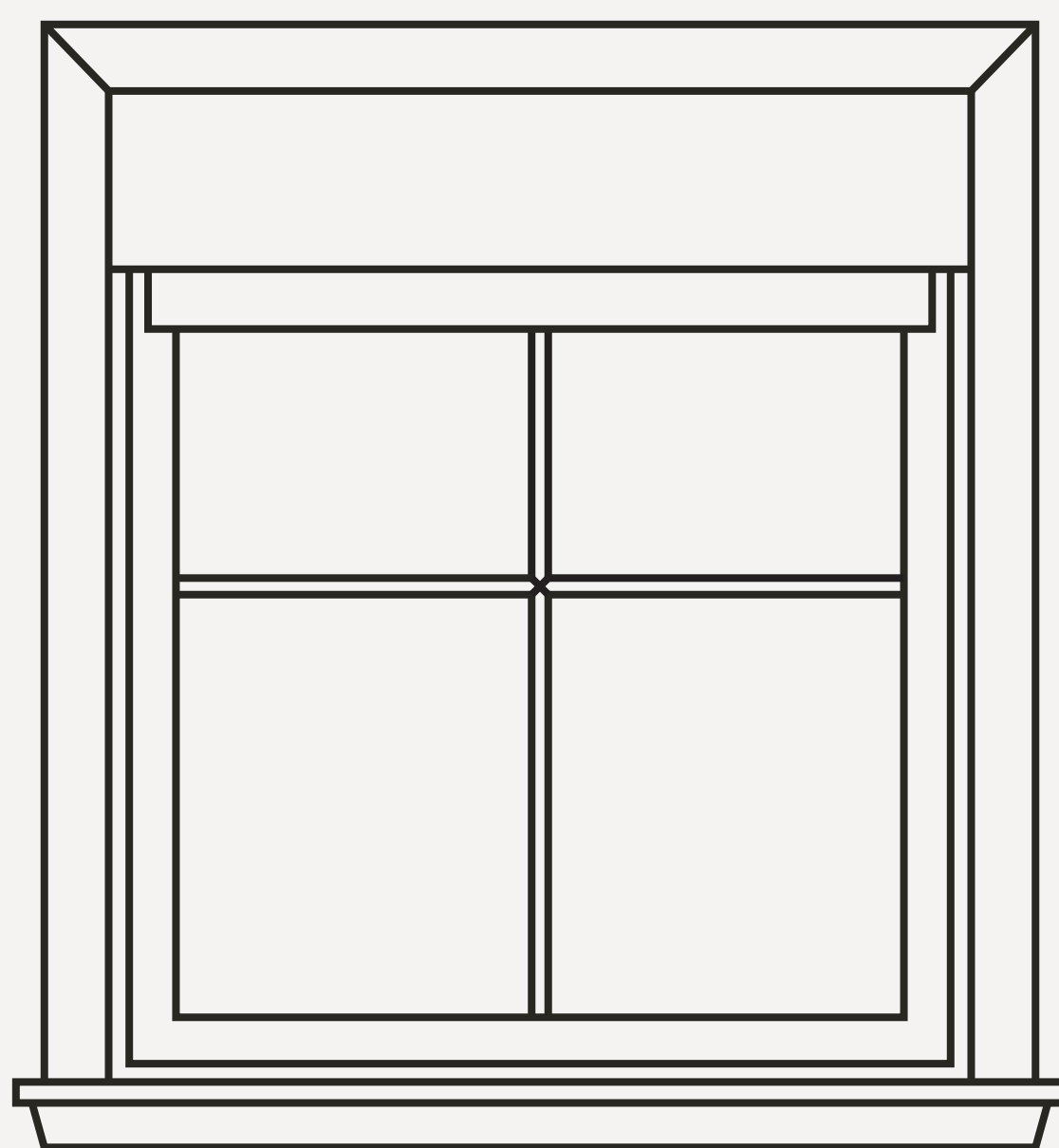

# *You're Done!*

Now your shade is ready for safe usage. Open and close your shade using the pre-programmed remote. Use the UP arrow to open your shade, DOWN arrow to close your shade, or the STOP square to lock your shade in a desired position.

EVERHEM