

How to Scan a Paper Business Card Using the Camera in the CardByte Mobile App

Follow these steps to scan a paper business card directly using the CardByte app's scanner:

- Open the **CardByte Mobile App**.

For Android users, click on the link below:

<https://play.google.com/store/apps/details?id=ai.cardbyte.enterprise>

For Apple users, click on the link below:

<https://apps.apple.com/in/app/cardbyte-enterprise/id1670373750>

- **Log in** to the CardByte mobile app.
- **Go to "My Card"** by clicking on the nav bar.

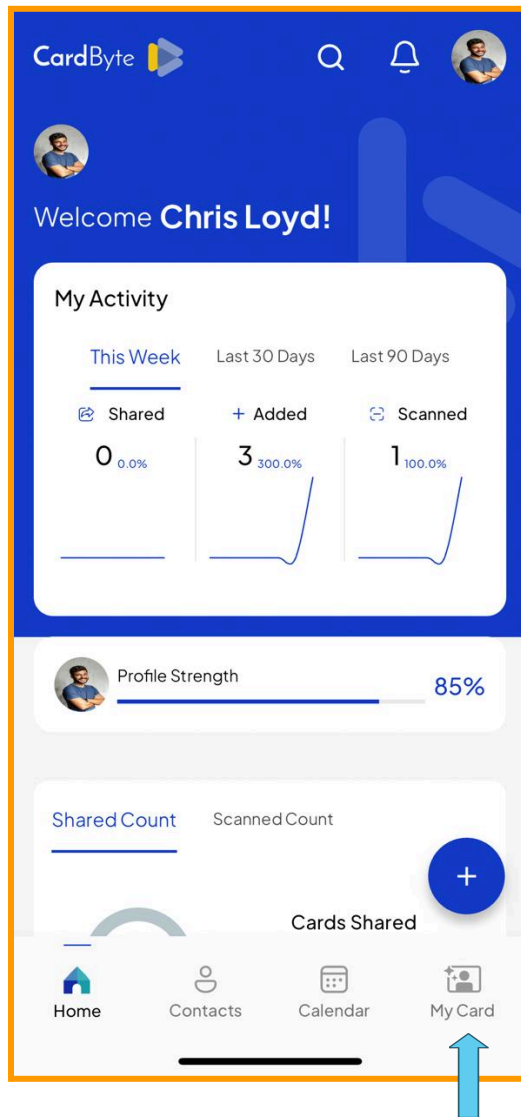

- Select the “**Scan Card**” option.

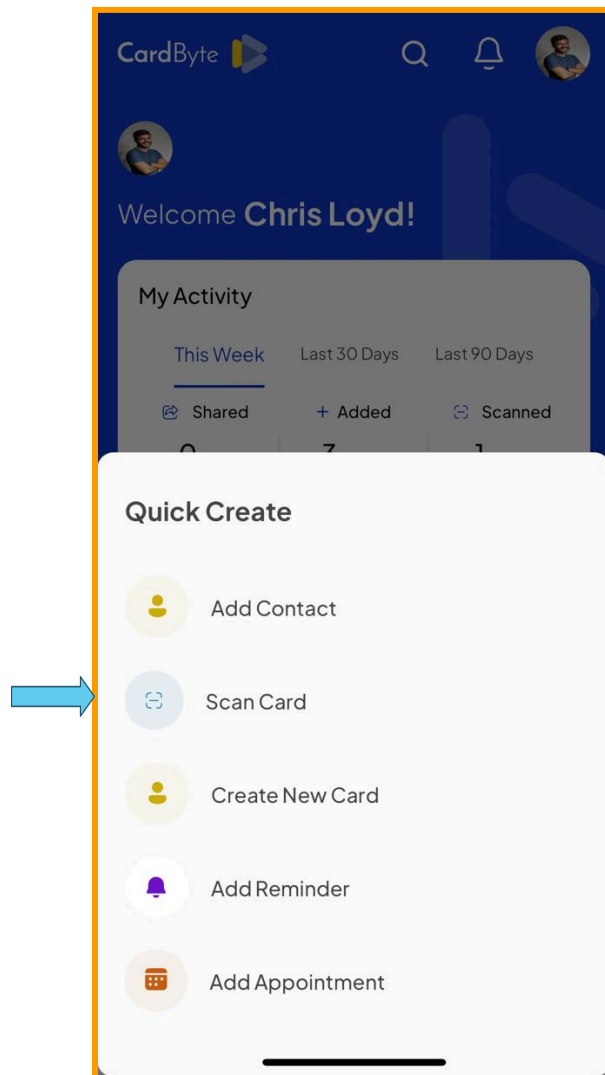

- On the next screen, choose between:
 - Scanning a physical card using your camera, or
 - Uploading a saved business card image from your **Gallery**.
 - (In this guide, we'll focus on **scanning with the camera**.)

- Place the **business card on a flat surface**, ensuring good lighting for clear visibility.
- Use the CardByte app's **scanner** to scan the business card.
- And click on the Circle icon.

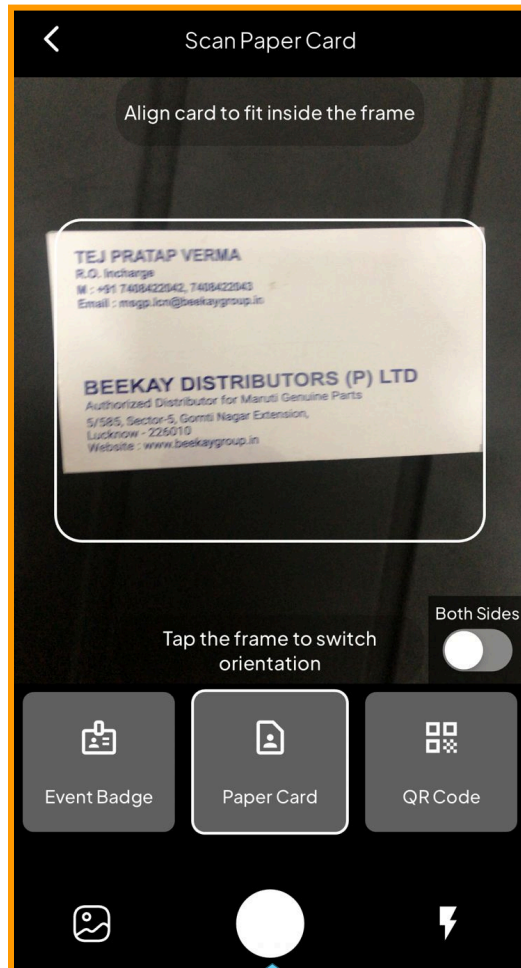

- The app will automatically **extract contact details** from the card, including the card image. If needed, you can **edit or add extra details** before saving.

< Scan Card

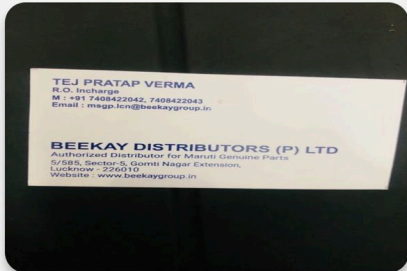

Enter Prefix

TEJ PRATAP

VERMA

+91

7408422042

⊕ ADD

+91

7408422043

✉

msgp.lcn@beekaygroup

⊕ ADD

- Tap “**Save**” to store the contact.

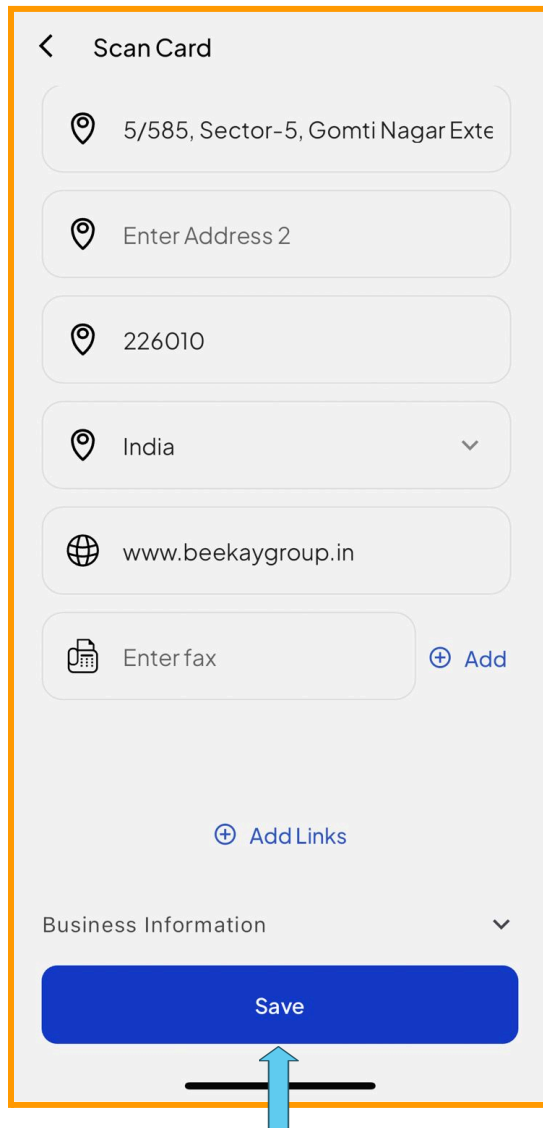

The screenshot shows a mobile application interface for adding a contact. The title is 'Scan Card' with a back arrow. The form includes several input fields: a location field with a pin icon and the text '5/585, Sector-5, Gomti Nagar Ext', an 'Enter Address 2' field, a ZIP code field with '226010', a country dropdown menu showing 'India', a website field with a globe icon and 'www.beekaygroup.in', and a fax field with a fax icon, 'Enter fax', and an 'Add' button. Below these is an 'Add Links' button. A 'Business Information' section is partially visible. At the bottom is a large blue 'Save' button. A blue arrow points upwards to the 'Save' button, indicating the next step.

- A **pop-up will appear**, prompting you to **add tags** (optional).

- Tags help organize contacts into specific groups.
- If you don't want to add a tag, simply tap **Skip**.

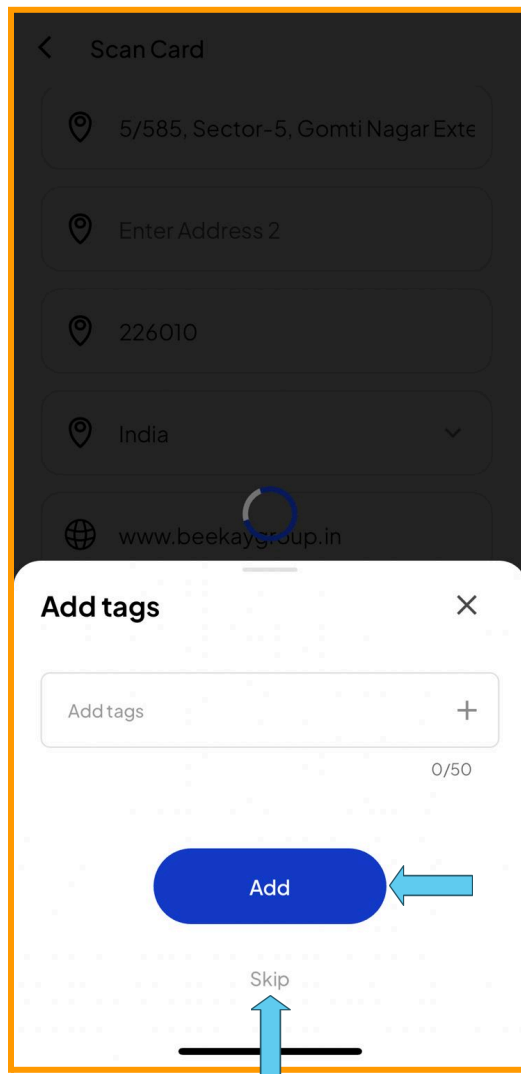

- The scanned contact will now appear under the “**Contacts**” tab, categorized under “**My CardByte**”.

