

# DRX ANSI Grade 1 Mortise Deadbolt Lock with Ligature Resistant Thumb Turn

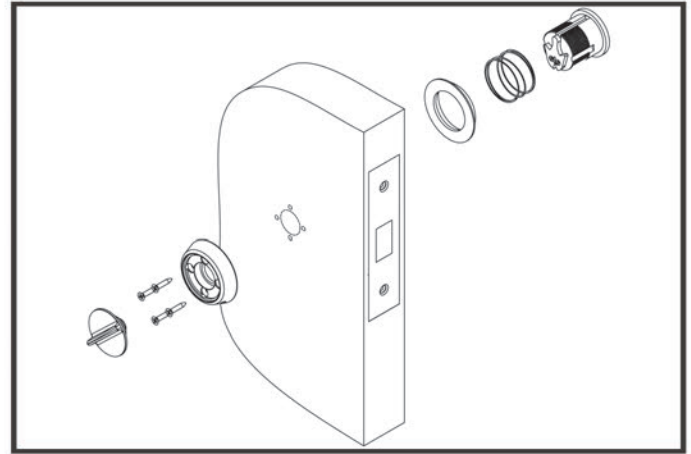

## Specifications

DRX Series- Heavy duty commercial quality deadbolt that provides a positive deterrent to forced entry. The health safety thumb turn design enhances opportunity to reduce accidents in health care facilities, detention centers and potential high risk areas. It is also designed to be an integral part of your Accident Prevention and Safety Program. Schlage C keyway, standard Small Format 6 or 7 pin Interchangeable Core (SFIC) available. 630 (US32D) Finish. Thumb turn, ADA compliant. 10-year limited warranty.

## DRX Functions

ANSI F09		Deadbolt operated by key from inside turn retracts but does not project deadbolt.
ANSI F07		Deadbolt Operated by key from outside and turn from inside.
ANSI F18		Deadbolt operated by turn from one side only, no trim on other side.

## Code Compliance

- ANSI/BHMA: A156.5 Grade 1 Certified
- UL/ULC: UL 10C Listed 3 Hour Fire Rating
- BAA: Meets requirements of the Buy American Act
- ADA: Meets requirements of The Americans with Disabilities Act



## Important Note

It is TownSteel's position that if any of our keyed locks are to be used less cylinder, whether I.C. or standard, and another manufacturer's cylinder is to be used in place of the TownSteel original manufacturer's cylinder, that a sample of that product be provided to TownSteel in advance for testing.

How to Order:	
Trim	DRX Ligature Resistant Mortise Deadbolt Lock
Function	F09 / F07 / F18
Cylinder	SC / SFIC6 / SFIC7 / CLFIC6 / SLFIC

**Example Order: TRX-L-86-SC**