

Profiled

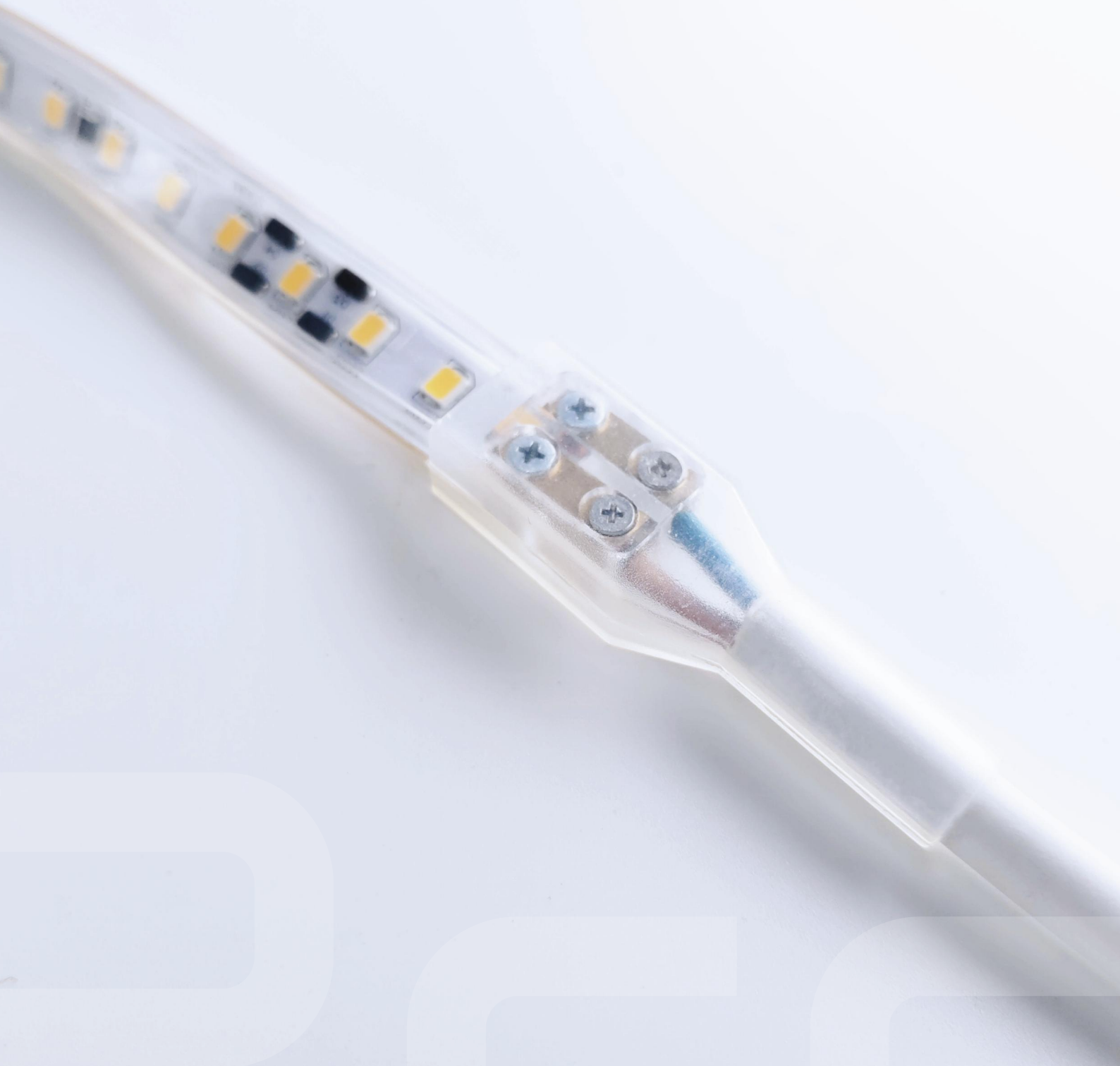

CABLE TO STRIP CONNECTORS

Installation Manual



Driverless.

Endless.

Magical.

ACCESSORIES + TOOLS



TERMINAL BLOCK (12×4mm)

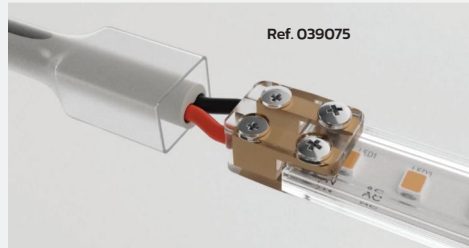

Applicable products

General Series G60/G120/G140
Elevator Series E30/E60

Compatible cables and strips:



Profiled's Strips
12 × 4mm IP65 or IP67



Double-Isolated Cable
Range 2 × 0.5 mm² – 2 × 1.0 mm²

Tools needed:



Screwdriver PH0



Scissors

Connector kit:



1 × Power Cap



1 × End Cap



Terminal block connector
Ref. 039075



2 × Screws M2 × 4.75 mm (Strip)



2 × Screws M2 × 4 (Cable)



RTV Silicone Glue

USER MANUAL

Peel the cable jackets and insert the power cap as indicated.



Insert each cable into the terminal block on the side, and use the screwdriver to apply proper torque to the M2 x 4 mm screws until the cables are tightly fastened.

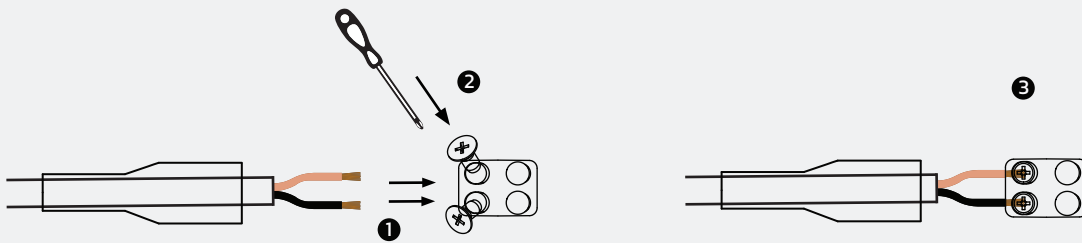

The entire length of the peeled cable must be inside the block.

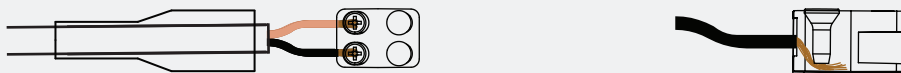

Cut the strip only along the indicated cutting lines.
Strip Max. External dimension must be 12 x 4 mm or 12 x 5 mm (For both IP65 and IP67).

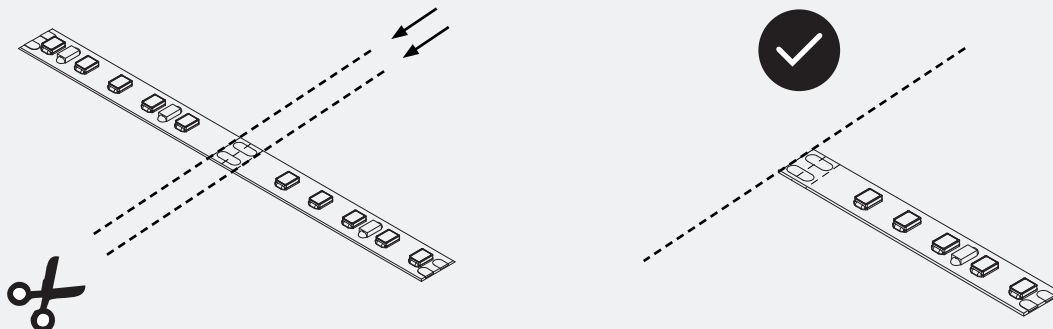

USER MANUAL

Insert the strip into the connector fully, as indicated in the picture (with LEDs facing up).

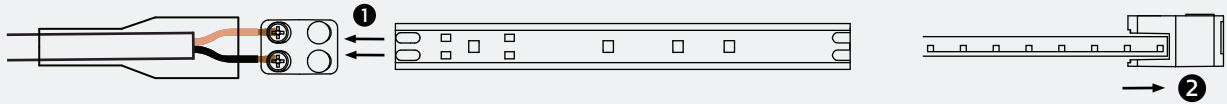

With the strip properly inserted, fasten the M2 × 4.75 mm or M2 × 5.75 mm screws using a PHO screwdriver until fully tightened. The final position of the head of the screw must be inside the connector.

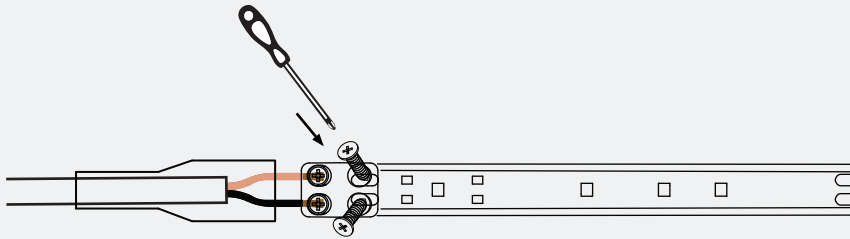

Apply silicone glue inside the silicone cap; at least half of the cavity must be filled.

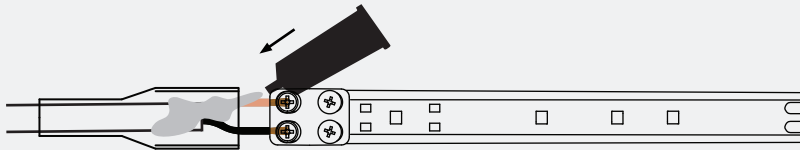

Slide the silicone cap over the connector and remove any excess silicone glue.

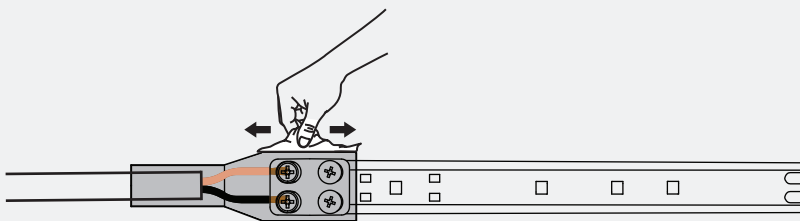

For safety reasons, the end of the strip must be covered with the silicone end cap. Apply sealant and insert the strip into the cap. Note on curing time: **Do not** handle the product within 2 hours after the glue has been applied. The total curing time is 24 hours.

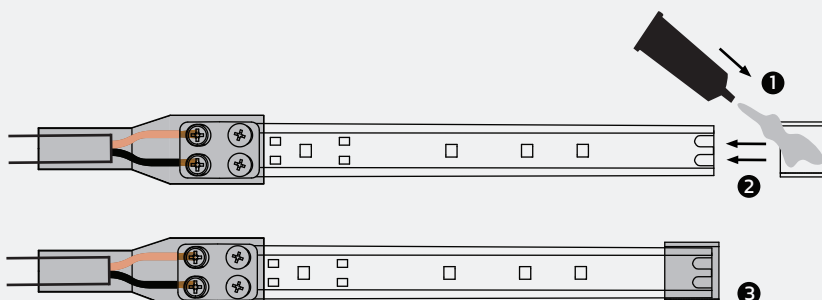

Profiled

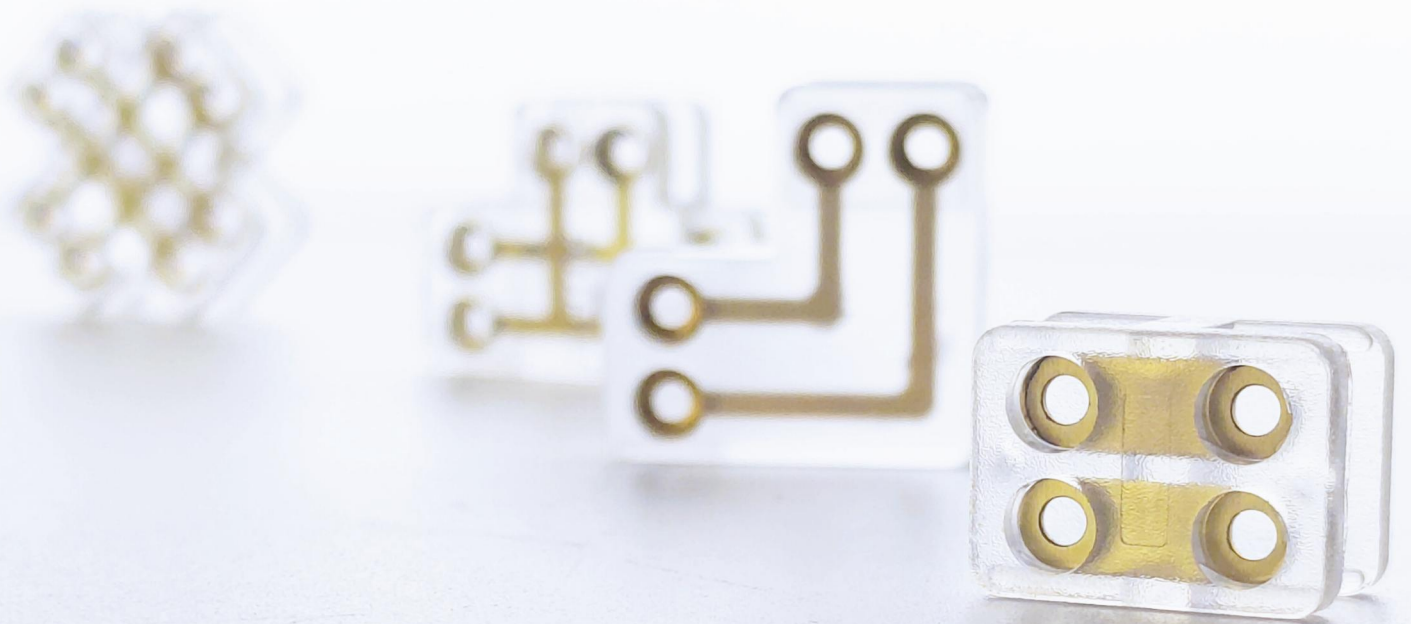

STRIP TO STRIP CONNECTORS

Installation Manual



ACCESSORIES + TOOLS



STRIP TO STRIP CONNECTORS (12 × 4 mm)

Bridge
Ref. 039014



T
Ref. 039015

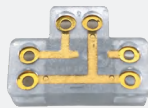

Cross
Ref. 039016



90° Vertical
Ref. 039182



90° Flat
Ref. 039164



Applicable products

General Lighting Series G60/G120/G140
Elevator Lighting Series E30/E60

Compatible cables and strips:



Profled's Strips
12 × 4mm IP65 or IP67



Double-Isolated Cable
Range 2 × 0.5 mm² – 2 × 1 mm²

Tools needed:



Screwdriver PH0



Scissors

Connector kit:



1 × Power Cap



1 × End Cap



Connectors
Ref. 039014/039015
039016/039182/039164



2 × Screws M2 × 4.75 mm (Strip)



RTV Silicone Glue

USER MANUAL

Cut the strip only along the indicated cutting lines.

The strip's maximum external dimensions must be 12×4 mm or 12×5 mm (for both IP65 and IP67).

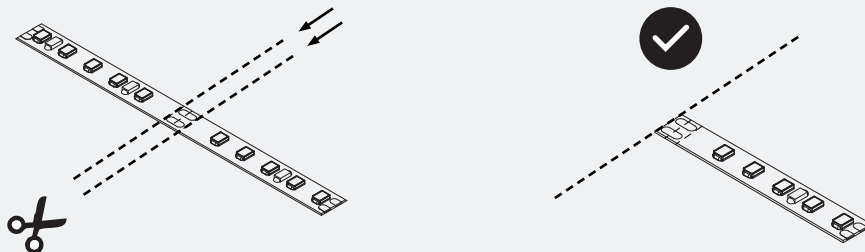

Insert the power cap as indicated.

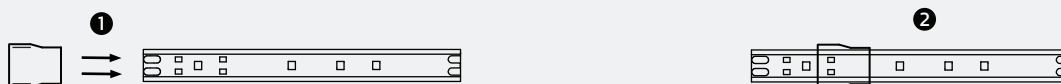

Insert the strip into the connector fully, as shown in the illustration.

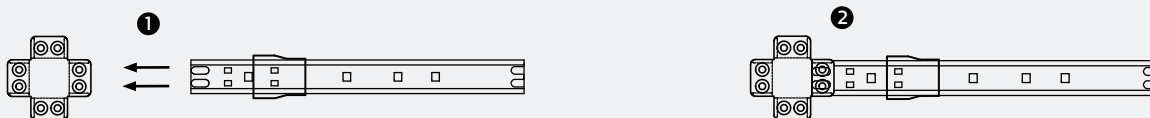

With the strip properly inserted, fasten the $M2 \times 4.75$ mm or $M2 \times 5.75$ mm screws using a PH0 screwdriver until fully tightened.

The final position of the head of the screw must be inside the connector.

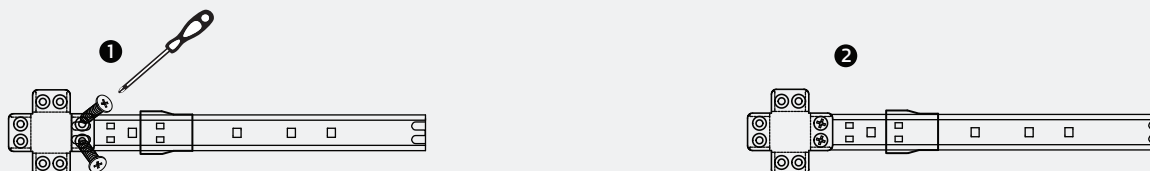

Insert the other strips in the other three ends of connector until the end as indicated.

Then screw the $M2 \times 4.75$ mm or $M2 \times 5.75$ mm screws using a PH0 screwdriver until the limit.

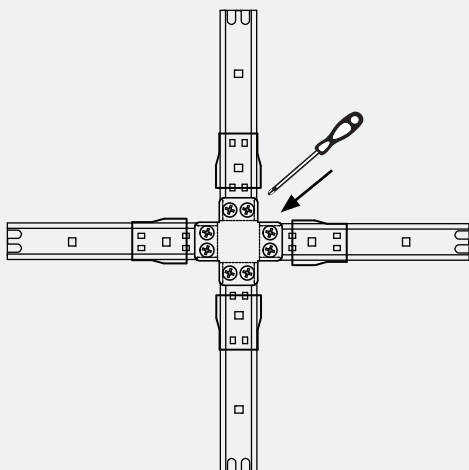

USER MANUAL

Apply silicone glue to the screw to prevent loosening.

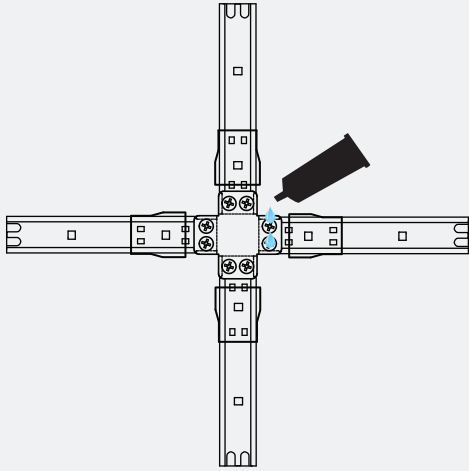

Apply silicone glue inside the power cap; at least half of the cavity must be filled.
Slide the silicone cap over the connector and remove any excess silicone glue.

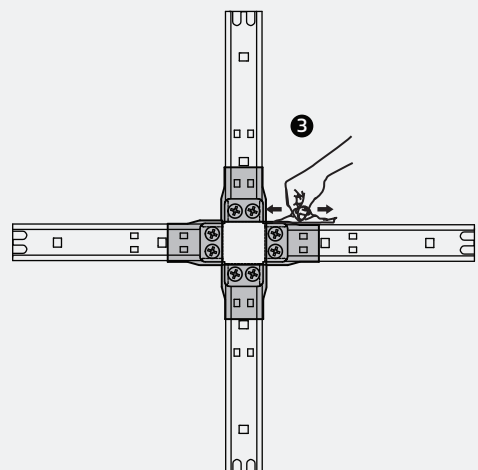
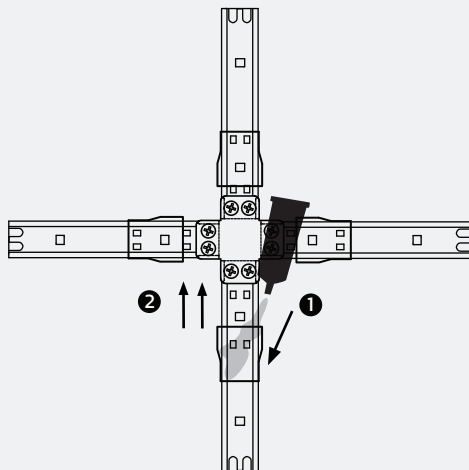

For safety reasons, the end of the strip must be covered with the end cap. Apply sealant, insert the strip into the cap, and remove any excess silicone glue.
Note on curing time: **Do not** handle the product within 2 hours after the glue has been applied. The total curing time is 24 hours.

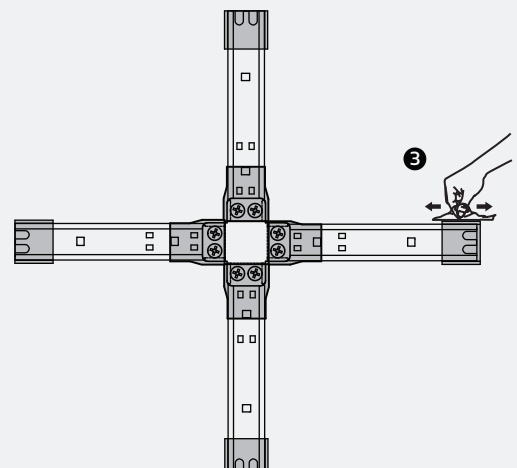
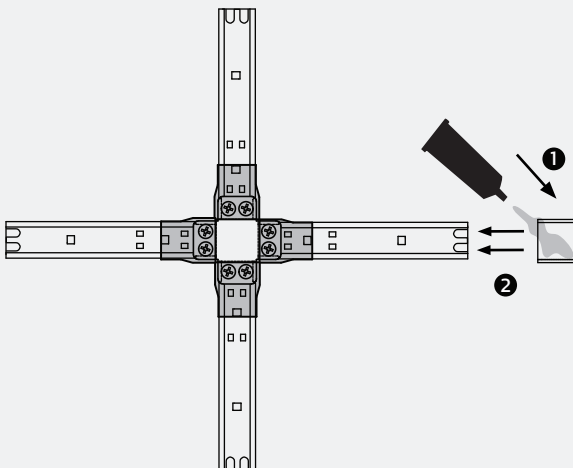

R&D Center

Unit 1901B, 19F, Allied Kajima Building,
138 Gloucester Road,
Wanchai, Hong Kong S.A.R.

Production Facilities

Room 302, 3/F (west side), Building F,
Fuanna Industrial Park, No. 1 Qingning Rd.,
Qinghu Community, Longhua District,
Shenzhen 518109, China.

www.profiled-group.com
info@profiled-group.com
+852 2369 9678



Profiled

www.profiled-group.com