



crean | EST
1968
CONTRACT FLOORING & TILING

Company Profile

Over 50 Years of Industry Experience

Established in 1968 and now with over 50 years of industry experience we believe we are very well positioned to help and assist our Clients to deliver a best-in-class project.

We also believe that through hard work, and by constantly pursuing high standards, we can make this company the very best in its sector. It is this positive attitude that has made Creaan a premier Flooring & Tiling contractor. We continually aspire to be our Client's contractor of choice.

Our Vision

To be the construction industry's Flooring and Tiling contractor of choice.



Our Clients

Crean successfully delivers more than 250 contract Flooring and Tiling projects per year for diverse client base in Ireland and UK. We believe our Clients are also our partners, we engage early. First, we help our Clients so that in turn our Client can help us. We believe in being proactive not reactive. Through this philosophy trust is built, relationships are strengthened and mutually beneficial results are achieved.

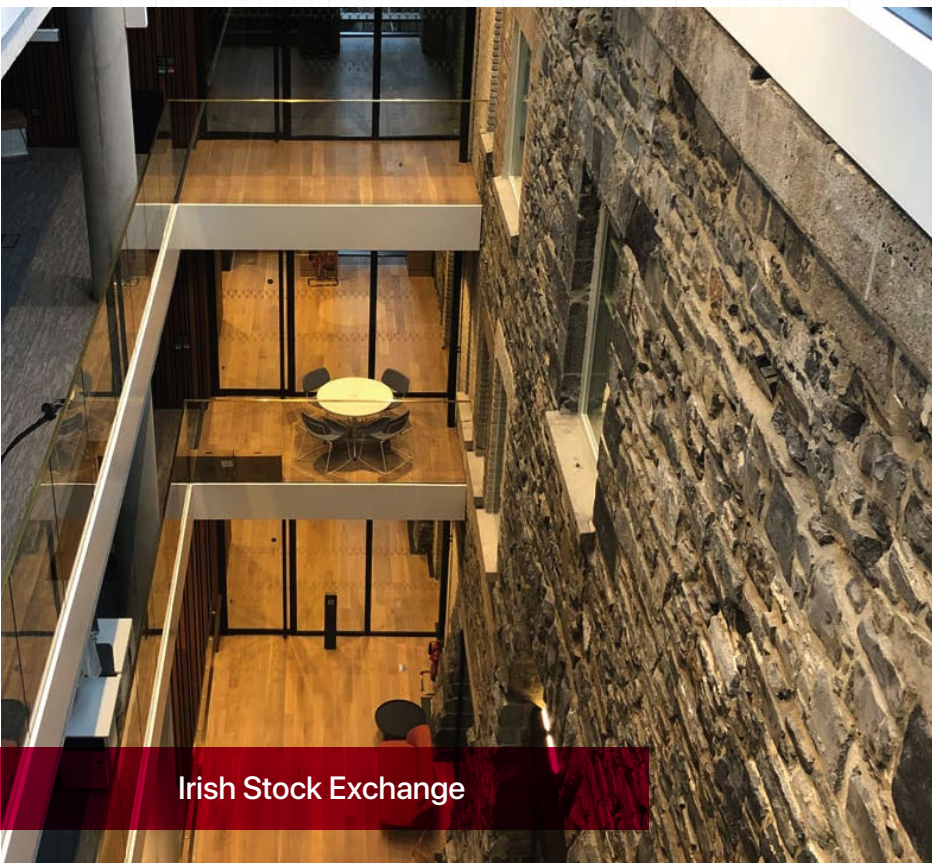

Irish Stock Exchange



Adare Manor

Internationally Recognised ISO Accreditations

We are extremely proud to have received the following ISO accreditations. This internationally recognised standard will help us deliver class leading service and product to our customers. We are Irelands first Flooring and Tiling company to be awarded three ISO accreditations.

ISO Accreditations

- ISO 9001 Quality Management
- ISO 14001 Environmental Management
- ISO 45001 Health & Safety Management

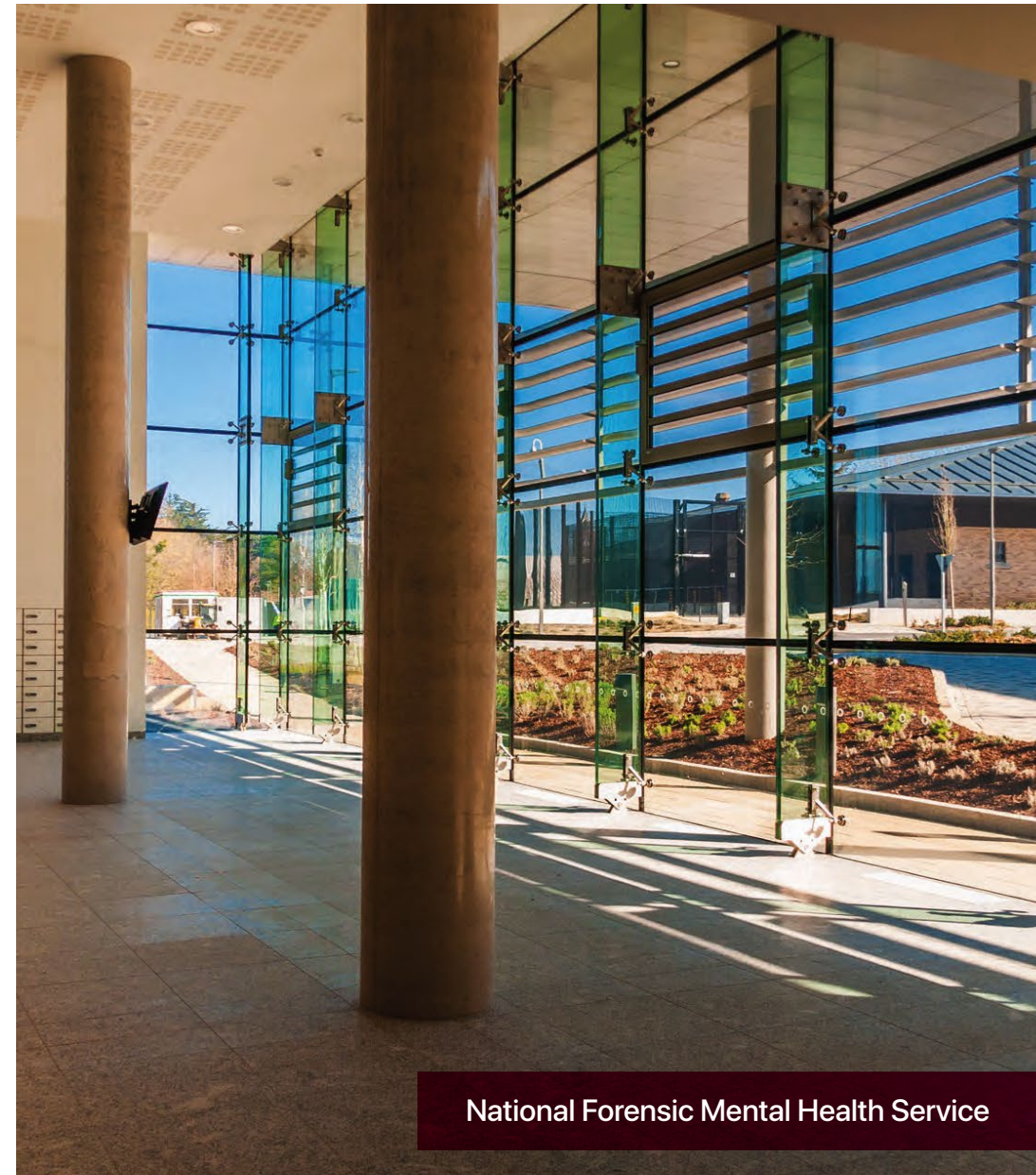

National Forensic Mental Health Service

Crean **Supply & Install** a wide product range:

A close-up photograph of a dark grey, textured carpet surface.

Carpets

A photograph of a light brown linoleum floor with a wood-grain pattern.

Linoleum

A photograph of a dark brown timber floor with a wood-grain pattern.

**Timber
Flooring**

A photograph of a red rubber floor with white curved lines, typical of a sports court.

**Rubber
Flooring**

A close-up photograph of a black safety floor mat with a raised, triangular pattern.

**Safety
Flooring**

A photograph of a grey tiled floor with a diamond pattern.

Tiles

A photograph of a dark grey vinyl floor with a wood-grain pattern.

**Vinyl
Flooring**

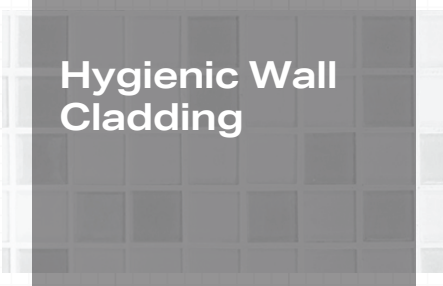
A photograph of a grey wall cladding with a square pattern.

**Hygienic Wall
Cladding**

A photograph of a blue floor preparation surface with a textured, pebbled appearance.

**Floor
Preparation**

A close-up photograph of a dark grey, textured entrance matting.

**Entrance
Matting**

A photograph of a sports floor with orange and blue line markings.

**Sports Floors &
Line Marking**

A photograph of various floor accessories and profiles, including a metal strip and a wooden plank.

**Accessories
& Profiles**



Supply Chain

Our supply chain and who we partner with is an integral part of what we offer our Clients. To us it's imperative that we only partner with best-in-class sustainable suppliers with world class sustainable products, this is inherent in our DNA.

A sustainable supply chain also helps improve productivity while saving money at the same time. By using sustainable techniques and resources, you increase efficiency and reduce cost.

We trust all our suppliers so when we say we deliver our client knows we will deliver a quality and sustainable product plus a reliable before and after sales service. This can only be delivered to our Clients when we partner with the very best.

Our Mission

Since 1968, we have been committed in the pursuit of delivering excellence in the provision of floor and wall finishes, to the residential and commercial construction industry in Ireland and the UK.

We will continue to build sustainable relationships with our Clients, suppliers and employees. We will achieve this through respect and trust so that we can nurture mutually beneficial outcomes for all vested partners.

Relevant Experience

The company presently delivers in excess of 200 projects per year across a range of different commercial sectors:

Commercial



Information Technology



Health



Pharmaceutical



Tourism/Leisure



Education



Retail



Residential

Lansdowne Place | Capital Docks | Bolands Quay Towers | Ayrfield Housing | Cardiff Lane Development | St Clares

Sustainability

Sustainability encapsulates every single aspect of our business, and it has done so since the company was founded. It is for good reason sustainability is also referenced in terms of our Clients & Supply Chain.

Businesses that are not sustainable don't survive or grow; our longevity & continued growth through good times & bad is testament to this & our people.

In recent times with thanks to the continued vision & innovation of our Management team, our accreditation for ISO has taken sustainability within our company to another level in terms of our interaction with our Staff, Clients & Supply Chain.

We particularly see ISO 9001 & 14001 accreditation as a further advancement of our already core principle of sustainability for the procurement & installation of environmentally responsible materials in collaboration with our Mutual Partners.

Current Key Projects

Client	Main Contractor	Sector	Value
Bon Secours Hospital, Limerick	John Sisk & Son (Holdings) Ltd	Healthcare	€2,800,000.00
O'Devaney Gardens - Phase 1 & 2, Dublin	John Sisk & Son (Holdings) Ltd	Residential	€2,450,000.00
UCD Future Science, Dublin	BAM Ireland	Education	€1,825,000.00
Glass Bottle - Phase 1A, Dublin	John Sisk & Son (Holdings) Ltd	Residential	€1,800,000.00
Oscar Traynor Apartments, Dublin	Glenveagh	Residential	€1,700,000.00
Castleforbes Residential Development, Dublin	John Paul Construction	Residential	€1,500,000.00
Rathborne Apartments, Dublin	Walls Construction Ltd	Residential	€1,350,000.00
2 Grand Canal Quay, Dublin	John Sisk & Son (Holdings) Ltd	Commercial	€1,250,000.00
Central Hotel, Dublin	Duggan Brothers (Contractors) Ltd	Hospitality	€1,200,000.00
Letterkenny Community Nursing Unit, Co. Donegal	Boyle Construction	Healthcare	€1,100,000.00
Sea Gardens Apartments, Bray / 5 - 9 South Frederick Street Offices, Dublin	Ballymore	Residential/Commercial	€850,000.00
Waterford & Limerick Sugical Hubs	JJ Rhatigan & Company	Healthcare	€800,000.00
Presentation Secondary School, Kilkenny / St. Finian's, Mullingar (Project Nore)	JJ Rhatigan & Company	Education	€780,000.00
Dorset Street Residential, Dublin	Duggan Brothers (Contractors) Ltd	Residential	€785,000.00
Kylemore Residential, Killiney, Co. Dublin	Vardis	Residential	€700,000.00
Ennistymon Educational Campus, Co. Clare	Kilcawley	Education	€675,000.00
Rosslare Europort, Co. Wexford	John Paul Construction	Industrial & Logistics	€600,000.00
Greenside Building, Cuffe Street / St. Finbar's Road Cabra, Dublin	Townlink	Residential/Commercial	€500,000.00
Nexus Logistics Park - Units 4 & 8 / Airport Trade Park, Dublin	TLS Projects	Industrial & Logistics	€485,000.00
College Square Residential, Dublin	Walls Construction Ltd	Residential	€450,000.00
Brownsbarn Apartments, Dublin	Glenveagh	Residential	€450,000.00

Recent Projects Completed

Client	Main Contractor	Sector	Value
Coopers Cross Mixed Use Development, Dublin	John Sisk & Son (Holdings) Ltd	Commercial & Residential	€3,900,000.00
8th Lock Residential Development, Dublin	Ballymore	Residential	€2,250,000.00
Wilton Park, Blocks 1, 2, 3 & 4, Dublin	John Sisk & Son (Holdings) Ltd	Commercial	€2,150,000.00
Fibonacci Square, Ballsbridge (Facebook HQ), Dublin	John Sisk & Son (Holdings) Ltd	Commercial	€1,600,000.00
Cardiff Lane Mixed Use Development, Dublin	Walls Construction Ltd	Commercial	€1,500,000.00
Charlemont Square, Blocks 1 & 2, Dublin	JJ Rhatigan & Company	Commercial	€1,350,000.00
Bolands Quay, Mixed Use Development (incl Bolands Mills Fit-Out)	BAM Ireland	Commercial & Fit-Out	€1,200,000.00
Limerick Prison	P.J. Hegarty & Sons	Commercial	€1,100,000.00
ESB Headquarters, Fitzwilliam Street, Dublin	P.J. Hegarty & Sons	Commercial	€1,050,000.00
Sandyford Central Residential, Dublin	John Paul Construction	Residential	€950,000.00
Rialto PCC/North Clondalkin Library/Spencer Hotel/Bluebell Avenue Residential	Townlink Construction Ltd	Healthcare/Commercial/Hospitality/Residential	€815,000.00
Navan Shopping Centre, Meath	Graham Construction (NI)	Retail	€800,000.00
Scoil An Athar Tadhg & Scoil Mhuire Gan Smál, Cork	MMD Construction	Education	€725,000.00
IADT Dun Laoghaire & TUD, Blanchardstown	JJ Rhatigan & Company	Education	€700,000.00
Dorset Street Hotel, Dublin	Duggan Brothers (Contractors) Ltd	Hospitality	€700,000.00
Horgans Quay Pods	Modern Homes Ireland	Offsite Modular	€685,000.00
St. Luke's General Hospital, Kilkenny	ESS Modular	Healthcare	€650,000.00
Integer New Ross	David Flynn Ltd	Pharmaceutical	€625,000.00
The Sidings Office Development, Grand Canal Quay	Collen Construction Ltd	Commercial	€600,000.00
Adare Manor Leisure Facility, Limerick	John Paul Construction	Hospitality	€600,000.00
WeWork Fit-Out, Central Plaza, Dublin	TSK Group (UK)	Fit-Out	€525,000.00

Older Projects Completed

Client	Main Contractor	Sector	Value
Capital Docks Mixed Use Development, Dublin (including JP Morgan Fit-Out)	John Sisk & Son (Holdings) Ltd	Commercial, Residential & Fit-Out	€ 4,000,000.00
Wyeth Medica, Dublin	P.J. Hegarty & Sons	Pharmaceutical	€ 3,300,000.00
Lansdowne Place Luxury Residential Development, Ballsbridge, Dublin	JJ Rhatigan & Company	Residential	€ 3,300,000.00
Central Bank of Ireland HQ, Dublin	Walls Construction Ltd	Commercial	€ 2,350,000.00
Eircom HQ	Pierse Contracting	Commercial	€ 2,250,000.00
PwC (PricewaterhouseCoopers), Dublin	John Sisk & Son (Holdings) Ltd	Commercial	€ 1,800,000.00
Intel, Leixlip	P.J. Hegarty & Sons	Technology	€ 1,500,000.00
Portlaoise Prison	Laing O' Rourke	Commercial	€ 1,400,000.00
6 Hanover Quay & Donnybrook Gardens Residential Developments, Dublin	Cairn Homes PLC	Commercial	€ 1,400,000.00
Fernbank Residential Development, Dundrum, Dublin	Direct c/o Irish Life Investments Managers	Residential	€ 1,150,000.00
Miesian Plaza Office Development, Dublin (including Shire Fit-Out)	John Paul Construction	Commercial & Fit-Out	€ 1,100,000.00
Xerox	John Sisk & Son (Holdings) Ltd	Commercial	€ 1,200,000.00
Phoenix Park Residential Development	Flynn O'Flaherty	Residential	€ 1,100,000.00
Shannon Airport	P.J. Hegarty & Sons	Commercial	€ 1,100,000.00
Ulster Bank RBS, HQ	Ardmac	Commercial	€ 1,100,000.00
St Vincent's Hospital	John Paul Construction	Healthcare	€ 1,000,000.00
Wheatfield Prison	John Sisk & Son (Holdings) Ltd	Commercial	€ 950,000.00
Radisson Blu Royal Hotel, Golden Lane, Dublin	JJ Rhatigan & Company	Hospitality	€ 900,000.00
Robswall Housing & Apartments, Malahide, Co. Dublin	Hollybrook Homes	Residential	€ 850,000.00
The Aviva Stadium	John Sisk & Son (Holdings) Ltd	Hospitality	€ 800,000.00
One South County Office Development, Leopardstown, Dublin	Collen Construction Ltd	Commercial	€ 830,000.00
LinkedIn EMEA HQ, Dublin	Walls Construction Ltd	Fit-Out	€ 675,000.00
National Indoor Arena, Dublin	Heron Buckingham JV	Leisure & Recreational	€ 650,000.00
Castlebar Swimming Complex, Co. Mayo	PJ McLoughlin & Sons Ltd	Leisure & Recreational	€ 635,000.00

Crean Group

Organisation and Support Structure





crean EST 1968
CONTRACT FLOORING & TILING

Alan Crean
Executive Chairman

Brian Ruane
Managing Director

David Cunningham
Director

Tony Waters
Contracts Director

Jason Carey
Financial Director

Seán Markham *MSCSI MRICS*
Associate Director - Commercial

Richard Quinn
Associate Director - Surveying

SALES/ESTIMATING DEPARTMENT

Quantity Surveyor/Estimator & ISO
IMS Lead

Quantity Surveyor/Estimator

Trainee Quantity Surveyor/Estimator

Sales Estimator

QUANTITY SURVEYING DEPARTMENT

Senior Quantity Surveyor

Quantity Surveyor

Quantity Surveyor

Quantity Surveyor

WAREHOUSE DISTRIBUTION

Mayo

Dublin

CONTRACTS MANAGEMENT

Senior Contracts Manager

Contracts Manager

Contracts Manager

Contracts Manager

Contracts Manager

Contracts Manager

Contracts Manager

Contracts Manager

ACCOUNTS DEPARTMENT

Credit Control/ Health & Safety

Payroll

Accounts Payable

Accounts Payable Administrator



ceramic city

TILES & BATHROOMS

Retail, Wholesale & National Distribution

Alan Crean

Executive Chairman

Declan Glynn

Director

CERAMIC CITY CHARLESTOWN

Retail Sales

Accounts Assistant

CERAMIC CITY SLIGO

Retail Sales

Retail Sales

CERAMIC CITY CASTLEBAR

Manager

Retail Sales

Retail Sales

Retail Sales

Retail Sales

Retail Sales

CERAMIC CITY WHOLESALE & NATIONAL DISTRIBUTION

Sales Account Manager

Sales Account Manager

Warehouse & Distribution Manager

RETAIL, WHOLESALE & NATIONAL WAREHOUSE DISTRIBUTION



UK Office

Alan Crean
Managing Director

Brian Ruane
Director

ADMIN/ESTIMATING DEPARTMENT

Senior Estimator

Estimating Admin/ Document
Controller

Estimating Admin

Pre-Qualification

QUANTITY SURVEYING DEPARTMENT

Commercial Director

Senior Quantity Surveyor

DATA MANAGEMENT

Commercial Director

CONTRACTS MANAGEMENT DEPARTMENT

Contracts Director

Contracts Manager

Contracts Manager

HEALTH & SAFETY

Contracts Director

ACCOUNTS DEPARTMENT

Financial Controller

Payroll

Accounts

CREDIT CONTROL

**HEAD OFFICE**

The Square,
Charlestown
Co Mayo
F12 PW62

+353 94 925 4274
info@crean.ie

DUBLIN OFFICE

Unit 298,
Blanchardstown
Corp. Park 2,
Dublin 15
D15 XR25

+353 94 925 4274
info@crean.ie

LONDON OFFICE

Unit 25
Bates Industrial Estate
Church Road
Harold Wood
RM3 0HU

+44 (0)1708 375510
info@crean.co.uk

**CASTLEBAR**

Moneen Industrial Estate
Castlebar
Co Mayo
F23 XP99

+353 94 902 4250
info@ceramiccity.ie

SLIGO

Ballast Quay
Sligo
Co Sligo
F91 XYV9

+353 71 916 0978
info@ceramiccity.ie

CHARLESTOWN

The Square
Charlestown
Co. Mayo
F12 PW62

+353 94 925 4274
info@ceramiccity.ie