

# SUSPENDED MOUNTING CLIP + ROD

## Without Wires: Installation

### STEP 1:

Mark the installation position of clevis on the ceiling with sufficient load-carrying capacity.

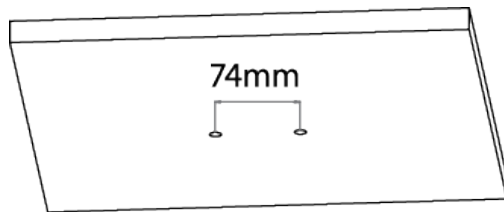

### STEP 2:

Tighten the clevis by screws.

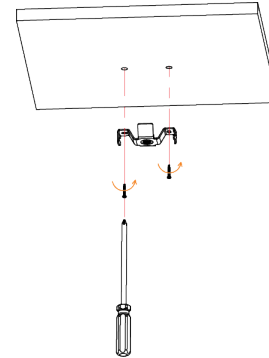

### STEP 3:

Assemble the mounting flange and the rods in order of 1, 2, and 3.

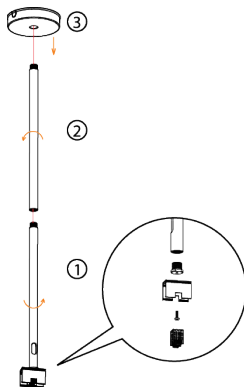

### STEP 4:

Rotate and fasten them clockwise.

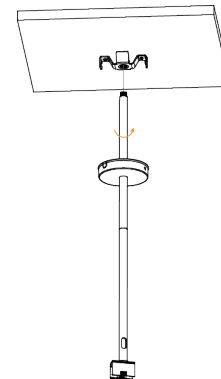

### STEP 5:

Shield the clevis by the mounting flange and rotate anticlockwise until it clicks into place.

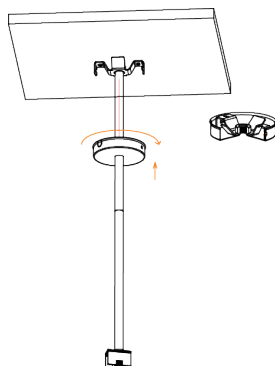

### STEP 6:

Adjust the clip to the angle you need (max. 180° in a clockwise direction).

