

S270

Stainless Steel Profile - Clip



It uses grade 316 stainless steel with excellent property of deformation and rust resistance. The material makes it suitable for humid coastal surroundings and weak acid-base industrial environments that other mounting profiles can't accommodate. The structural design and material characteristics collectively ensure a tight clamping force. It's very convenient and reliable even for suspended installation in the curve shape. Please refer to general installation manual for proper installation practices.



ORDER CODE

MOUNTING PROFILE TYPE	STANDARD LENGTH	PROFILE	COLOR
S1 = Stainless Steel Clips	2 = 1.38in (35mm)	D = S270	1 = Standard

DIMENSIONS

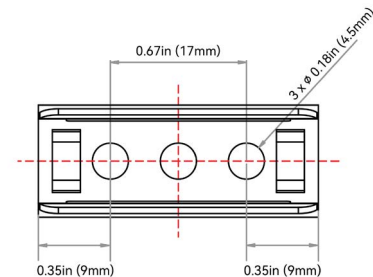
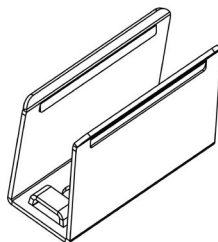
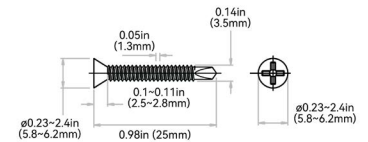
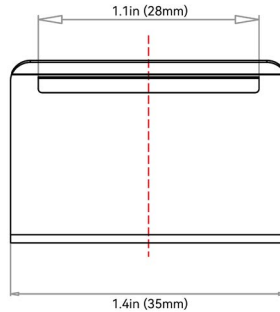
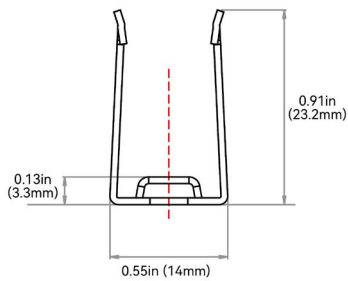

ORDER CODE	LEGACY ORDER CODE	STANDARD LENGTH	SLOTTED HOLE	HOLE #
S1-2-D-1	CL11RSS3C5SD	1.38in (35mm)	ø 0.18in (4.5mm)	3