

EC-3

EBI BOTTLE COOLER/ CHEST BOTTLE COOLER SERIES



EC-3

GENERAL CHARACTERISTICS

EC-3

- Exterior and interior in white plastic-coated steel
- COMMON FEATURES
- Designed for beverages and packaged products
- Shelves made of plastic-coated steel wire, adjustable in height
- High starting torque hermetic compressor
- Ventilated evaporator printed on aluminium plate
- Digital temperature control and defrosting
- Vertical LED interior lighting
- Ventilated condensing unit
- Injected polyurethane insulation, CFC free, density 40 Kg/m³
- Automatic evaporation of defrost water
- Working temperature K1(0+7°C), climatic class CC2(32°C 65%R.H.), according to EN16902
- Single-phase voltage 230V 50/60 Hz
- Refrigerant R-600a

GENERAL FEATURES

EC-3

- Exterior and interior in white plastic coated steel
- FEATURES IN COMMON
- Designed for beverages and packaged products
- Shelves plastic coated steel wire, adjustable height
- Hermetic compressor high starting torque
- Ventilated evaporator printed on aluminium plate
- Digital temperature control and defrost
- Interior lighting vertical LED
- Ventilated condensing unit
- Insulation: Polyurethane, without CFCs, density 40 Kg / m³
- Automatic evaporation of defrost water
- Working temperature K1 (0+ 7°C), climatic class CC2 (32°C 65% R.H.), according to EN16902
- Voltage 230V 50/60 Hz
- Refrigerant R-600a

Technical and constructive characteristics subject to variation without prior notice, all photos should be considered as a reference.

EC-3

EBI BOTTLE COOLER/ CHEST BOTTLE COOLER SERIES

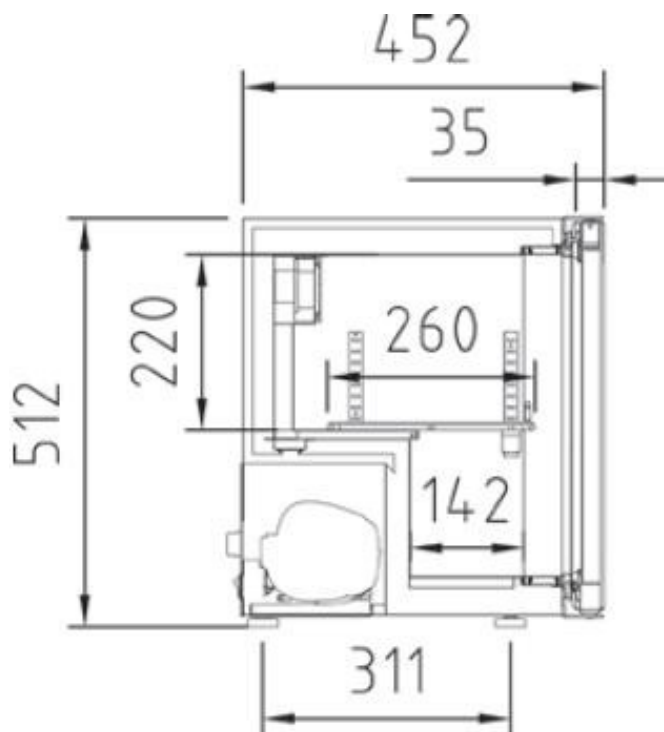

	➔	⬆	↙	☐	🗄	🗄	❄	⚡	📦	📚
Modelo Model Modèle	Largo Length Longueur (mm)	Alto Height Hauteur (mm)	Fondo Depth Profondeur (mm)	Pantalla pulicidad Canopy Marquise	Facings lata 33cl 33 cl Facings 33 cl Facings (uds.)	Capacidad lata 33cl 33cl can capacity Capacité 33cl boîtes (uds.)	Potencia frig. Frig. Power Puissance frig. (W)	Consumo Nominal Nominal Consumption Consommation Nominale (W)	Capacidad Capacity Exposition L	Estantes Shelves Étagères
EC-3	415	512	462	NO	4	24	142	85	38	1+1

Technical and constructive characteristics subject to variation without prior notice, all photos should be considered as a reference.