

LUMIFORM FLEXIBLE

Installation Manual

Discover the innovative design of our on-site fully adaptable spec-grade Orbit LS in-ground fixtures. Engineered for easy installation, maintenance and highlighted by their multi-directional bending capabilities, along with high quality silicone composition. When the Orbit LS fixture is packaged together with our in-ground stainless steel flexible mounting system it creates our LumiForm Orbit LS - flexible In-ground system.

DIMENSIONS & COMPONENTS

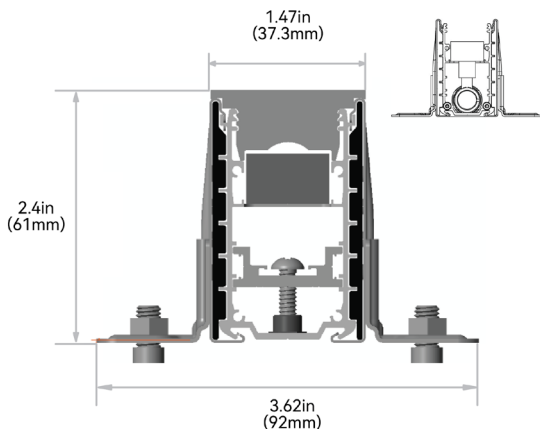
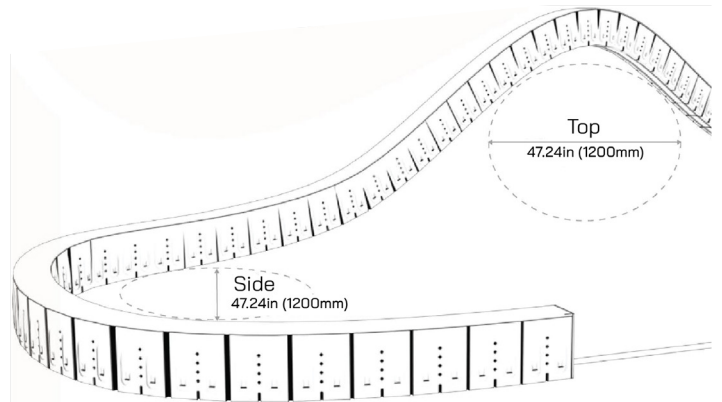
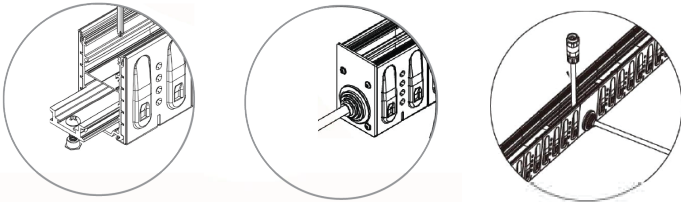

Tolerance: ± 0.01 in (0.3mm)

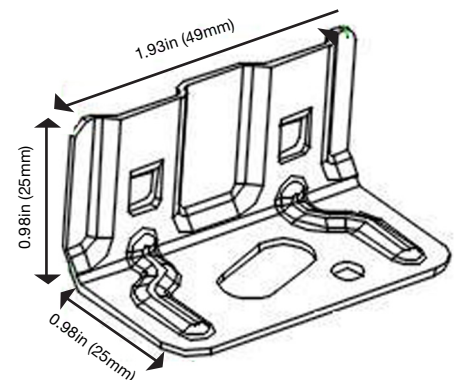

Mounting Bracket

Installation

STEP 1:

Trench Layout

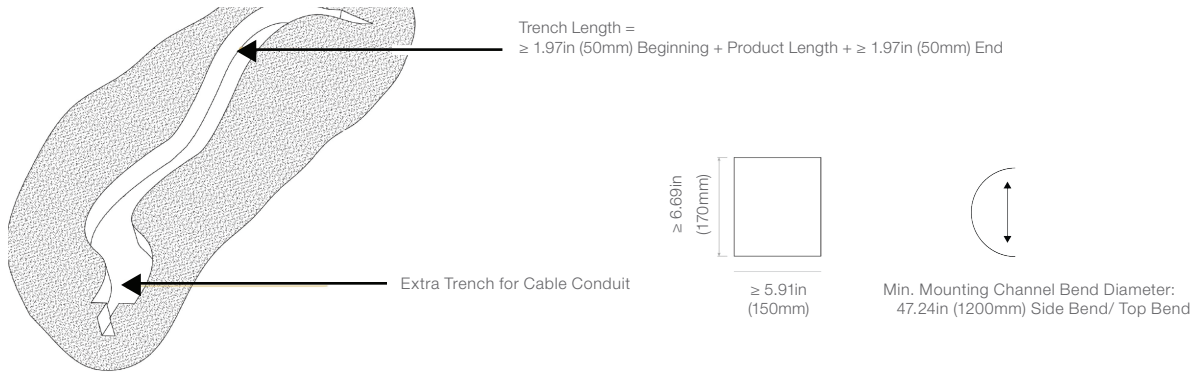

STEP 2:

Drainage layer construction

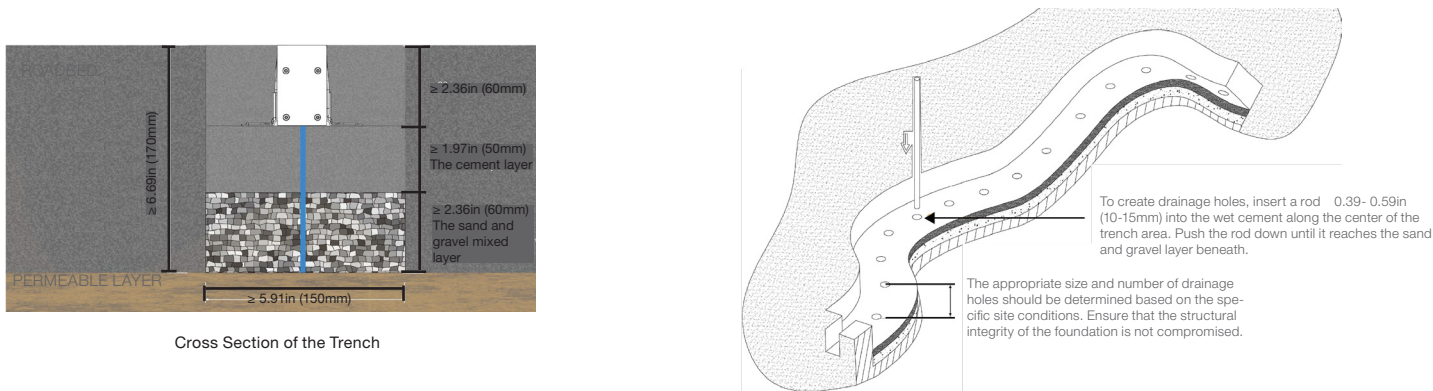

STEP 3:

Profile joining

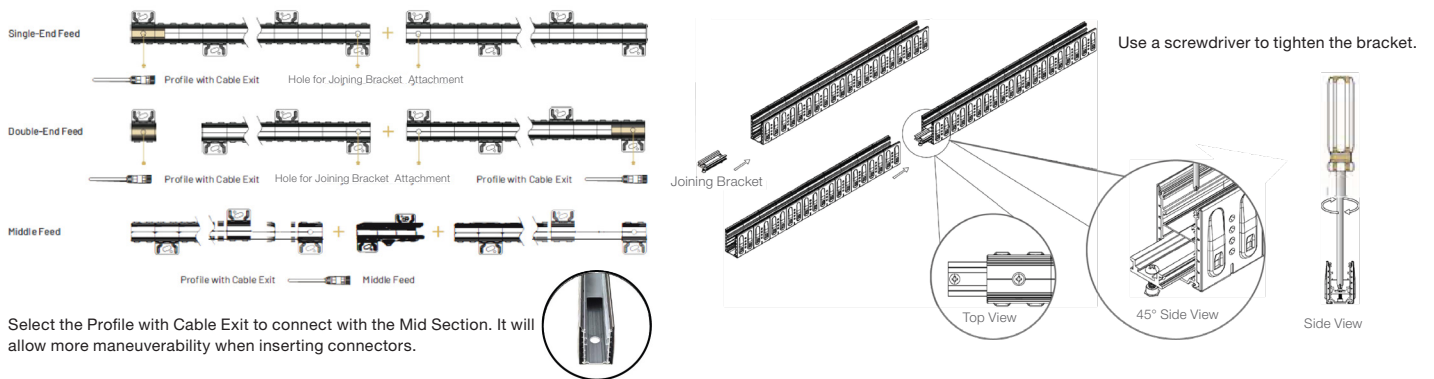

Installation Continued

STEP 1:

Profile cutting

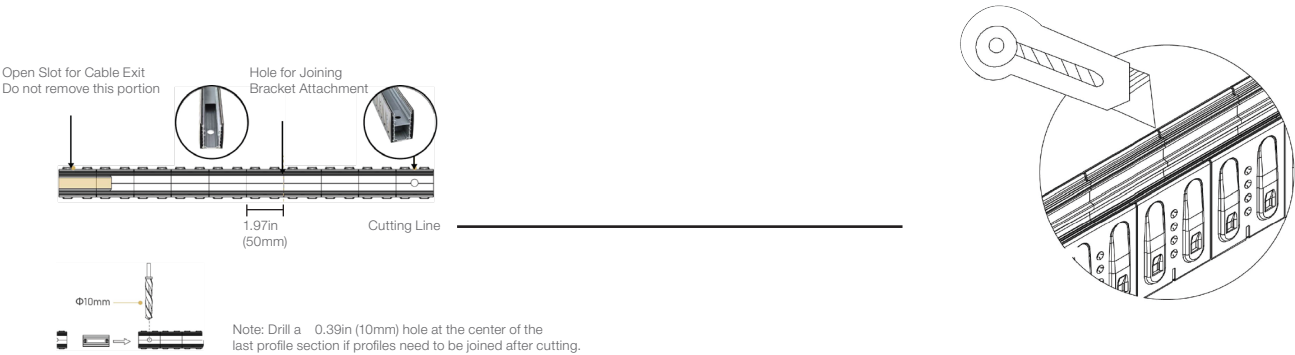

STEP 2:

Installation of end cover & connector

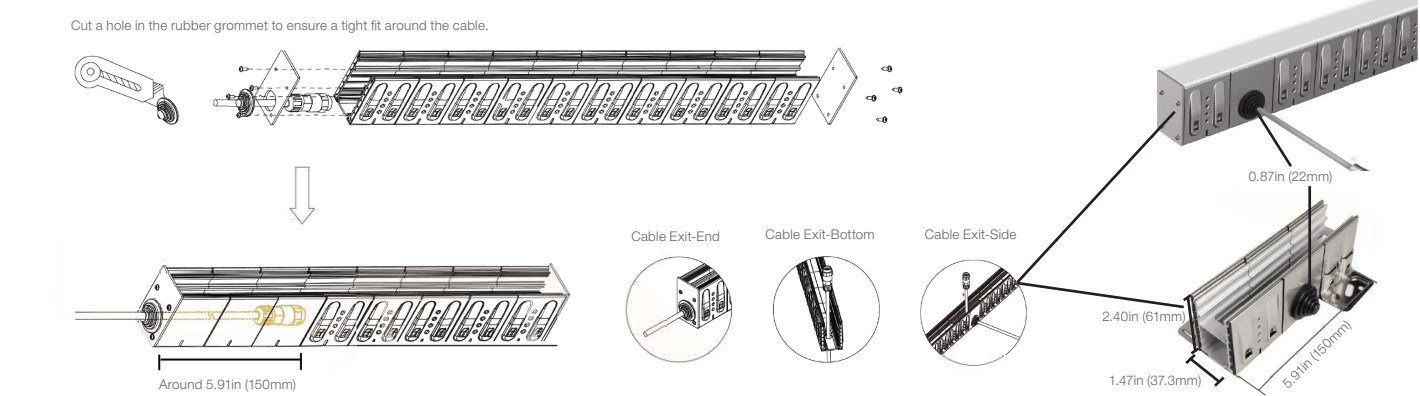

STEP 3:

Installation of the mounting bracket

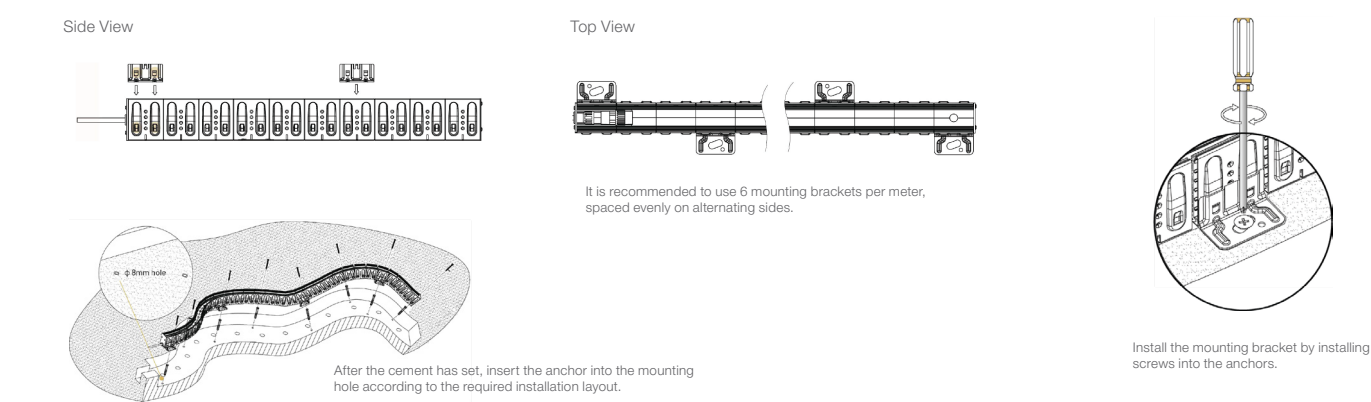

Installation Continued

STEP 7:

Installation of PVC protection cover

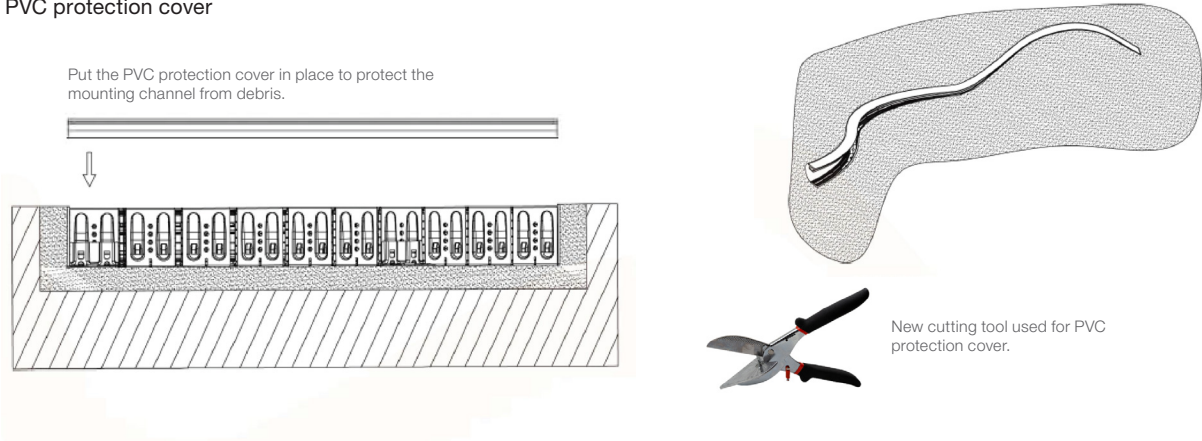

STEP 8:

Drainage layer construction

Fully encase the cable in the conduit to prevent cement from hardening around it and causing blockage.

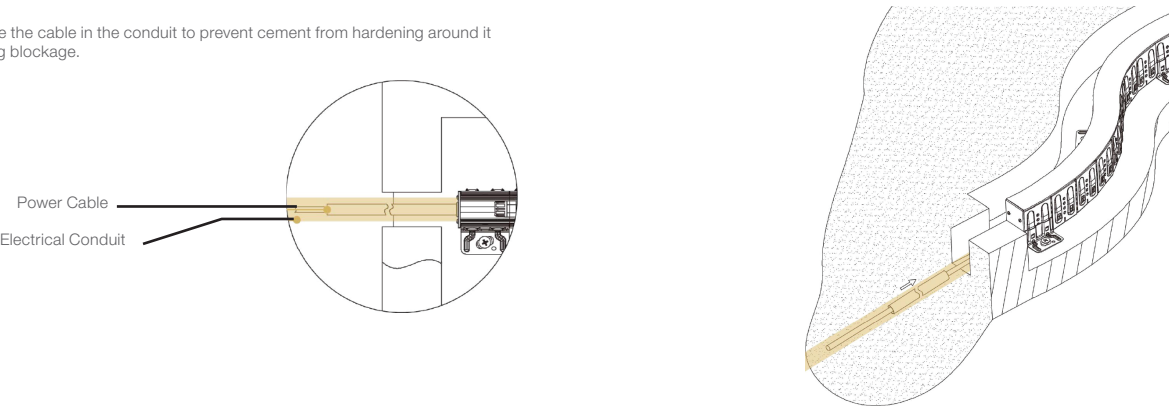

STEP 9:

Filling Cement

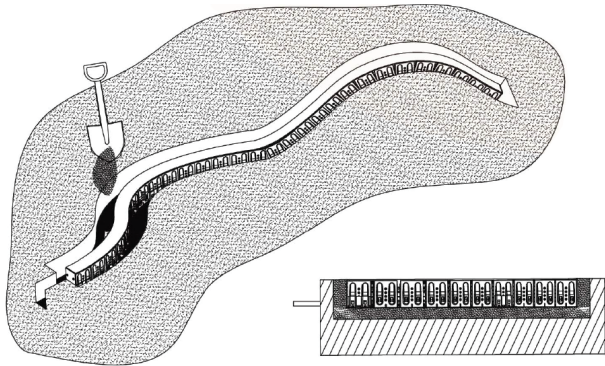

STEP 10:

Removing the PVC protection cover

Clean the in-ground mounting channel after removing the cover.

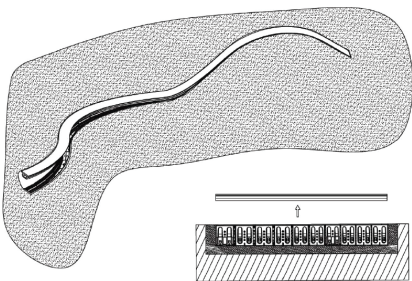

Installation Continued

STEP 11:

Installation of Orbit LightStrip

Note: Ensure the fixture is powered and tested before installing it into the mounting channel.

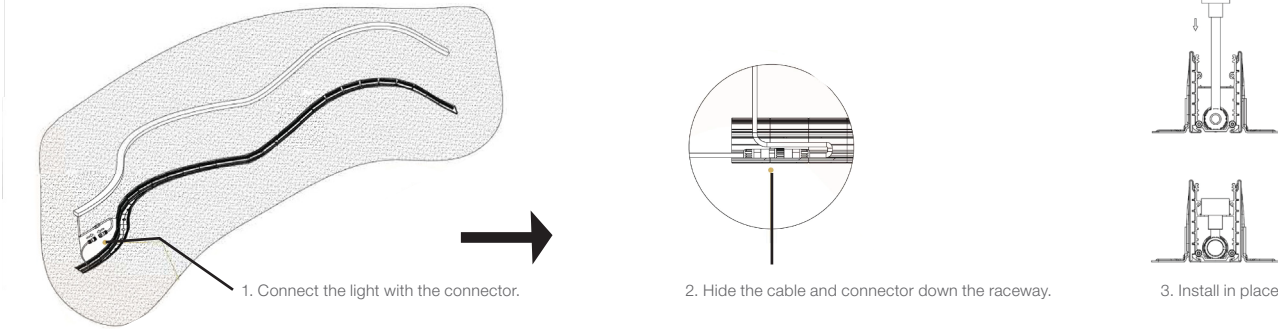

STEP 12:

Lighting Test

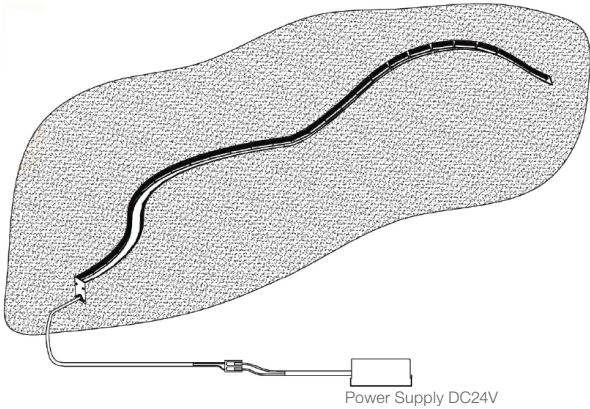

STEP 13:

Glue

Apply the structural adhesive along the edge of the profile at both ends, the length to be glued around 5cm to prevent the silicone diffusing lens from being stolen. Adhesives such as Dow Corning SJ168, 791, and 995 are highly recommended for this purpose.

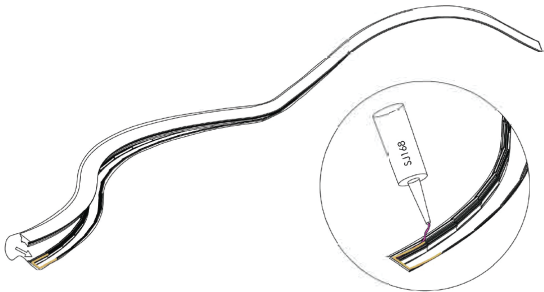

STEP 14:

Placing the silicone diffusing lens

