



LED Neon
FLEX



VIVID

WAVE

DYNAMIC WHITE

SILICONE 24V



Version 2.1 | 12/21/2021

For More Information

Toll Free: 1 (888) 580-6366



UNITED STATES

Pacific Business Center
1075 American Pacific Dr.,
Ste. A Henderson, NV 89074

CANADA

264 Botsford Street,
Suite 200 Moncton, NB
E1C 4X7

UNITED KINGDOM

Unit 21, The Old Rectory
Northfleet, Gravesend,
DA11 8HN, UK

DISCLAIMER

GLLS reserves the right to make any design changes for continuous improvement which will not affect the overall appearance or performance.

WEBSITES

www.glls.com
www.ledneonflex.com
www.aquaneon.com

PAGE

1

of 9

Light Dimension	0.63 x 0.67in (16x17mm)	
Output	Dynamic White	
LED Light	SMD LED Chip	
Max Run Length	*GLLS does not recommend exceeding a max. run length per fixture of 65.62ft(20m) for handling capabilities.	
Single Feed	Full Load: 49.2ft (15m)	Dynamic Load: 98.4ft (30m)
Double Feed	Full Load: 98.4ft (30m)	Dynamic Load: 196.8ft (60m)
Light Surface	Square profile 160°	
Lumen Maintenance	70,000 Hours L70 @ 25°C : 90,000 L50 @ 25°C 50,000 Hours L70 @ 50°C : 70,000 Hours L50 @ 50°C	

Electrical

Input Voltage	24V DC	
Power Consumption	3.66W/ft (12W/m)	

Physical

LED Count	43 LEDs/ft (144 LEDs/m)	
Cutting Unit Length	3.28in (83.3mm) (12 LEDs)	
Thermal Management	Free air convection	
Fixture Connections	End, side & bottom lead wires	
Minimum Bend Diameter	11.81in (300mm) (Top & Side Bending)	

Temperature Ranges

Installation	-40°F to 122°F (-40°C to 50°C)	
Operating	-40°F to 131°F (-40°C to 55°C)	
Max. Surface	185°F (85°C)	
Humidity	0-95% non condensing	

Dependability

Warranty	10 Year Limited Warranty	
----------	--------------------------	--

Safety

Testing	Tested to UL & CSA by Underwriters Laboratory for use in USA and Canada, complies with California Title 24 Requirements, Lighting Facts. Exceeds ANSI C78.377A, CE & RoHS Compliant.		
Certifications	Testing Organization	Certificate Serial N°	Report Reference
UL 2108	UL	E347880	E347880-20130503
CE-EMC	SGS	SZEM1712012372LMV	SZEM171201237201
IP Rating	IP68 With appropriately rated accessories.		

Optical Parameters

Available Colors

Color	CCT
2200K	2238 ± 66K
5700K	5669 ± 305K

Lumen Count

Color	Per Foot	Per Meter
2200K	67lm	220lm
5700K	82lm	270lm

Top & Side Bending

*Dynamic White products use a PWM signal which allows you to control the color temperature from 2200K to 5700K.

Beam Angle 160°	Bending Diameter D:300mm	Flame Resistant	UV Resistant	Solvents Resistant	Saltwater Resistant	IP68 Protection	IK08 Protection	10 Year Warranty

Bending Direction

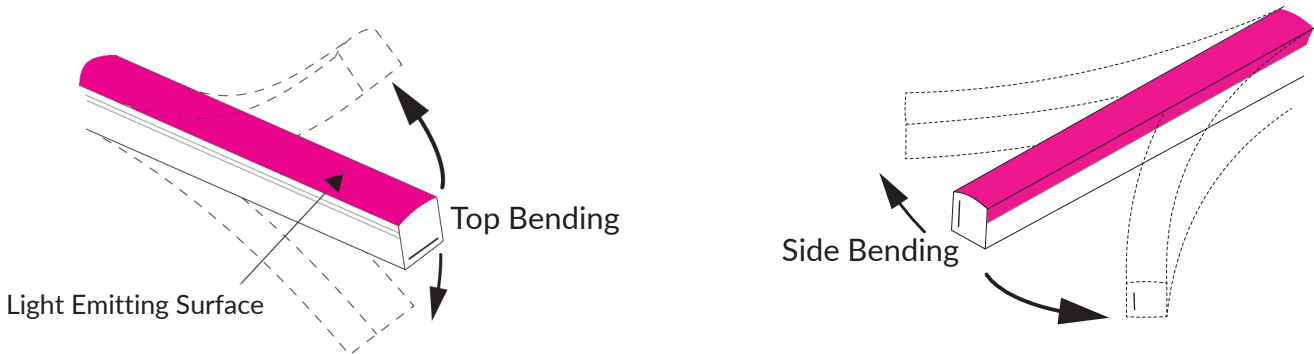

Light Profile

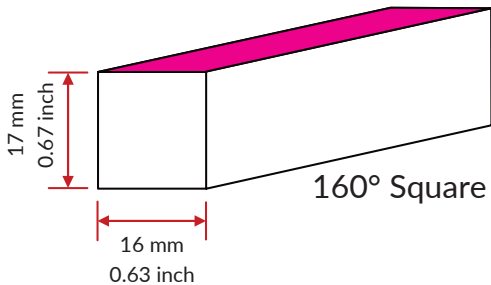

Minimum Bending Diameter

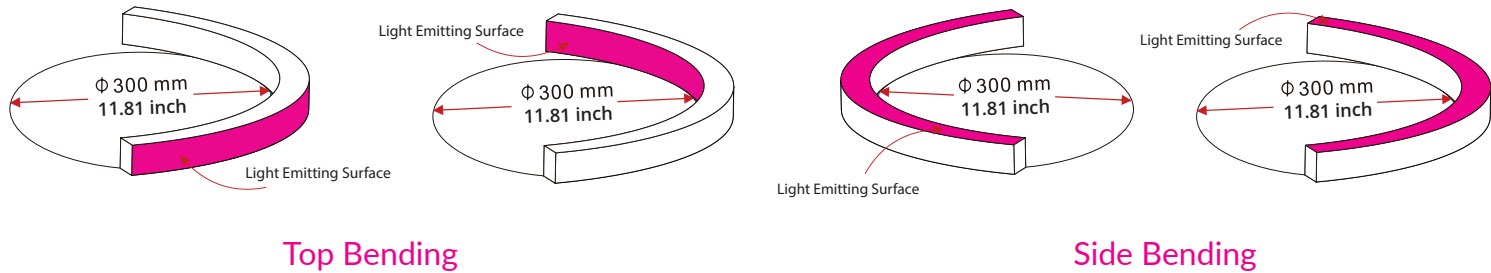

Fixtures

SF-16E-X- 01-3W-E-DWH-24DV



Bending Direction
0 - Top Bending
1 - Side Bending

Lead Connector

FA-16E-X-00-3W-XX-X-XX-XXX-S

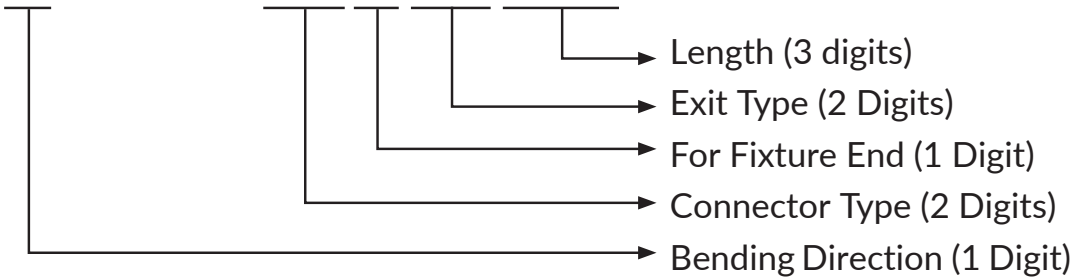

Bending Direction (1 Digit)	Connector Type (2 Digits)	For Fixture End (1 digit)	Exit Type (2 digits)	Length (3 digits)
0 - Top Bending	SC - Snap	1 - Input side	EN - End	0M3 - 0.98ft (30cm)
1 - Side Bending	SE - Seamless	2 - Output side	BO - Bottom	01M - 3.28ft (1m)
		0 - Jumpers/T-Feeds/ Seamless Bottom/ Seamless End	SL - Side left	03M - 9.84ft (3m)
			SR - Side right	05M - 16ft (5m)
			EJ - End jumper	10M - 32.81ft (10m)
			BJ - Bottom jumper	000 - For End Cap



For full part number naming rules, please refer to the document on <https://www.glls.com/documentation/>

IP68: Submersible. Factory Assembly only.

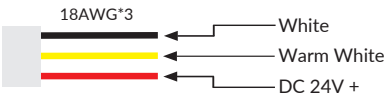

(Dimensions: mm)

Seamless

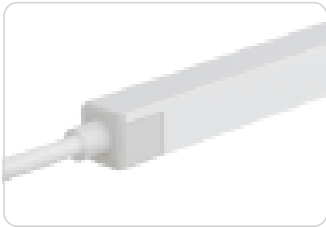

Seamless End Exit
FA-16E-X-00-3W-SE-0-EN-XXX-S

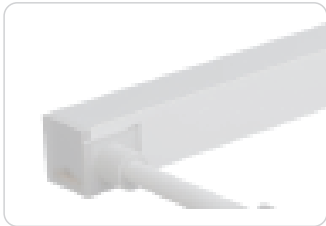
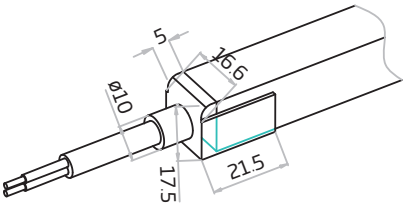

Seamless Side Exit
FA-16E-X-00-3W-SE-1-SR-XXX-S
FA-16E-X-00-3W-SE-2-SL-XXX-S

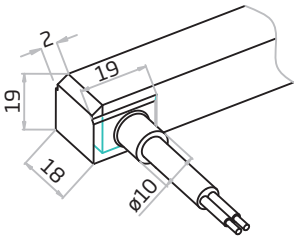

Seamless Bottom Exit
FA-16E-X-00-3W-SE-0-BO-XXX-S

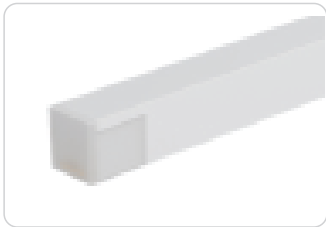
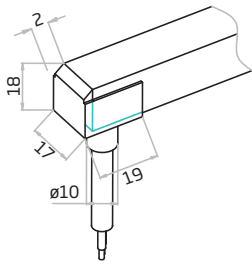

Seamless End Cap
FA-16E-1-00-0W-SE-1-EC-000-P
FA-16E-1-00-0W-SE-2-EC-000-P

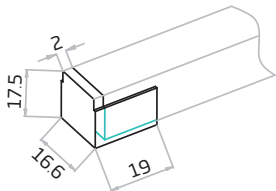

Seamless Jumper
FA-16E-X-00-3W-SE-0-EJ-0M3-S
FA-16E-X-00-3W-SE-0-BJ-0M3-S

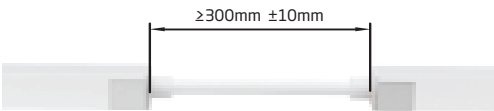

IP67: Wet environments. DIY connectors

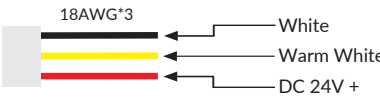

(Dimensions: mm)

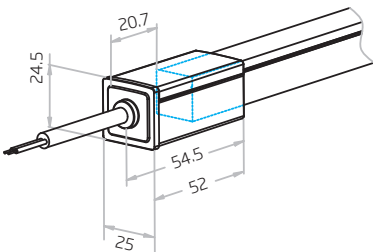

*Snap connectors are available in End, Side, Bottom, End Cap, and Jumpers. Please see more info at <https://www.glls.com/documentation/>

Snap



Snap Connectors
NA-16E-X-00-3W-SC-X-XX-XXX-S

Male & Female Connectors

IP67: Plug and play. Outdoor Rated.



Male & Female Connectors
NA-3W-PL-10A-C60-F
NA-3W-PL-10A-C60-M

NA-3W-SL-10A-C60-F
NA-3W-SL-10A-C60-M

NA-3W-LW-SC-C60-F
NA-3W-LW-SC-C60-M

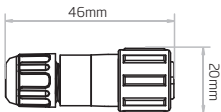

Anti-Wicking Ferrule



Anti-wicking Ferrule

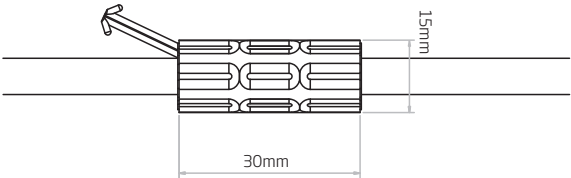
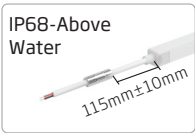

Standard Aluminum Channel

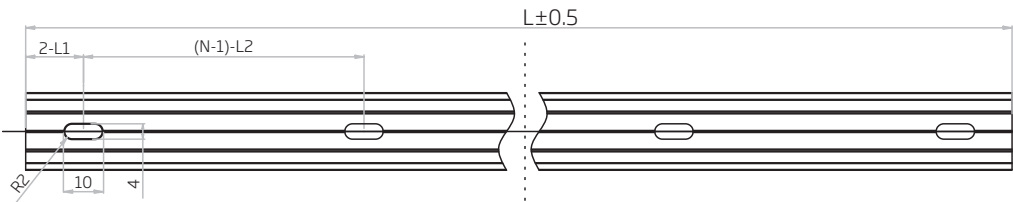
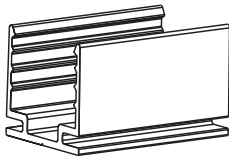
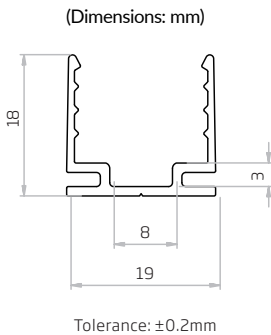
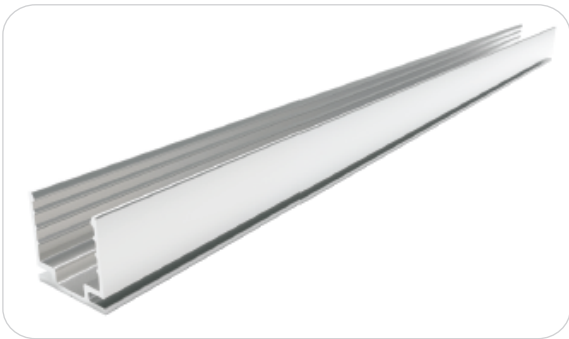

- Note
- 1. 2-L1 refers to two of symmetric L1 in each piece of profile.
 - 2. (N-1)-L2 refers to (N minus one) of symmetric L2 in each piece of profile. "N" hereby stands for its corresponding "Hole Number" in the below table

W x H	Standard Length	Part Number	L1	L2	Screw Hole	Hole #
0.75 x 0.71in (19 x 18mm)	1.38in (35mm)	CL-16-R-AL-3C5-SD	0.69in (17.5mm)	/	0.39x0.16in(10x4mm)	1
	19.69in (500mm)	CH-16-R-AL-0M5-SD	1.97in (50mm)	7.87in (200mm)	0.39x0.16in(10x4mm)	3
	39.37in (1000mm)	CH-16-R-AL-01M-SD	3.94in (100mm)	7.87in (200mm)	0.39x0.16in(10x4mm)	5
	78.74in (2000mm)	CH-16-R-AL-02M-SD	3.94in (100mm)	7.87in (200mm)	0.39x0.16in(10x4mm)	10

Recessed Aluminum Channel

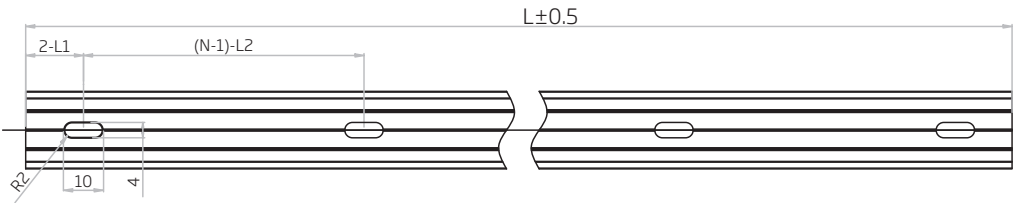
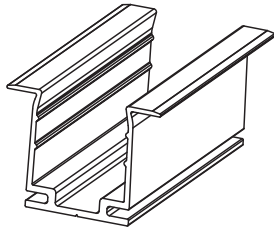
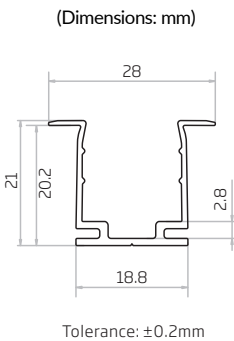

- Note:
- 1. 2-L1 refers to two of symmetric L1 in each piece of profile.
 - 2. (N-1)-L2 refers to (N minus one) of symmetric L2 in each piece of profile. "N" hereby stands for its corresponding "Hole Number" in the below table

W x H	Standard Length	Part Number	L1	L2	Screw Hole	Hole #
1.1 x 0.83in (28 x 21mm)	1.38in (35mm)	CL-16-R-RA-3C5-SD	0.69in (17.5mm)	/	0.39x0.16in(10x4mm)	1
	19.69in (500mm)	CH-16-R-RA-0M5-SD	1.97in (50mm)	7.87in (200mm)	0.39x0.16in(10x4mm)	3
	39.37in (1000mm)	CH-16-R-RA-01M-SD	3.94in (100mm)	7.87in (200mm)	0.39x0.16in(10x4mm)	5
	78.74in (2000mm)	CH-16-R-RA-02M-SD	3.94in (100mm)	7.87in (200mm)	0.39x0.16in(10x4mm)	10

Standard Aluminum Channel with Silicone Grip

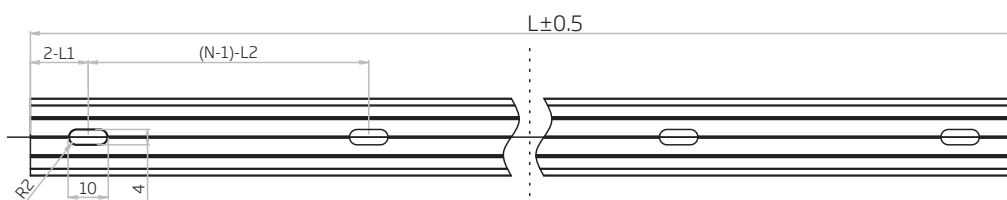
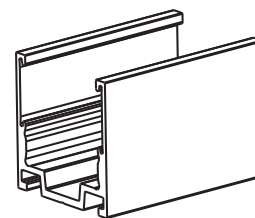
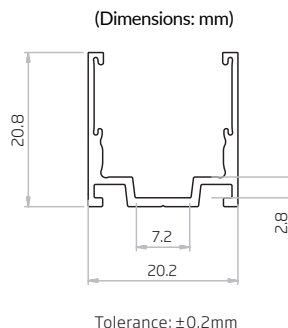

Note:

1. 2-L1 refers to two of symmetric L1 in each piece of profile.
2. (N-1)-L2 refers to (N minus one) of symmetric L2 in each piece of profile. "N" hereby stands for its corresponding "Hole Number" in the below table

W x H	Standard Length	Part Number	L1	L2	Screw Hole	Hole #
0.80 x 0.82in (20.2 x 20.8mm)	0.787in (20mm)	CL-16-R-AL-02C-SE	0.39in (10mm)	/	0.39x0.16in(10x4mm)	1
	19.69in (500mm)	CH-16-R-AL-0M5-SE	1.97in (50mm)	7.87in (200mm)	0.39x0.16in(10x4mm)	3
	39.37in (1000mm)	CH-16-R-AL-01M-SE	3.94in (100mm)	7.87in (200mm)	0.39x0.16in(10x4mm)	5
	78.74in (2000mm)	CH-16-R-AL-02M-SE	3.94in (100mm)	7.87in (200mm)	0.39x0.16in(10x4mm)	10

Recessed Aluminum Channel with Silicone Grip

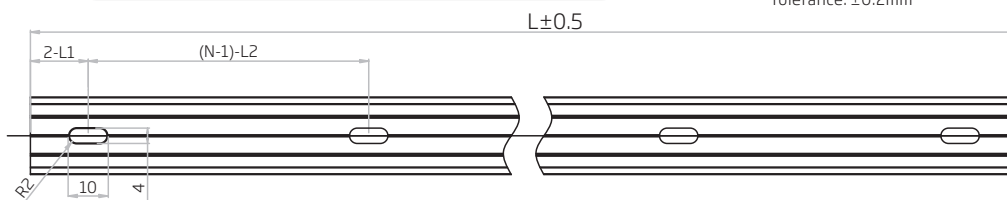
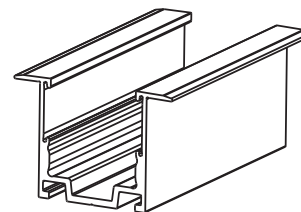
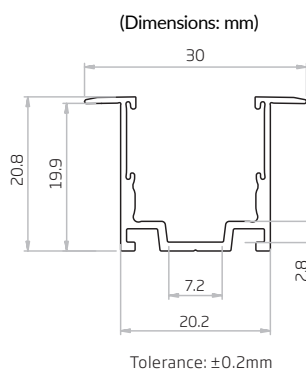

Note:

1. 2-L1 refers to two of symmetric L1 in each piece of profile.
2. (N-1)-L2 refers to (N minus one) of symmetric L2 in each piece of profile. "N" hereby stands for its corresponding "Hole Number" in the below table

W x H	Standard Length	Part Number	L1	L2	Screw Hole	Hole #
1.18 x 0.82in (30 x 20.8mm)	0.787in (20mm)	CL-16-R-RA-02C-SE	0.39in (10mm)	/	0.39x0.16in(10x4mm)	1
	19.69in (500mm)	CH-16-R-RA-0M5-SE	1.97in (50mm)	7.87in (200mm)	0.39x0.16in(10x4mm)	3
	39.37in (1000mm)	CH-16-R-RA-01M-SE	3.94in (100mm)	7.87in (200mm)	0.39x0.16in(10x4mm)	5
	78.74in (2000mm)	CH-16-R-RA-02M-SE	3.94in (100mm)	7.87in (200mm)	0.39x0.16in(10x4mm)	10

Transparent Reinforced Plastic Channel

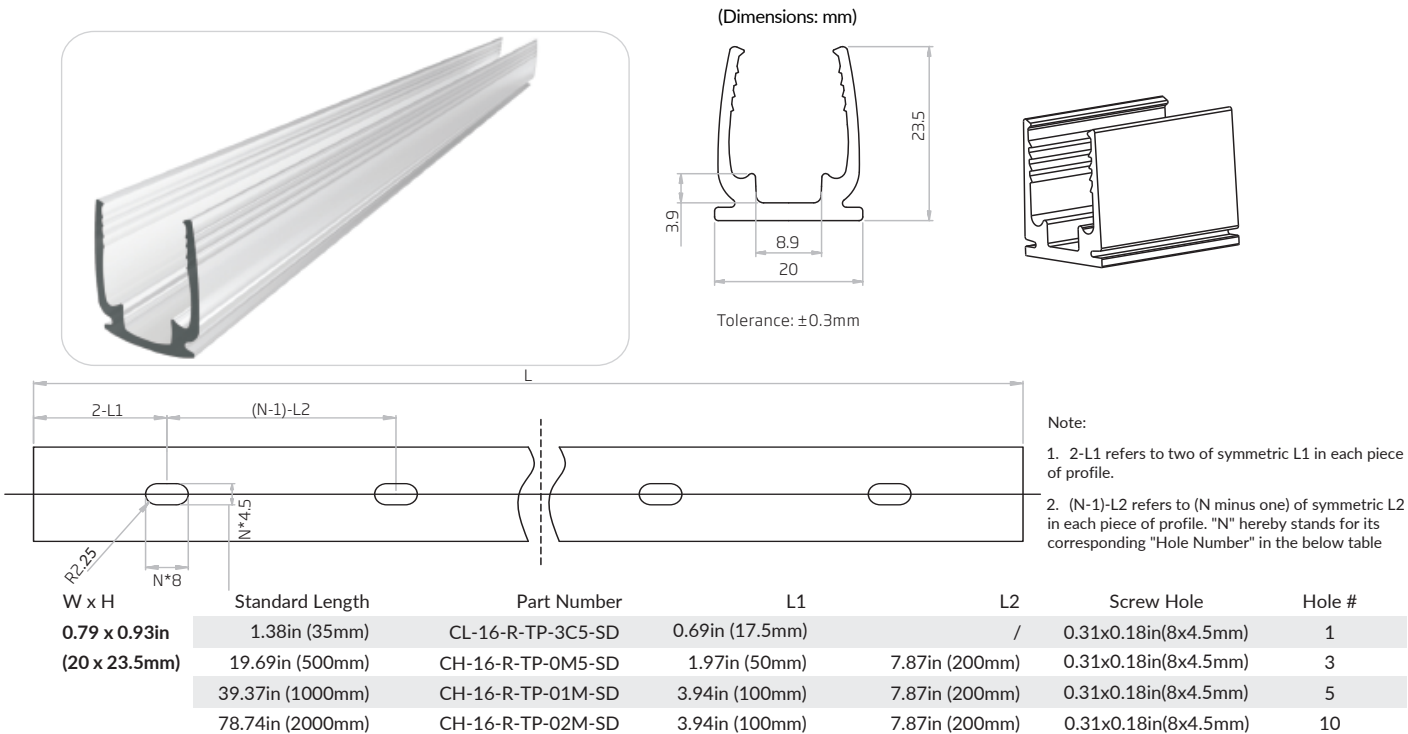

Bendable Serrated Aluminum Channel

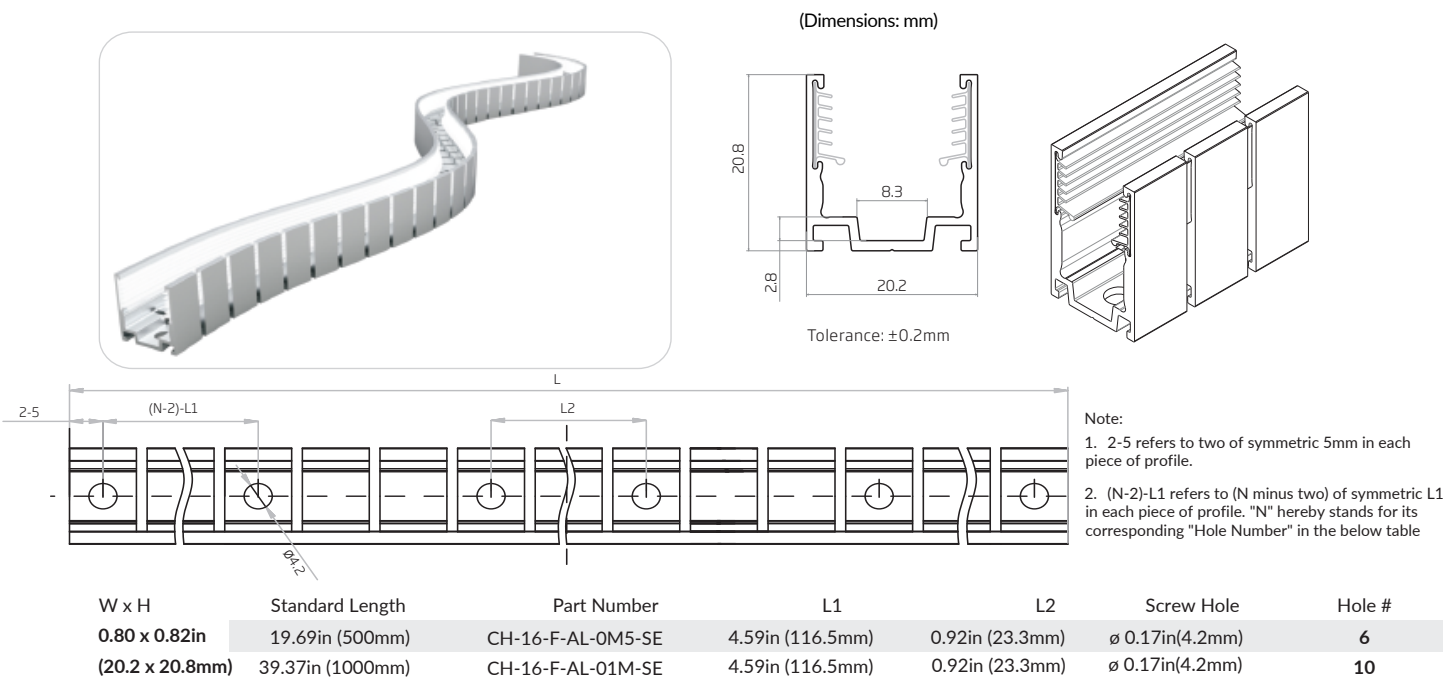

For more available mounting options, please refer to the series manual on <https://www.glls.com/documentation/>

