

JC 261 CAMERA INSTALLATION GUIDE



Key Features



Cameras

The JC 261 is compatible for both front-facing and driver-facing with a secondary camera.



Independent Lens

Both cameras can be adjusted separately for optimal viewing.

JC 261

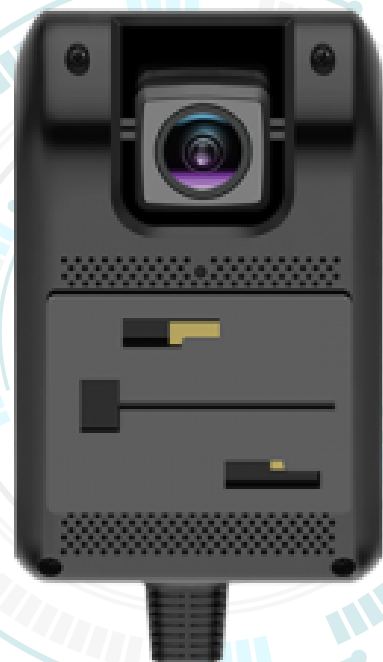

Always Connected

Built-in 4G LTE keeps the dashcam online at all times.



Reliable Storage

Saves video clips on both SD card and cloud for backup.



Secure & Protected

Tamper-proof build with protection against low vehicle battery voltage.

This guide describes how to install the forward-facing and an IR Inward-facing AI Dashcam.

Please follow the installation instructions below.

Index

- 1 Checking the camera box
- 2 Pre installation checks
- 3 Installing the camera
 - a. Connect using OBD 2 port
 - b. Connect using 3-wire connector
- 4 Wiring and harness management
- 5 Connecting and testing the camera
- 6 Final steps and troubleshooting
- 7 Completing the installation
- 8 Mounting the camera
 - a. Removing the side panel
 - b. Inserting SD card
 - c. Choosing the mounting area
 - d. Adjusting road-facing camera
 - e. Adjusting driver-facing camera
 - f. Cleaning the windshield
 - g. Mounting the camera
 - h. Locking the road-facing camera
 - i. Locking the driver-facing camera

Before You Begin

Go through the box and check if you have received all the following items.

1. JC 261 Camera (x1)
2. Secondary Camera
3. Harness (3 wire)
4. Mounting Bracket
5. User Guide
6. Alcohol Wipes
7. Allen Key
8. Screwdriver
9. Panic Button
10. External Battery

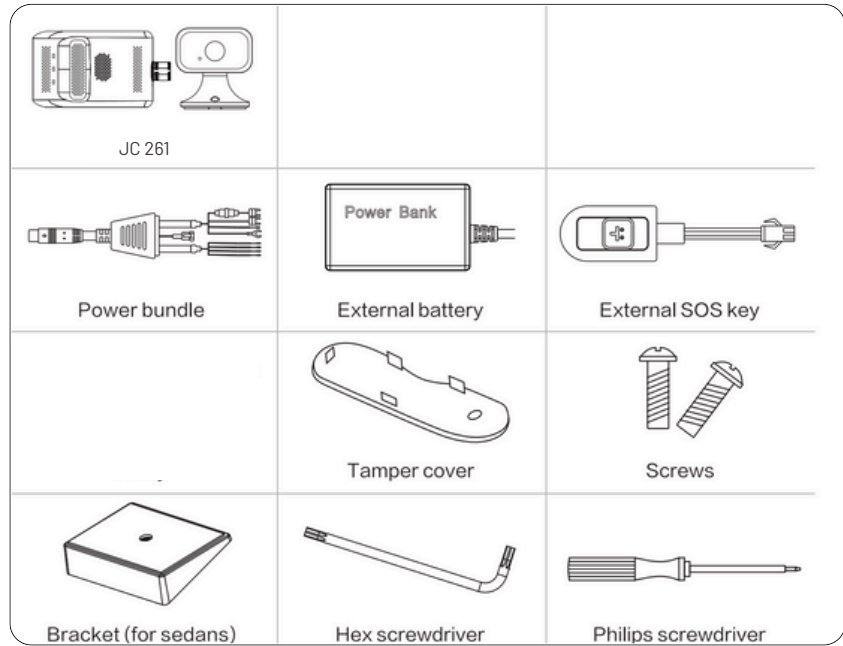

Optional Mounting Brackets

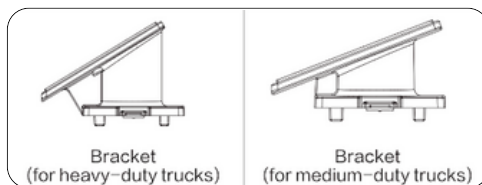

#1 mount bracket is for sedans, and is the standard that is shipped with the camera



#2 mount bracket is for medium-duty trucks



#3 mount bracket is for HGV and heavy-duty trucks



Pre-installation checks

Before you begin the physical installation of your dashcam, performing these pre-installation checks is crucial. Taking a few minutes now to verify these points will save you time later and ensure a successful and reliable camera setup.



Vehicle and Environment

- Compatibility:** Ensure that the vehicle can supply the specified power to the camera through the OBD2 port or 3 wire cable. Refer to the wiring section of this guide for more information.
-
- Network Coverage:** Make sure your vehicle is parked outdoors, typically open parking lot, with good connectivity and at least 25 meters of clear line of sight in front of the vehicle.
-
- Clean Windshield:** The position where the mounting bracket is affixed on the windshield should be clean, and free from any obstructions, such as wipers, stickers, or dirt. Check the mounting section for more information.
-



Device and Power

- Camera Provisioning:** Before you start, ensure that the dashcam is provisioned on the fleet portal. If the solid red and green LED light, this indicates that it is in idea mode - not running a trip due to device full storage.
-

If you observe a blinking blue LED once every 2 seconds it indicates the device is connected to power, ignition is on, and not connected to the internet, and the trip is running.

If there is a solid blue LED, then it indicates connected to power, ignition on and connected to the internet, and the trip is running



Power Source:	Make sure your vehicle's power source is working and has the correct voltage.
SIM Activation:	Make sure that the SIM card inserted properly, is active, and has a data plan.

Installing the Camera

Power Connection

The camera needs to be connected to a power source using either a **3-wire fuse box connection** or an **OBD-2 harness**.



Connect to OBD 2 Port:

Locate the OBD-II port in your vehicle, usually found under the dashboard or steering column.

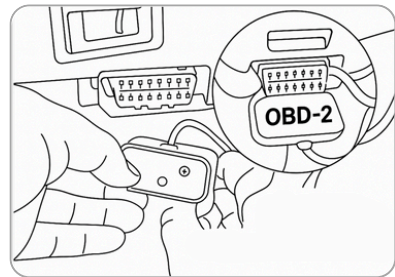
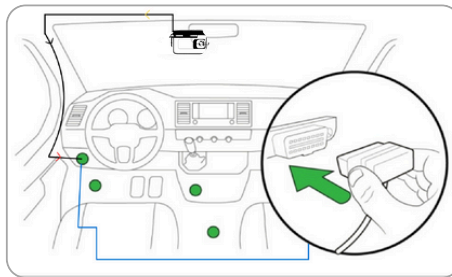

Secure Connection:

Plug the harness securely into the port.

If the port is being used by another device, contact Support to order a Y-splitter, so that you can connect both devices to the OBD2 port.

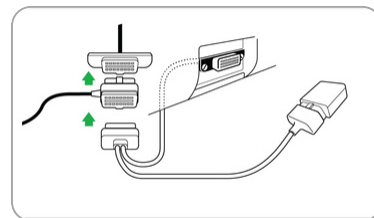
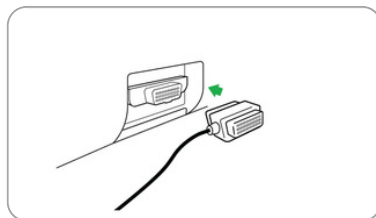

Ignition On:

During the boot up, the red LED on the camera will turn on followed with the green LED (GPS) for few seconds and later the GPRS LED (blue) comes on

Audio Confirmation:

A click sound to indicate a proper power connection. The camera will also announce that the trip has started.

Disclaimer: *If you are using another telematics device, you will need a Y splitter to connect both the dashcam and the telematics unit at the same time.*

2

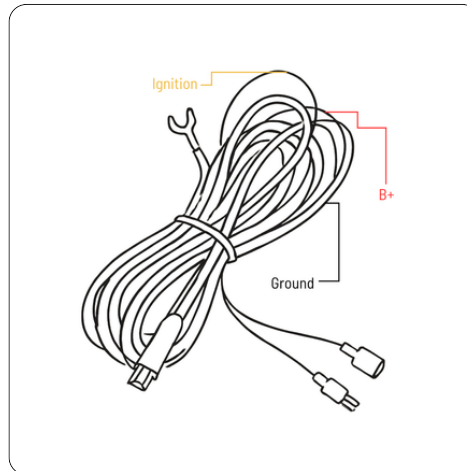
Connect using the 3-wire:**Initial Hookup:**

Make sure the engine is off, connect the micro-USB connector (point A- near the cable extension) of the harness to the matching connector on the camera. Make sure that the connector lock latches into place. The other side of the harness has three wires: ACC (yellow), Power/B+ (red), Ground/GND (black)

Engine Off:

Ensure the vehicle ignition and engine is turned off before you proceed. You may notice the first GPS and GPRS turns off, and the red LED continues blinking for 15 to 20 seconds

Yellow Wire (Ignition):

Connect the yellow wire to an ignition line or ACC.

**Red Wire
(Constant
Power B+):**

- Find a constant 12-24 V power source. Please use a multimeter to verify the rated voltage the rated voltage when the ignition is off.
 - Connect the red wire to the identified continuous power source.
-

**Black Wire
(Ground):**

Connect the black wire to a factory bolt or a spare ground lead. Use chassis ground only in light vehicles—do not use it in light- or heavy-duty trucks.

**Final Step:**

Turn on the vehicle ignition and wait 2 minutes. The red LED would blink first, followed by green and then blue.



Wiring & Harness Management

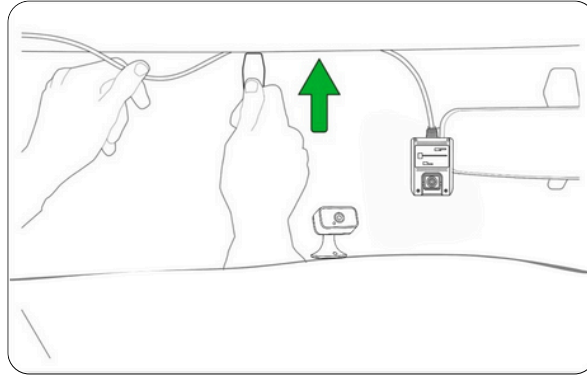

- 1 Conceal the Harness:**

Ensure the harness is properly tucked inside the top trim.
- 2 Use the Provided Tool for Routing:**

Utilize the tool provided with the camera to neatly route the harness along the headliner and A-pillar.
- 3 Follow the Harness Path:**

Guide the harness along the side or behind the interior panels towards the power source.
- 4 Secure Excess Wiring:**

Use the wire ties to fasten any excess/loose harness. There is a split wire for the JC 261 one for the camera and one for the power
- 5 Prioritize Safety:**

Verify that no part of the harness comes in the way of normal vehicle/driver function.

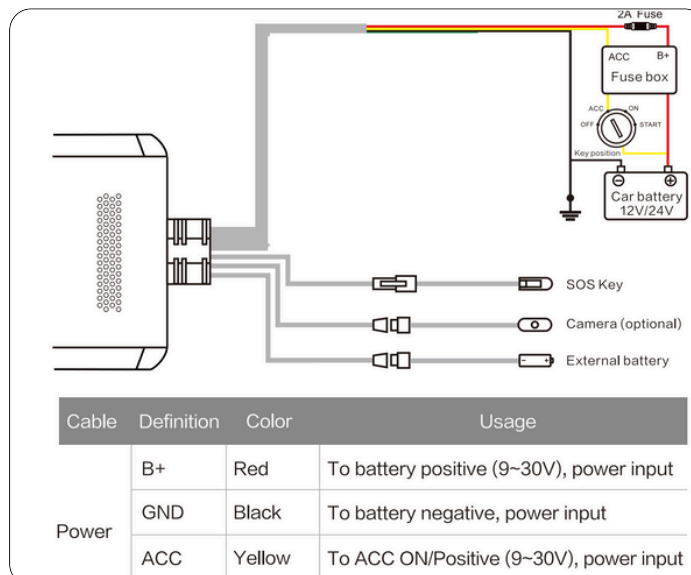

Connecting & Testing the Camera

- 1 **Start the Vehicle:** Turn on the vehicle's ignition.

- 2 **Check the LED Light:** Wait for one minute and observe the camera's LED. A solid blue LED blinking indicates that the camera is functioning correctly.

- 3 **Listen for Alerts:** Ensure that you can hear audible alerts from the camera.

Final Checks & Troubleshooting

- 1 **Ensure Clear Visibility:** Confirm that the camera has a clear and unobstructed view of both the road and the driver field of view. Remember to remove the protective film from both camera lenses.

- 2 **Verify Network Connectivity:** Check for a solid blue LED light, which confirms that the camera is connected to the internet.

- 3 **Confirm Recording:** Verify that the camera is recording correctly. Press the panic button to capture media and listen for the audible alert. Wait for a minute and then check with your fleet manager or back office to confirm that they can view the video or images on the fleet portal.

- 4 **Check Camera Alignment:** Ensure that the camera lens is oriented correctly. Make any necessary adjustments, if needed.

Completing the Installation

- 1 **Secure the Camera:** Ensure the camera is firmly mounted and fastened in place.

- 2 **Brief the Driver:** Explain the system's operation to the driver.

Mounting the JC 261 Camera

1 Placing the Camera:

- Hold the camera upright, keeping the QR Code (panic button) facing cabin/driver.
- The road / driver side camera can be moved horizontally to adjust the angle.
- The driver-facing camera can be adjusted to the desired angle with the screw behind the driver-facing camera.

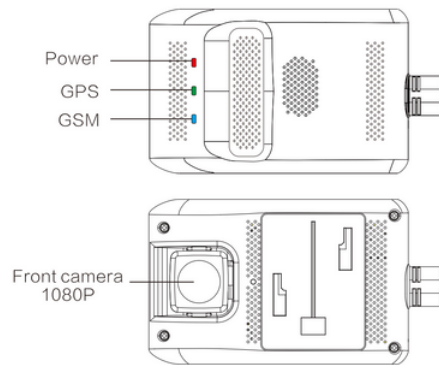

2 Insert a New SD Card:

- Verify if the camera already has an SD card.

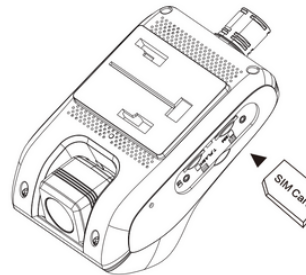

- Find the SD card slot, which is located below the SIM card slot.
- Insert the new SD card by pushing it into the slot until you hear and feel it click into place.
- If the camera already has an SD card, gently press on it to release and remove it and then insert a new card.

Disclaimer: Having an SD card is essential for storing video footage captured during each trip. This ensures that critical events or incidents are recorded and can be reviewed later.

For the proper functioning of the SD Card, it has to be completely formatted (FAT 32)

3

Choose Where to Mount the Camera:

Sit in the driver's seat and pull down both sun visors.

Hold the camera in the recommended shaded area on your windshield, making sure that:

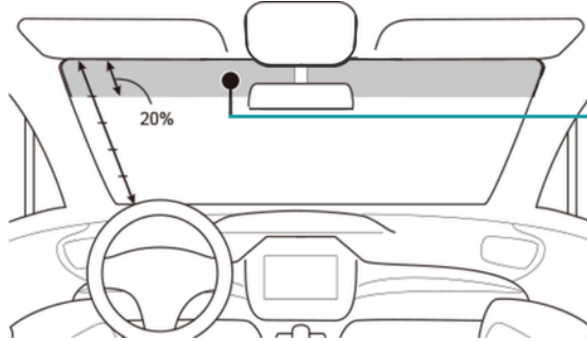

- It doesn't block the driver's view.
- The sun visors and rearview mirror don't block the driver-facing camera lens.
- The sunstrip doesn't block the road-facing camera or expose it to too much heat.
- The camera should be mounted on the driver's side of the rear view mirror.

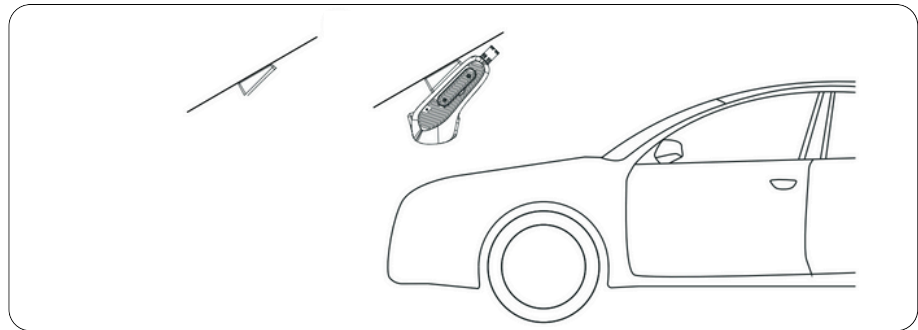

4 Adjust the Road-Facing Camera:

- Reorient/pitch the lens up or down to give the camera a clear view in front of the vehicle.
- Red line below is the only indicator of the horizon line in the camera's field of view.

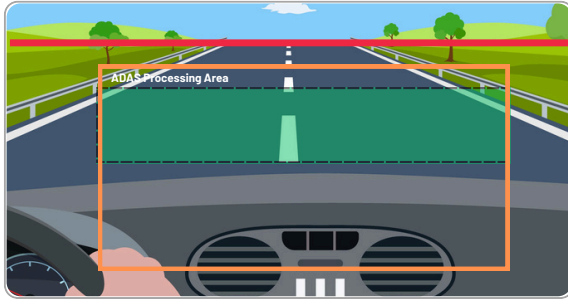

Camera has too less sky

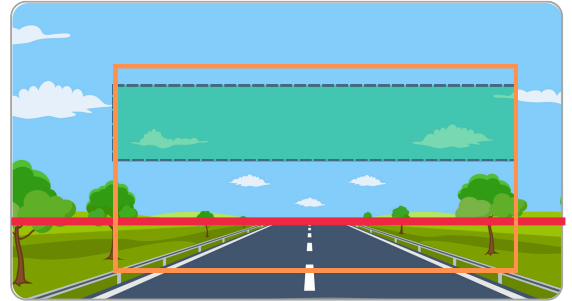

Camera has too much sky

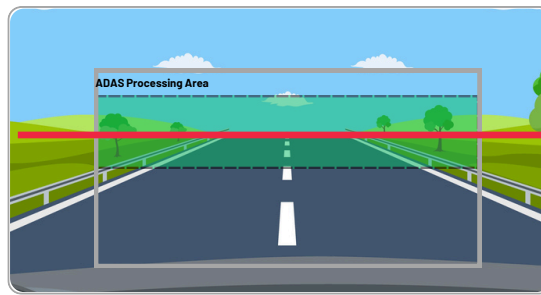

Perfectly aligned



5 Adjust the Driver-Facing Camera:

- Reorient the driver camera lens such that the camera has a clear and an unobstructed view of the driver's face and torso.
- Mount the camera on the driver's side of the rearview mirror.
- Center it on the driver's seat.
- The camera should be mounted towards the top edge of the windshield just above the wiper zone. Please ensure you follow the local regulations.
- Make sure the headrest on the driver's seat is visible in the top quarter of the camera preview.
- Position the driver's face within the recommended zone shown in the guide.

- Make sure the seat belt on the driver's torso is clearly visible to the camera's field of view.
- Position the camera for a full-frontal or near-frontal view of the driver, instead of a side view.

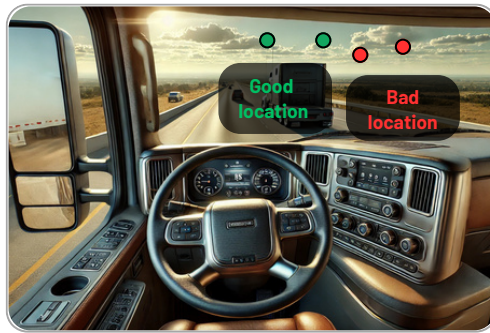

6

Clean the Windshield:

- Use the provided alcohol wipes to clean the area on the windshield where the mounting bracket is to be affixed.
- Let it air dry for 60 seconds, then wipe it dry with a cloth.

7

Mount the Camera:

- For the JC 261, camera setup options include a rear and an IR inward-camera system with a forward-facing camera and a secondary inward-facing camera.
- The forward-facing camera offers a 142° diagonal field of view, covering 116° horizontally and 60° vertically. It should be mounted to provide an unobstructed view of the road ahead.

Note: The camera angle is fixed and must be correctly set during installation to ensure optimal field of view and coverage.

- Make sure the windshield is between 50°F and 80°F (10-26°C) so the adhesive will stick properly.

- Remove the protective film from both camera lenses.
- Place the camera and look for the horizon, if the placement is correct, remove the 3M sticker from the bracket.
- Stick the bracket to the windshield and press firmly for 30 seconds.

8

Lock the Road-Facing Camera:

- Slide the camera from right to left to attach the camera.

Important: You should hear a click sound to ensure the camera is properly locked on to the bracket.

- Move the road-facing camera vertically to adjust the camera and lock the mounting after verifying using the companion app
- Secure the road-facing cameras at the chosen orientation/pitch.

9

Lock the Driver-Facing Camera:

- The secondary driver camera is a different unit which can be adjusted to the main unit

Important: You should hear a click sound to ensure the camera is properly locked on to the bracket.

- Move the driver-facing camera horizontally to adjust the camera and verify using the companion app
- Secure the driver-facing camera at the chosen orientation/pitch.

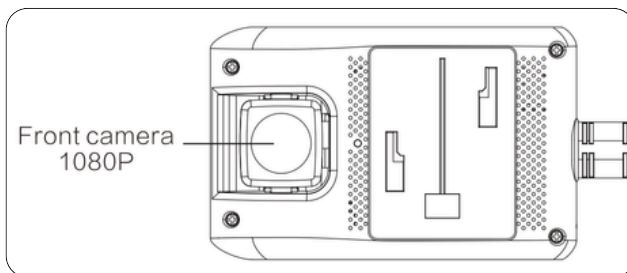

Road Facing Camera

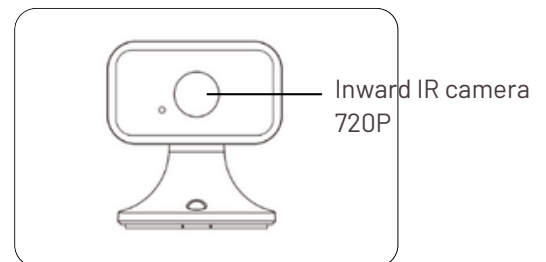

Driver Facing Camera

Contact your service provider for any further assistance.