

## MSS SPRINT FEST Auto Gymkhana Series '2025 Round 1 & 2– Program Time Table

**Sat 11 & Sun 12 Oct 2025**

<b>7.30AM – 8.30AM</b>	Sign in & Scrutineering for AM Session	<p><b>Please be advised that the marshal will close access at the main gate at event ground leading to paddock by <u>8.00AM</u>.</b> No cars will be permitted to enter once the event starts. Please ensure u arrive on time.</p> <p>Scrutineers will come to your car.</p>
<b>8.30AM – 12.00PM</b>	<p>Drivers Roll Call and Briefing</p> <p>Drivers Walk the Track</p> <p>Autogymkhana Pattern 1 - Timed Runs (Class 1 to 7)</p>	<p>Attendance will be called. Participants whom did not attend briefing will not be allowed to start.</p> <p><b>There will be no practice runs.</b></p>
<b>12.00PM – 1.00PM</b>	Taxi rides and Demos – subject to COC's approval	Lunch Break. Paddock will be open for Public Access.
<b>1.00PM – 4.00PM</b>	Autogymkhana Pattern 2 - Timed Runs (Class 1 to 7)	Drivers Walk the Track
<b>4.00PM – 4.30PM</b>	<p>Team Shoot-out</p> <p>Eliminator Shoot-out</p>	Eliminator Shoot Out will be a shoot-out between top 4 competitors (with fastest cumulative time selected from class 1, 2, 3 and 5) based on a ladder system. If there are insufficient competitors from these 4 classes, the remaining competitors will be selected from Open Class based on their ranking.
<b>4.30PM – 6.00PM</b>	Free Practice Runs and Taxi Rides	All taxi rides passengers must sign indemnity forms.
<b>6.00PM – 6.30PM</b>	Prize Presentation	<b><u>All participants</u></b> are to wear their racing suit for prize presentation and group photo.

## **EVENT GROUND ACCESS**

Access to the paddock is through the **Main Gate** (marked in red), with participants' cars required to cross the competition ground to enter. Competitors with support vehicles may bring them in temporarily to unload tools and spares. Due to limited parking, support or personal vehicles must exit the paddock after the designated loading/unloading period. Non-compliance with this policy, including unauthorized vehicle entry, may lead to the participant's disqualification or removal from the event.

*If sufficient parking becomes available, the organiser may allow participants to park their support vehicles within the paddock. Personal vehicles, however, are not permitted to remain inside under any circumstances.* Non-compliance with this policy, including unauthorized vehicle entry, may lead to the participant's disqualification or removal from the event.

The designated access times for support vehicles are from 7:00 AM to 8:00 AM. No further vehicle access to the paddock is permitted during the event, except for ambulances or in cases where cars need towing due to breakdowns. Access times may be adjusted depending on event progress or weather conditions, so please follow instructions from security or marshals at the main gate.

A secondary entrance, the **Side Gate** (also marked in red), is located along Ayer Rajah Crescent for public access. Participants may use this entrance to bring in tools and spares when the Main Gate is closed.

## **EARLY SETUP AND TOWING OF TRACK CARS**

On Friday, 10 October 2025, the paddock will be open strictly between 4:00 PM and 6:00 PM for early tow-in of track cars, tent setup, and unloading of spares. The paddock will be locked and secured at 6:00 PM sharp. No one is permitted to remain on-site after this time. Any equipment or vehicles left behind are entirely at your own risk.

## **PARKING AND SECURITY**

Due to the limited parking lots available, each participant will be assigned a parking lot at the paddock. Please park and set up tents according to this allocation. Any request to change this parking allocation should be arranged directly between participants.

Overnight security will not be provided. MSS, JTC, and the event organizers accept no responsibility for any personal property. All vehicles and belongings are left and parked entirely at the owner's risk.

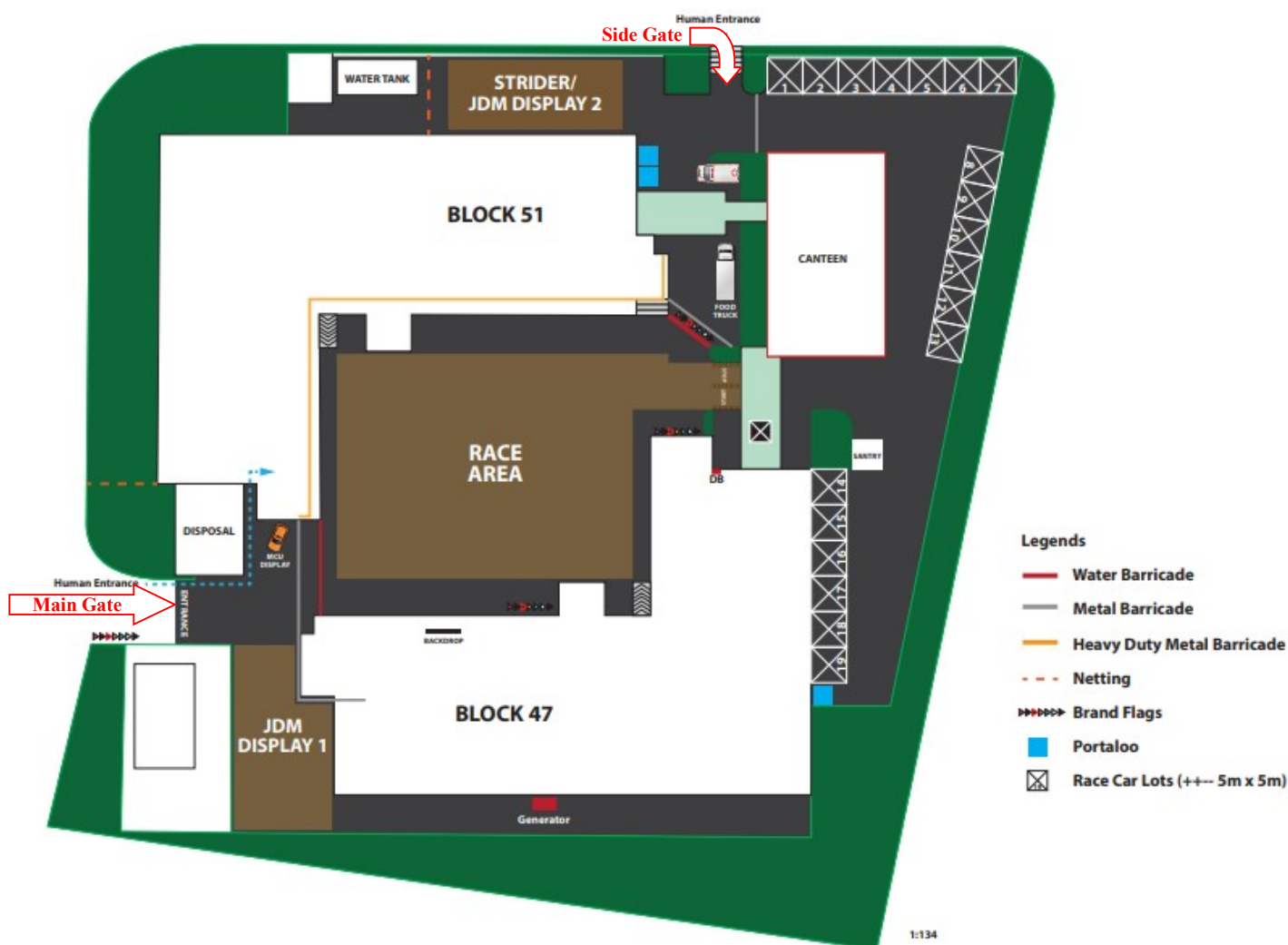

## IMPORTANT NOTES:

**Driver Sign-In Requirements:** All drivers must present their competition license and valid driver's license, either in physical or digital format, at sign-in.

**Track Familiarization Restrictions:** Drivers are strictly prohibited from using bicycles, rollerblades, skateboards, or any power-assisted wheels to familiarize themselves with the track. Playing music inside the car is not permitted, and no passengers are allowed during practice/demo runs unless they have signed an indemnity form or are registered instructors.

**Speed and Conduct Outside the Circuit:** A speed limit of 10 km/h applies outside the circuit. Any participant found speeding, testing handbrakes, drifting, or performing tire burnouts will be removed from the event. All participants must follow instructions from the marshals at all times.

### **SCRUTINEERING**

**Vehicle Inspection:** Drivers must open their car's bonnet and trunk for a mechanical inspection. All loose items, such as phone holders, sunglasses, air fresheners, water bottles, window blinds/curtains, clip-on rearview mirrors, and driver-side floor mats, must be removed from the car's cabin before scrutineering.

**Eligibility and Compliance:** The MSS Scrutineers will assess the eligibility of all cars in the event. Their decisions are final and at their discretion. Non-compliance will be referred to the Clerk of Course (COC), and drivers may be excluded from the event without a refund.

### **ATTIRE**

**Helmet and Dress Code:** Helmets with visible damage are not permitted. Competition drivers who do not follow the dress code outlined in the Supplementary Regulations (SR) will not be allowed to start.

### **CREW CONDUCT**

**Behavior in the Paddock:** Any drivers or pit crew found smoking, vaping, or behaving disruptively in the paddock, thereby causing a nuisance to others, will be excluded from the event. Drivers found consuming alcoholic beverages will be removed and excluded. Smoking is strictly prohibited within the event grounds (JTC compound) and is only allowed outside the Main and Side Gates.

### **BANNERS AND ADVERTISING**

**No Display of Banners or Promotional Materials:** Pull-up banners, posters, or any form of product/service displays are not allowed in the paddock. Commercial activities, such as videography, distributing brochures or handouts, are strictly prohibited throughout the event, except for sponsors.

### **POST-EVENT**

**Clean-Up:** All participants are requested to clear any trash they leave behind in the paddock area after the event and to depart in an orderly manner. Please refrain from loud departures, such as "pops and bangs."