

## MSS Auto Gymkhana Tarmac (Practice Session) – Program Time Table

Saturday – 4<sup>th</sup> Oct 2025

8.00AM – 8.45AM	Sign in & Scrutineering for Practice Participants	<b>Please be advised that the marshal will close access at the main gate at event ground leading to paddock by <u>9AM sharp</u>. No cars will be permitted to enter once the event starts. Please ensure u arrive on time.</b>
8.45AM – 9.00AM	Drivers Roll Call and Briefing	Drivers Walk the Track
9.00PM – 12.00PM	Autogymkhana Practise Pattern 1	

12.00PM – 1.00PM	Autogymkhana Practise Timed Run	The best recorded time will be used as the final result.  All runs must stop at 1.00PM. No demo or joy rides allowed without ambulance on site.
------------------	---------------------------------	---

1.00pm – 1.15pm	Prize Presentation and Group Photo Taking	
-----------------	---	--

### EVENT GROUND ACCESS

Entry to the paddock is via the Main Gate (marked in red). Participants' vehicles—whether track cars, support vehicles, or personal vehicles—are permitted to cross the competition area for access. Only registered participants may bring support and personal vehicles into the paddock; all others must exit the area.

Failure to comply with this policy, including unauthorized vehicle entry, may result in participant's participation from the event.

**All vehicles and belongings must clear by 1.45pm.**

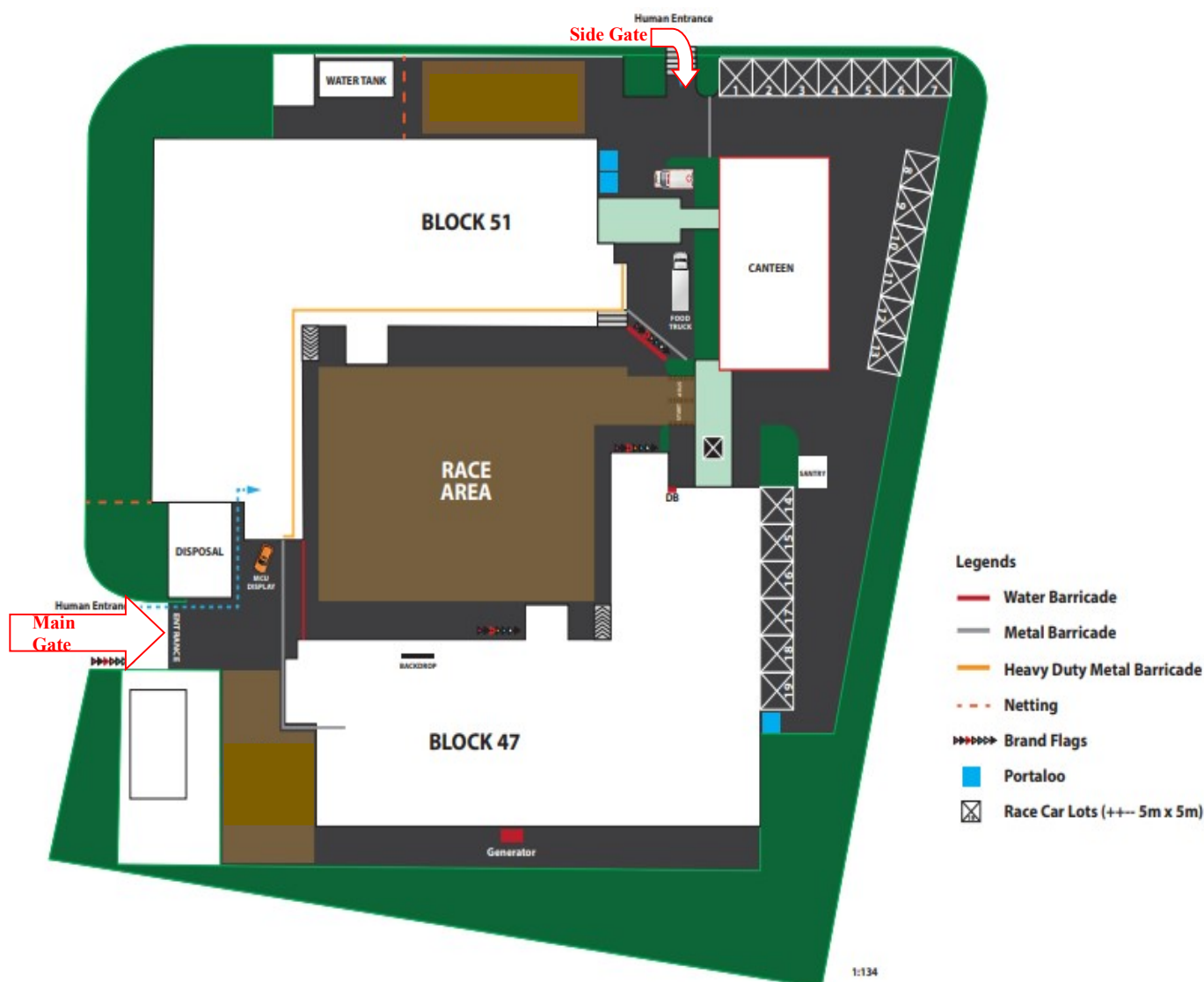

## IMPORTANT NOTES:

**Driver Sign-In Requirements:** All drivers must present their valid driver's license, either in physical or digital format, at sign-in.

**Track Familiarization Restrictions:** Drivers are strictly prohibited from using bicycles, rollerblades, skateboards, or any power-assisted wheels to familiarize themselves with the track. Playing music inside the car is not permitted, and no passengers are allowed during practice/demo runs unless they have signed an indemnity form or are registered instructors.

**Speed and Conduct Outside the Circuit:** A speed limit of 10 km/h applies outside the circuit. Any participant found speeding, testing handbrakes, drifting, or performing tire burnouts will be removed from the event. All participants must follow instructions from the marshals at all times.

### **SCRUTINEERING**

**Vehicle Inspection:** Drivers must open their car's bonnet and trunk for a mechanical inspection. All loose items, such as phone holders, sunglasses, air fresheners, water bottles, window blinds/curtains, clip-on rearview mirrors, and driver-side floor mats, must be removed from the car's cabin before scrutineering.

**Eligibility and Compliance:** The MSS Scrutineers will assess the eligibility of all cars in the event. Their decisions are final and at their discretion. Non-compliance will be referred to Chief Instructor, and drivers may be excluded from the event without a refund.

### **ATTIRE**

**Helmet and Dress Code:** Covered shoes. No flipflop, slippers, open toes Sandler.

- long pants, jeans. No skirt, dress, 3/4 pants.
- T shirts, No sleeveless shirts, spaghetti strips, singlets.
- Racing glove is optional.
- Racing shoes is optional.

### **CREW CONDUCT**

**Behavior in the Paddock:** Any drivers or pit crew found smoking, vaping, or behaving disruptively in the paddock, thereby causing a nuisance to others, will be excluded from the event. Drivers found consuming alcoholic beverages will be remove and excluded. Smoking is strictly prohibited within the event grounds (JTC compound) and is only allowed outside the Main Gate.

### **BANNERS AND ADVERTISING**

**No Display of Banners or Promotional Materials:** Pull-up banners, posters, or any form of product/service displays are not allowed in the paddock. Commercial activities, such as videography, distributing brochures or handouts, are strictly prohibited throughout the event, except for sponsors.

### **POST-EVENT**

**Clean-Up:** All participants are requested to clear any trash they leave behind in the paddock area after the event and to depart in an orderly manner. Please refrain from loud departures, such as "pops and bangs."