

# PATIO DOOR INSTALLATION INSTRUCTIONS



READ THESE INSTRUCTIONS COMPLETELY BEFORE STARTING ANY INSTALLATION. FAILURE TO INSTALL AND MAINTAIN OUR PRODUCT ACCORDING TO THESE INSTRUCTIONS MAY VOID ANY PRODUCT WARRANTY AND MAY ALSO LEAD TO PRODUCT FAILURE. THESE ARE GENERIC INSTRUCTIONS INTENDED TO COVER MOST COMMON SITUATIONS, WHICH MAY NOT BE APPROPRIATE FOR ALL INSTALLATIONS DUE TO BUILDING DESIGN, CONSTRUCTION MATERIALS, METHODS USED, OR BUILDING/SITE CONDITIONS. CONSULT A CONTRACTOR OR ARCHITECT FOR RECOMMENDATIONS.

**PLEASE VISIT OUR WEBSITE AT [WWW.MGMINDUSTRIES.COM](http://WWW.MGMINDUSTRIES.COM)  
OR CALL US AT 1-800-476-5584 FOR MORE INFORMATION.**

**NOT FOLLOWING THESE INSTRUCTIONS COULD RESULT IN PRODUCT DAMAGE, INJURY, OR PROPERTY DAMAGE.**

## **HANDLING:**

- INSPECT UNITS UPON ARRIVAL. REPORT ISSUES TO YOUR MGM DISTRIBUTOR OR MGM.
- DO NOT CARRY OR LAY FLAT. STACK UNITS AS VERTICAL AND TIGHTLY AS POSSIBLE TO AVOID BOWING.

**TOOLS/MATERIALS REQUIRED:** MEASURING TAPE, HAMMER, PHILLIPS HEAD SCREWDRIVER, CORDLESS DRILL, PLASTIC SHIMS, LEVEL, FASTENERS (NAILS OR SCREWS), SILICONE

## **DOCUMENT OVERVIEW:**

- 1) MAIN UNIT INSTALLATION (PAGES 3-4)
- 2) SINGLE SCREEN INSTALLATION (PAGE 5)
- 3) BI-PARTING SCREEN INSTALLATION (PAGES 6-8)
- 4) OPERATING PANEL REVERSAL – 8005 ONLY (PAGE 9)
- 5) CRITICAL ITEM CHECKLIST (PAGE 10)
- 6) PRECAUTIONARY NOTES (PAGE 11)

**NOT FOLLOWING THESE INSTRUCTIONS COULD RESULT IN PRODUCT DAMAGE, INJURY, OR PROPERTY DAMAGE.**

## FIGURE OVERVIEWS:

### MAIN FRAME AND PANEL FIGURES

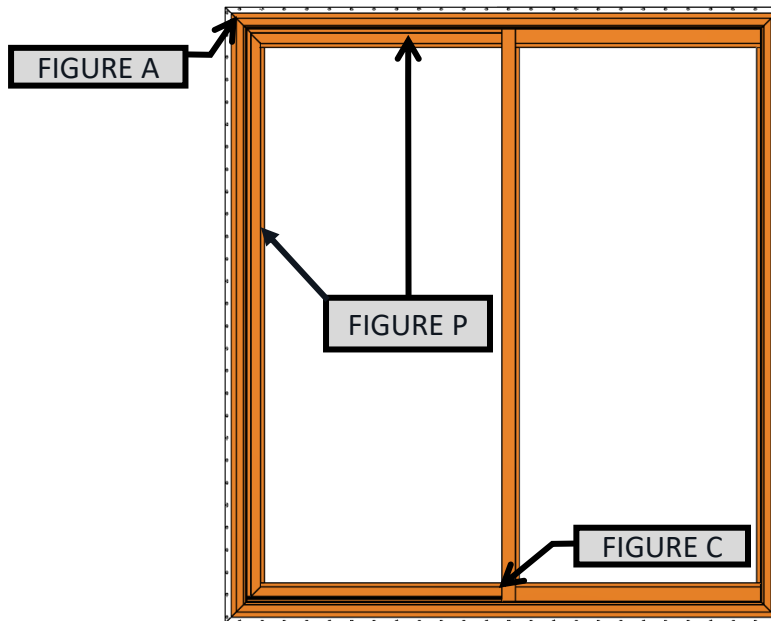

### BI-PARTING SCREEN FIGURES

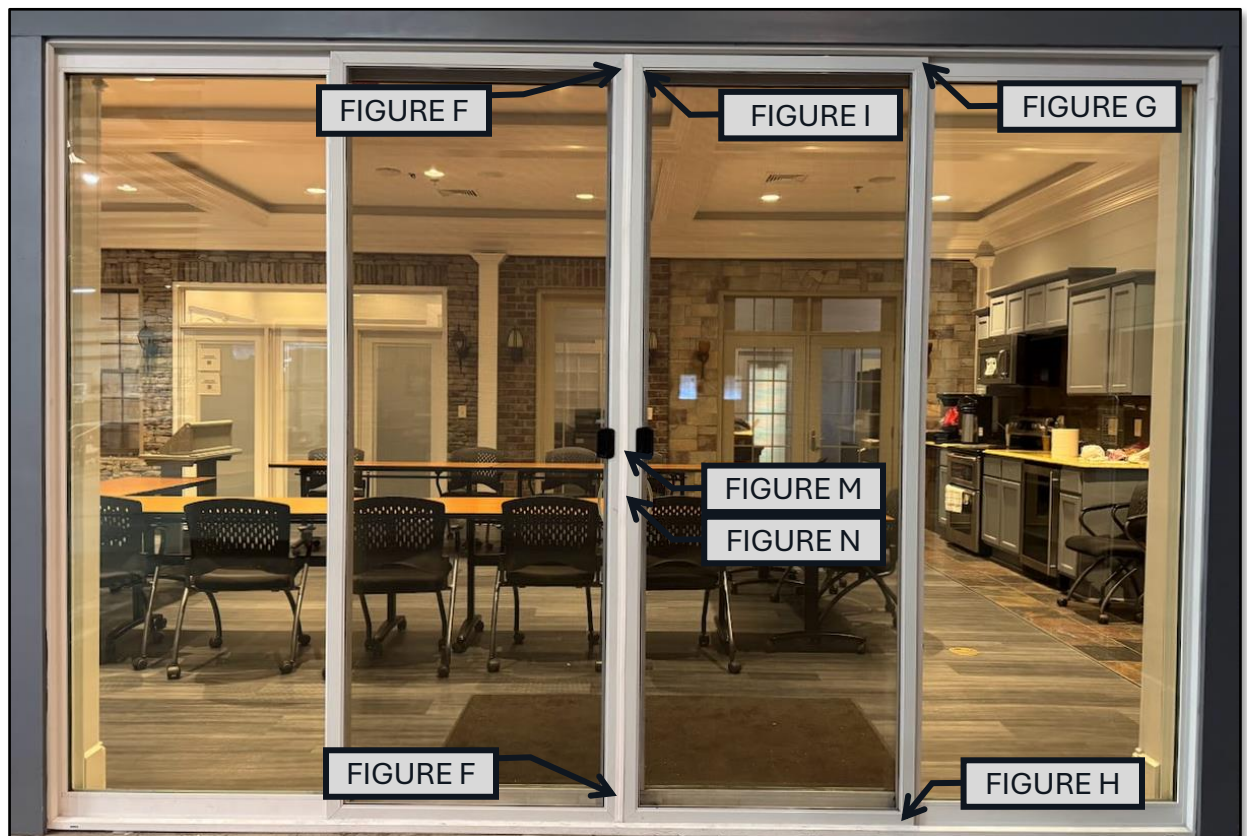

NOT FOLLOWING THESE INSTRUCTIONS COULD RESULT IN PRODUCT DAMAGE, INJURY, OR PROPERTY DAMAGE.

## SEQUENCE:

- 1) ENSURE THE ROUGH OPENING IS ½" WIDER AND ½" TALLER THAN THE UNIT SIZE.
- 2) ENSURE THE ROUGH OPENING, INCLUDING SUB-FLOOR, ARE PLUMB, LEVEL, AND SQUARE WITH ALL OBSTRUCTIONS, DEBRIS, AND DUST CLEARED TO ALLOW PROPER INSTALLATION.
- 3) REMOVE ALL PACKAGING MATERIALS EXCEPT FOR THE SUPPORTS HOLDING THE OPERATING PANEL SECURELY IN PLACE.
- 4) CONFIRM DOOR OPERATES IN DESIRED/REQUIRED DIRECTION.
- 5) ALL 2-PANEL DOORS WILL COME WITH THE OPERATING AND FIXED PANELS FULLY INSTALLED IN THE MAIN FRAME. ALL 3- OR 4-PANEL DOORS WILL HAVE THE OPERATING PANELS SHIPPED WITH THEM BUT NOT INSTALLED. THESE WILL BE INSTALLED IN THE MAIN FRAME AFTER THE MAIN FRAME IS INSTALLED IN THE OPENING.
- 6) APPLY A 1/2" WIDE BEAD OF SILICONE SEALANT AROUND THE INTERIOR PERIMETER OF THE NAILING FIN. THIS BEAD SHOULD COVER ALL THE PRE-PROCESSED NAILING FIN HOLES (SEE **FIGURE A**) IF DONE CORRECTLY.
- 7) APPLY A 3/4" WIDE BEAD OF SILICONE DIRECTLY TO THE SUBFLOOR, NOT THE DOOR UNIT. RUN A STRAIGHT BEAD FROM JAMB TO JAMB ALONG THE INTERIOR AND EXTERIOR EDGES OF THE BOTTOM OF THE ROUGH OPENING TO SEAL THE DOOR SILL. NEXT, APPLY A SWEEPING BACK-AND-FORTH 3/4" BEAD ACROSS THE WIDTH OF THE OPENING BETWEEN THE TWO STRAIGHT BEADS, AS SHOWN BY THE BLACK LINES IN **FIGURE B**. ENSURE THE SWEEPING PATTERN MAKES CONTACT WITH BOTH STRAIGHT BEADS TO CREATE A CONTINUOUS SEAL.
- 8) PLACE DOOR UNIT INTO ROUGH OPENING AND ENSURE UNIT IS PLUMB, LEVEL, AND SQUARE. IF THE UNIT DOES NOT MEET ANY REQUIREMENT(S), USE SHIMS AS NECESSARY. USING MORTAR TO LEVEL THE SILL WILL CREATE A MORE STABLE, EVEN SILL THAN SHIMS ALONE.
- 9) SECURE IN ROUGH OPENING WITH FASTENERS (MINIMUM OF 2" IN LENGTH) IN, AT MINIMUM, EVERY OTHER PRE-PROCESSED HOLE IN THE NAILING FIN.
- 10) COVER NAILING FIN WITH A CONSTRUCTION-GRADE BUILDING TAPE THAT OVERLAPS THE BUILDINGS EXTERIOR SHEATHING FOR THE BEST WATERPROOF SEAL.
  - 1) FOLLOW BUILDING TAPE MANUFACTURER'S INSTRUCTIONS FOR APPLYING TAPE WHILE ENSURING THE LENGTH OF TAPE EXTENDS AT LEAST 7" BEYOND THE FRAME IN ALL DIRECTIONS WITH APPLICATION STARTING AT SILL THEN TO JAMBS THEN FINALLY THE HEAD.
  - 2) DO NOT ALLOW ANY BUBBLES, CREASING, OR GAPS IN FLASHING.
- 11) ENSURE THE SILL TRACK IS FREE OF DIRT AND DEBRIS BEFORE MOVING FORWARD.

**FIGURE A**

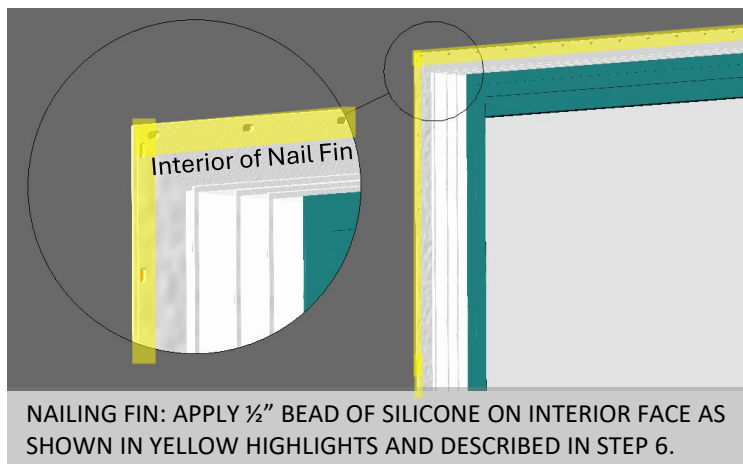

**FIGURE B**

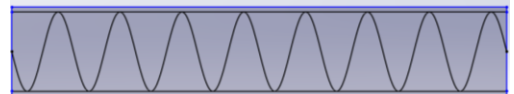

**NOT FOLLOWING THESE INSTRUCTIONS COULD RESULT IN PRODUCT DAMAGE, INJURY, OR PROPERTY DAMAGE.**

## SEQUENCE:

**NOTE:** THE NEXT STEP(S) WILL DEPEND ON YOUR UNIT AND ACCESSORIES. IF THE UNIT IS A 3- OR 4-PANEL UNIT WITH THE OPERATING PANEL(S) SHIPPED SEPARATELY, CONTINUE ON TO STEP 12. **SINGLE SCREEN INSTALLATION** IS DESCRIBED ON PAGE 5. **BI-PARTING SCREEN INSTALLATION** IS DESCRIBED ON PAGES 6-8. **OPTIONAL PANEL REVERSAL** (ONLY AVAILABLE ON 8005 UNITS AND WILL REQUIRE ORDERING NEW INTERIOR AND EXTERIOR INTERLOCKS) IS DESCRIBED ON PAGE 9.

12. INSERT THE TOP OF THE PANEL INTO THE INNER TRACK HEAD FROM THE EXTERIOR WHILE LIFTING THE BOTTOM OF THE PANEL OVER THE ROLLING TRACK AND PLACING THE PANEL DOWN INTO THE TRACK. CHECK FOR FREE ROLLING MOTION.
13. MOVE THE PANEL TO WITHIN 1/8" OF THE JAMB TO ADJUST ROLLER HEIGHT AND PLUMB THE PANEL IN THE FRAME. ROLLING PANEL SHOULD RECESS INTO THE TRACK AT THE HEAD (TOP) BY APPROXIMATELY 7/16". ROLLERS ARE ADJUSTED USING A PHILLIPS HEAD SCREW DRIVER (**DO NOT USE A POWER DRILL FOR ROLLER ADJUSTMENTS**) IN AN OPENING AT THE BOTTOM OF THE DOOR. SEE **FIGURE C**. CLOCKWISE ROTATION RAISES THE PANEL.
14. LOCK AND HANDLE INSTALLATION SHOULD BE DONE ACCORDING TO THE INSTRUCTIONS INCLUDED IN THE LOCK AND HANDLE KIT STAPLED TO THE DOOR.
  - A. MUST KNOCK OUT HOLE IN HANDLE SET. LAY HANDLE ON A SOFT SURFACE THEN TAP OUT HOLE.
15. NOTE: IT MAY BE NECESSARY TO RAISE THE STEEL REINFORCEMENT IN THE LOCK STILE SO THE HOLES WILL ALIGN TO THE LOCK.
16. THE HOOK ON THE MORTISE LOCK CAN BE ADJUSTED AS SHOWN IN THE LOCK INSTRUCTIONS INSET IMAGE. LEAVE ABOUT 1/8" OF MOVEMENT TO ALLOW FOR DOOR/FRAME SHIFTING WHILE PROVIDING A SECURE LOCK.

**FIGURE C**

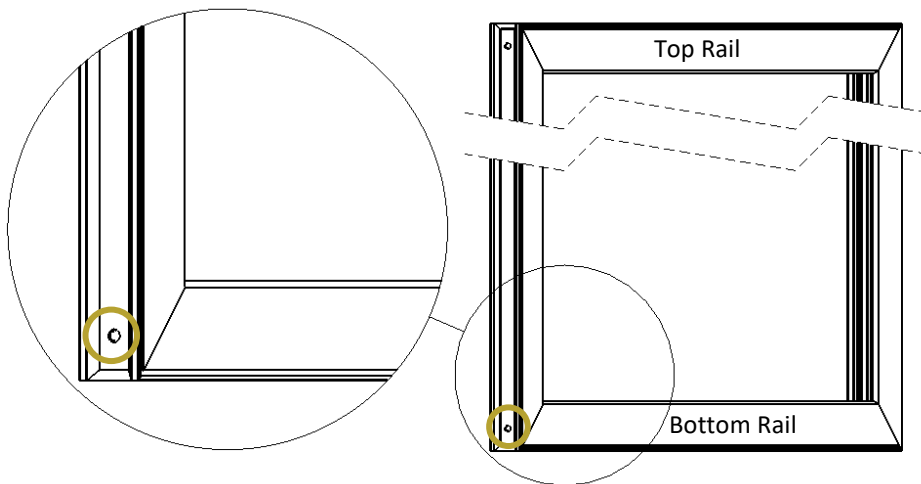

**NOT FOLLOWING THESE INSTRUCTIONS COULD RESULT IN PRODUCT DAMAGE, INJURY, OR PROPERTY DAMAGE.**

## SINGLE SCREEN INSTALLATION SEQUENCE:

- 1) IF THE UNIT HAS A SINGLE SCREEN DOOR, CONTINUE ON WITH THESE INSTRUCTIONS. IF THE UNIT HAS 2 SCREEN DOORS (ONLY AVAILABLE ON 3- OR 4-PANEL 9000 UNITS), REFER TO THE **BI-PARTING SCREEN INSTALLATION** SECTION ON PAGES 6-8.
- 2) REMOVE ALL PACKAGING FROM THE SCREEN DOOR INCLUDING THE LATCH KIT CONSISTING OF A HOOK LATCH AND 2 SCREWS IN A SMALL PLASTIC BAG. SAVE THE LATCH KIT FOR LATER.
- 3) FOR THE SINGLE SCREEN DOOR, MAKE SURE BOTH THE TOP AND BOTTOM ROLLERS OF THE SCREEN DOOR CAN FULLY COMPRESS. ABOUT 1/16" OF THE ROLLER WILL STILL BE EXPOSED BEYOND THE FRAME. IF THEY CANNOT FULLY COMPRESS, USE A PHILLIPS HEAD SCREWDRIVER (**DO NOT USE A POWER DRILL FOR ROLLER ADJUSTMENTS**) ON THE ADJUSTMENT SCREWS, WHICH ARE AT THE SAME RELATIVE LOCATIONS AS SHOWN IN **FIGURE C** FOR THE OPERATING PANEL OF THE MAIN DOOR. COUNTERCLOCKWISE WILL ALLOW THE ROLLERS TO COMPRESS WHILE CLOCKWISE WILL EXTEND THEM.
- 4) FROM THE EXTERIOR, LIFT THE SCREEN INTO THE SCREEN TRACK IN THE HEAD, FULLY COMPRESSING THE ROLLERS, THEN TILT THE BOTTOM TOWARDS THE INTERIOR UNTIL ABOVE THE SILL SCREEN TRACK. BE CAREFUL NOT TO SCRAPE THE SILL WITH THE ROLLERS. A FLAT ITEM/TOOL SUCH AS A PUTTY KNIFE MAY BE NECESSARY TO COMPRESS THE LOWER ROLLERS SO THAT THEY CLEAR THE SILL WITHOUT SCRAPING.
  - A. **NOTE:** 9000 SERIES UNITS HAVE A SIMPLE OPEN TRACK IN THE HEAD AND SILL. 8005 SERIES UNITS HAVE AN OPEN TRACK IN THE HEAD AND A RAIL TRACK THAT BOTH LOWER ROLLERS WILL STRADDLE IN THE SILL.
- 5) WHEN ALLOWING THE SCREEN TO SETTLE INTO/ONTO THE SILL TRACK, MAKE SURE IT WILL NOT FALL OUT OF THE HEAD TRACK BEFORE YOU ADJUST THE ROLLERS TO CENTER THE SCREEN.
- 6) USE THE ADJUSTMENT SCREWS TO TIGHTEN THE SCREEN FRAME TO A SECURE BUT NOT FULLY TIGHT FIT. THERE SHOULD BE ABOUT 1/8" OF VERTICAL MOVEMENT POSSIBLE FOR THE SCREEN TO PREVENT BINDING.
- 7) TEST SCREEN OPERATION ALONG THE FULL DISTANCE OF THE TRACK.
- 8) MEASURE FROM THE TOP OF THE SILL'S SCREEN TRACK (9000) OR RAIL (8005) TO THE TOP OF THE BUILT-IN SLIDING LATCH ON THE SCREEN DOOR. MAKE SURE THE LATCH IS IN THE UP POSITION WHEN MEASURED AS SHOWN IN **FIGURE D**.
- 9) INSTALL THE HOOK LATCH TO INSIDE OF THE JAMB SCREEN TRACK BY MEASURING FROM THE LIP OF THE SILL TRACK (9000) OR RAIL (8005) WITH AN ADDITIONAL 1/8" ADDED TO THE HEIGHT MEASURED IN STEP 14 AS SHOWN IN **FIGURE E**.
- 10) USE 1 OF THE INCLUDED SCREWS FROM THE LATCH KIT TO HOLD THE HOOK LATCH IN PLACE.
- 11) TEST LOCK OPERATION. IF THERE ARE ISSUES WITH THE LOCKING MECHANISM, RE-MEASURE BOTH LATCH (IN "UP" POSITION) AND HOOK LATCH THEN ADJUST AS NEEDED UNTIL PROPER OPERATION OCCURS.
- 12) IF LOCK OPERATES CORRECTLY, USE THE OTHER SCREW FROM THE LATCH KIT TO FULLY SECURE THE HOOK LATCH.

**FIGURE D**

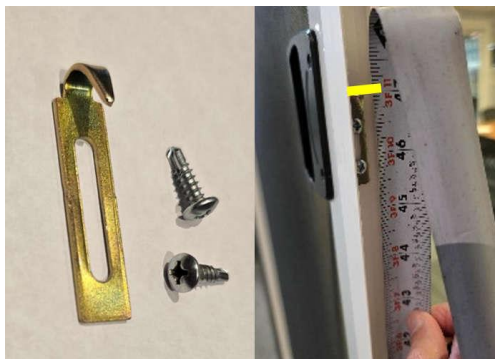

**FIGURE E**



**NOT FOLLOWING THESE INSTRUCTIONS COULD RESULT IN PRODUCT DAMAGE, INJURY, OR PROPERTY DAMAGE.**



## BI-PARTING SCREEN INSTALLATION SEQUENCE:

- 1) ONCE THE MAIN DOORS, INCLUDING THE INOPERABLE AND OPERABLE PANELS, ARE FULLY INSTALLED, THE DOOR IS READY FOR THE SCREEN DOORS TO BE INSTALLED.
- 2) MAKE SURE BOTH THE TOP AND BOTTOM ROLLERS ON THE SCREEN DOOR FRAME CAN FULLY COMPRESS. THERE WILL BE ABOUT 1/16" OF THE ROLLER EXPOSED BEYOND FRAME WHEN FULLY COMPRESSED. IF THEY CANNOT FULLY COMPRESS, USE A PHILLIPS HEAD SCREWDRIVER (DO NOT USE A POWER DRILL) ON THE ADJUSTMENT SCREWS, LOCATED AT EACH CORNER OF THE SCREEN AS SHOWN BELOW IN **FIGURE F**, TO BACK UP THE SET SCREW TO THE NECESSARY DISTANCE BY TURNING THE SCREW COUNTERCLOCKWISE UNTIL FULL COMPRESSION IS POSSIBLE.
- 3) GRASP THE SIDES OF THE SCREEN AND LIFT THE TOP INTO THE SCREEN CHANNEL IN THE HEAD OF THE DOOR FRAME. MAKE SURE TO FULLY COMPRESS THE TOP ROLLERS BY LIFTING UPWARDS.
- 4) ROTATE THE BOTTOM OF THE SCREEN FRAME TOWARDS THE INTERIOR UNTIL IT ALIGNS WITH THE SCREEN CHANNEL IN THE SILL OF THE DOOR FRAME. TO AVOID SCRAPPING THE ROLLERS AGAINST THE SILL, IT MAY BE NECESSARY TO USE A FLAT TOOL SUCH AS A PUTTY KNIFE TO COMPRESS THE BOTTOM ROLLERS UPWARDS AS THEY PASS OVER THE FRONT OF THE SCREEN CHANNEL IN THE SILL.
- 5) GENTLY ALLOW THE FRAME TO SIT DOWN INTO THE SILL'S SCREEN CHANNEL AND ENSURE IT WILL NOT FALL OUT OF THE HEAD AND SILL SCREEN CHANNELS.
- 6) USE THE ADJUSTMENT SCREWS TO TIGHTEN THE SCREEN FRAME (TURNING CLOCKWISE TO EXTEND THE ROLLERS) INTO A SECURE BUT NOT TIGHT FIT THAT IS LEVEL WITHIN THE DOOR FRAME. THE CORRECT FIT WILL ALLOW FOR ABOUT 1/8" VERTICAL MOVEMENT WHILE BEING LEVEL. ENSURE PROPER ADJUSTMENT BY OPERATING THE SCREEN DOOR FRAME ALONG ITS FULL PATH. IF ANY TRAVEL ISSUES OCCUR, ADJUST AS NEEDED.
- 7) REPEAT STEPS 2-6 FOR THE SECOND SCREEN FRAME. IMAGE.
- 8) MEASURE ALONG THE NON-OPERATING/FIXED DOOR PANEL'S FRAME FROM THE FRONT EDGE OF THE SCREEN CHANNEL IN THE HEAD OF THE DOOR FRAME (**FIGURE G**) DOWN TO THE REAR EDGE OF THE SCREEN CHANNEL IN THE SILL OF THE DOOR FRAME (**FIGURE H**).

**FIGURE F**



**FIGURE G**

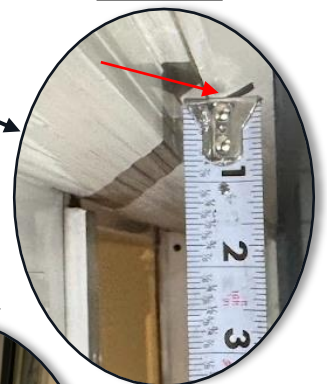

**FIGURE H**



Round measurement up to the nearest 1/8 to ensure first cut is not too short

**NOT FOLLOWING THESE INSTRUCTIONS COULD RESULT IN PRODUCT DAMAGE, INJURY, OR PROPERTY DAMAGE.**

## BI-PARTING SCREEN INSTALLATION SEQUENCE:

- 9) SUBTRACT 1/8" FROM THE MEASUREMENT IN STEP 8 AND CUT THE 96" H-PROFILE ASTRAGAL TO THAT LENGTH. BE CAREFUL NOT TO CUT THE ASTRAGAL TOO SHORT.
- 10) PLACE THE ASTRAGAL CENTERED ON THE DESIRED SCREEN DOOR FRAME THEN INSPECT FOR VISUAL INTERFERENCE ON THE EXTERIOR EDGE OF THE SCREEN CHANNEL AS SHOWN IN **FIGURE I**.
- 11) THE ASTRAGAL IS NOT SYMMETRICAL. THE TIGHTER SIDE (INDICATED IN **FIGURE J**) SHOULD BE THE ONE AGAINST THE SCREEN IT WILL BE FASTENED TO.
- 12) AFTER ENSURING THE ASTRAGAL IS CLEAR OF THE EXTERIOR EDGE OF THE SCREEN CHANNEL, ATTEMPT TO OPERATE THE DOOR ALONG ITS FULL PATH TO ENSURE NO BINDING OCCURS. IF ANY INTERFERENCE IS FOUND, THE ASTRAGAL WILL NEED TO BE TRIMMED FURTHER OR YOU MAY CHOOSE TO "NOTCH" THE ASTRAGAL IF THE INTERFERENCE IS ONLY ON THE INTERIOR EDGE OF THE SCREEN CHANNEL. DETAILS FOR THE OPTIONAL NOTCHING PROCEDURE ARE BELOW IN STEPS 18-20.
- 13) ONCE THE DOOR OPERATES CORRECTLY WITH THE ASTRAGAL IN PLACE, USE THE 6 INCLUDED 8-18 X 3/4 PH #7 FLAT HEAD SCREWS (**FIGURE K**) TO PERMANENTLY FASTEN THE ASTRAGAL IN PLACE AGAINST THE SCREEN FRAME.
- 14) START THE TOP SCREW ~2" FROM THE TOP OF THE ASTRAGAL AND THE BOTTOM SCREW ~2" FROM THE BOTTOM OF THE ASTRAGAL THEN EVENLY SPACE THE OTHER 4 SCREWS ALONG THE LENGTH OF THE ASTRAGAL WITHOUT INTERFERING WITH LATCH FEATURES. SEE FIGURE H.
- 15) INSTALL THE LATCH DEVICE ON THE ASTRAGAL BY MEASURING FROM THE LIP OF THE SILL SCREEN CHANNEL TO THE TOP OF THE LATCH ON THE NON-ASTRAGAL SCREEN DOOR AS SHOWN IN **FIGURE M**.

**FIGURE I**



**FIGURE L**



**FIGURE J**



**FIGURE K**



**FIGURE M**



**NOT FOLLOWING THESE INSTRUCTIONS COULD RESULT IN PRODUCT DAMAGE, INJURY, OR PROPERTY DAMAGE.**

## **BI-PARTING SCREEN INSTALLATION SEQUENCE:**

- 16) PLACE THE LATCH HOOK INTO THE ASTRAGAL CHANNEL AND MEASURE SO THAT THE LATCH HOOK IS APPROXIMATELY 1/8" ABOVE THE TOP OF THE LATCH AS SHOWN IN **FIGURE N**. MARK AS NECESSARY.
- 17) USE 1 OF THE INCLUDED LATCH KIT SCREWS TO SECURE THE LATCH HOOK AND TEST THE SCREEN LATCH. IF THE LATCH WILL NOT CATCH ON THE LATCH HOOK, RE-MEASURE THE LATCH HOOK TO DETERMINE IF IT IS CORRECTLY PLACED.
- 18) IF THE LATCH MECHANISM OPERATES PROPERLY, USE THE 2ND LATCH KIT SCREW TO SECURE THE LATCH HOOK.

**FIGURE N**

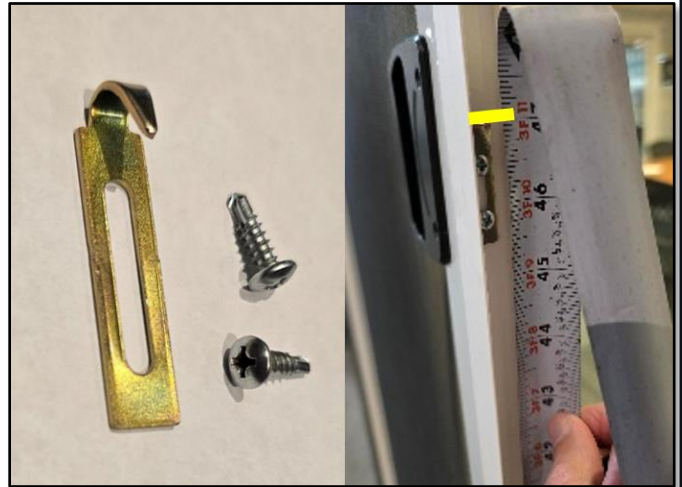

## **BI-PARTING SCREEN INSTALLATION – NOTCHING THE ASTRAGAL (OPTIONAL) SEQUENCE:**

- 19) IF DESIRED, THE ASTRAGAL MAY BE NOTCHED TO ACCOUNT FOR THE SCREEN CHANNEL DIFFERENCES BETWEEN INTERIOR AND EXTERIOR EDGE HEIGHTS.
- 20) THE ASTRAGAL CAN BE CUT 1/2" IN FROM EITHER END ON THE INTERIOR SIDE. **FIGURE O** SHOWS THE AREA TO BE REMOVED INSIDE THE SHADED BOX. THIS WILL ALLOW THE ASTRAGAL TO NOT CONTACT THE INTERIOR EDGE OF THE SCREEN CHANNEL WILL KEEPING THE EXTERIOR-FACING PORTION TIGHTER TO THE EXTERIOR EDGE OF THE SCREEN CHANNEL.
- 21) STEP 19 MAY NEED TO BE REPEATED FOR BOTH SIDES OF THE ASTRAGAL "SPINE" ON THE INTERIOR-FACING EDGE OF THE ASTRAGAL FOR BEST PERFORMANCE. A SMALL CLIP (LESS THAN 1/8") OF THE "SPINE" MAY ALSO BE TAKEN OUT TO PREVENT CONTACT WITH THE FRAME CHANNEL.

**FIGURE O**



**SCREENS ARE INTENDED TO PROVIDE VENTILATION WHILE KEEPING OUT INSECTS. THEY ARE NOT INTENDED FOR SECURITY OR TO PREVENT FALLS AND SHOULD NOT BE RELIED UPON FOR CHILD OR PET CONTAINMENT.**

**NOT FOLLOWING THESE INSTRUCTIONS COULD RESULT IN PRODUCT DAMAGE, INJURY, OR PROPERTY DAMAGE.**



## PANEL REVERSAL (8005 ONLY) SEQUENCE:

- 1) TO REVERSE THE OPERATIONAL AND FIXED PANELS ON THE DOOR UNIT, YOU WILL NEED TO ORDER REPLACEMENT INTERLOCK AND EXTERIOR INTERLOCKS. THESE INTERLOCKS ARE NOT REVERSIBLE OR INTERCHANGEABLE.
- 2) WHEN THE NEW INTERLOCKS ARRIVE AND REVERSAL CAN BEGIN, REMOVE 6 SCREWS (3 ALONG THE HEAD AND 3 ALONG THE JAMB) THAT HOLD THE FIXED PANEL SECURELY IN THE MAIN FRAME.
- 3) TO REMOVE THE PANELS, ACCESS THEM FROM THE EXTERIOR SIDE OF THE DOOR..
- 4) REMOVE THE OLD INTERLOCK (SNAP FIT, NO FASTENERS) FROM THE FIXED PANEL.
- 5) LIFT THE PANEL INTO THE HEAD TRACK THEN TILT THE BOTTOM TOWARDS THE EXTERIOR AND REMOVE THE PANEL. BE CAREFUL NOT TO DAMAGE THE HEAD, SILL, OR PANEL.
- 6) ADJUST THE OPERATIONAL PANEL'S ROLLERS (SEE **FIGURE C**) TO FULLY COMPRESSED BY TURNING THE ADJUSTMENT SCREW COUNTERCLOCKWISE WITH A PHILLIPS HEAD SCREWDRIVER. **DO NOT USE A POWER DRILL FOR ROLLER ADJUSTMENTS.**
- 7) REPEAT STEPS 4 AND 5 FOR THE OPERATING PANEL.
- 8) THE ROLLERS FROM THE BOTTOM OF THE OPERATIONAL PANEL WILL NEED TO BE REMOVED AND REINSTALLED ON THE OPPOSITE END. EACH HAS 2 SCREWS INTO A BRACKET.
- 9) RE-INSTALL THE OPERATING PANEL WITH THE GLAZING BEAD TOWARDS THE EXTERIOR BY LIFTING THE TOP OF THE PANEL INTO THE INTERIOR HEAD TRACK THEN TILTING THE LOWER END OF THE PANEL INTO THE SILL TRACK.
- 10) TEST THE ROLLING OPERATION THEN ADJUST THE ROLLERS USING THE SAME METHOD IN **FIGURE C**. TURN THE ADJUSTMENT SCREW CLOCKWISE UNTIL THE ROLLERS EXTEND ENOUGH TO MAKE FIRM CONTACT WITH THE WEATHERSTRIP.
- 11) RE-INSTALL THE FIXED PANEL WITH THE GLAZING BEAD TOWARDS THE EXTERIOR BY LIFTING THE TOP OF THE PANEL INTO THE EXTERIOR HEAD TRACK THEN TILTING THE LOWER END OF THE PANEL ONTO THE SILL TRACK.
- 12) SLIDE THE FIXED PANEL FIRMLY INTO THE JAMB TO THE DESIRED SIDE THEN USE THE SCREWS PREVIOUSLY REMOVED FROM THE FIXED PANEL DURING REMOVAL TO FASTEN THE FIXED PANEL IN PLACE. PLACE SCREWS AT APPROXIMATELY EVEN DISTANCES THROUGH THE WEATHERSTRIPPING CHANNEL ON THE FRAME AND INTO THE SILL AS SHOWN IN **FIGURE P**.

**FIGURE P**

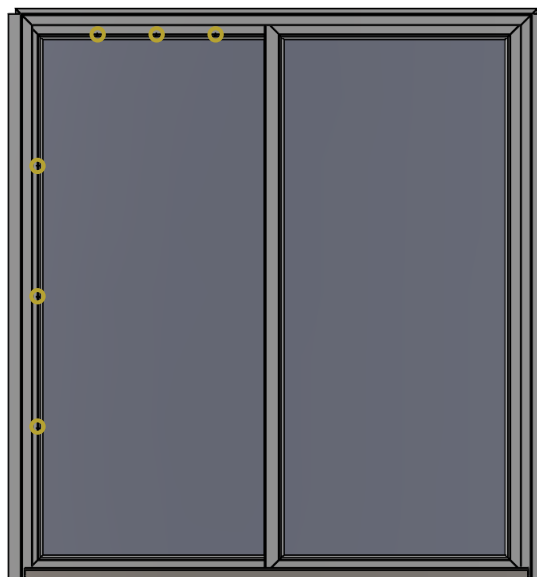

**NOT FOLLOWING THESE INSTRUCTIONS COULD RESULT IN PRODUCT DAMAGE, INJURY, OR PROPERTY DAMAGE.**

### **CRITICAL ITEM CHECKLIST**

- ENSURE DOOR IS PLUMB, LEVEL, AND SQUARE WITHOUT ANY RACKING.
- ENSURE DOOR OPERATES FULLY AND CORRECTLY BEFORE INSTALLATION IF OPERATING PANEL COMES INSTALLED. IF YOU HAVE ISSUES WITH DOOR OPERATION, DO NOT ALLOW THE EXTERIOR OR INTERIOR SURFACES TO BE APPLIED. IF THE SURFACES ARE APPLIED WITH A POORLY INSTALLED DOOR, THE SURFACES WILL HAVE TO BE REMOVED TO ALLOW THE DOOR TO OPERATE CORRECTLY.
- ON THE INTERIOR ROUGH OPENING, ENSURE PROPER SPACING OF ½" ON ALL SIDES IS MAINTAINED FOR THERMAL EXPANSION WITHOUT COMPROMISING WEATHERSTRIP SEALS (SHIM AS NECESSARY).
- EXTERIOR: LEAVE A 1/4" GAP BETWEEN THE FAÇADE AND DOOR FOR THERMAL EXPANSION. SEAL GAP BETWEEN DOOR FRAME AND FAÇADE WITH SILICONE (USE BACKER ROD IF NEEDED). DO NOT ALLOW FAÇADE TO TOUCH THE FRAME.
- SILL AND JAMB NAIL FINES MUST BE ADEQUATELY SEALED BY INSTALLER INCLUDING THE SILL/JAMB NAIL FIN JOINT.
- FASTENERS MUST BE THROUGH THE PRE-PUNCHED NAIL FIN HOLES AND DRIVEN STRAIGHT. DO NOT TOENAIL OR DRIVE FASTENERS AT AN ANGLE. DO NOT START FASTENING AT THE SILL. DO NOT OVERDRIVE SCREWS OR NAILS.
- THE USE OF HARSH CHEMICALS (INCLUDING BUT NOT LIMITED TO: ACETONE, ALCOHOL, MINERAL SPIRITS, BLEACH, AMMONIA BASED SOLUTIONS, ETC.) WILL VOID THE WARRANTY AS THESE PRODUCTS MAY CAUSE IRREVERSIBLE DAMAGE.
- DO NOT ALTER THE PRODUCT IN ANY WAY UNLESS SPECIFICALLY STATED IN THESE INSTRUCTIONS.

**NOT FOLLOWING THESE INSTRUCTIONS COULD RESULT IN PRODUCT DAMAGE, INJURY, OR PROPERTY DAMAGE.**

## **PRECAUTIONARY NOTES:**

- ALL PACKAGING PRODUCTS (SHIPPING BLOCKS, PADS, ETC.) SHALL BE REMOVED UPON INSTALLATION OR WITHIN TWO WEEKS OF DELIVERY, WHICHEVER COMES FIRST. SHIPPING BLOCKS USED TO WEDGE THE OPERATING PANEL CLOSED DURING SHIPPING SHOULD BE REMOVED UPON INSTALLATION ONLY.
- ALL APPLIED TAPES BY OTHERS MUST BE REMOVED PRIOR TO THE TAPE MANUFACTURERS RECOMMENDED TIME PERIOD.
- METAL FASTENERS AND COMPONENTS COULD CORRODE WHEN USED WITH PRESERVATIVE-TREATED LUMBER. USE APPROVED FASTENERS AND COMPONENTS TO FASTEN WINDOW.
- MGM DOES NOT SUPPLY ANCHORAGE/FASTENER CALCULATIONS AND IS NOT RESPONSIBLE FOR DETERMINING STRUCTURAL ADEQUACY OF THE ANCHORAGE/FASTENERS USE TO INSTALL OUR PRODUCTS, OR THE OPENINGS INTO WHICH THEY ARE INSTALLED. CONTACT THE SITE ENGINEER/ARCHITECT FOR ANCHORAGE/FASTENER CALCULATIONS.
- EXPOSING THE DOOR TO BUILDING (BRICK, SIDING, ETC.) CLEANERS WILL VOID THE WARRANTY. COVER THE EXTERIOR OF THE WINDOW/DOOR WHILE USING BUILDING CLEANERS. THESE CHEMICALS CAN DETERIORATE THE SEALANTS AND PVC OVER TIME.
- DO NOT STORE THE UNITS OUTSIDE, OR IN AN EXTREMELY HOT OR COLD ENVIRONMENT.
- DO NOT STACK VINYL PRODUCTS IN DIRECT SUN LIGHT.
- NEVER STACK DOORS MORE THAN 10 DEEP.
- STACK DOORS AS CLOSE TO VERTICAL AS POSSIBLE, BUT IN NO CASE SHALL THE LEAN BE IN EXCESS OF 10 DEGREES.
- ONLY STACK DOORS ON FLAT GROUND TO AVOID WARPAGE DUE TO UNEVEN PRESSURE.
- WHEN STACKING DOORS, ENSURE DOORS ARE TIGHT TOGETHER ALONG THEIR FULL LENGTH AND DO NOT APPLY UNEVEN PRESSURE TO EACH OTHER AT ANY POINT.
- NEVER PLACE THE DOORS ON TOP OF RUNNERS.
- DO NOT ALLOW MORTAR TO SET UP ON CAPSTOCK/PAINTED WINDOWS AND DOORS. REMOVE MORTAR WITH MILD SOAP AND SOFT BRISTLE BRUSH.
- THE USE OF ACETONE ON PAINTED OR CAPSTOCK SURFACES WILL VOID THE WARRANTY AS THIS PRODUCT MAY CAUSE DISCOLORATION.
- LIVE OR DEAD LOADS TRANSFERRED INTO OUR PRODUCT CAN AFFECT FUNCTIONALITY, DAMAGE FRAME JOINERY OR CAUSE GLASS FAILURES. DEAD LOADS SUCH AS UPPER LEVELS, ROOF, ETC. SHOULD BE CONSTRUCTED BEFORE WINDOW OR DOOR IS INSTALLED.
- ONLY USE AAMA APPROVED MINIMAL EXPANDABLE FOAM INSULATION BETWEEN WINDOW/DOOR AND ROUGH OPENING. THE PRODUCT MUST MEET THE LATEST UPDATE TO AAMA STANDARD 812.
- DO NOT POWER WASH DOORS.
- DOORS HAVE SMALL PARTS. SMALL PARTS IF SWALLOWED COULD POSE A CHOKING HAZARD TO YOUNG CHILDREN. DISPOSE OF UNUSED, LOOSE, OR EASILY REMOVED SMALL PARTS. FAILURE TO DO SO COULD RESULT IN INJURY.

**NOT FOLLOWING THESE INSTRUCTIONS COULD RESULT IN PRODUCT DAMAGE, INJURY, OR PROPERTY DAMAGE.**

**ENJOY YOUR FINISHED PRODUCT!**



**NOT FOLLOWING THESE INSTRUCTIONS COULD RESULT IN PRODUCT DAMAGE, INJURY, OR PROPERTY DAMAGE.**



# **9300/9700 SERIES WITH SINGLE POINT LATCH** **INSTALLATION INSTRUCTION**

OX VIEW

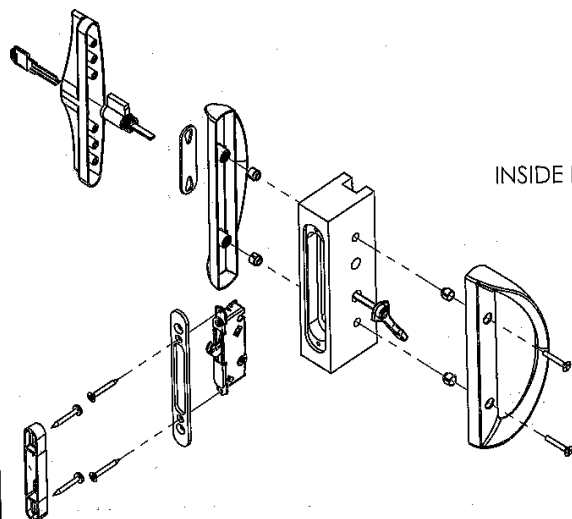

XO VIEW

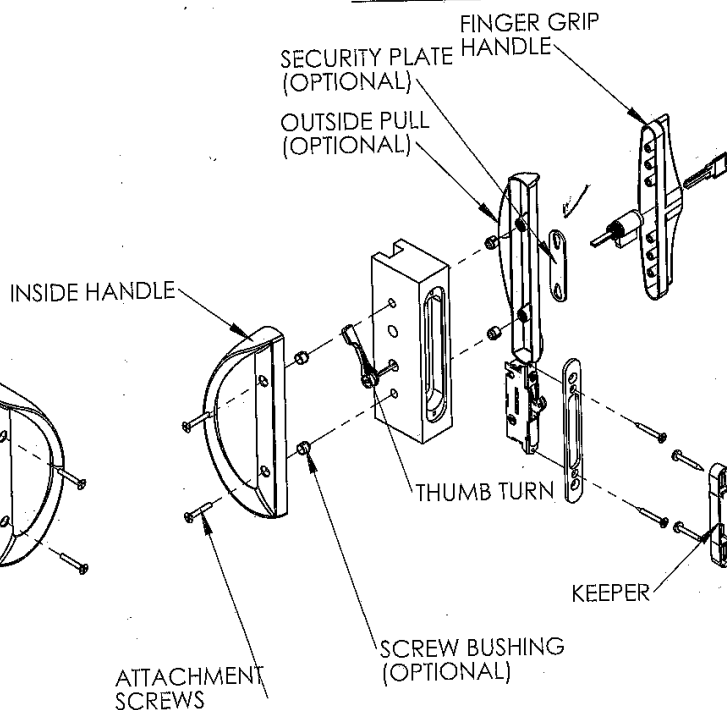

1. Determine the handing direction from the exploded view (XO or OX)
2. Make sure that the door rollers are adjusted so that the moving panel is square with the jamb.
3. Secure the lock in the door stile with the provided screws.
4. Insert the thumb turn lever into the hub of the mortise lock, as shown.
5. Insert screw bushings onto the handles (if supplied).
6. Place the Inside Handle against the door while holding the thumb turn into the slotted hub of the mortise lock. Align the mounting holes of the Outside Pull with the inside handle and install the provided screws.
7. Install the keeper on the jamb with the provided screws. Adjust the keeper for maximum engagement with the lock.
8. Close the door, operate the lock, and check that it latches properly. If necessary, adjust the play by turning the Adjustment Screw just above the lock hook – CW to extend, CCW to retract.

\* HAND TIGHTEN HANDLE ATTACHMENT SCREWS ONLY.  
POWER TOOL MAY CAUSE DAMAGE TO SURFACE FINISH.

#M0059