

# FOR LEASE



## 28,458 SF OFFICE BUILDING

19865 West 156<sup>th</sup> Street | Olathe, Kansas 66062

## ULTRA ENERGY EFFICIENT VERSATILE LAYOUT



### PROPERTY OVERVIEW

Crossroads Real Estate is pleased to present 19865 W 156th Street, a premier leasing opportunity in Olathe, Kansas. Built in 2014, this impressive two-story office property offers up to 28,458 square feet for a full building user. The landlord will consider a multi-tenant configuration to suit smaller tenants on a case-by-case basis.

Both floors have a common breakroom, conference room, restrooms and elevator lobby. Situated on a 3.23+/- acre site, the property features an excellent parking ratio of 5.8 spaces per 1,000 SF with additional room for outdoor tenant amenities. Tenants will benefit from a robust backup generator and an energy efficient geothermal HVAC system designed to enhance operational reliability and help control utility costs (\$8.86 PSF as of YE 2024).

### PROPERTY HIGHLIGHTS

- Available for Lease
- Exceptional Condition | Built in 2014
- Operational Efficiency | Geothermal HVAC system & backup generator
- Abundant Parking | 5.8 spaces per 1,000 SF
- Excellent Accessibility | Convenient access to I-35, K-7, and US-169
- Strong Corporate Presence Nearby
- Zoning | M-2 General Industrial District

RENT: \$22.00 FSG

**HOLLY LARRISON MILLS, MAI, CCIM**

hmills@Crossroads-KC.com

M (816) 808-2540

**JOHN NOLAN**

jnolan@Crossroads-KC.com

M (913) 486-9129

Crossroads Real Estate Group  
O (816) 298-9998  
7227 Metcalf Avenue, Suite 201  
Overland Park, KS 66204



**CROSSROADS**  
REAL ESTATE GROUP

FOR LEASE



# 28,458 SF OFFICE BUILDING

19865 West 156<sup>th</sup> Street | Olathe, Kansas 66062

FIRST FLOOR

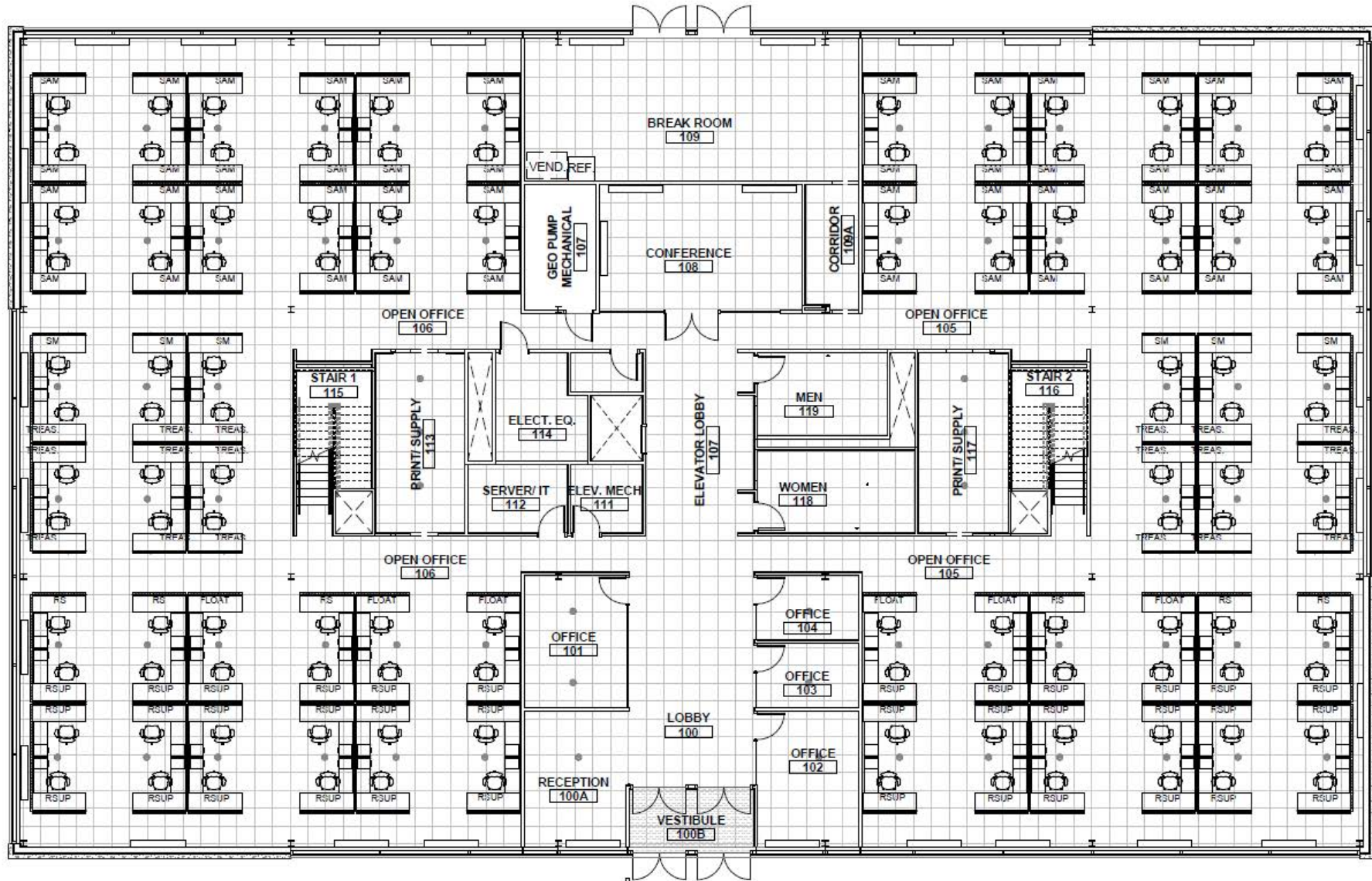

**HOLLY LARRISON MILLS, MAI, CCIM**

hmills@Crossroads-KC.com

M (816) 808-2540

**JOHN NOLAN**

jnolan@Crossroads-KC.com

M (913) 486-9129

Crossroads Real Estate Group  
O (816) 298-9998  
7227 Metcalf Avenue, Suite 201  
Overland Park, KS 66204



**CROSSROADS**  
REAL ESTATE GROUP

FOR LEASE



28,458 SF OFFICE BUILDING

19865 West 156<sup>th</sup> Street | Olathe, Kansas 66062

SECOND FLOOR

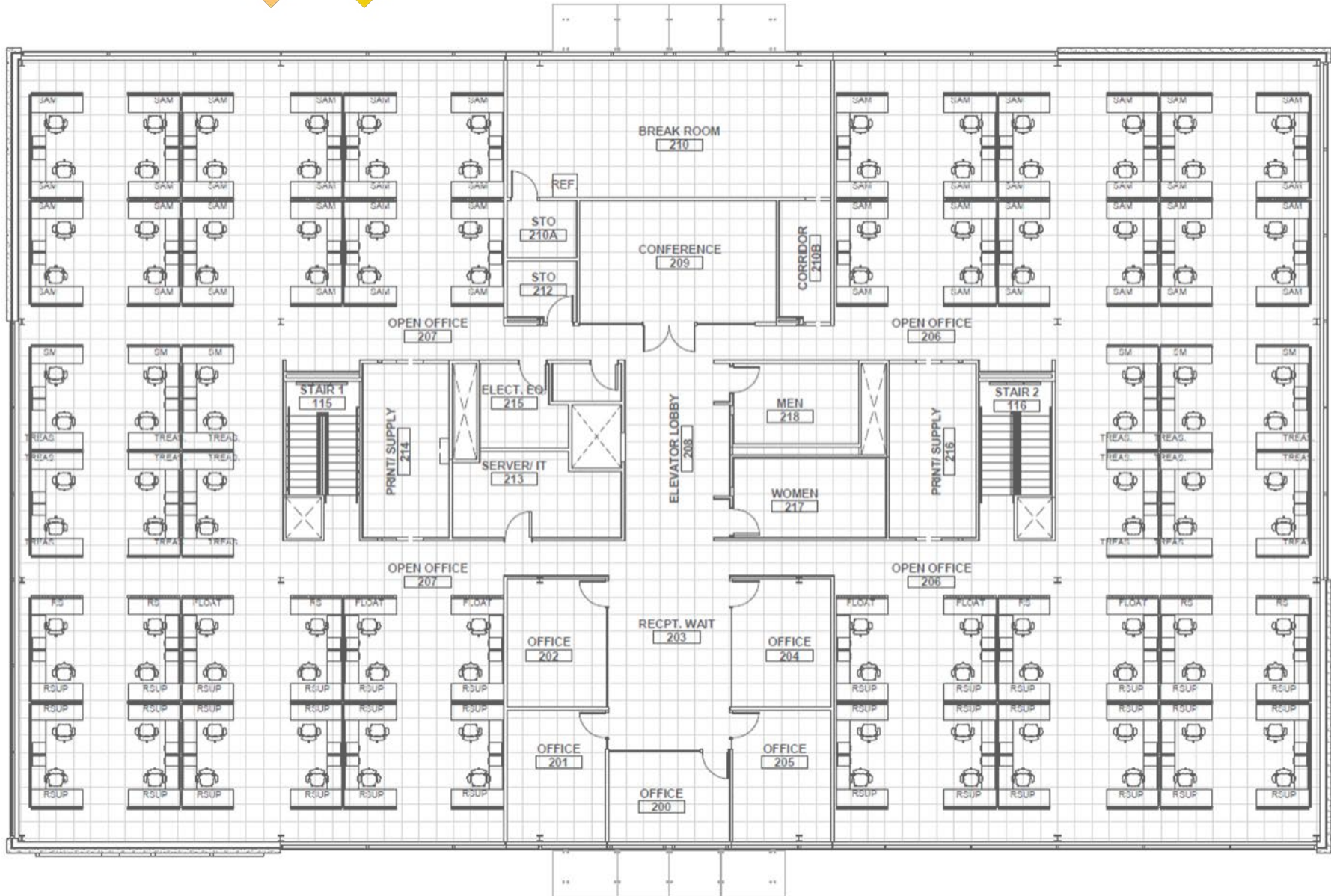

HOLLY LARRISON MILLS, MAI, CCIM

hmills@Crossroads-KC.com

M (816) 808-2540

JOHN NOLAN

jnolan@Crossroads-KC.com

M (913) 486-9129

Crossroads Real Estate Group  
O (816) 298-9998  
7227 Metcalf Avenue, Suite 201  
Overland Park, KS 66204



**CROSSROADS**  
REAL ESTATE GROUP

# FOR LEASE



## 28,458 SF OFFICE BUILDING

19865 West 156<sup>th</sup> Street | Olathe, Kansas 66062

Olathe, Kansas offers one of the metro's premier areas to live, work, and play. Residents here enjoy a high standard of living with an average household income of \$112,682, and an average housing value of \$374,066. The submarket also boasts a highly educated workforce with 51.0% of the population achieving a bachelor's degree or higher, compared to a national average of just 38.0%.

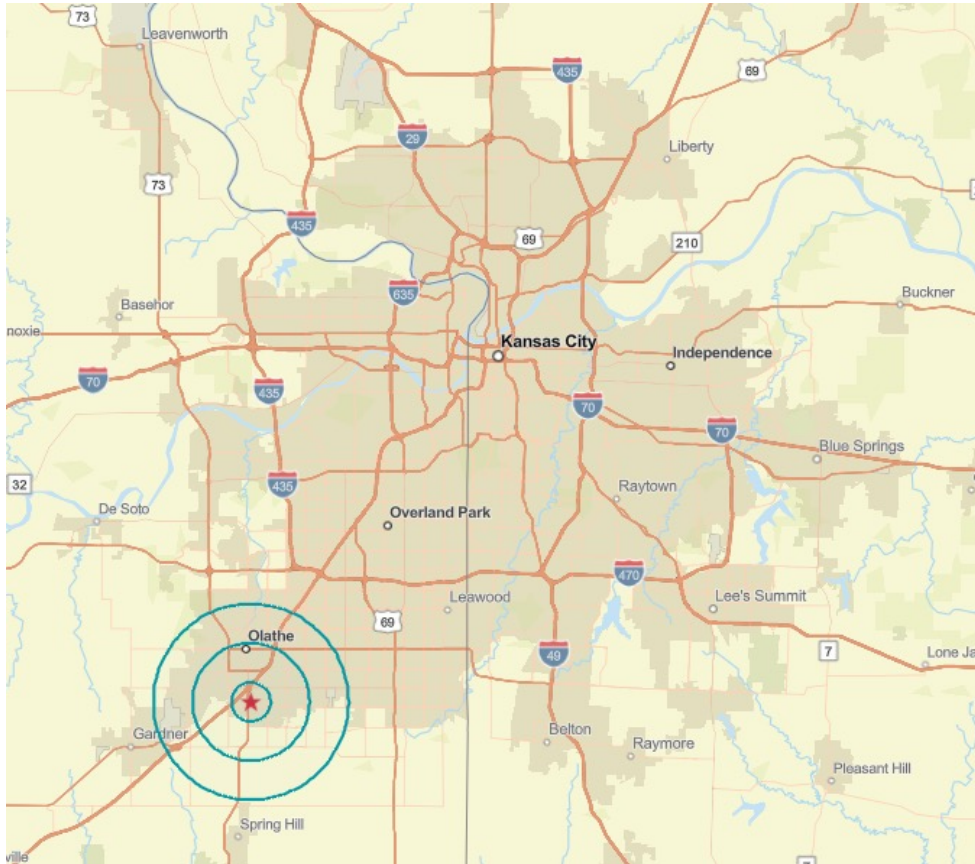

### TOP EMPLOYERS IN OLATHE



### Trade Area Demographic Profile

	1 Mile	3 Mile	5 Mile
<b>Total Population</b>	4,117	57,475	134,601
<b>2025-2030 Growth</b>	1.20%	0.37%	0.50%
<b>Median Age</b>	38.7	36.5	36.8
<b>Daytime Population</b>			
<b>Workers</b>	9,673	34,942	65,811
<b>Residents</b>	1,815	25,431	58,038
<b>Households &amp; Income</b>			
<b>Total Households</b>	1,618	20,167	47,595
<b>Bachelor's Degree+</b>	55.7%	46.3%	49.9%
<b>Median HH Income</b>	\$111,592	\$105,492	\$112,460
<b>Median House Value</b>	\$361,332	\$351,232	\$371,837
<b>Daytime Employment</b>			
<b>Number of Businesses</b>	477	2,177	4,073
<b>Number of Employees</b>	8,704	32,195	57,929

**HOLLY LARRISON MILLS, MAI, CCIM**

hmills@Crossroads-KC.com

M (816) 808-2540

**JOHN NOLAN**

jnolan@Crossroads-KC.com

M (913) 486-9129

Crossroads Real Estate Group  
 O (816) 298-9998  
 7227 Metcalf Avenue, Suite 201  
 Overland Park, KS 66204



**CROSSROADS**  
 REAL ESTATE GROUP

FOR LEASE



## 28,458 SF OFFICE BUILDING

19865 West 156<sup>th</sup> Street | Olathe, Kansas 66062

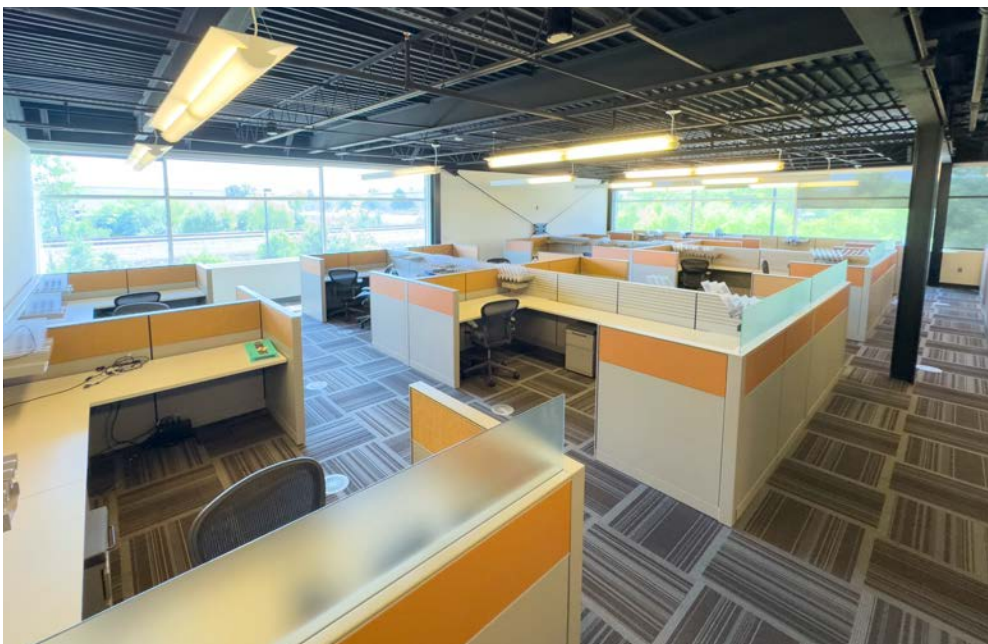

**HOLLY LARRISON MILLS, MAI, CCIM**

hmills@Crossroads-KC.com

M (816) 808-2540

**JOHN NOLAN**

jnolan@Crossroads-KC.com

M (913) 486-9129

Crossroads Real Estate Group  
O (816) 298-9998  
7227 Metcalf Avenue, Suite 201  
Overland Park, KS 66204



**CROSSROADS**  
REAL ESTATE GROUP

FOR LEASE



## 28,458 SF OFFICE BUILDING

19865 West 156<sup>th</sup> Street | Olathe, Kansas 66062



**HOLLY LARRISON MILLS, MAI, CCIM**

hmills@Crossroads-KC.com

M (816) 808-2540

**JOHN NOLAN**

jnolan@Crossroads-KC.com

M (913) 486-9129

Crossroads Real Estate Group  
O (816) 298-9998  
7227 Metcalf Avenue, Suite 201  
Overland Park, KS 66204



**CROSSROADS**  
REAL ESTATE GROUP