

## User Manual SIEMENS ROOM STAT

### Operating Instructions

	1 Main Display	2 Operating Modes
	<ul style="list-style-type: none"> <li> Operating mode selection *</li> <li> Scheduler</li> <li> Fan speed selection</li> <li> Escape</li> <li> Delete schedule</li> <li> Confirm parameters</li> <li> Number of schedules</li> <li> Parameter</li> <li>24.5 Digits for setpoint display Time bar for schedule</li> <li> Digits for setpoint display Time bar for schedule</li> <li>24.5 Digits for setpoint display Time bar for schedule</li> </ul>	<ul style="list-style-type: none"> <li> Holiday mode</li> <li> Protection mode</li> <li> Economy mode</li> <li> Comfort mode</li> <li> Cooling mode</li> <li>AUX Electric heater active</li> <li> Heating mode</li> <li> Scheduler mode</li> <li> Manual changeover</li> <li> Auto mode</li> <li> Temporary timer</li> <li> Fault</li> <li> Button lock</li> <li> Condensation in room (dewpoint sensor active)</li> <li> Automatic fan</li> <li> Fan speed I</li> <li> Fan Speed II</li> <li> Fan Speed III</li> </ul>
<p>18:32 Additional user information, such as time of day</p> <p>AMPM Morning: 12-hour format; Afternoon: 12-hour format</p> <p>°C °F Degrees Celsius or Fahrenheit</p> <p>24.5°C Value with thermometer: Digits for room temperature display</p> <p><b>A</b> Operating mode button *      <b>B</b> Fan mode button</p> <p><b>C</b> Rotary knob      <b>D</b> Protection hospitality mode or scheduler button</p>		

### Changing the room temperature



Turn the rotary knob clockwise to increase, or counterclockwise to decrease the current room temperature setpoint.

*Note: The setting range is 5...40°C, it can be limited by parameters P013 and P016. (for parameter settings, see control parameters on page 2)*

## Adjusting the fan speed

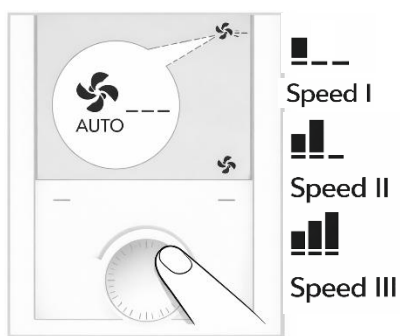

- Press the right button repeatedly until the desired fan mode is reached.
- In auto mode , the fan speed is automatically selected by the thermostat depending on setpoint and current room temperature.
- In Manual Mode, the fan operates independently and runs at the speed set by the users: Speed I/ speed II/ speed III.

## Changing the operating mode

Comfort mode



Economy mode



Protection mode



Auto mode



### 1. Comfort Mode

- In comfort mode, the thermostat maintains the room temperature at the set point which can be adjusted with the rotatory knob.

### 2. Economy Mode

- In Economy mode, the thermostat maintains the room temperature at a lower or higher setpoint, thus saving energy and money.

### 3. Protection Mode





- In protection mode the thermostat stops operating.



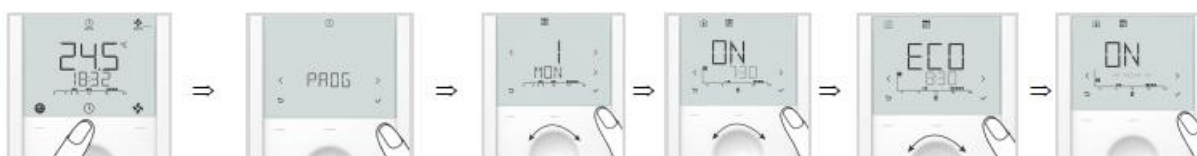

### 4. Auto Mode



- In Auto mode, the thermostat automatically switches over between Comfort and Economy mode.

## Set schedule





- Press button  once and then turn the rotary knob or press button  continuously to select programming mode PRROG.
- Press button  once to enter scheduler mode .
- Turn the rotatory knob to select the weekday to be set, then press button  once.

- Turn the rotary knob to view existing schedules, then press button ✓ once to select the schedule that need to be edited.
- Comfort mode setting of selected schedule and icons  and  are displayed then press button ✓ once. The start time for Comfort flashes and can be changed by turning the rotary knob.
- Press button ✓ once to confirm the adjusted value and enter the Economy mode setting for the schedule. Icons  and  are displayed, the press button ✓ once. The start time for Economy flashes and can be changed by turning the rotary knob,
- Press button ✓ once to confirm the adjusted value. Then users can view other schedules by turning the rotary knob and enter other schedule settings (same as edited schedule).

*Note: User can press button  to delete any schedule or  (Esc) to Cancel the change. The maximum number of set schedule is three per day.*

## Set TIME



- Press button  once and then turn the rotary knob or press button  continuously to select programming mode TIME.
- Press button ✓ once and then turn the rotary knob to select time format (12H).
- Press button ✓ once and then turn the rotary knob to select AM or PM.
- Press button ✓ once and enter hour setting.
- The hour value flashes and can be changed by turning the rotary knob.
- Press button ✓ once to confirm the adjusted value and enter the minutes settings. Repeat the steps as for the hour.

*Note: When time format is 24H, AMPM is not displayed.*

## Set DATE

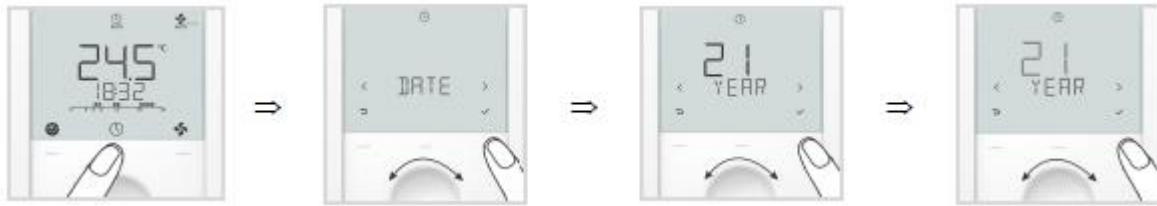

- Press button once and then turn the rotary knob or press button continuously to select programming mode DATE.
- Press button once to enter date setting.
- Turn the rotary knob to select month/ weekday/ year, then press button once.
- For example, enter the year setting. The Year value flashes and can be changed by turning the rotary knob.
- Press button to confirm the adjusted value, or (Esc) to cancel the change.

Repeat the steps for month and weekday settings.

## Set AWAY (Holiday Mode)

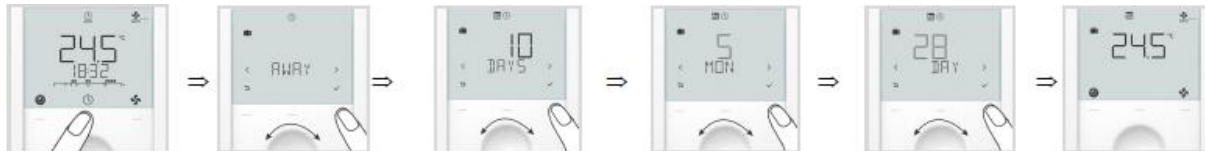

- Press button once and then turn the rotary knob or press button continuously to select programming mode AWAY. Holiday mode is displayed.
- Press button once to enter scheduler mode .
- Turn the rotary knob to adjust the holidays, then press button once.
- Set the start time (AWAY): Set the month (MON) and the press button - set the day (DAY)
- Press button once confirmed the adjusted value ; the idle page for Holiday mode is displayed once the start time reaches.

## Button Lock



If the button lock function is enabled (parameter P028=2), pressing the right button for 3 seconds locks or unlocks the buttons respectively. Locked buttons are indicated by the key symbols.