

☐

I'm not robot



reCAPTCHA

I am not robot!

Dewenwils timer instructions.

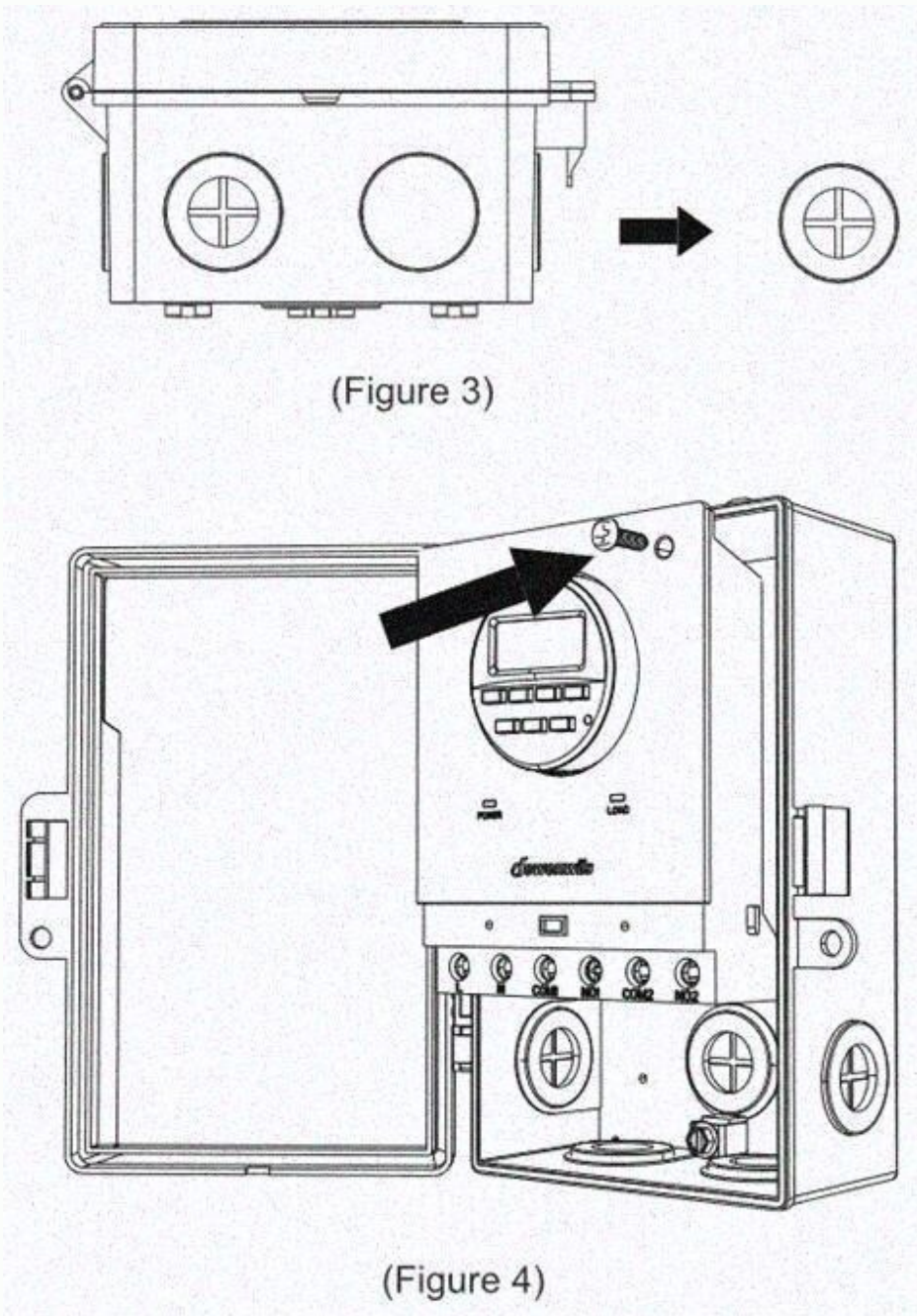

Dewenwils timer manual.



Easy set outdoor digital timer instructions. Digital outdoor timer instructions. How does a digital timer work. Dewenwils digital lamp timer instructions.

CAUTION: For outdoor use in a rain-tight or wet location. Ensure proper installation using UL-compliant conduit hubs and consult a licensed electrician before proceeding. ****Button Layout**** 1. TIME: Set the clock. 2. RESUME: Erase program. 3. MODE: Choose different modes. 4. (-) - Adjust down. 5. (+) - Adjust up. 6. PROGRAM: Set program. 7. RESET: Reset all functions. 8. POWER: Power indicator light indicates power status (ON/OFF). 9. STATUS: Status light indicates output operating status. ****Initial Setup**** Before first use, charge the internal battery for at least 30 minutes by wiring it as shown in the diagram. After the screen displays, the unit is ready for programming.

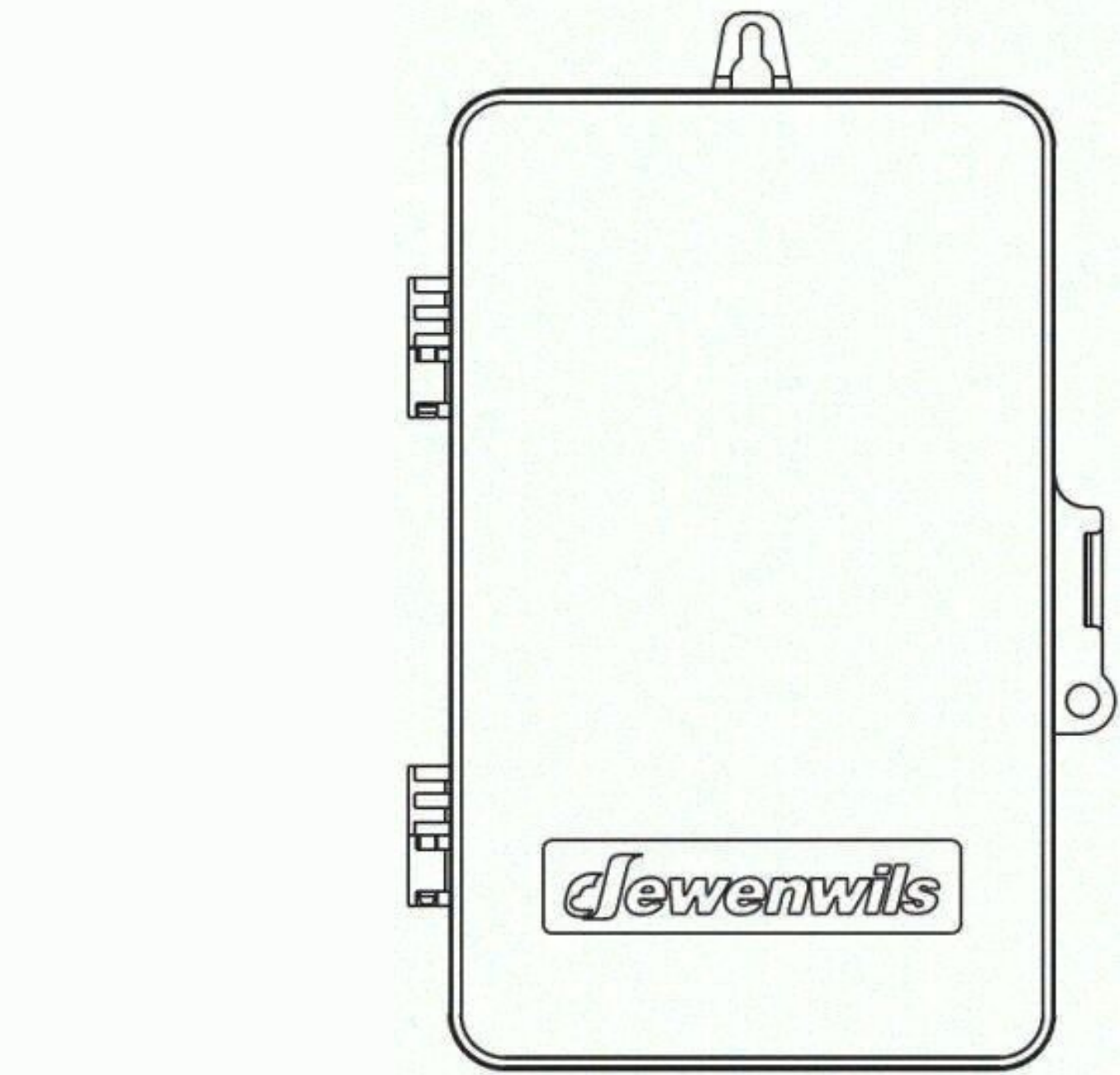

Dewenwils digital lamp timer instructions.

CAUTION: For outdoor use in a rain-tight or wet location. Ensure proper installation using UL-compliant conduit hubs and consult a licensed electrician before proceeding. ****Button Layout**** 1.

6
Time Modes

Dispsay	Mode	Explanation
<div>ON OFF</div> <div></div> <div>12:00</div>	ON/OFF	Always on/off
<div>RDM</div> <div></div> <div>12:00</div>	RDM	Security feature, on at a random time,and remains on for 15 minutes.
<div>AUTO</div> <div></div> <div>12:00</div>	AUTO	On/Off at your exact programmed time.
<div>AUTO</div> <div></div> <div>12:00</div>	AUTO CDS	Ture the power on at dusk, off at dawn.
<div>AUTO</div> <div></div> <div>12:00</div>	AUTO CDS+Timer	Turn the power on at dusk,off at your exact programmed time.

Easy set outdoor digital timer instructions. Digital outdoor timer instructions. How does a digital timer work. Dewenwils digital lamp timer instructions.

CAUTION: For outdoor use in a rain-tight or wet location. Ensure proper installation using UL-compliant conduit hubs and consult a licensed electrician before proceeding. ****Button Layout**** 1. TIME: Set the clock. 2. RESUME: Erase program. 3. MODE: Choose different modes. 4. (-) - Adjust down. 5. (+) - Adjust up. 6.



Ensure proper installation using UL-compliant conduit hubs and consult a licensed electrician before proceeding. ****Button Layout**** 1. TIME: Set the clock. 2. RESUME: Erase program. 3. MODE: Choose different modes. 4. (-) - Adjust down. 5. (+) - Adjust up. 6. PROGRAM: Set program. 7. RESET: Reset all functions. 8. POWER: Power indicator light indicates power status (ON/OFF). 9. STATUS: Status light indicates output operating status. ****Initial Setup**** Before first use, charge the internal battery for at least 30 minutes by wiring it as shown in the diagram. After the screen displays, the unit is ready for programming. ****Setting Current Date and Time**** 1. Set current date: * Press TIME to set year. * Adjust year using +/- buttons. * Repeat process to set month (01-12) and day. 2. Set Day Light Savings Time (DST): * Press TIME to set DST function. * Adjust AUTO setting as shown in the figure. 3. Set current time: * Press TIME to set hour. * Adjust hour using +/- buttons. * Repeat process to set minutes (00-59). ****Astronomic Function**** 1. Determine timer zone based on map below. 2. Set astronomic function: * Press TIME to set astronomic function. * Adjust settings for three different areas to your current location. ****Sunrise and Sunset Time Settings**** 1. Set sunrise time: * Press TIME to adjust sunrise time. * Adjust ±2 hours using +/- buttons. * Resume button returns to current sunrise time (AM twinkling indicates setting). 2. Set sunset time: * Press TIME to adjust sunset time. * Adjust ±2 hours using +/- buttons. * Resume button returns to current sunset time (PM twinkling indicates setting). ****Programming Switching Times**** 1. Note: Press RESUME to clear current settings during programming. 2. Set first On event: * Select every day, weekday, or weekend using +/- buttons. 3. Set hours: * Press TIME to set hours. * Adjust 12-hour clock (AM/PM) or sunrise/sunset mode using +/- buttons. 4. Set minutes: * Note: If selecting sunrise or sunset as event, press PROGRAM button to select ON/OFF. ****Additional Notes**** * Consult manual for more information on programming and troubleshooting. To cancel the setting, press the "RESUME" button. Alternatively, use the "PROGRAM" button to turn off the rst event. This step is similar to the previous one. You can set seven events on this timer. Once you've finished setting, press the "PROGRAM" button to return to standby mode. Note: If the timer remains idle for 30 seconds, it will automatically set the time to the current time. The device features various contacts, including: * 30A Resistive, 120~277VAC, 1HP * 16A FLA, 96A LRA, 120 VAC, 2HP, and more Please be cautious when operating the timer and follow the warning signs. The instructions manual can be found in PDF or HTML formats on this site. To submit a manual for a product that others may not have, please contact us at (attach your User Name or Order ID). ****Power Outage and Battery Handling**** When power goes out, this device will stop operating. After power is restored, reset your desired operating mode as per instructions. ****Helpful Tips:**** * When set to "ON", the timer provides continuous power to attached devices until switched off or changed to another mode. * In sensor mode (dusk-to-dawn), temporary light sources won't interfere unless on for more than 15 minutes, when the device will shut off until darkness returns. ****Programming and Sensor Modes**** * Once programmed at dusk in 2hr, 4hr, 6hr, or 8hr modes, the program cycle completes before resetting. * External lighting sources (headlights, porch lights, etc.) won't interfere with active timer programs. ****Battery Handling and Replacement**** * Install batteries observing the positive (+) side up, as indicated inside the battery compartment. * Never throw batteries into a fire or expose to heat sources. Battery contains mercury; recycle or manage as hazardous waste. * Replace old batteries with new Type 3V (CR2032) lithium batteries, ensuring correct installation and polarity. ****Specifications and FCC Compliance**** * DO NOT ATTACH A DEVICE EXCEEDING UNIT RATINGS: 125 V ac 60 Hz, 15 A Resistive, etc. * This equipment complies with Class B digital device limits, part 15 of the FCC Rules, providing reasonable protection against harmful interference in residential installations. This device complies with Part 15 of the FCC Rules and Industry Canada's license-exempt RSS standard(s). To operate, it must not cause harmful interference and accept any received interference, including that which may cause undesired operation. The manufacturer is not responsible for radio or TV interference caused by unauthorized modifications. The device has been approved to operate with specific antenna types, listed below, up to the maximum permissible gain indicated. Any antenna type not included in this list, exceeding the maximum gain for that type, is prohibited from use with this device. This equipment has been tested and found to comply with the limits for a Class B digital device. This device generates radio frequency energy and may cause harmful interference if not installed and used according to instructions. If interference occurs, try reorienting or relocating the receiving antenna, increasing separation between the equipment and receiver, or connecting it to a different circuit. Consult a dealer or experienced technician for assistance. The manufacturer warrants this product against defects in material and workmanship for one year from the date of purchase. Warranty is void if damage results from misuse or improper installation. Contact with any questions; our customer service team will respond within 24 hours.