



RYOWO™

GRP WATER TANK

Keeps Water Clean, Ideal For Storing Drinking Water
www.ryowo.com





FEATURES & CHARACTERISTICS

Long-term Durability

Ryowo GRP Water Tank has been well-designed such that it can preserve over 70% of designed performance after 15 years of normal usage. And with only 70% of designed performance it can meet the requirement of daily usage under various load conditions including the occupancy loads, wind loads and seismic loads.

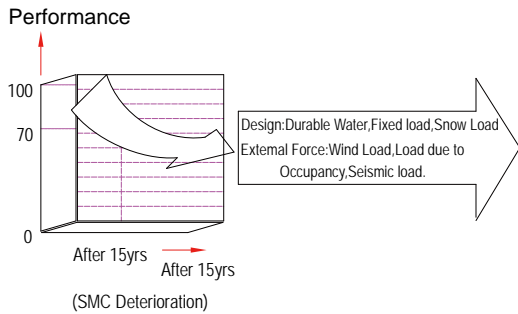

Item	Design Condition
Earth Quake	Horizontal magnitude
Hydrostatic Load	Standard-3.3 times of Hydrostctic Load Strain Rate under full water,Below0.1% of Tank Height
Snow Load	Beiow 60kg/m ² (Standard-30cm of snowfall amount)
Wind Load	Below 60m/sec
Lilumination Intensity Rate	Below 0.1%

Free Capacity Design

The Ryowo GRP Water Tank can be expanded to different sizes subject to the site space available by combining the three basic units.

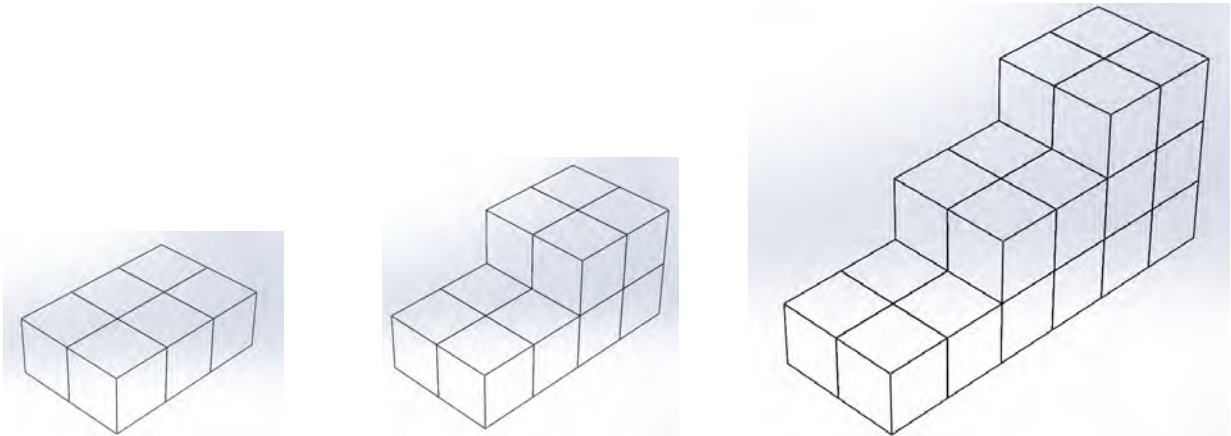



RYOWO WATER TANK

WWW.RYOWO.COM

Bottom Drainage System

The panel combination allows the water to be drained off rapidly and completely. The special convex base panel is so designed that any increase in water pressure as the volume of water increases is distributed to the panel joints evenly.

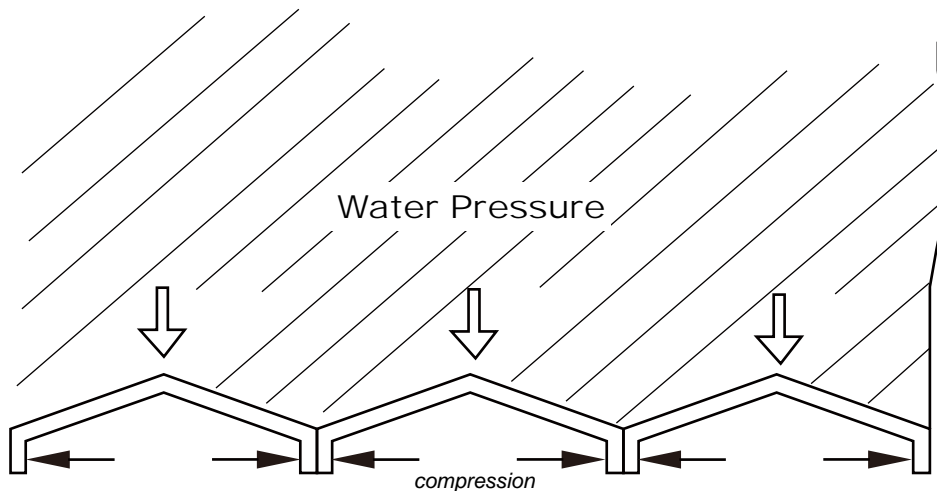

Water Pressure Mechanism

The water pressure created by filling the tank seals the joints preventing leakage.

The combination of convex base panels with a concave drainage panel ensures complete and faster drainage.

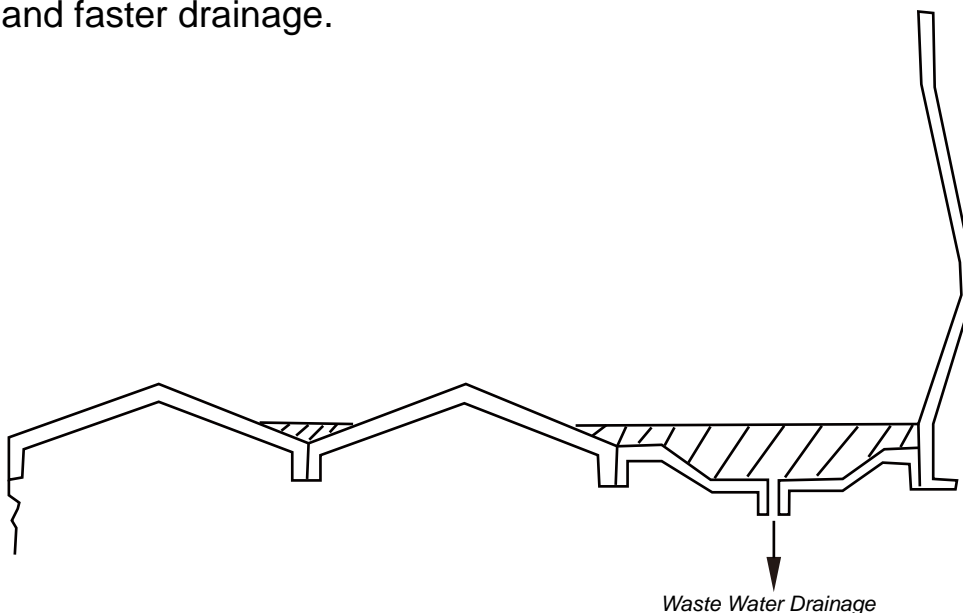

A unique feature of Ryowo GRP panel type water tank, the concave drain panel was especially designed to facilitate periodic tank cleaning and inspection.



FEATURES

Best Hygienic Properties

Ryowo GRP Water Tank has adopted panels that completely block the direct sunlight to avoid the growth of algae and other micro-organisms. And by assembling tanks with anti-rust accessories, it can keep water clean.

■ ■ *Poor Sanitation On Other Tanks*



Ryowo Tank



Excellent Water Tightness





RYOWO WATER TANK

WWW.RYOWO.COM

Reinforcement System



Internal section and structure

FEATURES

The excellent strength, durability and water-tightness of the Ryowo GRP Water Tank are obtained by connecting inner panels with stainless steel braces.



External section and structure

FEATURES

The exterior reinforcement system refers to a system that has been designed to withstand stress that occurs due to the hydraulic pressure exerted on the outer part of the tank.



TANK CONSTRUCTION

Ryowo GRP Water Tanks make possible easy installation with on-side bolt assembly and panel assembly allow free design of shape and volume.

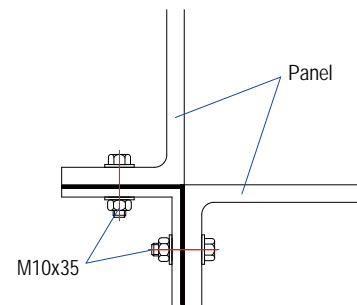
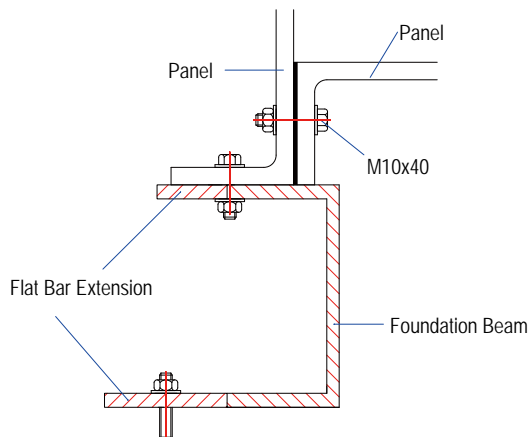
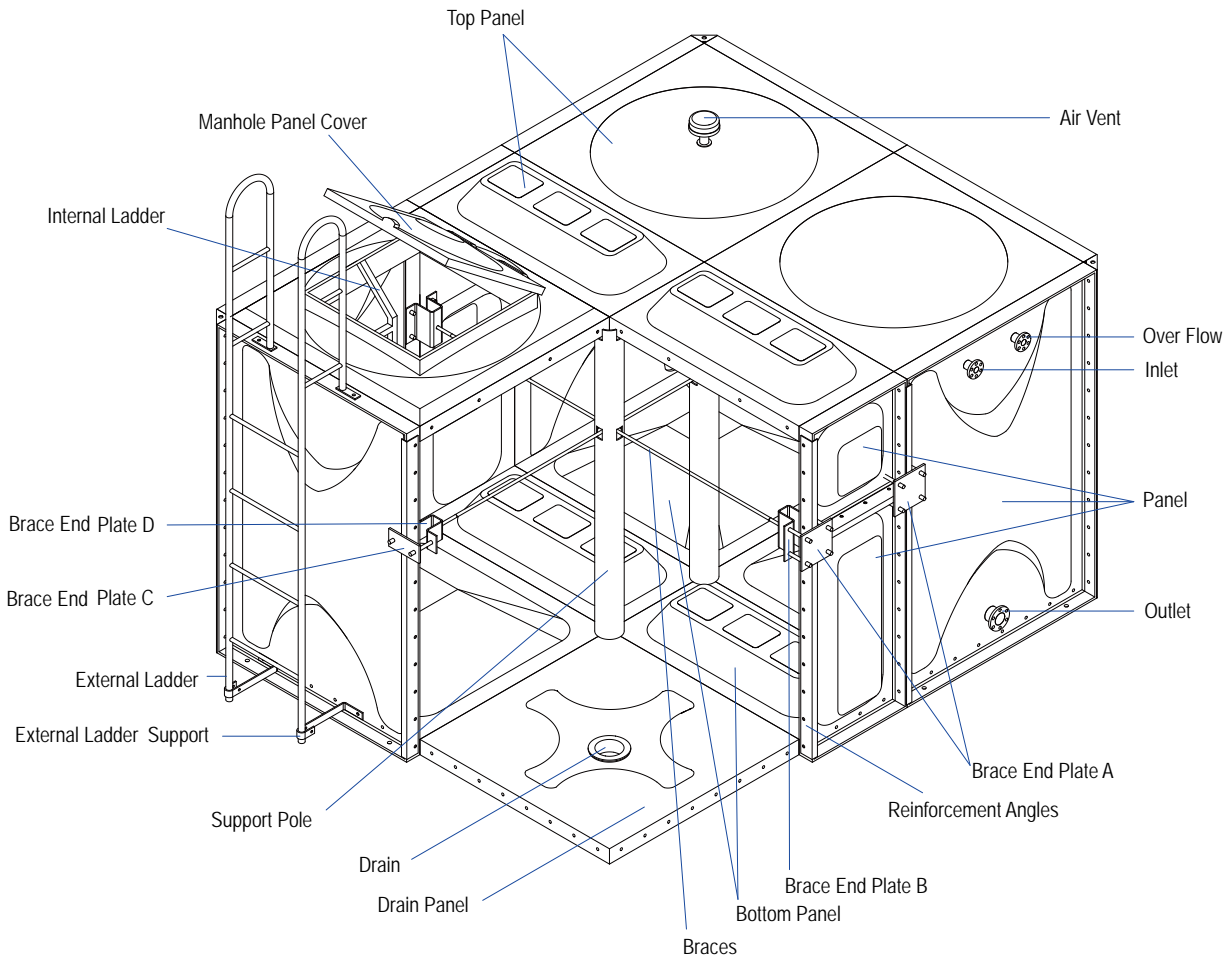

DIMENSIONS

RYOWO WATER TANK

WWW.RYOWO.COM

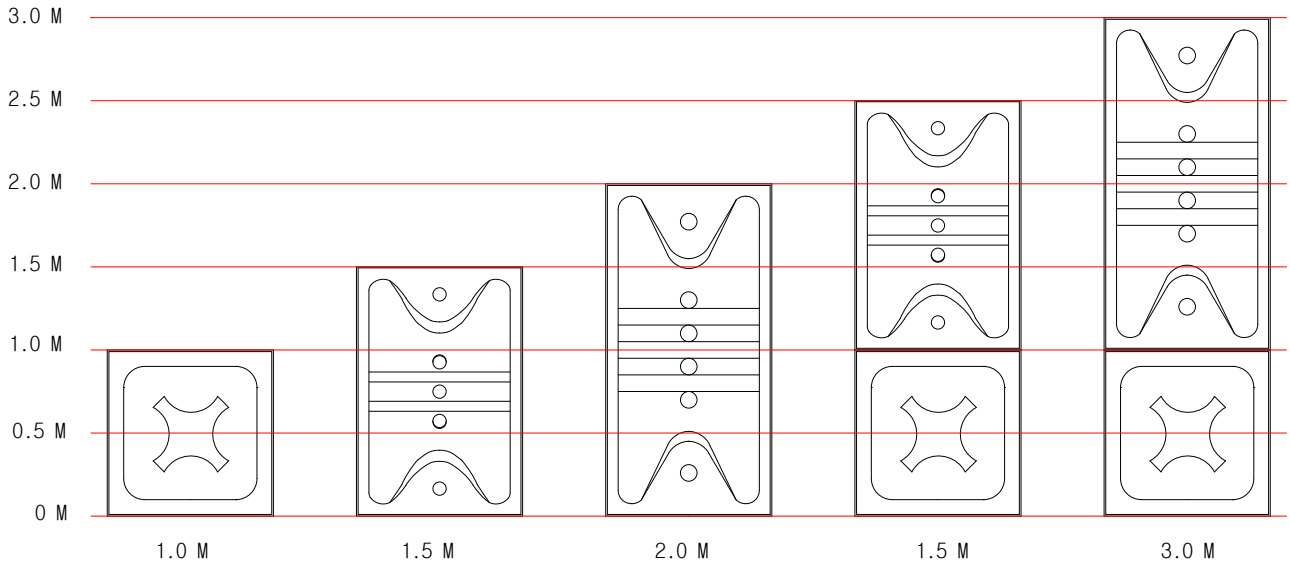

⑪ WALL PANEL (2X1)
Model no. 2-1-S

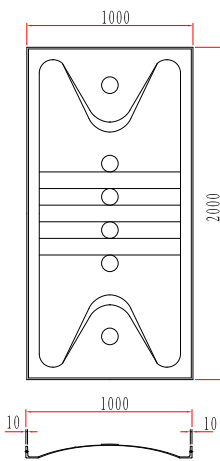

⑫ WALL PANEL (1.5X1)
Model no. 15-1-S

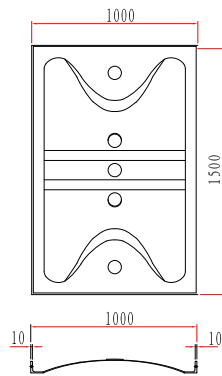

⑬ ROOF PANEL (1X1)
Model no. 1-1-T

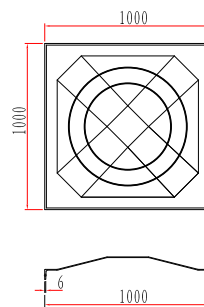

⑭ WALL PANEL (1X1)
Model no. 1-1-S

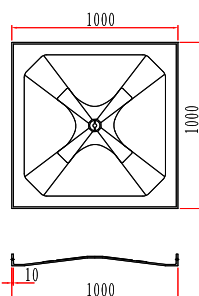

⑮ BOTTOM PANEL (1X1)
Model no. 1-1-B

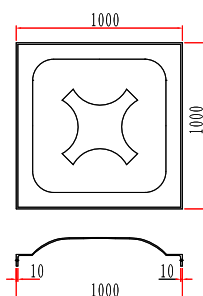

DIMENSIONS

RYOWO WATER TANK

WWW.RYOWO.COM

SMC WALL PANEL



0.5m X 0.5m
Model No. : 5-5-S



0.5m X 1m
Model No. : 1-5-S



1m X 1m
Model No. : 1-1-S



1m X 1.5m
Model No. : 15-1-S



1m X 2m
Model No. : 2-1-S

SMC BOTTOM PANEL



0.5m X 0.5m
Model No. : 5-5-B



0.5m X 1m
Model No. : 1-5-B

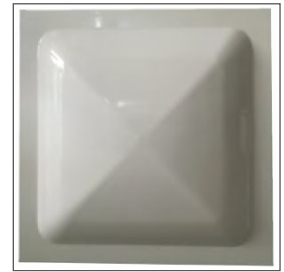

1m X 1m
Model No. : 1-1-B

SMC ROOF PANEL



0.5m X 0.5m
Model No. : 5-5-T



0.5m X 1m
Model No. : 1-5-T



1m X 1m
Model No. : 1-1-T

FOUNDATION DETAILS

Ryowo GRP Water Tanks are mounted on a foundation which is a necessity in panel tank installation. Refer to the table below for the dimensions of related steel members.

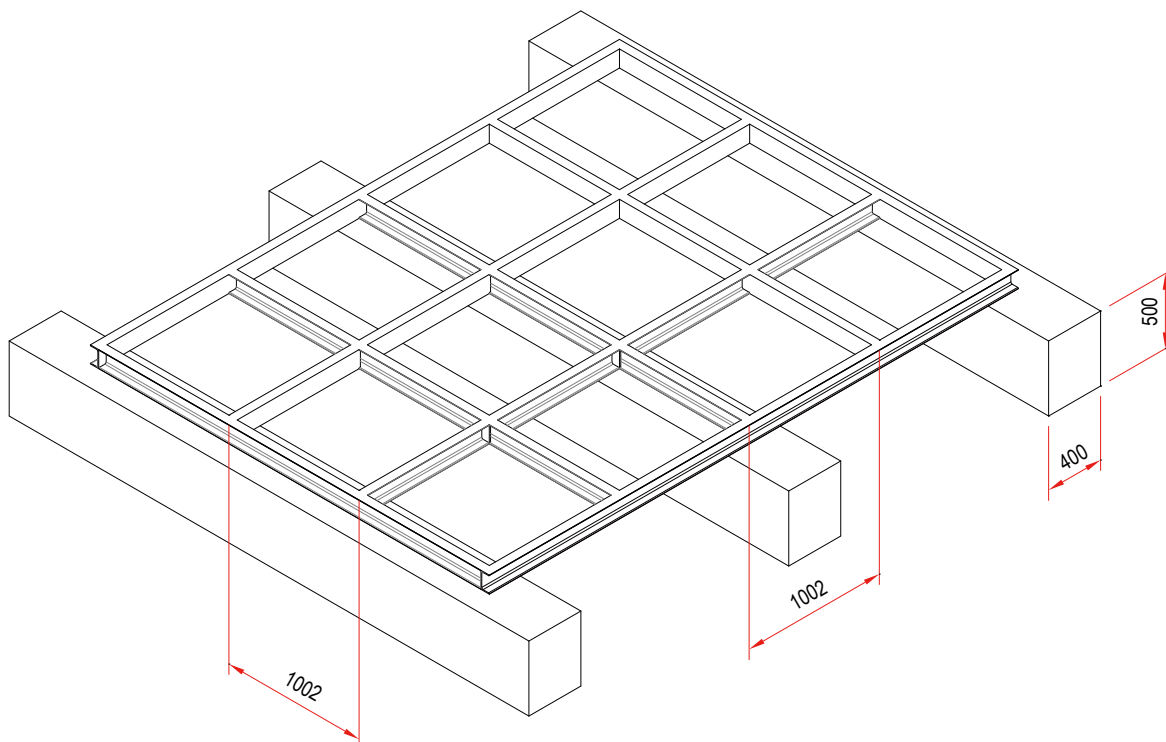

Dimensions Of Foundation Members

Height of tanks	Main Beams#
1m	127x64x6.4 Channel [
1.5m	
2m	
2.5m	160x63x6.5 Channel [
3m	

Flat bar extension is required along the perimeter

Tables of Accessories

Item	Remarks
Manhole panel	640mm x 640mm
Nozzle	Inlet, outlet, overflow and drain
Air vent	50mm or 100mm dia

RYOWO (HOLDING) CO., LTD.

Room 1908, Nathan Road 700 Mong Kok, Kowloon HongKong.
Tel.: (852) 2931 8381 Fax: (852) 2789 3802
E-mail: ryinfo@ryowo.com website: www.ryowo.com

DONGGUAN RYOWO COOLING TOWER CO., LTD.

No. 263 MeiJing Road West, Dalang, Dongguan, GuangDong, PRC
Post Code: 523795 Fax: (86-769) 8297 3398
Tel.: (86-769) 8939 9698 (86-769) 8939 9699