

roofrôllstix

SELF ADHESIVE CODE 3/4 LEAD ALTERNATIVE



THE MODERN LEAD FLASHING SUBSTITUTE THAT LOOKS AND WORKS LIKE LEAD.

Manufactured with a base of EPDM and aluminium expanded metal, it provides a safe alternative to lead and is the ideal solution in most roofing applications

roofrôllstix has a number of advantages over traditional lead flashing, particularly for those working in the construction industry.

The incredibly flexible and malleable properties of the aluminium, together with the excellent UV resistance of the EPDM, combine to create a safe and useful product that is quick and easy to use.

The product has a long life expectancy in excess of 20 years and is available at a fraction of the cost of traditional lead.

Available in widths of 150mm, 200mm, 300mm, 450mm and 600mm and lengths of 5 meters and 10 meters.



Safe &
Non-Toxic



Fast & Easy
Installation



Environmentally
Friendly



Light
Weight



Long Life
Expectancy

roofrôllstix

SELF ADHESIVE CODE 3/4 LEAD ALTERNATIVE

SUITABLE APPLICATIONS

- Cap Flashing to Roof Abutments
- Soaker flashings to chimneys
- Dormer installations
- Box valleys (no joins can be installed in one length)
- Valleys (can be installed in single pieces)
- Chimneys
- Aprons
- Soakers and Cap Flashings
- Wall abutments
- Dormer cheeks
- Dormer walls
- Roof Lights
- Interfaces with slate roofs
- Under windows
- Parapet walls
- Lead roof applications
- Ridge detailing
- Flat tiles or slate
- Roof hip details

APPLICATION CONDITIONS

roofrôll stix should be applied under conditions allowing standard masonry works, do not apply at temperatures below -5°C. At low temperatures and with wet substrates, the substrate onto which roofrôll stix is applied should be dried and heated using hot air.

CONDITIONS OF USE

Execution of a water protective measure using roofrôll stix should take place according to a technical project prepared according to the effective construction regulations.

JOINING

roofrôll stix parts should be joined using butyl glue. in order to improve mechanical properties of the joint, a polymer glue may be used in addition to the polymer glue. Use an overlap with a minimum width of 10cm in any case.

STORAGE

roofrôll stix should be stored before use at the construction site, in its original packaging and protected against contamination. roofrôll stix should be protected before installation against sunlight and high temperatures. In order to ensure optimal consistency and gluing force of the butyl glue, store roofrôll stix at room temperature where possible until application.

The maximum period of time for application of the butyl glue is 12 months from the production date.

roofrollstix

SELF ADHESIVE CODE 3/4 LEAD ALTERNATIVE

PARAMETER	UNIT	ROOFROLL STIX
Length	M	10
Width	mm	150mm - 600mm
Straightness / Flatness	mm	< 50 / < 10
Thickness	mm	1.5 ± 5%
Weight	kg/m ²	1.7 ± 5%
Reaction to fire	Class	E
Watertightness	10 kPa	Waterproof
Tensile properties: - In longitudinal direction - In transverse direction Elongation: - In longitudinal direction - In transverse direction	N/50 N/50 % %	> 200 > 300 > 50 > 20
Resistance to static loading	kg	> 20
Resistance to impact	mm	> 500
Tear resistance - Longitudinal direction: - Transverse direction:	N	> 80 > 80
Joint shearing strength - Longitudinal overlapping: - Transverse overlapping:	N/50 mm	> 60 > 45
Joint stripping strength - In longitudinal direction: - In transverse direction:	N/50 mm	> 1.2 > 1.1
UV exposure	1000 h	No breakdown or tearing
Flexibility at low temperature	°C	< -40°
Dangerous substances	-	NPD

roofrollstix

SELF ADHESIVE LEAD ALTERNATIVE

BACK GUTTER PARTY WALL TO PITCHED SLATE ROOF

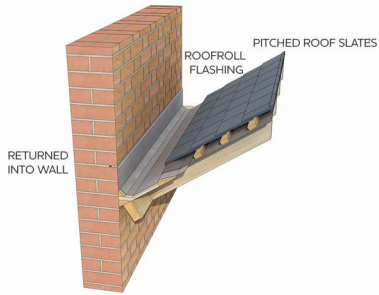

PITCHED ROOF TO DORMER WINDOW

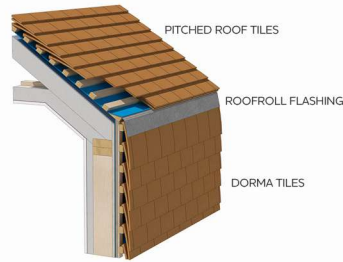

PITCHED ROOF TO FLAT ROOF LEAD DETAIL

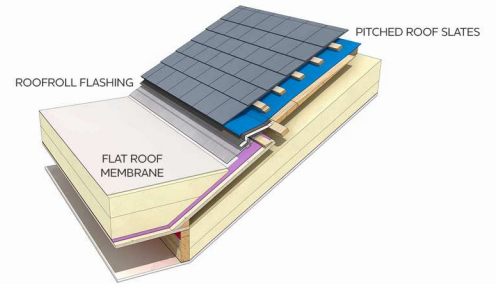

LEAN-TO SLATE ROOF ABUTMENT DETAIL



SLATE ROOF VALLEY DETAIL



PARTY WALL SLATE ABUTMENT SIDE FLASHING



MANSARD SLATE ROOF DETAIL WITH FLASHING

