

roofrôll valley

HEAVY DUTY CODE 5/6 LEAD ALTERNATIVE



THE MODERN LEAD FLASHING SUBSTITUTE THAT LOOKS AND WORKS LIKE LEAD.

Manufactured with a base of EPDM and aluminium expanded metal, it provides a safe alternative to lead and is the ideal solution in most roofing applications

roofrôll valley has a number of advantages over traditional lead flashing, particularly for those working in the construction industry.

The incredibly flexible and malleable properties of the aluminium, together with the excellent UV resistance of the EPDM, combine to create a safe and useful product that is quick and easy to use.

The product has a long life expectancy in excess of 20 years and is available at a fraction of the cost of traditional lead.

Available width of 500mm
and lengths of 5 meters and 10 meters.



Safe &
Non-Toxic



Fast & Easy
Installation



Environmentally
Friendly



Light
Weight



Long Life
Expectancy

roofrôll valley

HEAVY DUTY CODE 5/6 LEAD ALTERNATIVE

SUITABLE APPLICATIONS

- Cap Flashing to Roof Abutments
- Soaker flashings to chimneys
- Dormer installations
- Box valleys
- Valleys (can be installed in single pieces)
- Chimneys
- Aprons
- Soakers and Cap Flashings
- Wall abutments
- Dormer cheeks
- Dormer walls
- Roof Lights
- Interfaces with slate roofs
- Under windows
- Parapet walls
- Lead roof applications
- Ridge detailing
- Flat tiles or slate
- Roof hip details

APPLICATION CONDITIONS

roofrôll valley should be applied under conditions allowing standard masonry works, do not apply at temperatures below -5°C. At low temperatures and with wet substrates, the substrate onto which roofrôll valley is applied should be dried and heated using hot air.

CONDITIONS OF USE

Execution of a water protective measure using roofrôll valley should take place according to a technical project prepared according to the effective construction regulations.

JOINING

roofrôll valley parts should be joined using butyl glue. in order to improve mechanical properties of the joint, a polymer glue may be used in addition to the butyl glue. Use an overlap with a minimum width of 10cm in any case. In addition, roofrôll valley can also be welded using hot air at a temperature of +/- 450°C.

STORAGE

roofrôll valley should be stored before use at the construction site, in its original packaging and protected against contamination. To ensure optimal consistency and gluing force of the butyl glue, store roofrôll valley at room temperature until application.

roofrollvalley

HEAVY DUTY CODE 5/6 LEAD ALTERNATIVE

PARAMETER	UNIT	ROOFROLL VALLEY
Length	M	5 & 10
Width	mm	500mm
Straightness / Flatness	mm	< 50 / < 10
Thickness	mm	2.4 (± 5%)
Weight	kg/m ²	2,550 ± 5%
Reaction to fire	Class	E
Watertightness	10 kPa	Waterproof
Tensile properties: - In longitudinal direction - In transverse direction Elongation: - In longitudinal direction - In transverse direction	N/50 N/50 % %	> 200 > 300 > 100 > 20
Resistance to static loading	kg	> 20
Resistance to impact	mm	> 500
Tear resistance - Longitudinal direction: - Transverse direction:	N	> 80 > 80
Joint shearing strength - Longitudinal overlapping: - Transverse overlapping:	N/50 mm	> 60 > 45
Joint stripping strength - In longitudinal direction: - In transverse direction:	N/50 mm	> 15 > 15
UV exposure	3000 h/480MJ/m ²	No breakdown or tearing
Flexibility at low temperature	°C	< -40°
Dangerous substances	-	NPD
Resistance to artificial ageing though long-term influence of elevated temperature	8760 h 80 °C	Meets all requirements No damage

roofroll valley

HEAVY DUTY CODE 5/6 LEAD ALTERNATIVE

BACK GUTTER PARTY WALL TO PITCHED SLATE ROOF

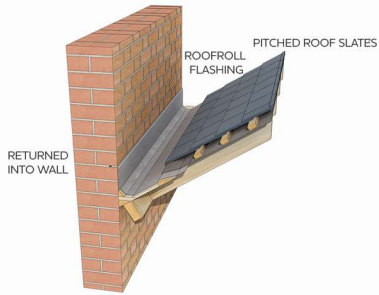

PITCHED ROOF TO DORMER WINDOW

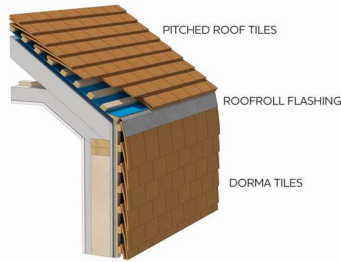

PITCHED ROOF TO FLAT ROOF LEAD DETAIL

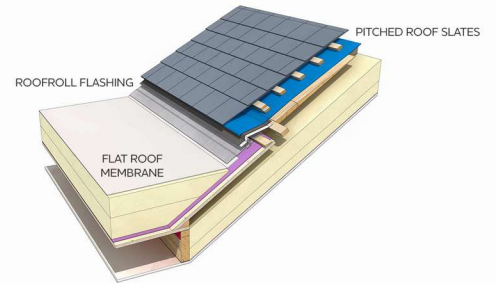

LEAN-TO SLATE ROOF ABUTMENT DETAIL



SLATE ROOF VALLEY DETAIL



PARTY WALL SLATE ABUTMENT SIDE FLASHING



MANSARD SLATE ROOF DETAIL WITH FLASHING

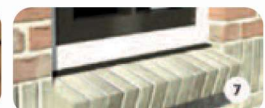

roofrôllfix

BUILDING SILICONE FOR LEAD ALTERNATIVES



AN ALL-ROUND, DURABLE, FLEXIBLE ADHESIVE & SEALANT BASED ON MS POLYMER TECHNOLOGY.

roofrôll fix provides excellent adhesion to non-porous surfaces, will bond to damp surfaces and is paintable with most paints. This product is odourless, neutral, and free of isocyanates.

Applications

- Adhesion of EPDM to most substrates
 - Gluing of products to bitumen
- Gluing and sealing of natural stone
- Waterproof construction adhesive
- Universal sealant for building sector

To find out more, view full data sheets or download installation instructions please visit:
www.rubbertech.co.uk/roofroll

roofrôll
THE LEAD ALTERNATIVE