

# roofrôll

THE LEAD ALTERNATIVE



roofrôllstone  
CODE 3/4 LEAD ALTERNATIVE



roofrôllslate  
CODE 3/4 LEAD ALTERNATIVE

## THE MODERN LEAD FLASHING SUBSTITUTE THAT LOOKS AND WORKS LIKE LEAD.

Manufactured with a base of EPDM and aluminium expanded metal, it provides a safe alternative to lead and is the ideal solution in most roofing applications

roofrôll has a number of advantages over traditional lead flashing, particularly for those working in the construction industry.

The incredibly flexible and malleable properties of the aluminium, together with the excellent UV resistance of the EPDM, combine to create a safe and useful product that is quick and easy to use.

The product has a long life expectancy in excess of 20 years and is available at a fraction of the cost of traditional lead.

Available in widths of 150mm, 200mm, 300mm, 450mm and 600mm and lengths of 5 meters and 10 meters.



Safe &  
Non-Toxic



Fast & Easy  
Installation



Environmentally  
Friendly



Light  
Weight



Long Life  
Expectancy

# roofroll

## THE LEAD ALTERNATIVE

### SUITABLE APPLICATIONS

- Cap Flashing to Roof Abutments
- Soaker flashings to chimneys
- Dormer installations
- Box valleys (no joins can be installed in one length)
- Valleys (can be installed in single pieces)
- Chimneys
- Aprons
- Soakers and Cap Flashings
- Wall abutments
- Dormer cheeks
- Dormer walls
- Roof Lights
- Interfaces with slate roofs
- Under windows
- Parapet walls
- Lead roof applications
- Ridge detailing
- Flat tiles or slate
- Roof hip details

PARAMETER	TEST	UNIT	ROOFROLL
Length	EN-BS 1848-2	m	10
Width	EN-BS 1848-2	mm	150 mm – 600 mm
Straightness	EN-BS 1848-2	Mm/10 m	≤ 50
Flatness	EN-BS 1848-2	mm	≤ 10
Effective thickness	EN-BS 1849-2	mm	2.5 ± 10%
Weight	EN-BS 1849-2	Kg/m2	2.8 ± 10%
Waterproofing	EN-BS 1928:2002	10 kPA	Waterproof
Combustibility class	EN-BS 13501-1	Class	E
Resistance to breaking	EN-BS 12311-2	N/50 mm	Longitudinal direction: 496 Transversal direction: 532
Stretching when breaking	EN-BS 12311-2	%	Longitudinal direction: 61.3 Transversal direction: 15.5
Resistance to static weight	EN-BS 12730	Kg	≤ 15
Resistance to tearing	EN-BS 12310-2	N	Longitudinal direction 110 Transversal direction: 164
Dimensional stability	EN-BS 1107-2	%	Longitudinal direction: ≥ 0.1 Transversal direction: ≥ 0.4
Resistance to temperature	EN 12691	°C	From -40 to 120
Folding at low temperatures	EN-BS 495-5	-40°C	No breaks No cracks
UV-stability	EN-BS 1297	3000h > 20 years	No breakdown or tearing

# roofroll

THE LEAD ALTERNATIVE

BACK GUTTER PARTY WALL TO PITCHED SLATE ROOF

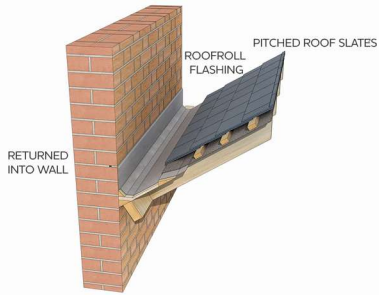

PITCHED ROOF TO DORMER WINDOW

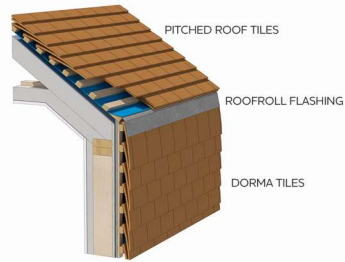

PITCHED ROOF TO FLAT ROOF LEAD DETAIL

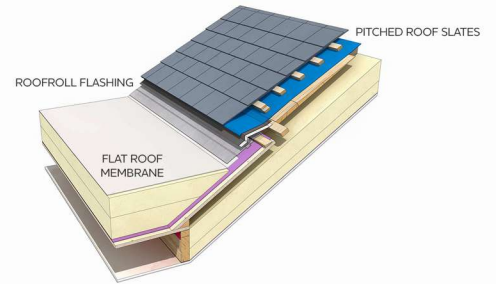

LEAN-TO SLATE ROOF ABUTMENT DETAIL



SLATE ROOF VALLEY DETAIL



PARTY WALL SLATE ABUTMENT SIDE FLASHING



MANSARD SLATE ROOF DETAIL WITH FLASHING

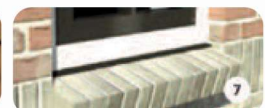

# roofrôllfix

BUILDING SILICONE FOR LEAD ALTERNATIVES



## AN ALL-ROUND, DURABLE, FLEXIBLE ADHESIVE & SEALANT BASED ON MS POLYMER TECHNOLOGY.

roofrôll fix provides excellent adhesion to non-porous surfaces, will bond to damp surfaces and is paintable with most paints. This product is odourless, neutral, and free of isocyanates.

### Applications

- Adhesion of EPDM to most substrates
  - Gluing of products to bitumen
- Gluing and sealing of natural stone
- Waterproof construction adhesive
- Universal sealant for building sector

To find out more, view full data sheets or download installation instructions please visit:  
[www.rubbertech.co.uk/roofroll](http://www.rubbertech.co.uk/roofroll)

roofrôll  
THE LEAD ALTERNATIVE