

800 8TH AVE  
GREELEY, CO  
80525



Space Available:

Suite 200: 2,176 SF

Suite 204: 2,246 RSF

Suite 300: 7,898 up to 15,796 SF

Suite 207: 894 RSF

Lease Rate:

\$12.50/SF NNN

\$14.50/SF NNN

NNN Rate:

\$8.50/SF

*\*2025 estimate*

*SUITES AVAILABLE IN HIGH-VISIBILITY OFFICE BUILDING IN DOWNTOWN GREELEY*

- Located in downtown Greeley in newly revitalized area with restaurants, breweries, apartments
- Short distance to Weld County Courthouse, City of Greeley offices, and DoubleTree by Hilton
- Ample parking
- Building signage available
- Fiber internet



# FLOORPLAN - SECOND LEVEL

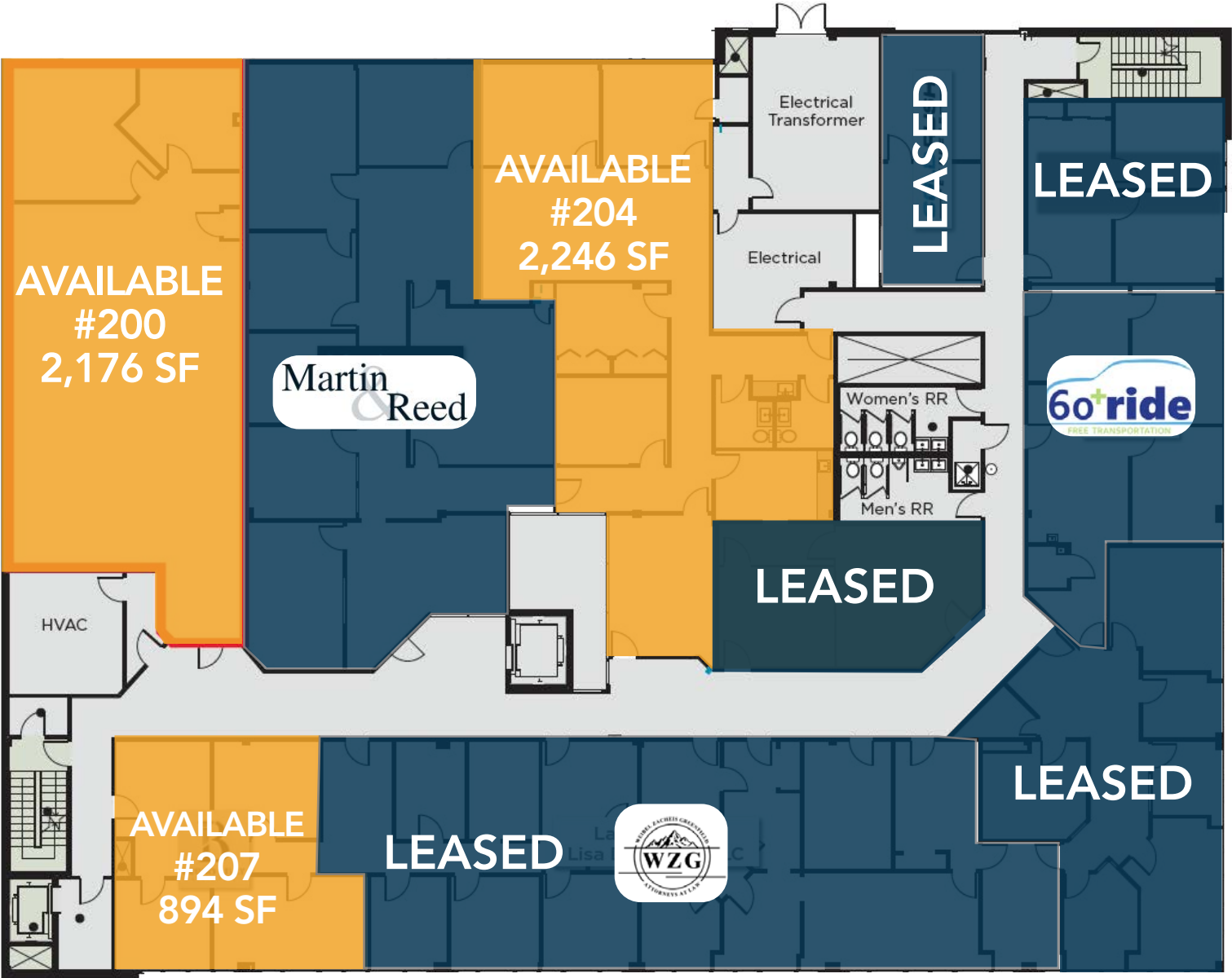

# FLOORPLAN - THIRD LEVEL

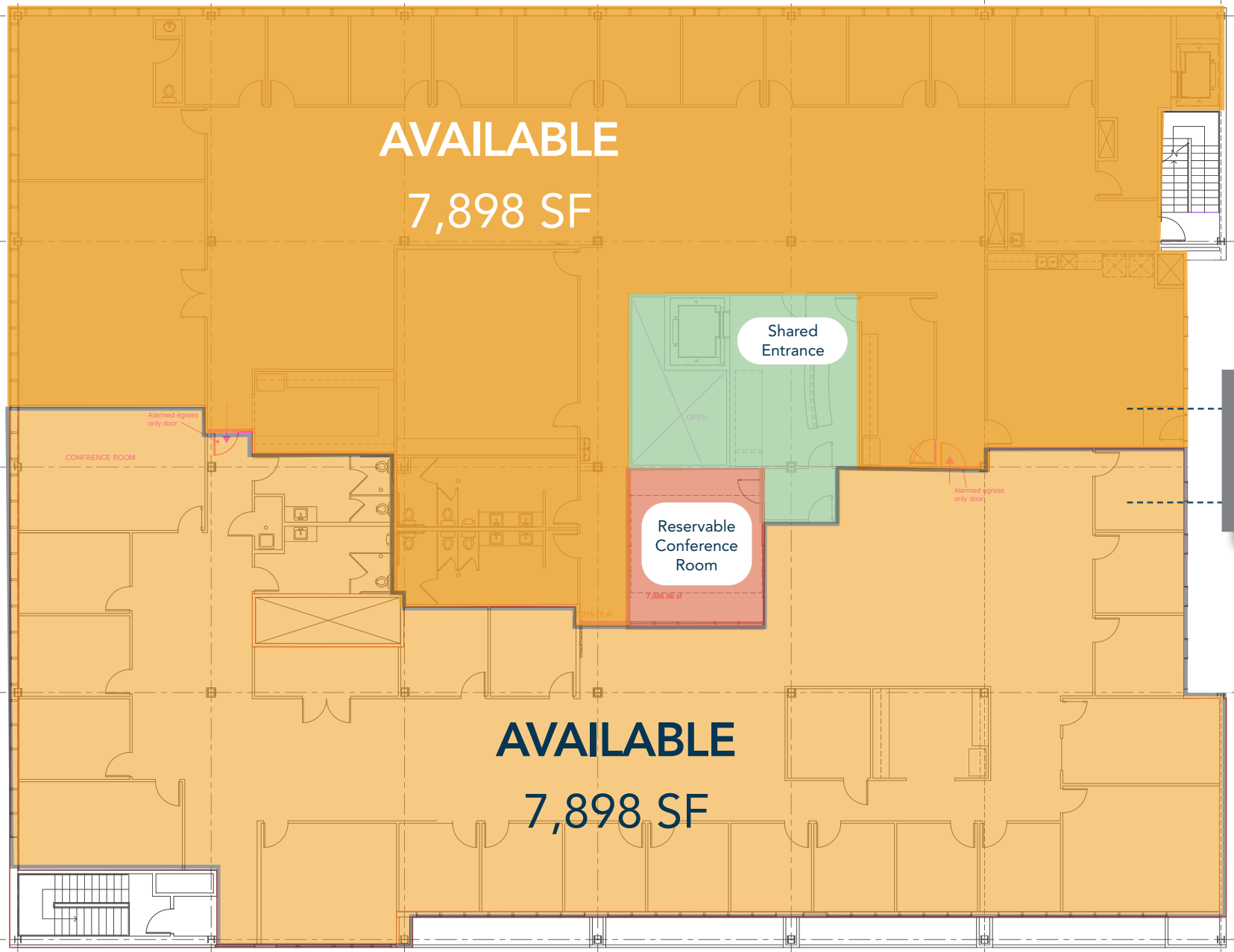

Combined  
Total  
15,796 SF

# PROPERTY PHOTOS - UNIT #200



# PROPERTY PHOTOS - UNIT #300



# SITE PLAN



# SITE MAP



# AREA MAP

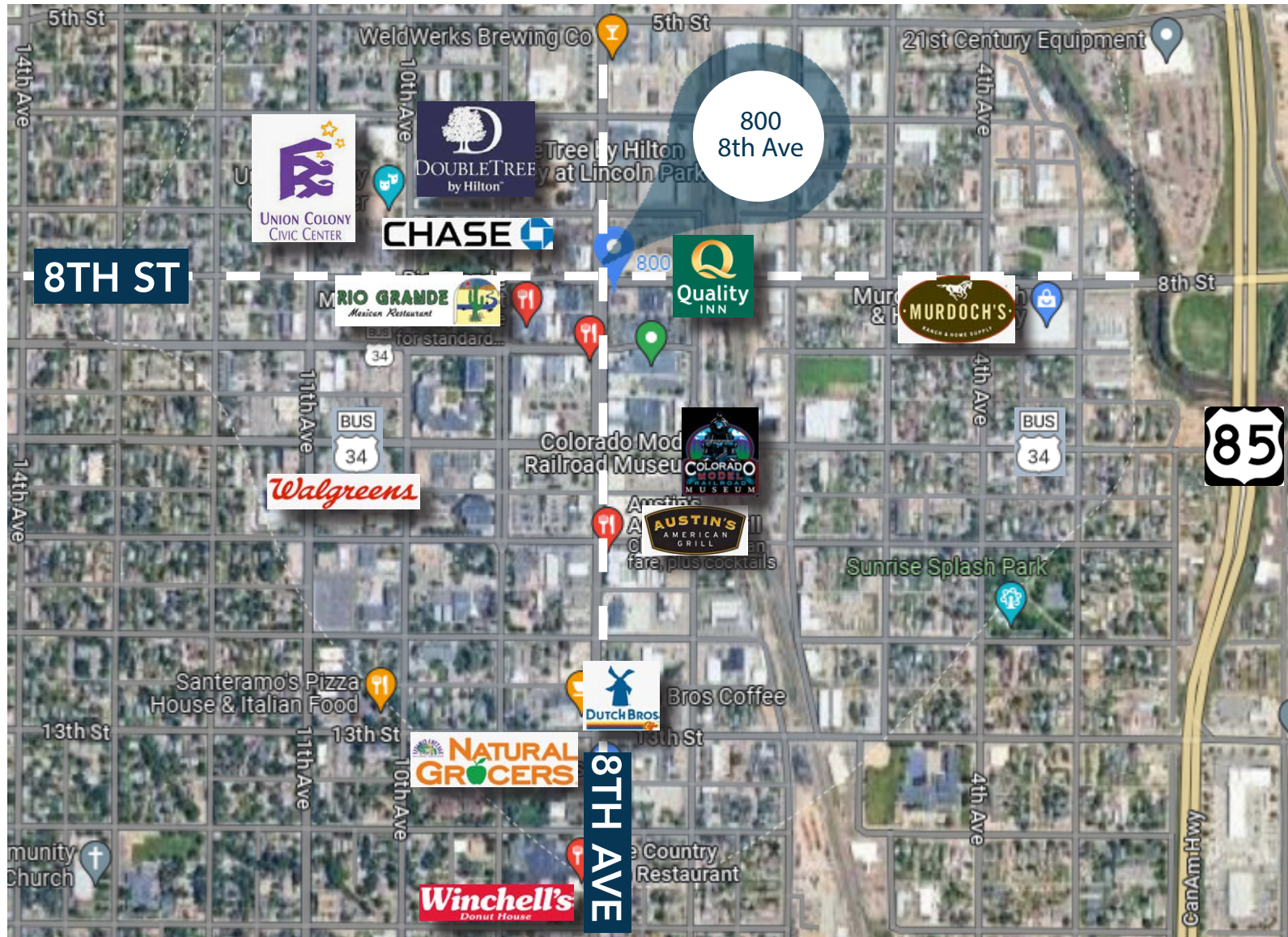

**CONTACT:** Brian Smerud, CCIM • 970-415-0538 • [bsmerud@waypointRE.com](mailto:bsmerud@waypointRE.com)

Erik Caffee • 970-218-4284 • [ecaffee@waypointRE.com](mailto:ecaffee@waypointRE.com)



BRIAN SMERUD / ERIK CAFFEE

125 S Howes Street Suite 500, Fort Collins, CO 80521 • 970-632-5050 • [www.waypointRE.com](http://www.waypointRE.com)

The information contained in this offering has been obtained from sources believed to be reliable; however, the accuracy cannot be guaranteed. All potential buyers and/or tenants are hereby advised to perform their own due diligence and independently verify all of the information set forth herein.