

YOUR DIGITAL DATA INSIGHT ASSISTANT

FarmGPT is a 2FA secure cloud-based AI solution designed to be a Digital Data Insight Assistant for all Livestock Agriculture Enterprises. FarmGPT's dynamic environment can be tailored to any Livestock Producer and provides quick responses and insights to Sales, Service or Data Analytics requests.

Utilizing cutting-edge AI agents developed by industry leading experts, FarmGPT helps producers improve production, enhance animal welfare, and save valuable time solving problems and making informed business decisions - all through an intuitive, natural language interface.

WHY FARMGPT?

- ✓ **Save Time & Resources**
Reduce inputs and troubleshooting time with quick, AI-powered solutions and insights.
- ✓ **Boost Decision-Making Speed**
Access farm-specific data instantly to assist staff in making quicker and better decisions, reducing downtime and improving efficiency.
- ✓ **Cut Operational Costs**
Minimize reliance on skilled labour and streamline processes with tailored, AI-driven recommendations.
- ✓ **Improve Animal Health & Productivity**
Optimize feeding, monitor environmental conditions, and identify production anomalies to keep livestock healthy and maximize output.

FarmGPT Example 1: Diagnosing ESF Error Message

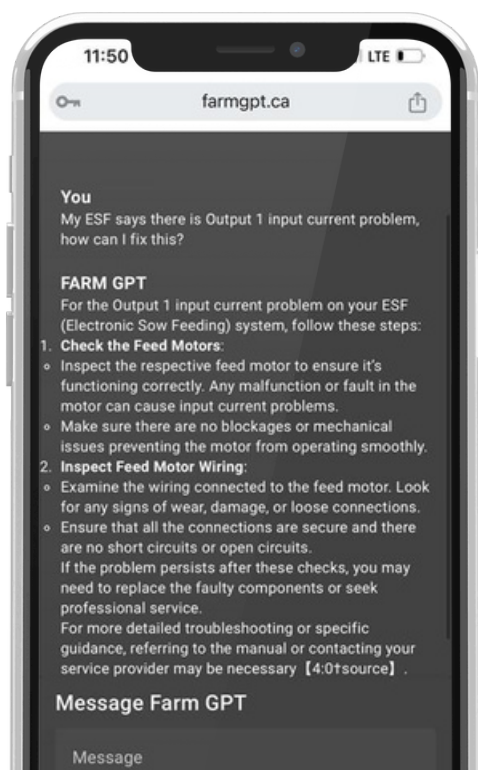

Just Ask FarmGPT

FarmGPT can give feedback on many different scenarios common in agriculture production.

Left: A FarmGPT user asks FarmGPT about an error message showing up on their Electronic Sow Feeder.

For Demonstrations or Media Inquiries:

Brian Debrot
General Manager, Cortex Agritechnology
info@cortex.ag
www.cortex.ag



FarmGPT Example 2: Cracked Eggs

Just Ask FarmGPT

Seeing an anomaly in your day to day operations? FarmGPT can help.

Right: A FarmGPT user asks FarmGPT for reasons their barn has an increase in cracked eggs.

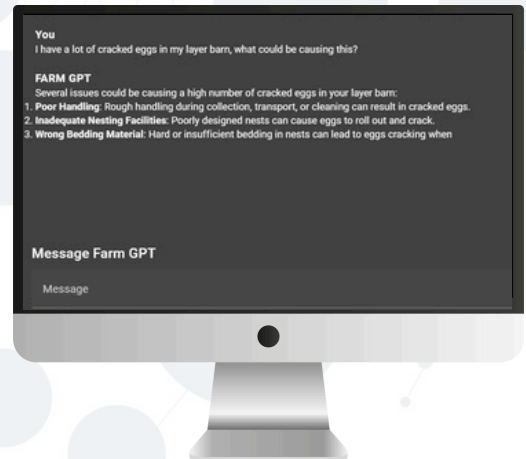

FEATURES



AI-Powered Data Insights

Provides real-time, data-driven recommendations, based on user inquiries, to enhance livestock operations.



Customizable for Producers

Easily tailor FarmGPT to your operations by uploading and managing essential documents, policies, and data.



Natural Language Interaction

Interact with FarmGPT using plain language to receive quick, actionable responses.



Tiered User Access

Manage data-sharing permissions across teams or departments for secure and organized operations.



Digital Expert Recommendations

Leverage AI agents specializing in Ventilation, Feed Management, Equipment Troubleshooting and more.

ABOUT CORTEX AGRITECHNOLOGY

Cortex Agritechnology is a member of the AgriHub Family of companies, focused on integrating, delivering, and managing innovative products born of the day-to-day challenges producers experience. A farmer-founded company, the Cortex Agritechnology team has decades of expertise in agriculture engineering and production.



For Demonstrations or Media Inquiries:

Brian Debrot
General Manager, Cortex Agritechnology
info@cortex.ag
www.cortex.ag