



Legacy Manufacturing



SPACE



AEROSPACE

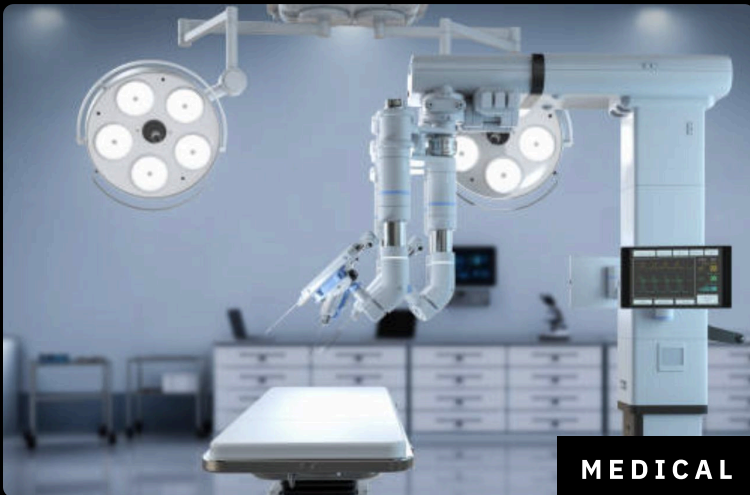

MEDICAL



MOTORSPORTS

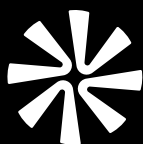



17-4 Stainless Steel
5-Axis Milling

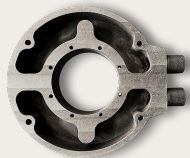

Delrin Plastic
3+2 Axis Milling

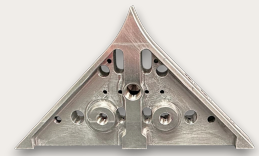

7075 Aluminum
5-Axis Milling



6061 Aluminum
Multi-Axis Live Tooling



17-4 Stainless Steel
Multi-Axis Live Tooling



403CB Stainless
Wire EDM + 5-Axis Milling

ABOUT US

Simple to complex, prototype to production. Decades of proven manufacturing expertise in Automotive, Packaging, Aerospace & Construction. Production Tool currently ships to Asia, Europe, Australia, South America and all North American countries.

MILLING

**Cells available as needed for volume production up to 5-axis.*

Capability	Table Size/ Travel	Weekly Capacity (hours)
5-Axis Automation <input checked="" type="checkbox"/>	40" x 25" x 25"	120
4-Axis Automation <input checked="" type="checkbox"/>	50" x 20" x 25"	80
3-Axis Automation <input checked="" type="checkbox"/>	64" x 32" x 30"	320
Horizontal	50" x 20" x 25"	60
		580 Hours/ Week

TURNING

Capability	Max Travel	Weekly Capacity (hours)
Bar fed	12.5" Dia. x 26" L	160
Multi-Axis Mill-Turn w/ Live Tooling	20" Dia. x 84" L	80
		240 Hours/ Week

MATERIALS

Aluminum	Steel/ Stainless Steel	Brass & Bronze
Titanium	Composites	And More...

**MANUAL**

Machine	Quantity	Dimensions
Bridgeport - Mill	3	-
Lathe	3	Up to 16" Dia. x 72" L
Surface Grinder	3	Up to 24" x 60"
OD Grinder	2	8" Dia. x 24" L
ID Grinder	1	-

WELDING

Type	Material
Mig	Steel
Tig	Aluminum & Steel

INSPECTION

Machine	Dimensions
Browne & Sharpe Performance	48" x 32"
Brown & Sharpe - Gage 2000	29" x 22"
Brown & Sharpe - Gage 2000	24" x 18"

SOFTWARE

Program	Function
CAMWorks	CAD/ CAM (ITAR Compliant)
Fusion 360	CAD/ CAM
ProShop (GovCloud)	ERP
Alora	CNC Machine Monitoring
Hexagon	Inspection



**ASSEMBLY &
KITTING**

Type
Mechanical
Hydraulic
Pneumatic
Electrical
Testing
Turnkey Assemblies

**OUTSIDE
PROCESSING**

Type
Heat Treat
Anodize
Black Oxide
Paint & Powder Coat
Plating

PLEASE SEND ALL RFQ'S TO:
CHAD@PTDMACHINING.COM

PRODUCTION TOOL
1710 CHARLOTTE HIGHWAY
LANCASTER, SOUTH CAROLINA
29720, UNITED STATES OF AMERICA