



THE MART SF

313,063 SF
CREATIVE
HEADQUARTERS

THEMARTSF.COM

CBRE

A CAMPUS TO SCALE

Thoughtful amenities, luxurious finishes and exceptional workspaces at your fingertips, One Tenth at The Mart SF is designed to draw you in and spark creativity.

- ◇ Expansion up to 1.0M SF
- ◇ ~35,000 SF floorplates
- ◇ LEED® Gold building
- ◇ 24/7 on-site security
- ◇ Branding and signage opportunity
- ◇ Light-filled flexible floorplates
- ◇ Furnished outdoor courtyard
- ◇ Top-tier, locally owned, Fitness SF on ground floor
- ◇ Onsite food hall and full-service restaurant, Cadillac Bar & Grill
- ◇ Full service cafeteria
- ◇ Potential for 250+ wired desks per floor
- ◇ 350+ parking garage with EV charging station
- ◇ 200+ bike facility with locker room & showers





Total expansion opportunity up to
1,000,000 SF

A PATH TO GROWTH

Large floor plates and large blocks of contiguous space allow tenants to virtually unlimited configurations and room for growth

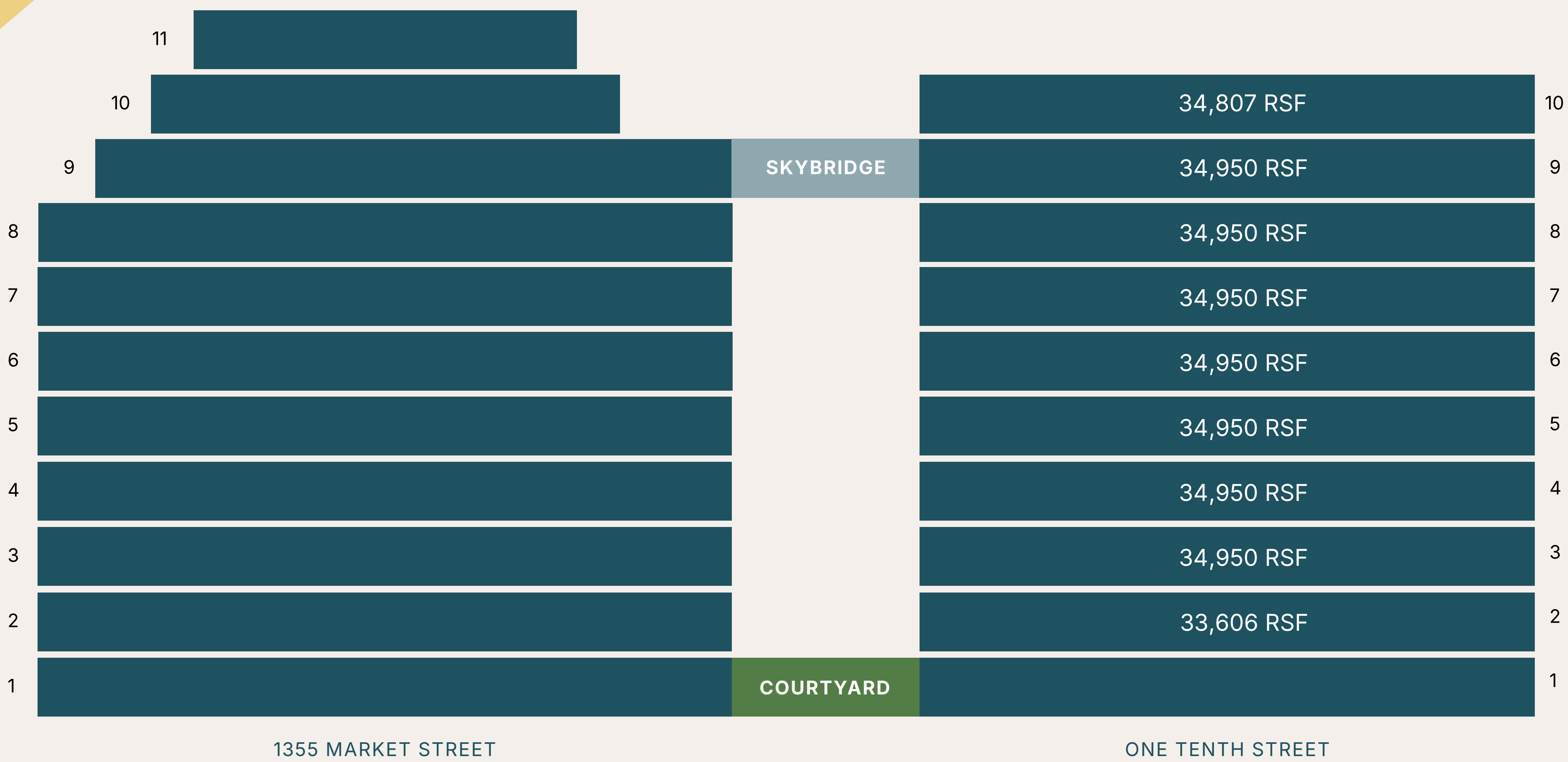



FULL CITY BLOCK

Former X Space

FLOOR 10

One Tenth Street

±34,950 RSF

- ◇ 11 Conference Rooms
- ◇ Potential for 98 Workstations
- ◇ Kitchen
- ◇ Executive Boardroom

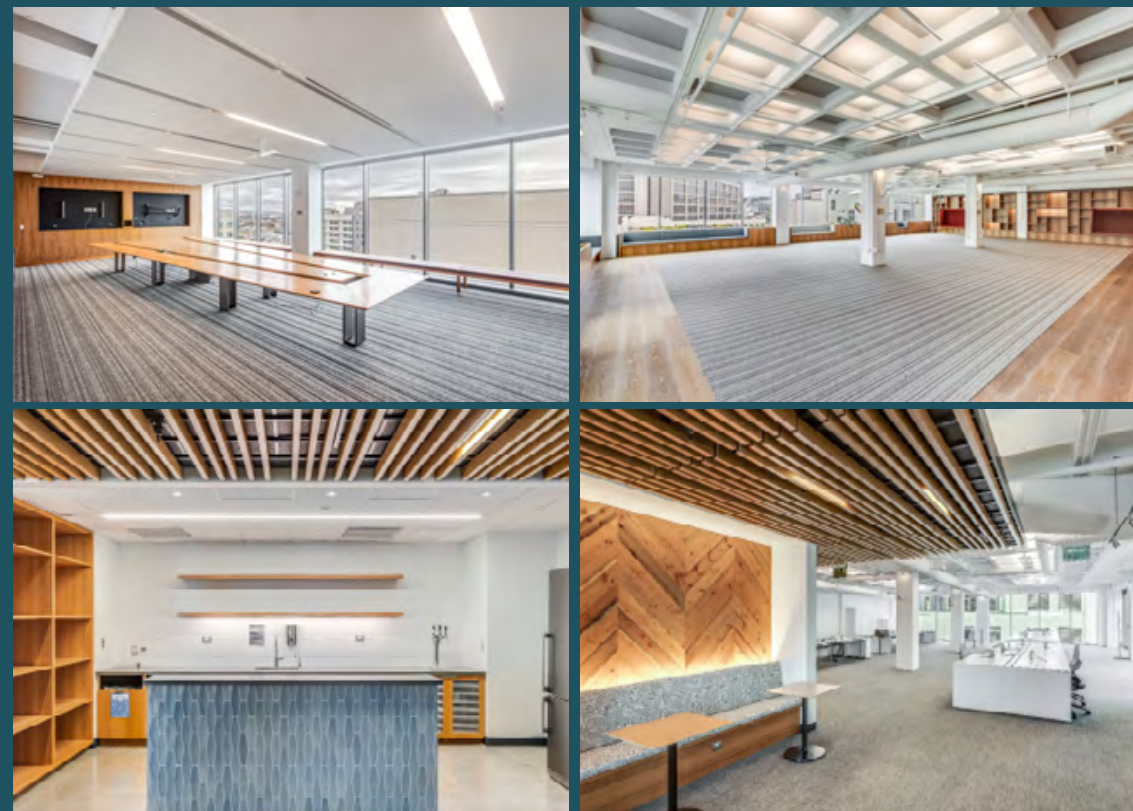

THE MART SF

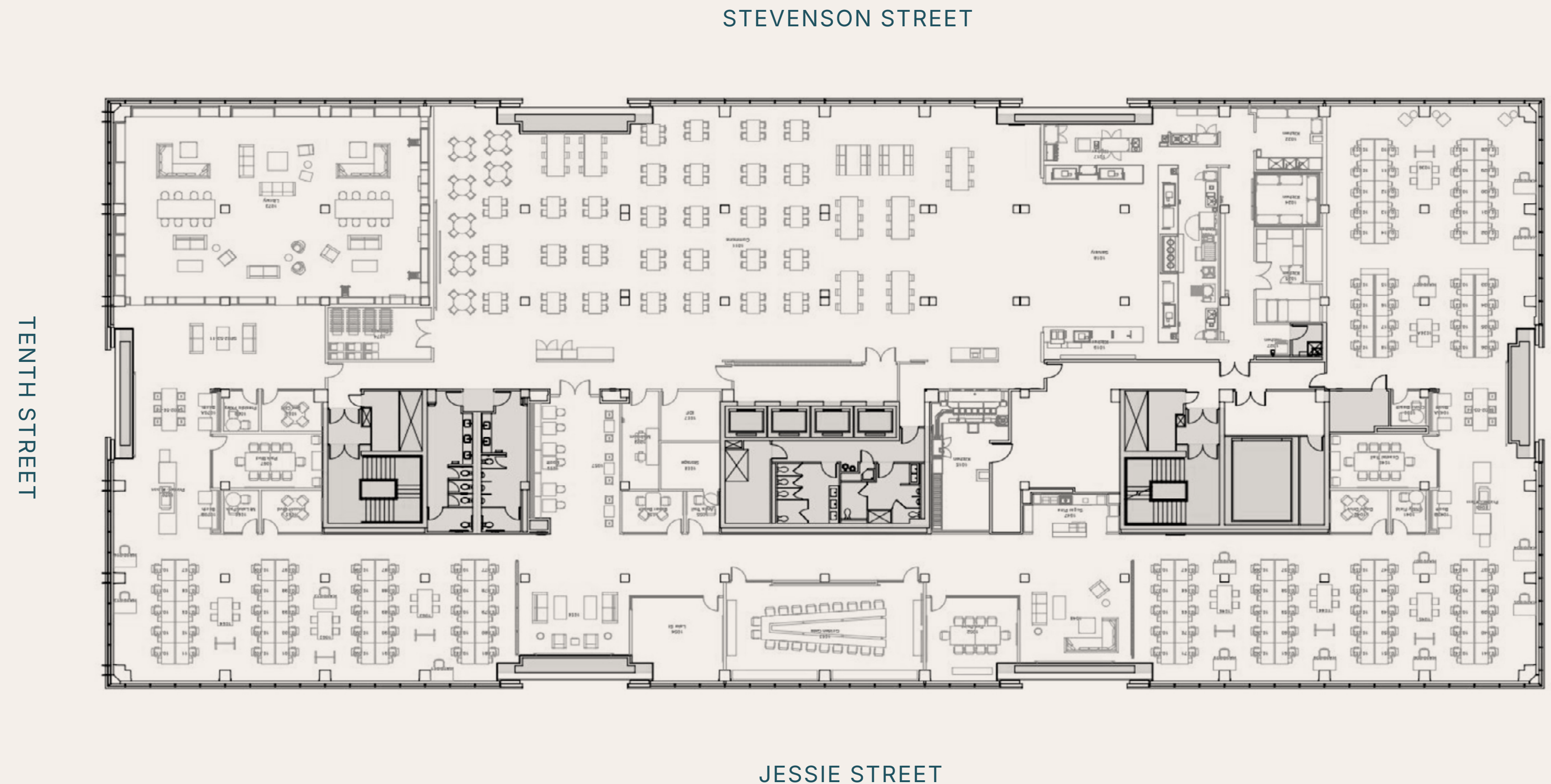

One Tenth Street

±34,807 RSF

- ◇ 15 Conference Rooms
- ◇ Potential for 136 Workstations
- ◇ Kitchen



THE MART SF

STEVENSON STREET

TENTH STREET

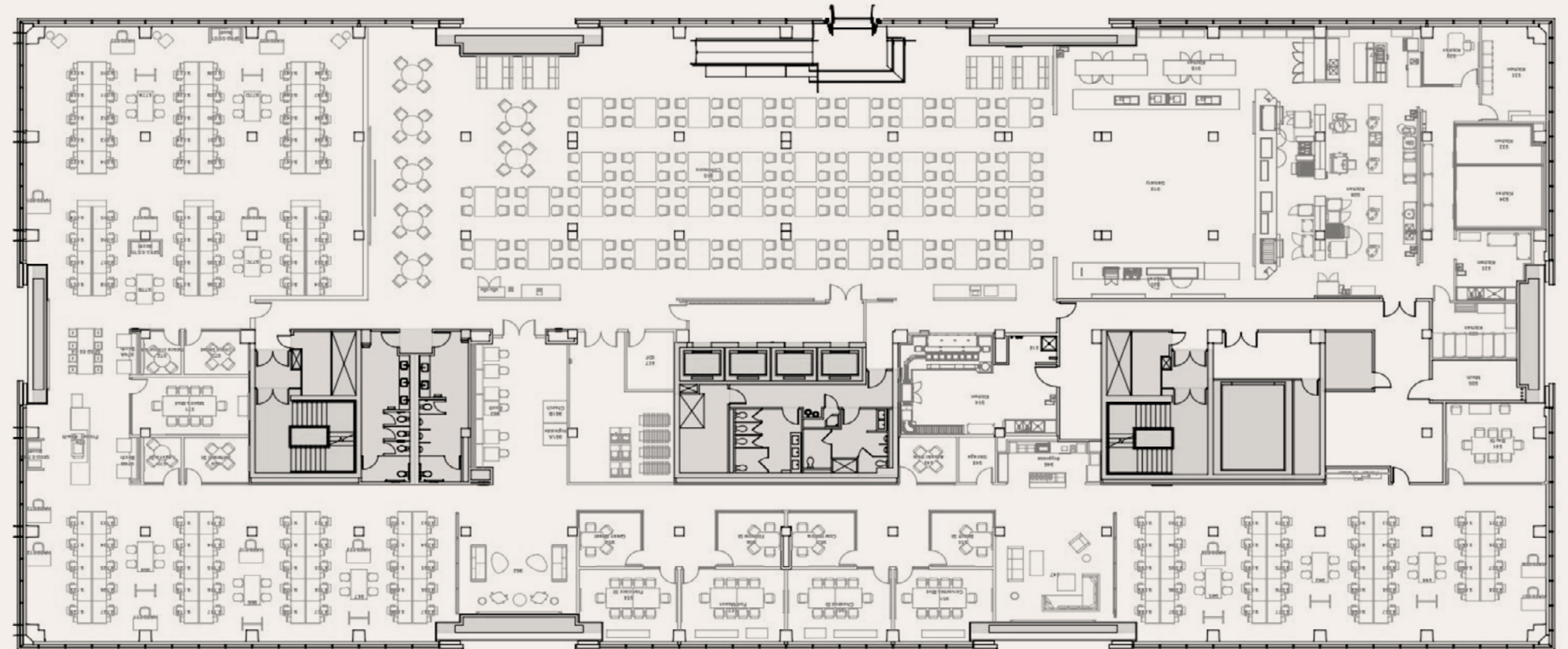

JESSIE STREET



FLOOR 8

One Tenth Street

±34,950 RSF

- ◇ 24 Conference Rooms
- ◇ Potential for 224 Workstations
- ◇ Kitchen

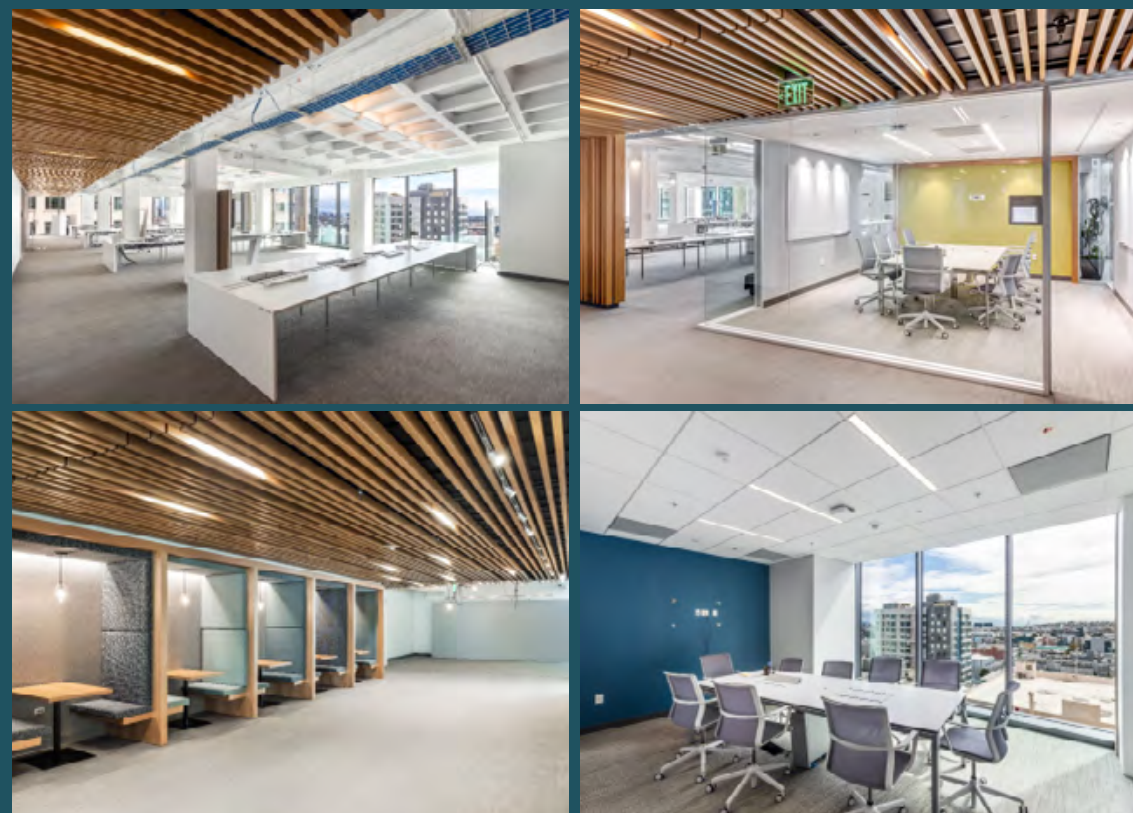

THE MART SF

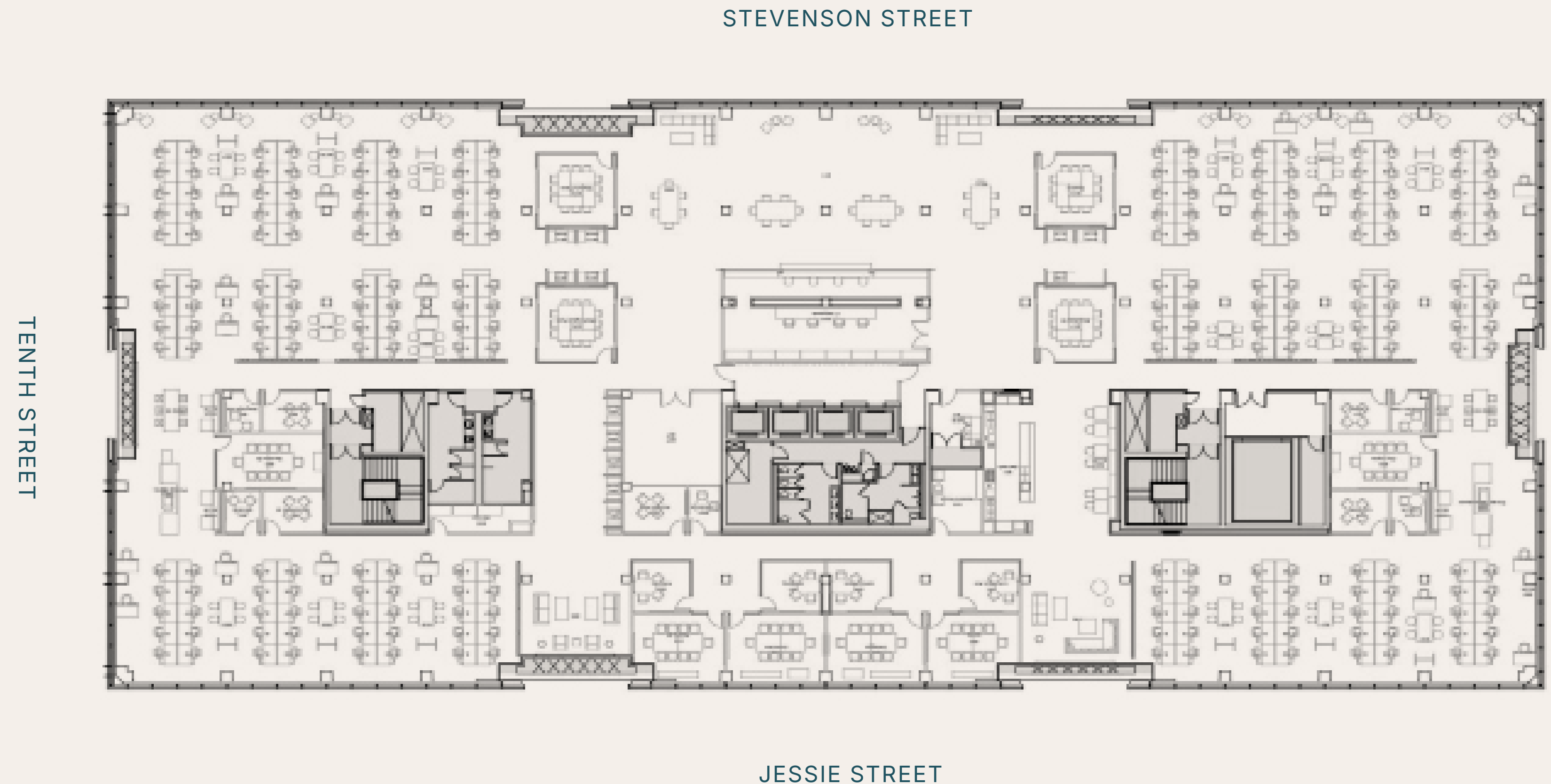

FLOOR 7

One Tenth Street

±34,950 RSF

- ◇ 24 Conference Rooms
- ◇ Potential for 296 Workstations
- ◇ Kitchen



THE MART SF

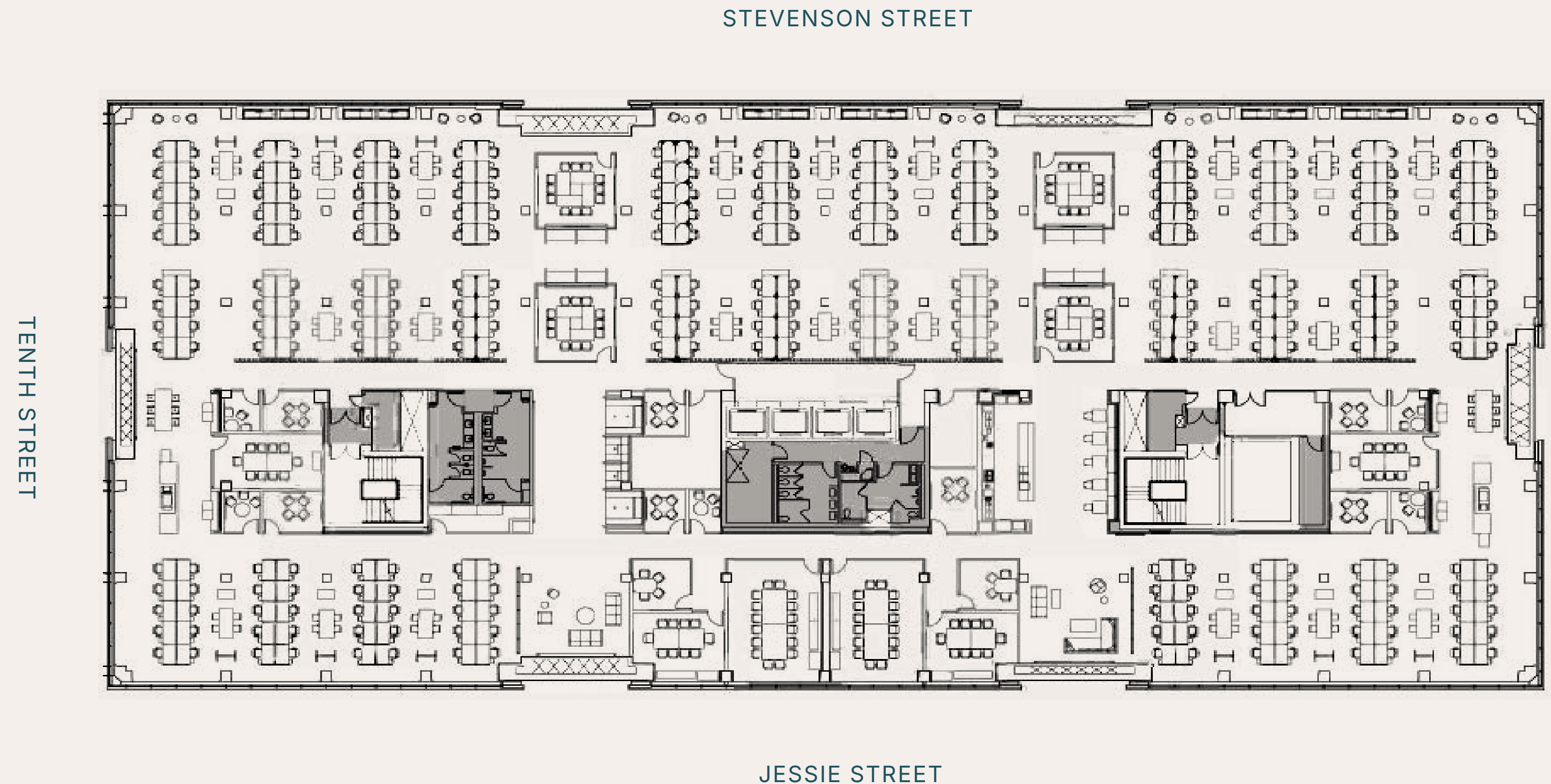

FLOOR 6

One Tenth Street

±34,950 RSF

- ◇ 25 Conference Rooms
- ◇ Potential for 286 Workstations
- ◇ Kitchen

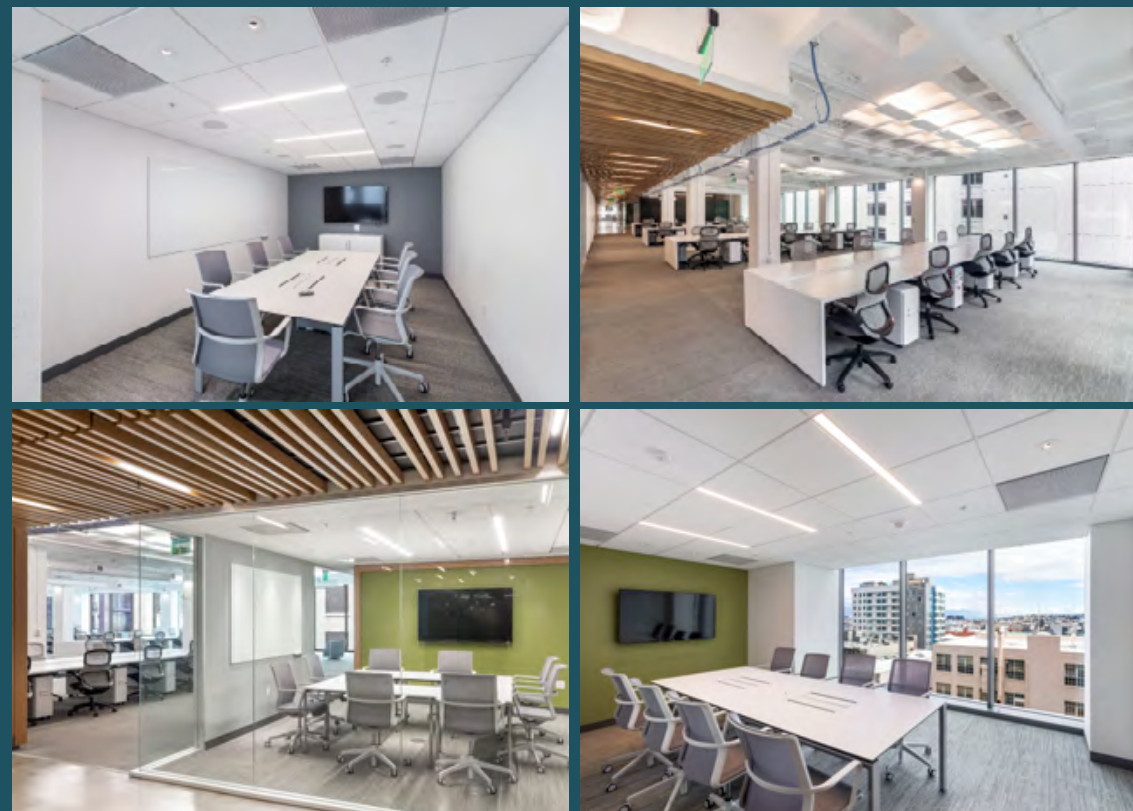

THE MART SF

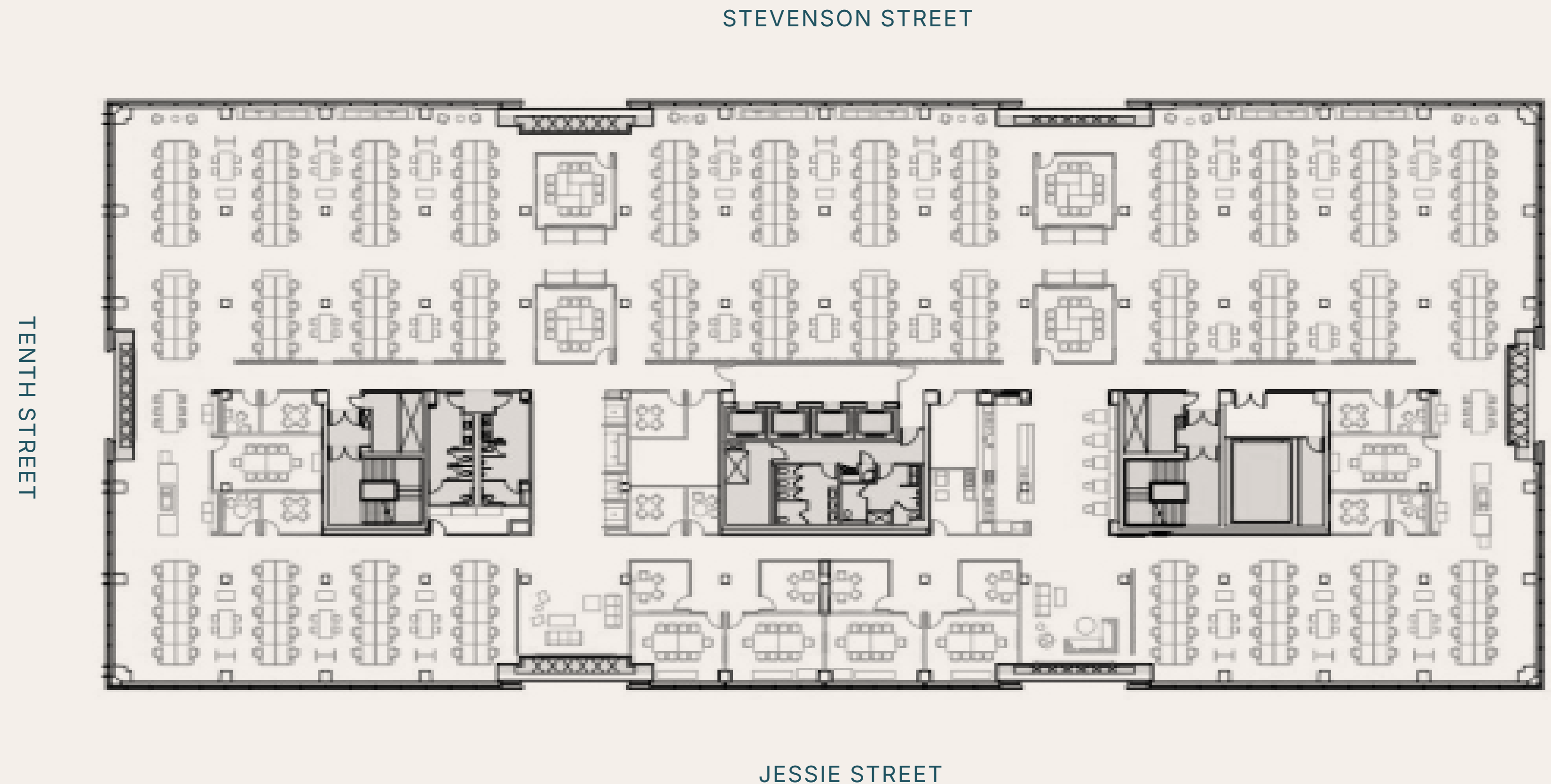

FLOOR 5

One Tenth Street

±34,950 RSF

- ◇ 23 Conference Rooms
- ◇ Potential for 256 Workstations
- ◇ Large Kitchen/Communal Area with Coffee Bar

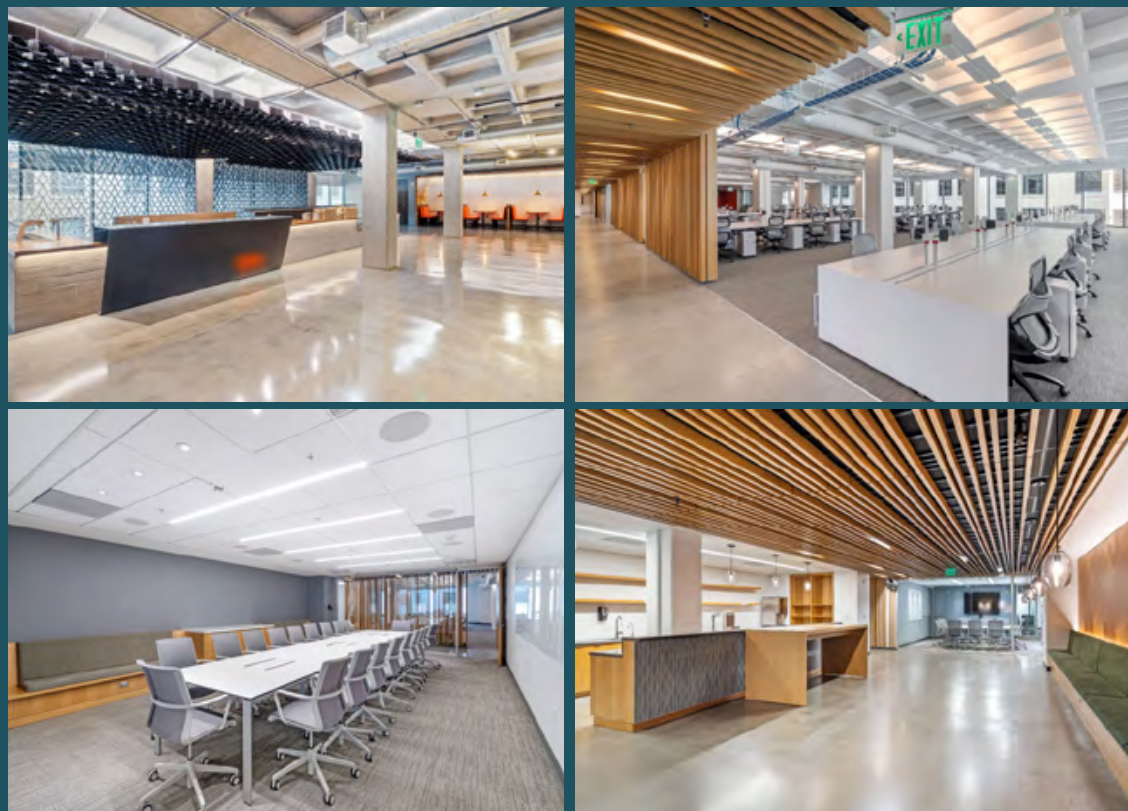

THE MART SF

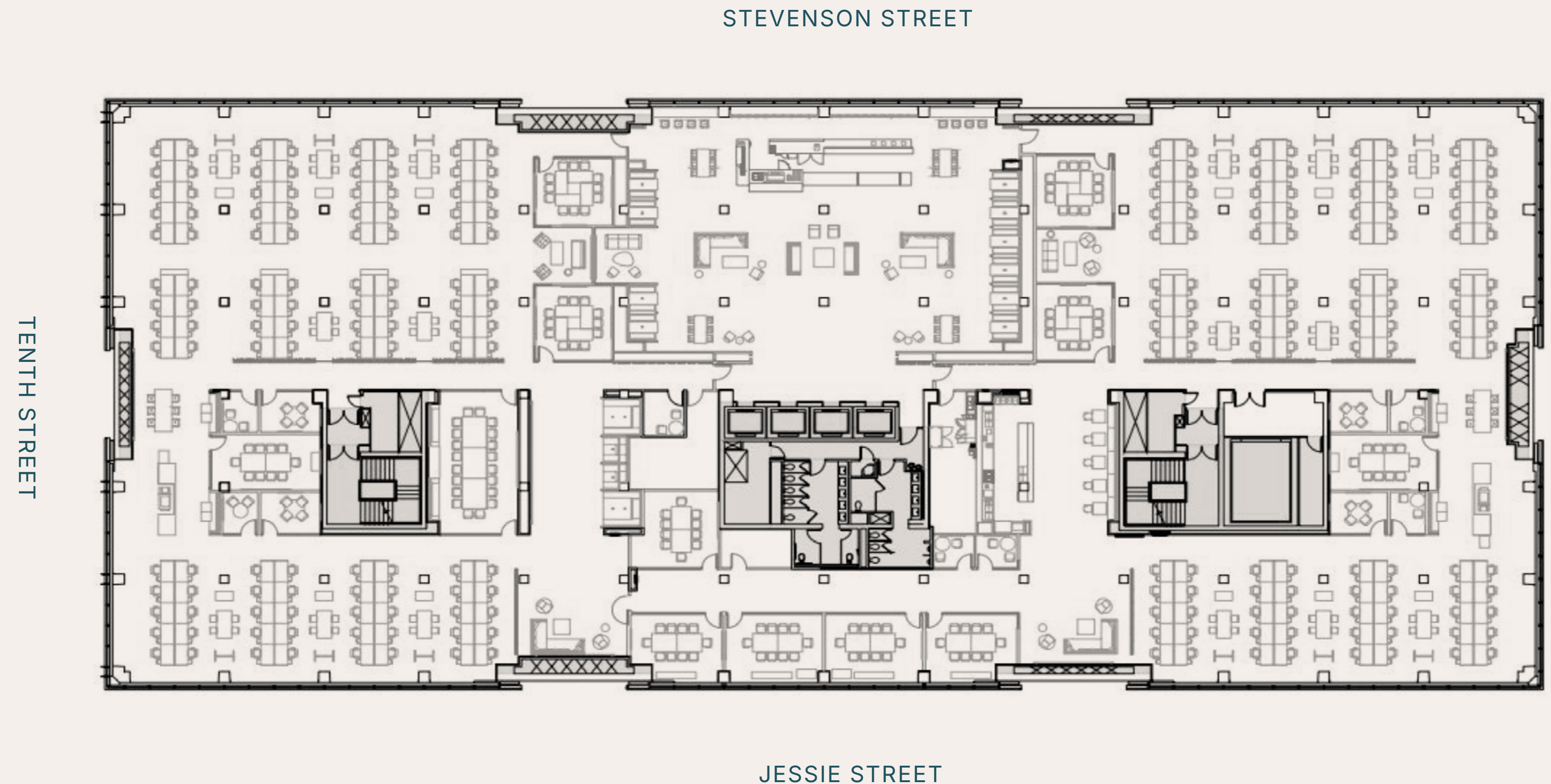

FLOOR 4

One Tenth Street

±34,950 RSF

- ◇ 24 Conference Rooms
- ◇ Potential for 296 Workstations
- ◇ Kitchen



THE MART SF

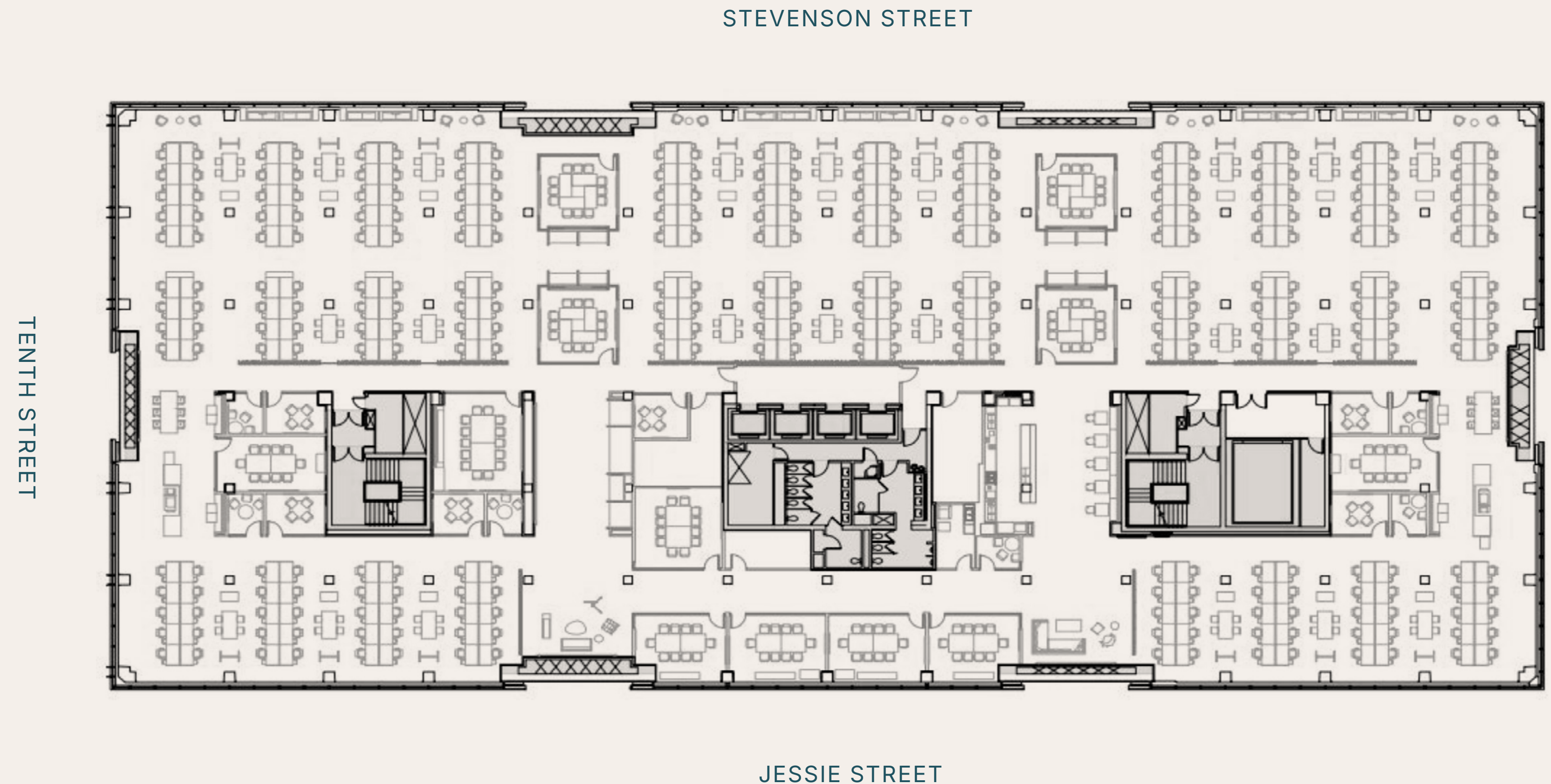

FLOOR 3

One Tenth Street

±34,950 RSF

- ◇ 18 Conference Rooms
- ◇ Potential for 296 Workstations
- ◇ Kitchen



THE MART SF

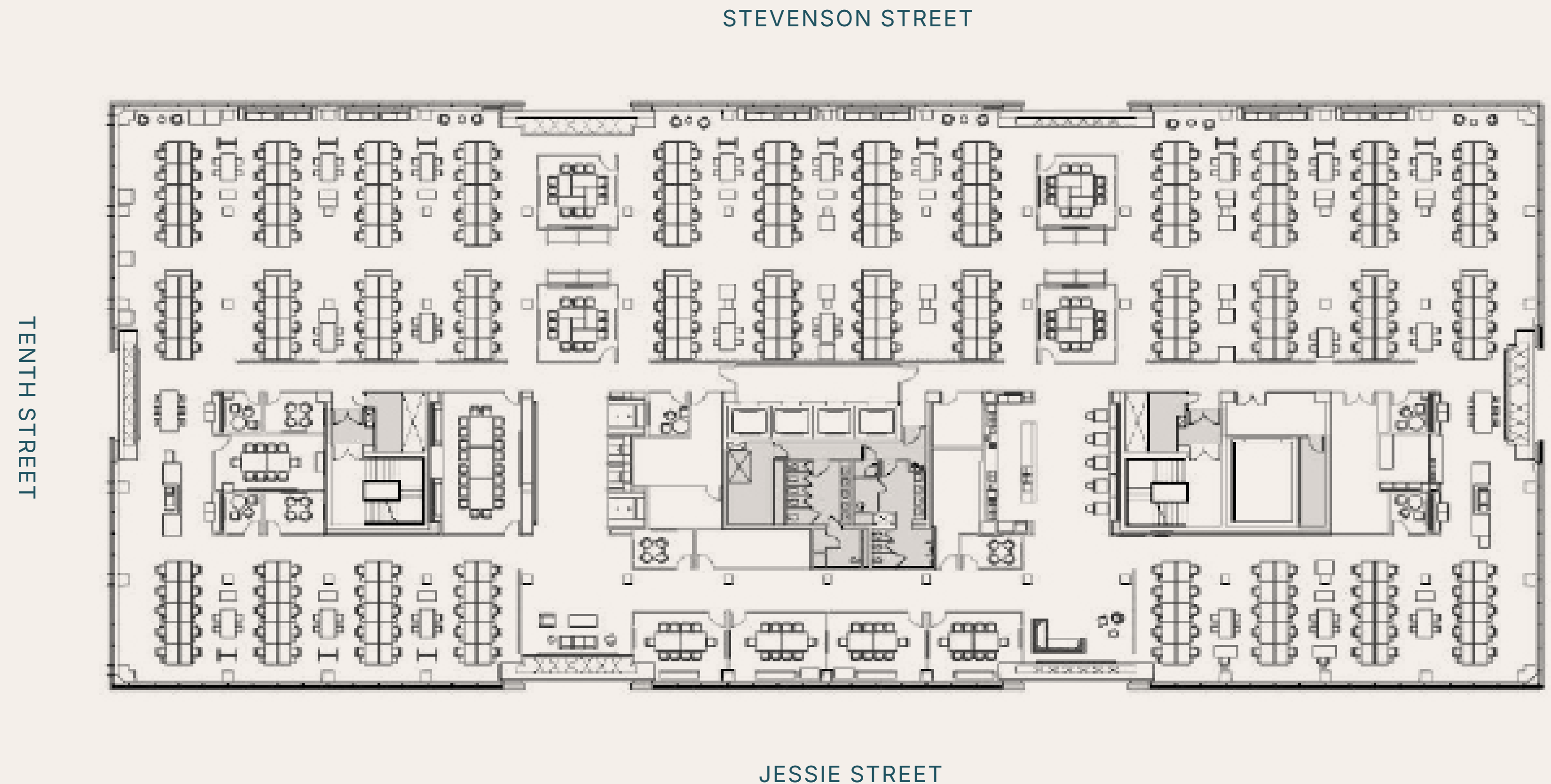

FLOOR 2

One Tenth Street

±33,606 RSF

- ◆ **Conferencing Floor**
- ◆ 12 Conference Rooms
- ◆ 3 Large Boardrooms
- ◆ 2 Large Auditorium Style Seatings
- ◆ 16 Phone Rooms
- ◆ Kitchen

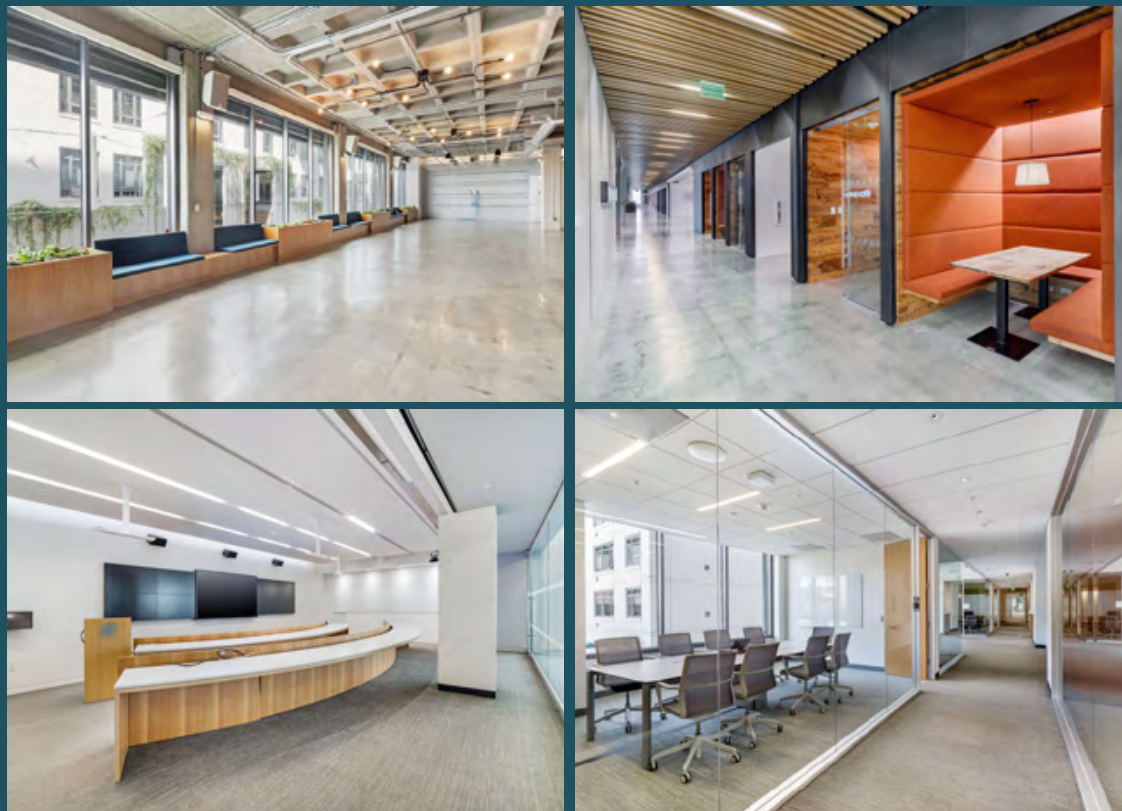

THE MART SF

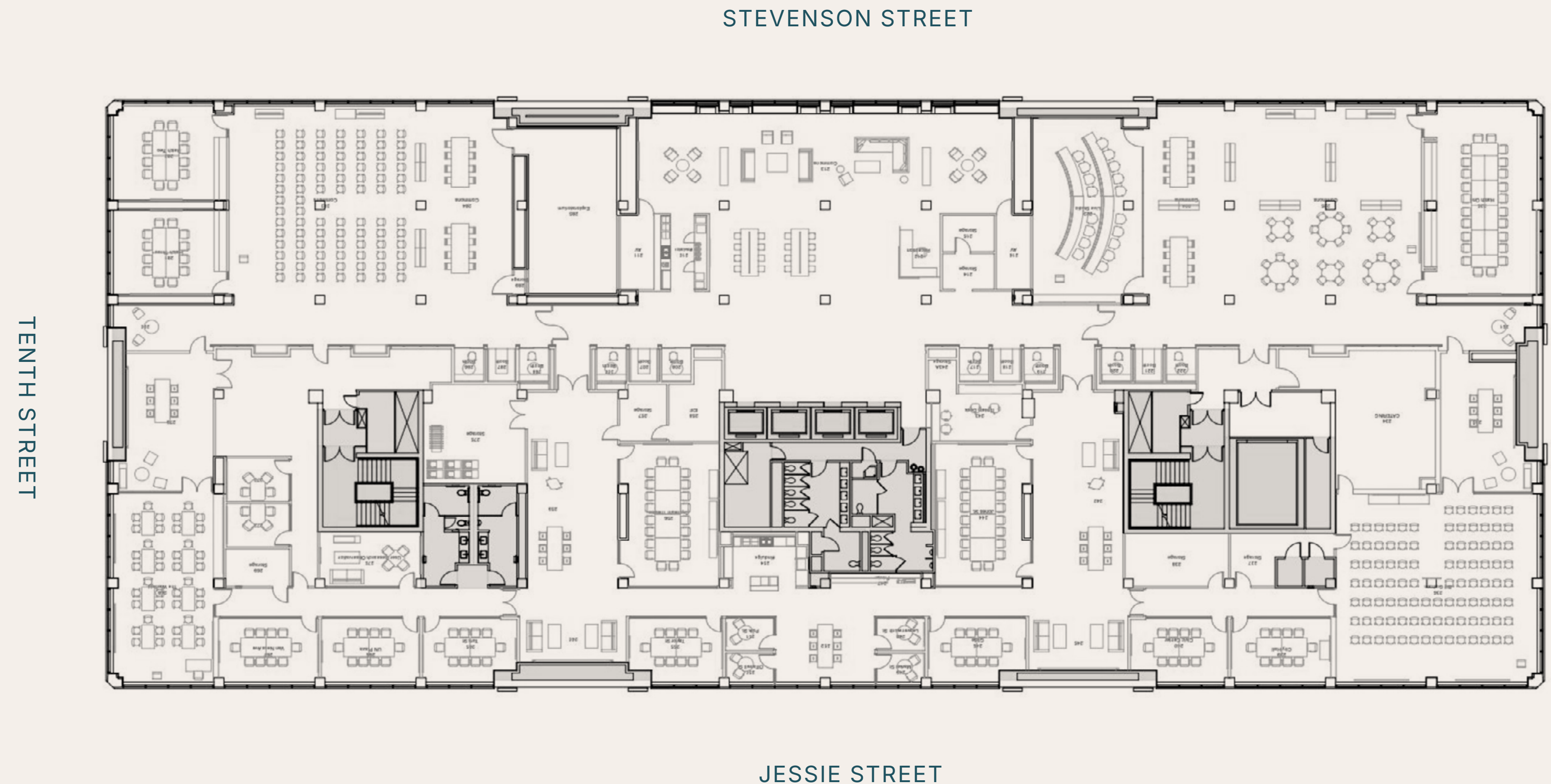





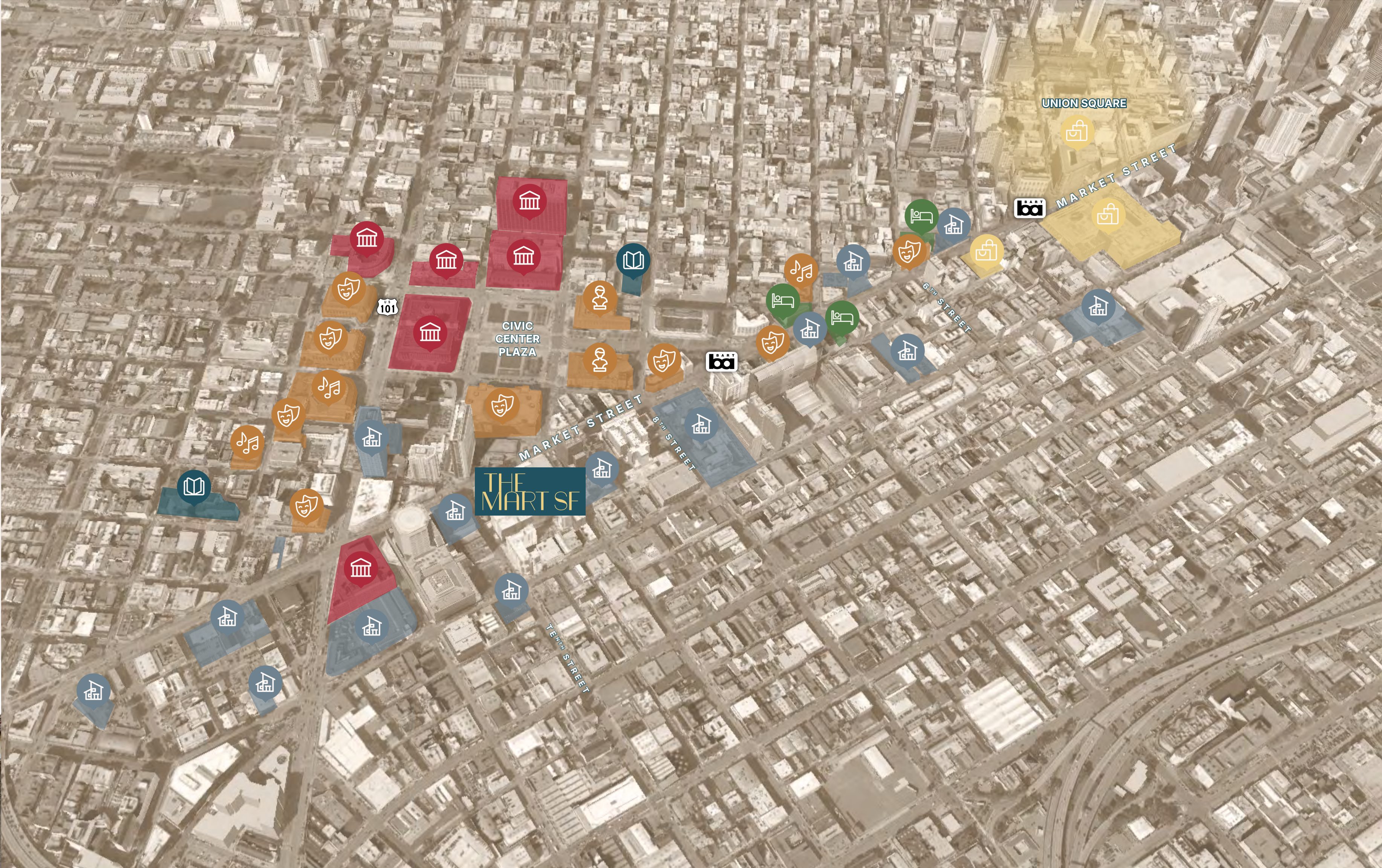

EVERYTHING YOU NEED ALL IN ONE PLACE

Surrounding The Mart SF is a historic—and dynamic—San Francisco neighborhood that’s home to tech offices, performing arts and music venues, Michelin-starred restaurants and more.



5-minute walk to housing, top cultural institutions, museums and 10+ performing arts venues

- | | | | | | |
|---|-------------|---|-------------|---|--------|
|  | EDUCATION |  | GOVERNMENT |  | ARTS |
|  | MULTIFAMILY |  | HOSPITALITY |  | RETAIL |

WORK WHERE IT ALL COMES TOGETHER

Exceptional convenience

- ◇ Walking distance from **Hayes + Mission**
- ◇ Less than 3 - minute walk to **Muni + Bart**
- ◇ 7-minute drive | 18-minute transit from **Mission District**
- ◇ 19-minute drive | 35-minute transit from the **Marina**
- ◇ 23-minute drive | 35-minute transit from **Outer Sunset**
- ◇ 20-minute drive to **Golden Gate Bridge**
- ◇ 15-minute drive to **SFO**
- ◇ 8-minute drive to **I-80** and **Hwy 101**



LEARN MORE AT THEMARTSF.COM

CONTACT

Conor Famulener

Executive Vice President

Lic. 01438818

C +1 510 847 0659

conor.fam@cbre.com

Luke Ogelsby

Vice Chairman

Lic. 01422599

C +1 415 271 5737

luke.ogelsby@cbre.com

Madison Dutra Sarro

First Vice President

Lic. 02041936

C +1 619 993 2520

madison.dutra@cbre.com

CBRE