

# STRONG

## TERRESTRIAL RECEIVER

SRT 84



Picture similar

User Manual

01/04/2025/1530

SERVICE CENTER		
AT	✉ ☎	<b>support_at@strong-eu.com</b> 0820 400 150 (€ 0,12/Min. österr. Festnetz)
BG	✉ ☎	<b>support_bg@strong-eu.com</b> +359 32 634451
CZ	✉ ☎	<b>support_cz@strong-eu.com</b> 844 44 44 90
DE	✉ ☎	<b>support_de@strong-eu.com</b> 0800 7788 787 (Gebührenfrei)
DK	✉	<b>support_dk@strong-eu.com</b>
ES	✉ ☎	<b>support_es@strong-eu.com</b> +34 91 119 61 76
FR	✉	<b>support_fr@strong-eu.com</b>
HR	☎	+385 1 344 57 66
HU	✉ ☎	<b>support_hu@strong-eu.com</b> +36 1 445 26 10
IT	✉	<b>support_it@strong-eu.com</b>
NL	✉	<b>support_nl@strong-eu.com</b>
PL	✉ ☎	<b>support_pl@strong-eu.com</b> 801 702 017
PT	✉ ☎	<b>support_pt@strong-eu.com</b> +351 2 100 06 125
SK	✉ ☎	<b>support_sk@strong-eu.com</b> 0850 15 05 50
SL	☎	+386 1 828 08 58
UA	✉ ☎	<b>support_ua@strong-eu.com</b> +380 (44) 238 61 50

Supplied by STRONG Austria  
 Represented by STRONG Ges.m.b.H.  
 Teinfaltstraße 8/4. Stock  
 1010 Vienna, Austria  
 Email: support\_at@strong-eu.com

## Licenses

This product contains one or more programs protected under international and U.S. copyright laws as unpublished works. They are confidential and proprietary to **Dolby Laboratories**. Their reproduction or disclosure, in whole or in part, or the production of derivative works therefrom without the express permission of Dolby Laboratories is prohibited. Copyright 2003-2009 by Dolby Laboratories. All rights reserved.

THIS PRODUCT IS SOLD WITH A LIMITED LICENSE AND IS AUTHORIZED TO BE USED ONLY IN CONNECTION WITH HEVC CONTENT THAT MEETS EACH OF THE THREE FOLLOWING QUALIFICATIONS: (1) HEVC CONTENT ONLY FOR PERSONAL USE; (2) HEVC CONTENT THAT IS NOT OFFERED FOR SALE; AND (3) HEVC CONTENT THAT IS CREATED BY THE OWNER OF THE PRODUCT. THIS PRODUCT MAY NOT BE USED IN CONNECTION WITH HEVC ENCODED CONTENT CREATED BY A THIRD PARTY, WHICH THE USER HAS ORDERED OR PURCHASED FROM A THIRD PARTY, UNLESS THE USER IS SEPARATELY GRANTED RIGHTS TO USE THE PRODUCT WITH SUCH CONTENT BY A LICENSED SELLER OF THE CONTENT. YOUR USE OF THIS PRODUCT IN CONNECTION WITH HEVC ENCODED CONTENT IS DEEMED ACCEPTANCE OF THE LIMITED AUTHORITY TO USE AS NOTED ABOVE.

## SIMPLIFIED EU DECLARATION OF CONFORMITY

Hereby, STRONG declares that the device SRT 84 is in compliance with Directive 2014/53/EU.

The full text of the EU declaration of conformity is available at the following internet address: <https://www.strong-eu.com/downloads/downloads>

Subject to alterations. In consequence of continuous research and development technical specifications, design and appearance of products may change. The terms HDMI, HDMI High-Definition Multimedia Interface, HDMI trade dress and the HDMI Logos are trademarks or registered trademarks of HDMI Licensing Administrator, Inc. Manufactured under license from Dolby Laboratories. Dolby, Dolby Audio, and the double-D symbol are trademarks of Dolby Laboratories Licensing Corporation. All product names are trademarks or registered trademarks of their respective owners.

© STRONG 2025. All rights reserved.

## **TABLE OF CONTENT**

<b>1.0 INTRODUCTION</b>	<b>6</b>
1.1 SAFETY INSTRUCTIONS	6
1.2 PRECAUTIONS	6
1.3 OPERATING ENVIRONMENT	6
1.4 WEEE DIRECTIVE	7
1.5 STORAGE	7
1.6 EQUIPMENT SET-UP	7
1.7 ACCESSORIES	7
1.8 USAGE OF EXTERNAL USB DEVICES	7
<b>2.0 YOUR RECEIVER</b>	<b>8</b>
2.1 PIN-CODE DEFAULT: 1234	8
2.2 SIDE PANEL	8
2.3 REMOTE CONTROL	8
2.4 INSTALLING THE BATTERIES	9
2.5 USING THE REMOTE CONTROL AND THE IR EXTENDER.	10
<b>3.0 CONNECTION</b>	<b>11</b>
3.1 CONNECTING TO A TERRESTRIAL ANTENNA	11
3.2 CONNECTING TO TV WITH HDMI EXTENDER CABLE OR DIRECTLY TO HDMI PORT	11
3.3 CONNECTING A USB STORAGE DEVICE	12
<b>4.0 STARTING UP FOR THE FIRST TIME</b>	<b>12</b>
<b>5.0 QUICK GUIDE TO USING YOUR RECEIVER</b>	<b>13</b>
<b>6.0 OPERATION</b>	<b>13</b>
6.1 CHANGING CHANNELS	13

6.2 INFO BANNER	13
6.3 AUDIO	13
6.4 TELETEXT	13
6.5 SUBTITLES	14
6.6 TIMESHIFT	14
6.7 EPG (ELECTRONIC PROGRAMME GUIDE)	14
6.8 INSTANT RECORDING	14
6.9 SLEEP	14
<b>7.0 MAIN MENU</b>	<b>14</b>
7.1 MEDIA PLAYER	14
7.2 EDIT CHANNEL	16
7.3 INSTALLATION MENU	17
7.4 SYSTEM SETUP	18
7.5 TOOLS MENU	21
<b>8.0 TROUBLESHOOTING</b>	<b>22</b>
<b>9.0 TECHNICAL SPECIFICATIONS</b>	<b>24</b>

## 1.0 INTRODUCTION

### 1.1 SAFETY INSTRUCTIONS

Read all of the instructions before operating the device. Keep these instructions well for later use.

- Only use attachments/accessories specified or provided by the manufacturer (such as the exclusive supply adapter, battery etc.).
- Please refer to the information on the product enclosure for electrical and safety information before installing or operating the apparatus.
- To reduce the risk of fire or electric shock, do not expose this apparatus to rain or moisture.
- The ventilation should not be impeded by covering the ventilation openings with items, such as newspaper, tablecloths, curtains, etc.
- The apparatus shall not be exposed to dripping or splashing and no objects filled with liquids, such as vases, shall be placed on the apparatus.
- ⚠ This mark indicates a risk of electric shock.
- To prevent injury, this apparatus must be securely attached to the floor/wall in accordance with the installation instructions.
- Danger of explosion if the battery is incorrectly replaced. Replace only with the same or equivalent types.
- The battery (battery or batteries or battery pack) shall not be exposed to excessive heat such as sunshine, fire or the like.
- Excessive sound pressure from earphones and headphones can cause hearing loss.
- Listening to music at high volume levels and for extended durations can damage one's hearing.
- In order to reduce the risk of damage to hearing, one should lower the volume to a safe, comfortable level, and reduce the amount of time listening at high levels.
- The mains plug or appliance coupler is used as disconnect device, it shall remain readily operable. When not in use and during movement, please take care of the power cord set, e.g. tie up the power cord set with cable tie or something like that. It shall be free from sharp edges or similar which can cause abrasion of the power cord set. When put into use again, please make sure the power cord is not damaged. The absence of a light indication on the apparatus does not mean that it is fully disconnected from the mains. To disconnect the apparatus completely, the mains plug must be pulled out.
- Attention should be drawn to environmental aspects of battery disposal.
- No naked flame sources, such as lighted candles, should be placed on the apparatus.
- ☒ To prevent the spread of fire, keep candles or other open flames away from this product at all times.
- ☐ Equipment with this symbol is a Class II or double insulated electrical appliance. It has been designed in such a way that it does not require a safety connection to electrical earth.

### 1.2 PRECAUTIONS

- Never try to open the device. It is dangerous to touch the inside of the device due to high voltages and possible electrical hazards. Opening the device will void the warranty of the product. Refer all maintenance or servicing to suitably qualified personnel.
- When you are connecting cables, be sure that the device is disconnected from the mains supply voltage. Wait a few seconds after switching off the device before you move the device or disconnect any equipment.
- It is a necessity that you only use an approved extension and compatible wiring that is suitable for the electrical power consumption of the installed equipment. Please ensure that the electrical power supply corresponds with the voltage on the electrical identification plate at the back of the device.

### 1.3 OPERATING ENVIRONMENT

- Do not install this equipment in a confined space such as a bookcase or similar unit.
- Do not use the set near damp, and cold areas, protect the set from overheating.
- Keep away from direct sunlight.
- Do not use the set near dust place.
- Do not place candles near the opening area, to avoid flammable foreign material from entering the device.

## 1.4 WEEE DIRECTIVE



Correct Disposal of this product. This marking indicates that this product should not be disposed with other household wastes throughout the EU. To prevent possible harm to the environment or human health from uncontrolled waste disposal, recycle it responsibly to promote the sustainable reuse of material resources. To return your used device, please use the return and collection systems or contact the retailer where the product was purchased. They can take this product for environmentally safe recycling.

## 1.5 STORAGE

Your device has been carefully checked and packed before shipping. When unpacking it, make sure that all the parts are included and keep the packaging away from children. We recommend that you keep the carton during the warranty period, to keep your device perfectly protected in the event of repair or warranty.

## 1.6 EQUIPMENT SET-UP

We recommend you to consult a professional installer to set up your equipment. Otherwise, please follow the instructions below:

- Refer to the user manual of your TV and your antenna.
- Make sure that the HDMI cable and outdoor components are in a good condition and the HDMI connections are well shielded and from good quality.

This user manual provides complete instructions for installing and using this receiver. The symbols serve as follows.

**WARNING:** Indicates warning information.

**NOTE:** Indicates any other additional important or helpful information.

**MENU:** Represents a button on the remote control or the receiver. (Bold characters)

*Move to:* Represents a menu item within a screen. (Italic characters)

## 1.7 ACCESSORIES

- 1x SRT84
- 1x IR extender
- 1x IEC to SMA adapter
- 1x Micro USB Y- cable
- 1x HDMI adapter cable
- 1x 2 in 1 remote control
- 2x AAA batteries
- 1x Installation instructions
- 1x Double sided sticker

**WARNING:** The batteries should not be recharged, disassembled, electrically short-circuited, be mixed or used with other types of batteries. If rechargeable accumulators instead of batteries are going to be used, we recommend using (e.g. NiMH) types with low self-discharge to ensure long time operation of remote control.

## 1.8 USAGE OF EXTERNAL USB DEVICES

- It is recommended to use USB 2.0 storage devices. If your device is not compatible to USB 2.0 specifications, the playback with your receiver might not work properly.
- If you are going to use external USB HDD (Hard Disk Drive) please consider that the power specifications might exceed the supported output of your receiver (5 V/500 mA). If so, please connect your USB HDD to an according external power adapter.
- STRONG cannot guarantee compatibility with all types of USB storage devices.
- It is advised not to store important information on USB storage devices used with the receiver. Always make backups of data on your USB storage device before using it with this receiver. STRONG will not take responsibility for any loss of information or circumstances caused by loss of information.
- Please ensure that either the USB device is already formatted to NTFS or FAT32 or format the USB device via your receiver. Formatting requires entering the PIN code (default <1234>)
- STRONG cannot guarantee the playback of all files although extensions are listed, as it depends on file size, codec, bit rate and resolution.

## 2.0 YOUR RECEIVER

### 2.1 PIN-CODE DEFAULT: 1234

### 2.2 SIDE PANEL

Fig. 1

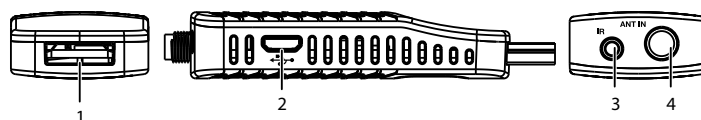

- |                |  |
|----------------|--|
| 1. TV (HDMI)   | To connect your receiver with your TV set using an HDMI extension cable or directly.     |
| 2. Micro USB   | Connector for USB devices and power from TV USB.   |
| 3. IR extender | Point your remote control towards this sensor.   |
| 4. Antenna     | To connect to your antenna for the reception of broadcast signal, using the IEC adapter. |

### 2.3 REMOTE CONTROL

Fig. 2

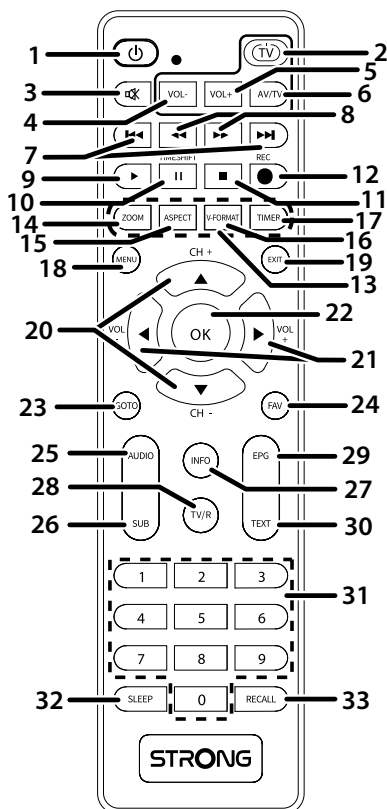

- |          |   |
|----------|---|
| 1.       | Turns the receiver On/Standby                             |
| 2. TV    | Programmable button, see chapter *                        |
| 3.       | Mutes audio output of the receiver                        |
| 4. VOL - | Programmable button, see chapter *                        |
| 5. VOL + | Programmable button, see chapter *                        |
| 6. AV/TV | Programmable button, see chapter *                        |
| 7.       | Previous / Next item in Multimedia.                       |
| 8.       | Fast rewind / Fast forward                                |
| 9.       | Start playback in Multimedia, Start Playback of Timeshift |



- |                             |   |
|-----------------------------|---|
| 10. <b>  </b>               | Activates the Timeshift function  |
| 11. <b>■</b>                | To stop playback or Time shift function   |
| 12. <b>●</b>                | Records the TV programme to the connected storage device  |
| 13. <b>COLOURED BUTTONS</b> | For Editing in menu, Multimedia and Teletext functions.<br>Follow on screen suggestions Combined on coloured buttons: |
| 14. <b>ZOOM</b>             | Zoom in Multimedia Picture show.  |
| 15. <b>ASPECT</b>           | Change aspect ratio of the video, default is Auto.  |
| 16. <b>V.F.</b>             | Change the video format of the video.   |
| 17. <b>TIMER</b>            | See an overview and/or edit the timer schedule  |
| 18. <b>MENU</b>             | Opens the main menu. In menu you will get one step back   |
| 19. <b>EXIT</b>             | Exits from the menu or sub-menu   |
| 20. <b>▲▼</b>               | Menu Off: Change channel to previous/next.<br>Menu On: Moves the cursor up/down.                                      |
| 21. <b>◀▶</b>               | Menu Off: Increases/decreases the volume level.<br>Menu On: Change settings for specific Menus                        |
| 22. <b>OK</b>               | Menu Off: Displays the current channel list<br>Menu On: Activates the highlighted menu item.                          |
| 23. <b>GOTO</b>             | No Function   |
| 24. <b>FAV</b>              | Favourite group selection   |
| 25. <b>AUDIO</b>            | Sets the current audio channel to left, right or stereo   |
| 26. <b>SUB</b>              | Shows list of subtitled languages   |
| 27. <b>INFO</b>             | Shows the actual channel information, toggle for more info  |
| 28. <b>TV/R</b>             | Toggles between TV or RADIO mode  |
| 29. <b>EPG</b>              | Shows the EPG (Electronic Programme Guide) in TV mode   |
| 30. <b>TEXT</b>             | Shows Teletext on OSD (On Screen Display)   |
| 31. <b>0~9</b>              | Channel selection or value input  |
| 32. <b>SLEEP</b>            | Press <b>SLEEP</b> repeatedly to select an automatic switch off time  |
| 33. <b>RECALL</b>           | Back to previous shown channel  |

## 2.4 INSTALLING THE BATTERIES

**Fig. 3**

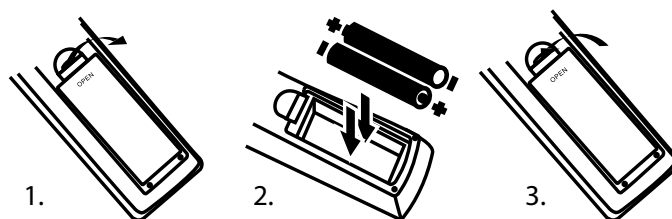

Open the cover on the remote control and insert 2x AAA type batteries into the compartment. Observe correct polarity of the batteries when inserting. A terminal diagram is shown inside the compartment.

1. Remove the cover.
2. Insert the batteries.
3. Place the cover.

## 2.5 USING THE REMOTE CONTROL AND THE IR EXTENDER.

Connect the external IR extender to the unit at the IR connector and place the sensor end somewhere convenient, where it can be "seen" by the Remote Control, for example on the TV front panels bezel. Use the provided double sided sticker.

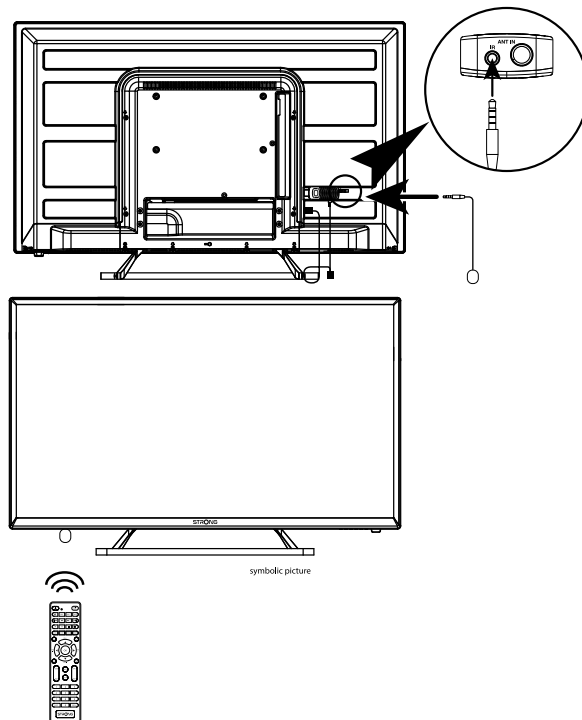

**Fig. 4**



To use the remote control, point it towards the external IR extender. The remote control supports a range of up to 5 meters distance to the receiver at an angle of up to approx. 30 degrees.

**NOTE:** Managing the receiver will be limited or not possible if there are obstacles between the remote control sensor and the remote control. Direct sunlight or very bright light can reduce or disturb the reception of the remote control signals.

### 2in1 RCU programming procedure.

Hint for programming buttons: TV , TV **VOL + VOL -**, TV 

1. Have the unit's RCU and the one from the TV lined up opposite of each other, e.g. on a table.  
The IR sensors should be pointing at each other, at about 3 - 4 cm distance.
2. Press and hold the Blue **TV** button on the unit's RCU, a Red LED lights up flashing, hold Set until LED lights up steadily. Release **TV** button.
3. Press the button on the unit's RCU which you want to program shortly. (Example On/Off, Blue) The LED will start flashing slowly.
4. Now press on the TV its RCU the corresponding On/Off button shortly.  
The LED will start flashing quickly to confirm command has been taken.
5. To program the other programmable buttons, repeat steps 3 and 4.
6. To exit the procedure at the end of programming, or at any moment, press **OK** shortly. The Red LED switches off.

## 3.0 CONNECTION

### 3.1 CONNECTING TO A TERRESTRIAL ANTENNA

Fig. 5

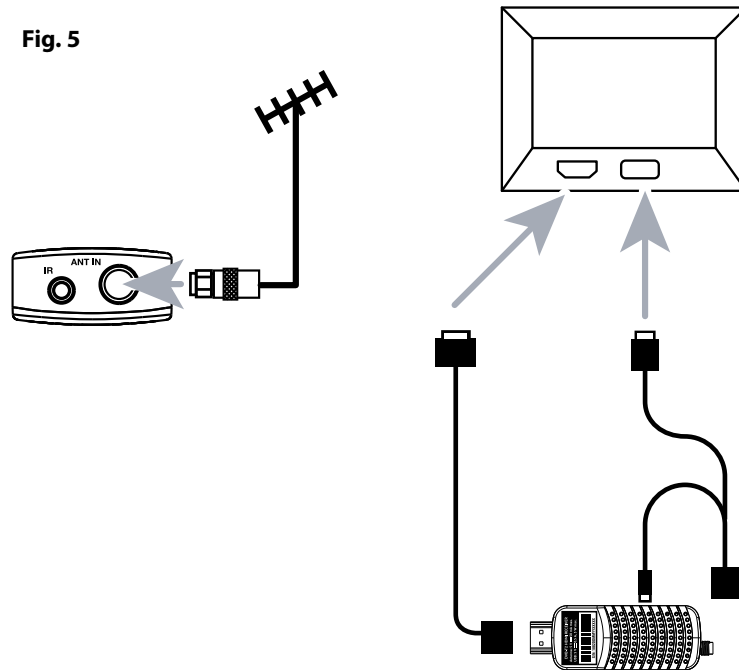

To receive broadcast signal, your terrestrial indoor or outdoor antenna must be connected to the RF IN connector of the receiver. Use a properly shielded antenna cable and suitable connectors. Use the provided SMA to IEC adapter to connect your antenna.

### 3.2 CONNECTING TO TV WITH HDMI EXTENDER CABLE OR DIRECTLY TO HDMI PORT

Fig. 5

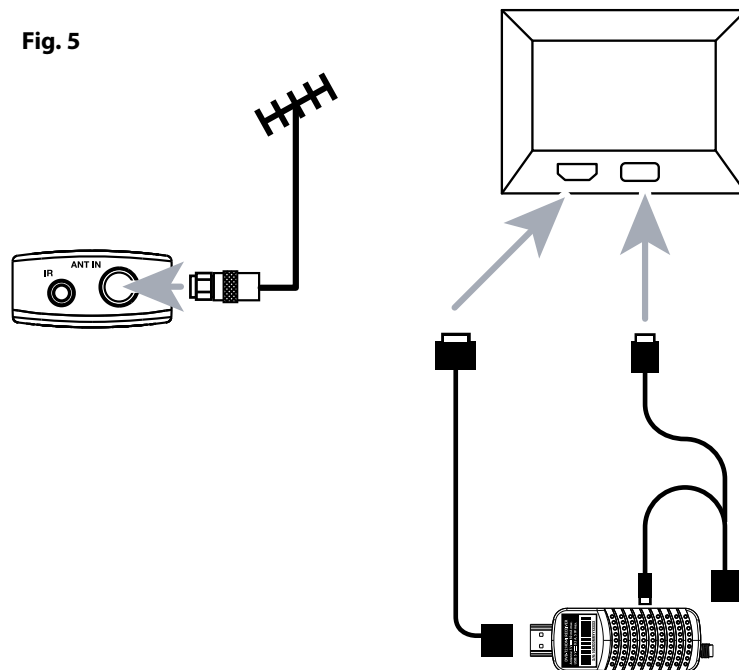

The TV set can be connected with the receiver using the provided HDMI extender cable. If enough spacing left between HDMI inputs and sufficient space is available to accommodate the various cables, then the receiver can also be inserted directly in to an HDMI port of the TV. Proceed with care, no physical tension should occur to the TV or receiver once inserted.

## 3.3 CONNECTING A USB STORAGE DEVICE

Fig. 6

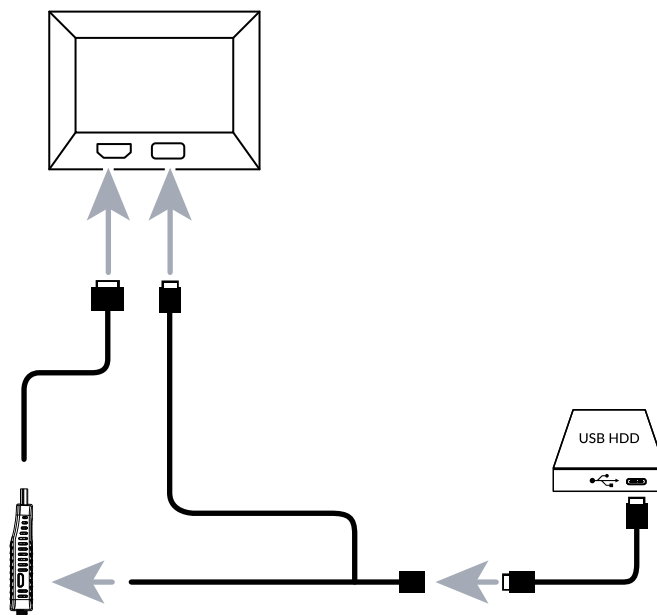

**NOTE:** We recommend the use of a hard disk drive USB 2.0 or higher for recording and play back of TV events.

Use the provided Y-cable (USB-A female at one end, USB-A male and USB-micro to each of the legs).

Connect the USB A plug to the USB port on your TV that is suitable for supplying power to external devices (5V and 0.9A) and connect the USB micro plug to the receiver.

The USB-A female can be used to connect an optional external HDD. The HDD will thus be powered by the TV, not by the receiver.

For proper functioning of Timeshift and recording functions, a fast USB device (such as a hard disk drive) is needed.

Interrupted playback or a distorted picture during playback or Timeshift are indications for a low device speed. STRONG cannot guarantee proper functioning of recording and or Timeshift functions with all USB devices.

## 4.0 STARTING UP FOR THE FIRST TIME

If you use your receiver for the first time, the *Welcome* menu appears. Use ▲▼ to move the highlight to the setting you wish to change and use ◀▶ to change values. Start by selecting your On-Screen Language (OSD) using ◀▶. Once you have selected your *Region*, press ▼ to move the highlight to *Language*. Select your language using ◀▶.

Other options are:

**Antenna Power:** Set to On if you use an active antenna. When set to On, a 5 Volt power will be present on the RF IN connector of the receiver. Select Off for passive antennas.

**FTA only:** Select Yes to store only Free-To-Air channels, select No to store scrambled and free to air channels. Note: Scrambled channels you cannot watch with this receiver.

Once all settings are made, move the highlight to *OK* and press **OK** to start scanning.

The receiver will now search for all available channels. Once scanning is finished, the receiver switches to viewing mode.

**NOTE:** Selecting the wrong country may result in a disorderly channel list, and missing of channels.

**NOTE:** In case the *Welcome* menu does not appear after switching on the receiver the first time, reset the receiver to factory settings by pressing the **MENU** button and selecting *Factory Setting* in submenu *Tools*. (Default PIN 1234)

## 5.0 QUICK GUIDE TO USING YOUR RECEIVER

We at STRONG understand that you can't wait to enjoy your new high definition digital terrestrial receiver. The following quick guide will make you familiar with the basic operation of this device. We do, however, advise you to read the full manual to get the best performance from your receiver.

To turn your receiver ON or to Standby, use the **⏻** button on the remote control.

Choose the desired channel with the **▲▼** buttons. Alternatively, you can digit the channel number with the **0~9** buttons on the remote control. Or press **OK** in viewing mode to display the channel list. The volume can be adjusted with the **◀▶** buttons.

Default Password is 1234.

## 6.0 OPERATION

Your new receiver is equipped with several features to make watching TV a true pleasure. This paragraph describes these features. Please also read chapter 7.0 to get familiar with the menu of your receiver.

### 6.1 CHANGING CHANNELS

Your new receiver is equipped with four ways to change channels.

- Via direct access using the **0~9** buttons.
- Via the channel list through **OK** button.
- Via the **▲▼** keys.

#### 6.1.1 DIRECT ACCESS VIA 0~9 BUTTONS

To gain direct access to a certain channel, simply input its number with the **0~9** keys on the remote control. Channel numbers can be up to four digits long. Entering a number with less than four digits is possible. Just wait a few seconds and your receiver will switch to the selected channel or press **OK** immediately after selecting the channel number.

#### 6.1.2 CHANNEL LIST

Press **OK** in viewing mode to display the Channel List. Use **▲▼** in the Channel List to highlight your channel of choice and press **OK** once to select the highlighted channel.

**TIP:** Use **TV/R** button to toggle between the *TV List* and *Radio List*, press **FAV** for a list of available favourite lists, toggle between them, with **◀▶**.

#### 6.1.3 USING THE ▲▼

▲ switches to the next channel.

▼ switches to the previous channel.

### 6.2 INFO BANNER

While watching TV you can press the **INFO** button any time to get information about the current channel and event\*. Press **INFO** again for programme information and again for some technical details about the current channel.

\*Event information is displayed when available. Availability depends on broadcast.

### 6.3 AUDIO

Some channels support a choice of audio formats and/or languages. To select another audio stream, press **AUDIO** in viewing mode. A list with available audio streams will now be displayed. Use **▲▼** to select the desired stream and confirm with **OK**.

### 6.4 TELETEXT

Your receiver includes a fully featured Teletext. Some channels provide Teletext (Ceefax). To access Teletext, press the **TEXT** button in viewing mode and use the **0~9** buttons to input the number of the page you wish to see. The coloured buttons of the remote control allow you to jump to selected pages immediately, as indicated on the bottom of the teletext screen. Use the **▲▼** buttons to select one page up or down, use **◀▶** buttons to select subpages, if indicated at the bottom of the screen. Selecting Auto makes the pages rotate automatically. Press **EXIT** or **TEXT** to get back to viewing mode. Hint: Pressing **OK** repeatedly, makes the Teletext background translucent.

## 6.5 SUBTITLES

Some channels support a choice of subtitle languages. Press **SUB** in viewing mode to display a list of available subtitle languages. Select your subtitle of choice with **▲▼** and press **OK** to confirm. Press **EXIT** to leave without making changes.

## 6.6 TIMESHIFT

Timeshift allows you to pause live broadcasts and resume playback later. Press **II** in viewing mode to activate this mode. On screen will appear a message *Entering Timeshift* and picture will pause. Press **▶** to resume time-shifted playback. A time banner will show, to indicate the time offset from live TV. Press **EXIT** to remove the banner. Press **II** to make frame steps. Use **◀▶** for Fast rewind/Fast forwards. Press **■** to return to live TV.

**NOTE:** Timeshift needs a connected USB storage device with sufficient free space and sufficient speed in order to work properly.

## 6.7 EPG (ELECTRONIC PROGRAMME GUIDE)

The Electronic Programme Guide is a very useful function that allows you to view event schedules and information and to mark programmes for recording. To access the EPG, press the **EPG** button in viewing mode. Use **▲▼** to select the desired channel and **◀▶** to select the desired event. Use **EXIT** to quit the detailed information screen. Press **GREEN** Timer to book a desired event automatically. It is possible to change the options manually. Make sure to have an HDD device connected, and select *Record* at the *Timer Service* option. Select **SAVE** and confirm with **OK**. Recordings will be stored in the Multimedia>PVR folder on your HDD drive.

Use **OK** to view detailed information about a programme. Use the **RED** Time button to change the hour or day of interest.

**NOTE:** When a USB device already is connected, the *Timer Service* will automatically be set to *Record*.

**NOTE:** A set Timers list and Edit options are available when in viewing mode, the **BLUE** is pressed.

**NOTE:** Availability of EPG data depends on broadcast.

## 6.8 INSTANT RECORDING

Your new receiver allows you to make an instant recording of the programme you are watching. Simply press **●** to start the recording.

During the recording a recording sign will be shown on the upper right side of your TV screen. To stop the recording, press **STOP**. Select **Yes** and press **OK** again to stop the recording.

\*Please connect a USB storage device with sufficient free space before you start a recording.

Recordings will be stored in the Multimedia>PVR> folder on your HDD drive.

## 6.9 SLEEP

Press **SLEEP** repeatedly to select an automatic switch off time, at which the unit will go to standby.

Default is **Off**.

## 7.0 MAIN MENU

The main menu gives you access to settings and multimedia functions. To access the main menu, press **MENU** in viewing mode. The main menu consists of the following sub menus: *Media Player*, *Edit Channel*, *Installation*, *System Setup* and *Tools*. Throughout the main menu, **MENU** or **EXIT** can be used to get back to the previous screen. Use **▲▼◀▶** and **OK** to select or to change settings. Use the button suggestions at the bottom of the screen available for certain functions. For some menu items a valid Password it is necessary to access the item. Default Password is 1234.

## 7.1 MEDIA PLAYER

**NOTE:** This unit can be powered directly from a USB port on a TV. Not all TVs supply enough current to provide stable operation. Also, some TVs switch off their USB power in Standby mode, meaning, Recordings and Timers set will not be executed. Some USB HDD may not start-up when Voltage and Current are too low. In these cases, it is recommended to use an external USB power supply (not included) from a well known brand, with specifications 5Volt and at least a current of 1 Ampere supplied.

## 7.1.1 PVR AND TIMESHIFT \*

\*This user manual describes the full functionality including the recording function and may not be applicable for Germany and Italia.

### PVR, Instant recording\*

To directly record a programme, press the **●** button to start the recording, a **REC** icon will show in the top-right corner of the screen. Press **STOP** and confirm to quit. During a recording it is possible to press the **▲▼** buttons or the **OK** and **▲▼** buttons to change to another channel on the same transponder only. It is not possible to use the **0~9** buttons. When you press **OK**, you can see a list with the channels in one transponder, which can be watched, while recording. The channel being recorded is identified by a **REC** icon in its program banner. Only one program at a time can be recorded.

### Timeshift\*

If you want to use the Timeshift function you only need to press **||** in viewing mode. To playback time shifted content, press **▶**. During playback you can use the **◀▶** or **||** buttons. To quit the Timeshift mode, press **STOP**.

Press **MENU** and select *Media Player*. The menu provides the options for playback of Recordings in *PVR*, *Video Music* and *Image*. The unit supports USB devices with FAT and FAT32 format. Make sure your USB device is formatted correctly.

**NOTE:** STRONG cannot guarantee compatibility (operation and/or bus power) with all USB mass storage devices and assumes no responsibility for any loss of data that may occur when connected to this unit. With large amounts of data, it may take longer for the system to read the contents of a USB device. Some USB devices may not be properly recognized. Even when they are in a supported format, some files may not play or display depending on the content.

If there is no USB device plugged in, the options in the menu will be greyed-out. Only when a USB device is detected you can select between Recordings in *PVR*, *Video Music* and *Image*.

Select one of them, press **OK** to enter the file browser and select the file you want to play.

*PVR\** Shows a list of your recordings made by this unit.  
*Video* Supported video files in various formats and containers.  
*Music* Supported file formats are MP3 and Flac\*\*  
*Picture* Supported file formats are JPG and BMP\*\*

**NOTE:** When in the *Media Player*, you can toggle between the four options with the **1 Switch** button.

\*\*STRONG cannot guarantee the playback of video files although extensions are listed here, as the correct playback depends on codec used, data bit rate and resolution as well. Please consult the STRONG Hotline in your country to get more details.

## 7.1.2 PLAYBACK OF OWN RECORDINGS

After a recording has been made you will find it in the PVR section of the *Media player* in a list created on your external USB storage device.

Select with **▲▼** the recording you want to playback.

Inside the PVR section the following functions are supported:

**OK** Starts playback in full screen.  
**■** Stop playback, and return to the recordings list.  
**||** Pause the current playback. Press repeatedly to go in to step-by-step motion.  
**▶** Start playback in the preview window, then **OK** to go full screen. Resume play from pause.  
**MENU or EXIT** Leave the PVR section.  
**YELLOW** Marks a recording for deletion. When all recordings you want to delete are marked, press **EXIT**.  
**GREEN** A recording can be locked from viewing by the password. Enter the password to set the *lock*. To unlock, repeat the procedure with the **GREEN** button. A locked recording is signalled with a *Lock* icon. This the password set in the *Parental Lock* menu.  
**RED** Opens the keyboard for entering a new name for a selected recording. In the keyboard, press **▲▼ ◀▶** for navigation, to enter a character press **OK**. After finishing your changes, select **OK** and press the **OK** button to save the new name. If you want to discard your changes select *Cancel* and then press **OK**.

### Video

Your receiver allows you to watch videos in the chosen folder. Choose a folder with video files for playing them. Not all video files can be played.

During playback you can use the playback control buttons, such as **||**, **◀▶**+**OK** (while progress banner on screen), **■**, **◀◀**, **▶▶**, **⏮** and **⏭**. To close the banner, press **INFO** again or **EXIT**. Use the **YELLOW** button and select a chapter with **▲▼** you

want to jump to, then press **OK** to confirm. With the **◀▶** buttons you can rewind or forward playback in x2, x4, x8, x16 and x24 speed. With the **◀◀ ▶▶** buttons you can jump to the previous/next video file.

This subtitle function with the **SUB** button only works for movies which have embedded subtitles

During playback, press (repeatedly) **SUB** to select a sub track.

Press **EXIT** to remove the pop-up.

For external subtitle files in .srt format, select those with the **GREEN** button.

Other options presented in the media player window may be used as indicated.

## Music

Select a music file (or file in a folder) and press **OK** to start playback.

During playback, following functions are available:

- ◀▶** Change the Audio volume
- OK** Start playback of the selected file
- ||** To pause/resume playback
- ▶** To start or resume playback
- To stop playback
- ◀◀ ▶▶** To rewind or forward playback. Press and hold the button. Release the button when you have reached the wanted position
- ◀◀ ▶▶** Start playback of the previous/next file. Press repeatedly to step
- EXIT** Press **EXIT** once if you want to leave the current folder. To get back to the *Multi media* menu, press **EXIT** repeatedly
- MENU** To go back to the main menu

Other options presented in the media player window may be used as indicated.

## Image

Your receiver allows you to watch a slide show with all available photos in the chosen folder. Choose a folder with photo files for the slide show. It possible to start music playback in the *Music* section first and then select images for a slide show, while the music keeps on playing.

In the *Image* mode following functions are available:

- ||** To pause/resume slide show.
- ◀▶** During the slideshow, the orientation of the image can be rotated. ◀To turn the photo counter clockwise. ▶To turn the photo clockwise.
- ▶** To continue slideshow after **||** or rotation of image.
- EXIT** To stop the slide show and return to the folder view.
- EXIT** To get back to the *Multimedia* menu. Press **EXIT** again if you want to leave the *Multimedia* menu.
- MENU** To go back to the *Multimedia* menu, to select another media type.

Use the coloured buttons to build a playlist with preferred images to show and to edit image list.

Other options presented in the media player window may be used as indicated.

## 7.2 EDIT CHANNEL

The procedures are equal for the *TV Channel List* and *Radio Channel List*.

**NOTE:** For successful editing of channel list, switch Off LCN function. See **ch.7.3**

### Moving channels

Use **▲▼** to select a channel and press **YELLOW** to select it to be moved. Enter the position number you like to move the channel to and press **OK** again. The channel is now fixed on its new position. When all changes have been made, press **EXIT**. A saving banner will pop up.

### Skipping channels

Channels marked with *Skip* will be skipped when zapping channels with the **▲▼** buttons. The channels will still be available from the channel list.

Use **▲▼** to select a channel and press **GREEN** to mark or unmark it for skipping. Channels set for skipping will be marked with the **SKIP** symbol. When all changes have been made, press **EXIT**. A Saving banner will pop up.

### Locking channels

Locked channels can only be watched after entering the password. (**DEFAULT password: 1234**)



Press **▲▼** to select a channel and press **RED** to lock or unlock it. You are asked to enter the password. Locked channels will be marked with the **LOCK** symbol. Locking/unlocking multiple channels in one session is possible. When all changes have been made, press **EXIT**. A Saving banner will pop up.

The **BLUE Edit** button adds more options to the menu in a second window.

Options are: *Sort, Edit* and *Delete*.

## Sort

Press the **RED** button, a pop-up window will show with several options. These are quick-sort options, choose as required. They overrule other sorting methods done on the first edit page.

## Edit

Use **▲▼** to select a channel you wish to rename. A pop-up keyboard will show on screen. Use **◀▶ ▲▼** to select characters/functions and enter them with **OK**. When you have finished editing, select **OK** to enter the changes. When all changes have been made, press **EXIT**.

## Delete

Use **▲▼** to highlight a channel and press **BLUE** to mark it for deletion. When you have marked the channel you wish to delete, a confirmation banner will be displayed. Select **OK** to delete the marked channel or **EXIT** to cancel. Press **EXIT** after finishing.

**NOTE:** Deleted channels can only be retrieved if you do a frequency scan in the *Channel Search* menu again.

## Adding channels to favourite lists

Channels from the channel list can be added to up to 8 different favourite groups. Press **FAV** in *Programme Edit* to access the function. Use **▲▼** to select a channel you wish to add to a favourite group. When the highlight is on the channel of your choice, press **OK**. A Favourite Type can be selected from the pop-up list. Use **▲▼** to select the favourite list you wish to add the channel to and press **OK**, press **EXIT** to finalize the process. Favourite channels will be marked with a heart symbol. When all changes have been made, press **EXIT**. A Saving banner will pop up. To de-select a channel from a Favourite list, repeat the above procedure, and press **OK** on the channel in the pop-up list to de-select.

## Delete All channels

To delete all stored channels and favourite lists, select the *Delete All* function.

**NOTE:** To obtain channels again, you must search for channels again from the *Installation* menu.

## 7.3 INSTALLATION MENU

### 7.3.1 CHANNEL SEARCH

<i>DVBT Channel Scan</i>	Select a particular channel to do a search on just one (known) frequency. Press <b>OK</b> to start the scan. The signal quality bar might be useful to check if the frequency is indeed in use.
<i>Scan Mode</i>	Options are: <i>By Channel</i> and <i>By Frequency</i> . Select the first if you know a certain channel number, the latter if you only know the transmitter frequency.
<i>Channel No.</i>	When at <b>Scan Mode</b> <i>By Channel</i> is chosen, select here the channel number. Select <i>Search</i> and press <b>OK</b> to start searching on the selected channel.

**NOTE:** Use the Signal and Quality bars to check if there is any reception on the selected channel, or to optimize your antenna alignment.

When at **Scan Mode** *By Frequency* is chosen, select at *Frequency* the frequency of the channel you wish to search for. *Bandwidth* is default set at 8 MHz (European standard), but can be changed if needed. Select *Search* and press **OK** to start searching on the selected channel.

**NOTE:** Use the Signal and Quality bars to check if there is any reception on the selected channel, or to optimize your antenna alignment.

## 7.3.2 DVBT AUTO SCAN

This menu allows you to search for channels from all available frequencies for your selected region automatically. Be aware that all previous installed channels and favourite list(s) will be deleted. The new-found channels will be installed in the channel list and afterwards you can create a new favourite list if you like. Select **Search** and press **OK** to start the scan.

*FTA Only* Free-to-Air channels are stored only when **Yes** is selected. Select **No** if you want to store scrambled channels as well.

Select **Search** and press **OK** to start searching on the selected channel.

**NOTE:** Scrambled channels can not be watched with this receiver.

## 7.3.3 LCN (LOGICAL CHANNEL NUMBERING)

If *LCN* (Logical Channel Numbering) is activated and an *LCN* signal is provided by the broadcaster, channels will be stored in a broadcaster defined order. Set *LCN* to **On** to activate broadcaster defined channel numbering or **Off** to store channels in found order. This function only applies when a new channel search is performed.

**NOTE:** For successful editing of channel list switch Off *LCN* function.

## 7.3.4 ANTENNA POWER

Set to **On** if you use an active antenna. When set to **On**, 5 V will be present at the Antenna input connector of the receiver. Select **Off** for passive antennas.

**NOTE:** When in doubt, check the User Manual of your Antenna.

*Country* Select the correct country where this receiver is used. If failing to do so, may result in that channels appear randomly in the channel list, instead of a more logical order.

## 7.4 SYSTEM SETUP

Press **MENU** and select *System Setup*. The menu provides options to adjust the system settings.

Press **▲▼** to select an option and press **►** or **OK** to adjust the setting. Press **EXIT** several times to exit the menu. Some menu items can only be entered by entering the password. Default is **1234**.

### 7.4.1 LANGUAGE

In this menu you can adjust the *Language*, *First Audio*, *Second Audio* and *Teletext* preferences.

Select an option and press **◀▶** to adjust the setting. Press **EXIT** to exit the menu.

*Language* Select the preferred language for the On Screen Display.

*First Audio* Select the first preferred audio language for watching TV channels. If the language is not available, the *Second Audio* language will be used.

*Second Audio* Select the second preferred audio language for watching TV channels. If the preferred *Second Audio* language is also not available, another available language will be used.

*Teletext* Select the preferred Teletext letter character set.

### 7.4.2 TV SYSTEM

Press **MENU**, then select *TV System*. The menu provides options to adjust the video settings. Press **▲▼** to select an option and **◀▶** to adjust the setting. Press **EXIT** to exit the menu.

#### Video Resolution

If the video does not appear correctly, change the setting. These settings match the most common settings for HDMI. By Source. Automatically negotiate with TV for optimal setting.

480i for NTSC system TV.

480p for NTSC system TV.

576i for PAL system TV.

576p for PAL system TV.

720p\_50 or 60 for PAL or NTSC system TV.

1080i\_25 or 30 for PAL or NTSC system TV.

1080p\_50 or 60 for PAL or NTSC system TV.

**NOTE:** Some brands of TV's do not support 576p.

## 7.4.3 ASPECT MODE

You can set the display format to available settings *Auto*, *16:9FS* (Fullscreen), *16:9LB* (Letterbox), *4:3PS*, (Pan&Scan) and *4:3LB* (Letterbox).

<i>16:9FS</i>	For 16:9 TV screens. All programmes will fill the full screen. Content formatted in 4:3 will be stretched.
<i>4:3LB</i> (Letterbox)	For 4:3 TV screens. The unit will display all content in its original aspect ratio. Programmes formatted in 16:9 will be presented with black bars on the top and bottom.
<i>4:3PS</i> (Pan&Scan)	For 4:3 TV screens. 16:9 content will have the extreme left and right portions cut off and presented full screen.
<i>16:9PB</i>	Combination of Pan&Scan and Letterbox
<i>Digital Audio Out</i>	Select digital audio output mode.
<i>LPCM</i>	(Pulse Code Modulation) Audio from any format will be converted to PCM Stereo format.
<i>BS Out</i>	(Bitstream) Audio from receiver will be send out in the original format. For use with advanced Home theatre equipment.
<i>HDR</i>	Some High Definition (HD) may be transmitted in HDR format, displayed on a non HDR TV colours might be distorted. Select <i>Auto</i> or <i>SDR</i> , depending on your TV.

## 7.4.4 DISPLAY SETTING

*Brightness*, *Contrast*, *Saturation* (Colour), *Hue* (Colour tone) and *Sharpness* can be adjusted. It would be the same as changing same settings on the TV. Better left on its default settings (50).

## 7.4.5 LOCAL TIME SETTING

Press **MENU** and select *Local Time Setting* The menu provides options to adjust the time and date settings.

Press **▲▼** to select an option and **◀▶** to adjust the setting. Press **EXIT** to exit the menu.

<i>Region</i>	Select the region or country in which you live. This will set the time offset from GMT (UTC) automatically.
<i>GMT Usage</i>	Select <i>By Region</i> (the Region selection is active), <i>User Define</i> (You may select your GMT Offset yourself) or <i>Off</i> (Time and Date setting are free to adapt.) However, the default <i>By Region</i> setting and the correct <i>Region</i> setting are usually sufficient. In case the Daylight Saving Time should not be delivered by the broadcaster, you can adapt it here.
<i>GMT Offset</i>	Select the correct Time Zone in which you live.
<i>Summer Time</i>	You may adapt <i>On</i> or <i>Off</i> for Daylight Saving Time, should it not be delivered by the broadcaster.
<i>Date</i>	Enter the date when <i>UTC Usage</i> is set to <i>Off</i> .
<i>Time</i>	Enter the time when <i>UTC Usage</i> is set to <i>Off</i> .

## 7.4.6 TIMER SETTING

In this menu you can setup the schedule for automatic switching to the defined channels at a particular date/time. Timers can be set directly from the EPG window or manually from this screen. Not set timers will be default *Off*. This menu can also be reached by a shortcut with the remote control, the **BLUE** button.

To enter a new timer manually, select an *Off* marked timer in the list and press **OK**.

<i>Timer Mode</i>	A free timer is default <i>Off</i> . Select <i>Once</i> for a onetime event, select <i>Daily</i> for each day, same time event, or <i>Weekly</i> for a weekly, same time recurring event.
<i>Timer Service</i>	Select <i>Channel</i> to wake up the receiver to view the channel or <i>Record</i> for recording the channel. When a USB device is already detected, default will be <i>Record</i> .
<i>Wakeup Channel</i>	Select the channel for this event. Use <b>◀▶</b> or <b>OK</b> for a pull down list to select.
<i>Wakeup Date</i>	Select the date for the event.
<i>On Time</i>	Enter the time to start the event.
<i>Duration</i>	Enter the length of the event. Default is 2 hours.

After all settings have been made, select *Save* to store the settings. Select *Cancel* to discard the settings.

To edit an already existing timer entry, select the entry in the list and press **OK**, then select and edit the item which you wish to change.

To delete an already existing timer entry, select the entry in the list and press **OK**, then select and set *Timer Mode* to *Off* and select *Save* to store. Exit the screens with **EXIT**.

## 7.4.7 PARENTAL LOCK

Set the age limit for a viewer, if the viewer is underage. This only functions if a broadcaster sends an age-signalling for the current programme. You can only enter the Parental Lock menu by entering your password. The default password **1234**.

*Menu Lock* Select either *On* or *Off*. When *On* many menu items can only be accessed after entering the password.

*Rating Lock* Select the age, for which above that age there is no restriction for watching.

*New Password* To change the default password from **1234** to another password like you wish, select this option. Enter the new password.

*Confirm Password* Re-enter your new password to confirm. Make a note off the new password.

## 7.4.8 OSD SETTING

OSD means On Screen Display, all the graphics you will see on screen.

*OSD Timeout* Set the time (in seconds) the program banner will be shown on screen, when switching channels.

*OSD Transparency* Set the amount of transparency the OSD (banners and menu) will have, superimposed on the running program. 40% is the most transparent option.

## 7.4.9 FAVOURITE

Here you can rename the default names of the Favourite lists. For example: Movies or Music. Or even the names of users of the unit with their own dedicated channels. Select the list name you want to edit and press **OK**. Use the pop-up keyboard to change the name and select **BLUE** (OK) to confirm.

## 7.4.10 AUDIO DESCRIPTION SETTING

AD. For the visually impaired, a narrator can describe the actions happening on screen with a dedicated additional audio track, mixed with the original audio track. This service is provided by some broadcasters and is therefore subject to availability.

*AD Service* Select *On* if you wish to use the service by default on all channels which may carry an AD track.

*AD Volume Offset* Set the balance of volume the AD audio track will have, mixed with the original audio track.

## 7.4.11 PVR STORAGE INFORMATION

This item can only be accessed when a suitable USB device is connected.

Find technical details about your USB device, like *Total Size*, *Free Size*, *Record Size*, *TMS (Time Shift Size)* and *File System*.

Use **YELLOW** (Format) button to format your device in FAT (FAT32).

**YELLOW** Format\* A (new) USB device must have been formatted before the first use. The correct format for the receiver is FAT(32)

**WARNING:** The format function will delete all data and information from your USB device or selected partition. STRONG will not take any responsibility for damaged or lost data on the USB device.

An attention banner will now be displayed. Select **OK** to start formatting (or **EXIT** to cancel it). The format procedure will take some time, depending on the size of the used storage device. At the end of the process, the "Wait" pop-up will disappear. Press **EXIT** to exit the menu.

## 7.4.12 PVR SETTING

This item can only be accessed when a suitable USB device is connected.

Select the options for Timeshift and recording.

*Timeshift* Timeshift can be disabled here also if needed.

*Timeshift to Record* If Timeshift was activated, but you decide not to continue watching at this moment, then press **●** to instant record the rest of the program. If this option is set to *On*, the already time shifted part of the program will be added upfront of the recording, to view later in one go.

## 7.4.13 AUDIO STANDBY

This feature is implemented for power saving. The receiver will turn to Standby automatically if no command from the remote is received for the selected time period. Default is 3 hours. It can also be turned *Off*.

**NOTE:** If there are timers running, the auto standby function will be disabled for the booked time.

## 7.5 TOOLS MENU

### 7.5.1 INFORMATION PAGE

Some technical information about the receiver is found here, like HW model and SW version. In case of service request, it is useful to have this info at hand.

### 7.5.2 FACTORY SETTING

Reset your receiver to the default factory settings.

Enter your password or the default password **1234**, select *Yes* and press **OK** to confirm.

The receiver will reboot and start with the *Welcome* page.

**WARNING:** A factory reset will permanently delete all your personal settings, timers and stored channels. Please consider this before you perform a factory reset.

### 7.5.3 UPGRADE BY USB

Download the required update file for your receiver model from the support page on our website [www.strong-eu.com](http://www.strong-eu.com) or contact your local dealer.

Unzip the file on your computer, if necessary, and copy it to root folder of your USB storage device. The USB device must have been formatted in FAT32.

Connect the USB storage device to the USB port of the receiver. Press **MENU** and select *Tools*, then *Upgrade By USB* to update the software select at *Upgrade Mode* the option *Allcode*. At *Upgrade File* select the correct upgrade file, the file has the extension *abs*.

Then select *Start*, and press **OK** to initiate the upgrade process. An attention banner will now be displayed. Press **OK** to confirm *Yes* the update (or *No* to cancel it). The update process will take some time. After the update process has been completed the receiver will restart and then show the first channel in the TV list. You can now safely remove the USB device, and then remove update software from the device (at the PC), to prevent accidental updating again.

**WARNING:** NEVER power off the receiver or remove the USB device during the software update process. Doing so might cause irreparable damage to your receiver and will void your warranty.

**NOTE:** In certain instances it can be advised on the website to upgrade the unit with the *Maincode* option in stead of *Allcode*.

The *HDCPkey* and *Bootback* are for Strong internal use only.

### 7.5.4 STORE CHANNEL LIST TO USB

This item allows you to save the channel Data Base of your receiver to a USB-device. This very convenient feature enables you to save your personal settings like Channel-, Favourite- lists on an USB storage device and load them back to the receiver later.

#### Write to USB Dump Channel list

In the *Upgrade by USB* menu, select *Upgrade Mode*, then *Dump channel list* and *Start* and press **OK** to make a backup of the data base, including channels and user set data. An *.udf* file with the current time, date (day month, year), will be created on the USB device. When the database has been successfully stored, press **EXIT** to leave the menu.

#### Load from USB Update channel List

In the *Upgrade by USB* menu, select *Upgrade Mode*, then *Update channel list*. Select the correct file at *Upgrade File* you want to restore to.

Use ◀▶ for displaying the available database files (if any stored before). The *.udf* files are shown with their built time, date (year, month, day) Select the file you want to load and then select *Start* to load the file. When the database has been successfully loaded the receiver will reboot and switch automatically to the first stored channel.

#### Remove USB safely

Use this option to safely remove your USB device from the unit. It will prevent loss of data and prevent hardware damage to such a device. This procedure is comparable working with a personal computer.

## 8.0 TROUBLESHOOTING

There may be various reasons for abnormal operation of the receiver. Check the receiver according to the procedures shown below. If the receiver does not work properly after checking it, please contact your dealer or the local Service Hotline or send email to our Support via [www.strong-eu.com](http://www.strong-eu.com) Do NOT try to open or disassemble the receiver. It may cause a dangerous situation and warranty will be void.

Problem	Possible cause	What to do
The LED/standby indicator and LED display (if available on your receiver) are not switching on.	The power cable or power adapter is unplugged.	Check that the power cable or power adapter is plugged to the wall outlet.
	If your receiver has a main power switch: The main power switch on the rear panel is set to OFF.	Switch the main power on.
	The external IR sensor is not working.	Check if the external IR sensor is (properly) connected.
	The electrical outlet may be damaged.	Check with another device if the electrical outlet is supplied.
No signal.	The receiver is not connected to the signal source (DVB-C) or to the antenna (terrestrial or satellite antenna).	Check the lead of the antenna or cable. Check that the coaxial cable is correctly fitted to the antenna input on the receiver.
	Damaged or defective connectors (IEC-connectors (DVB-T2)).	Check connectors for visible damage.
	The antenna (terrestrial or satellite) is damaged.	Check the antenna for visible damage.
	Out of digital signal area.	Check with your dealer or contact your local Service.
	An active antenna requires that the antenna power/external power is switched ON.	Switch the antenna power of the receiver ON/connect an external power source.
	Wrong direction of the antenna.	Check the signal strength and quality and adjust your antenna correctly, or contact your local Service.
	Multiswitch is defective or power cable or power adapter of Multiswitch is unplugged.	Check that the power cable or power adapter of Multiswitch is plugged to the wall outlet. Contact your local Service.
The picture and sound remain frozen, or macro blocks or similar distortion are visible on the screen.	The transmission signals are too weak or have reflections/interference.	Press the INFO key on the remote control 2 or 3x to call up signal bars to visually assess signal strength and signal quality (both parameters should be visible in the last third of the infobars). Contact your local Service.
	The antenna is not properly adjusted.	
No access to scrambled services.	The channel is scrambled. Your receiver doesn't support receiving scrambled channels.	Select an alternative channel.
The receiver switches off or to standby automatically.	The Auto Standby function is enabled and has reached the set time.	Disable Auto Standby. Refer to the user manual of your receiver for details.

Problem	Possible cause	What to do
No sound on TV or amplifier.	The volume of the TV is set too low. The volume of the receiver is set too low.	Increase the volume of the TV with its remote control. Increase the volume of the receiver with its remote control.
	The correct input is not selected on your TV or amplifier, or the unit is set to a higher resolution than supported by the TV.	Switch to the correct TV/amplifier input. Select lower resolution on the receiver.
	The TV, digital receiver or amplifier is not switched on.	Switch the TV/digital receiver/amplifier on.
	The TV or digital receiver is not connected to the mains.	Check the mains lead.
	Bad cable connection.	Make sure that any existing digital or analogue A/V cable connections between the used equipment (TV, digital receiver or A/V amplifier) are properly connected.
	Audio is muted.	Press the ! button on your remote control.
	The TV power is off.	Turn the TV on.
	The receiver is off.	Plug in and turn on the receiver.
No response to the remote control.	The remote control is not aimed correctly.	Aim the remote control at the IR sensor on the front panel of the receiver.
	The IR sensor on the front panel of the receiver is obstructed.	Avoid or remove obstructions.
	The batteries of the remote control are not inserted, wrongly inserted or exhausted.	Check whether the batteries are inserted correctly or exhausted. If exhausted, replace the batteries in the remote control.
After moving the DVB-T2 receiver to another room/area you are no longer able to receive digital reception.	The antenna signals are too weak.	Press INFO 2 or 3x on the remote control to keep the signal bars on screen and adjust the Indoor antenna for maximum reception. Alternatively, do a rescan of the channels.
	The signal strength/quality might be less than before, if using an indoor antenna.	When using an active antenna, check if the antenna power setting is On.
		Try using an outdoor antenna.
Forgotten PIN code/ password.		The default PIN is 0000 or 1234 (refer to the user manual of your Device).
		Contact your local Service Hotline or send an email to our Support via <a href="http://www.strong-eu.com">www.strong-eu.com</a>
Forgotten channel lock code.		Contact your local Service Hotline or send an email to our Support via <a href="http://www.strong-eu.com">www.strong-eu.com</a>
Recording is no longer possible.	The selected storage medium is full.	Delete existing recording(s). Attach and use another storage medium.
Playback of video (or Timeshift) is causing picture freeze/macro blocks or similar distortion, especially on HD content.	The read/write speed of your USB device could be too low.	Make sure to use a USB storage device with sufficient speed and space. Pen drives ('USB sticks') may not support sufficient speed.
The USB storage device is not working properly.	The power consumption is too high.	Connect an extra power supply adapter to your USB HDD device.
	The USB device is formatted incorrectly.	Format the USB device on a PC to FAT 32.
The receiver automatically switches off after a certain time.	The Auto Standby function is enabled.	Check the Auto Standby setting and disable if necessary.

## 9.0 TECHNICAL SPECIFICATIONS

### Demodulator:

Demodulator: COFDM; 16 QAM/64 QAM; QPSK; 256QAM  
Transmission mode: 2 K - 8 K

### Video Decoder:

Profil Level: HEVC (H265) AVC/H.264HP@L4.1, MPEG-4 ASP supported  
Video Resolution: 480i, 480p, 576i, 576p, 720p, 1080i, 1080p  
Decoding: PAL/NTSC  
Aspect Ratio: 4:3 Letterbox, 4:3 Pan & Scan, 16:9, Auto

### Audio Decoder:

Audio support: Dolby Digital Plus/AC3/PCM MPEG MusiCam Layer II  
Sampling rate: 32, 44.1, 48 KHz  
Audio mode: Stereo, Mono

\* Dolby Digital Plus, Dolby Audio and the double-D symbol are registered trademarks of Dolby Laboratories.

### Tuner:

Front End: DVB-T2, UHF & VHF Tuner  
Input frequency range: 174 – 230 MHz (VHF) & 470 - 790 MHz (UHF)  
Input signal level: -20 ~ -82 dBm  
Antenna power: 5 V DC, max. 50 mA, short cut protected

### Memory and System:

Flash memory: 4 MB  
SDRAM: 64 MB

### Connectors:

ANT IN - SMA to IEC adapter (female)  
HDMI  
Micro USB port: 5 V/500 mA (max.) supported  
IR

### General Data:

Power consumption: 2.5 (max)  
Power consumption in standby: <0.5 W  
Operating temperature: 0 ~ +40° C  
Storage temperature: -25 ~ +60° C  
Operating humidity range: 10 ~ 85%, RH, Non-condensing  
Size (WxDxH) in mm: 102 x 28 x 12  
Weight: 0.0235 kg