

Installation Instructions

1. Preparing site

Ditch should be shaped to the designer's requirements similar to any other revetment product. Irregularities in elevations should not be greater than 2".

2. Deploying slope paving

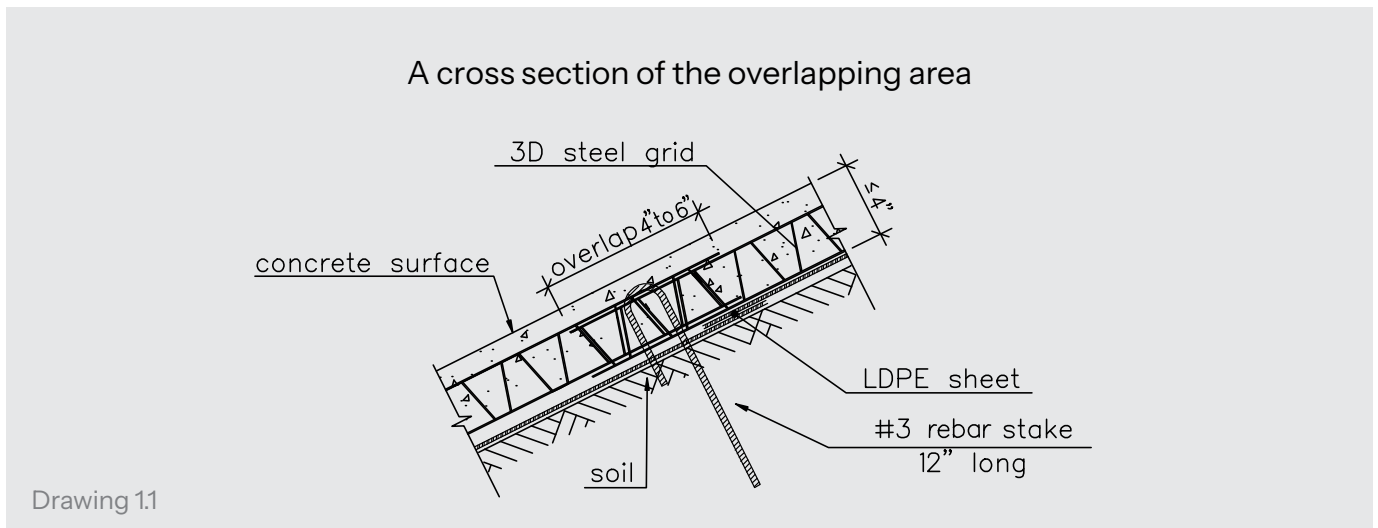

2.1

Unfold the plastic sheet that came with the material and lay it flat over the entire designated lining area. It is best to cut plastic prior to concrete placement.

Use a box cutter to trim any excess material (these pieces can be used for covering small or oddly shaped areas).

Attention – the plastic sheet will arrive pre-folded, likely in half or even quarters. To avoid wasting material, unfold it completely before deploying it over the designated lining area.

2.2

If necessary, secure the plastic sheet to the ground using the supplied anchors temporarily until the 3D grid is placed.

2.3

Overlap 4" to 6" of the consecutive sheets along the ditch according to the direction of flow (see drawing 1.1).

2.4

We suggest side forms for aesthetics, however tamping the edges with concrete pulls beneath string lines can provide adequate appearance.

3. Positioning the 3D Steel Grid

3.1

Lay the grid panels on top of the plastic protective layer (see drawing 1.2). Overlap each panel by one corrugation in the longitudinal direction and 4" to 6" in the transverse direction.

Attention – sharp edges, use work gloves for protection.

3.2

Secure the 3D Steel Grid to the ground through the protective layer, using the supplied anchors (the anchors that secure the plastic can be reused to secure the steel grid).

3.3

Using 5 pound hammers, position the anchors in the following pattern: one at each corner of the grid panel (securing 2 or 4 panels together) and one in the middle of each panel (see drawing 1.2).

3.4

On slopes greater than 3:1 - using additional anchors is advisable in order to secure the grid properly prior to pouring the concrete

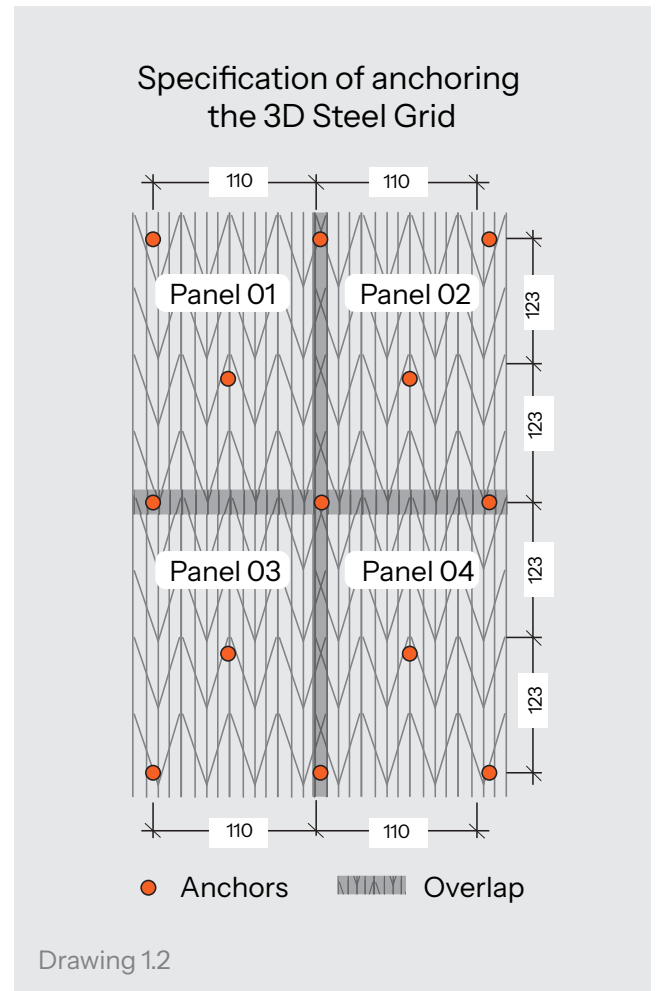

4. Pouring the ready mix concrete

4.1

3,000 psi 4" slump concrete is recommended.

4.2

Use concrete pulls for spreading the concrete. Completely cover the 3D Steel Grid with a layer of at least 1" thickness.

4.3

After covering 100-200 sq ft – form a rough finish on the entire surface by using a garden rake in slow and steady manner over the concrete surface.

4.4

Close attention should be paid to the rake finishing stage as this will determine the overall aesthetics of the project.