

Built to last

40 Years Leading FRP &
Polymer Concrete Expert



Your reliable infrastructure partner.



Contents

➤	About Us	1
➤	Our Service	2
➤	FRP Advantages	3
➤	Resin Concrete Advantages	4
➤	Solution	5-6
➤	Products - Fiber Grating	7-11
➤	Products - Pultruded Profiles	12-15
➤	Products - Drainage Channel	16-23
➤	SGS & Academic Certifications	24
➤	Case Study	25-29
➤	ESG	30



About Us

All Leader is a global leader in FRP composites and polymer concrete, committed to providing high-quality, durable solutions for diverse industries. With years of expertise and a dedicated team, we deliver products that stand the test of time.



Sid Wang

All Leader Founder

40+

Years In Business

100+

Custom Solutions

200+

Government Units



Our Service



Manufacture FRP products

All Leader excels in crafting top-quality FRP products known for their durability and resistance to extreme conditions, ensuring optimal performance in various applications.



Drainage system construction

We design and install efficient rainwater management systems, including robust drainage solutions, to enhance environmental sustainability and functionality.



Competitive product sourcing

Our expert sourcing services secure high-quality materials at competitive prices, tailored for government, construction, and solar energy projects, ensuring cost-effectiveness and reliability.

Why Choose FRP?



70% Lighter

FRP composites are up to 70% lighter than steel and concrete, reducing shipping costs and structural load, while allowing innovative designs without sacrificing strength.



Less Maintenance

FRP materials need little maintenance because of their corrosion resistance and durability, resulting in long-term cost savings and consistent performance in tough conditions.



Safer Alternative

FRP is a safer construction option due to its non-conductive properties and high strength-to-weight ratio, ensuring reliable performance in critical conditions.



Eco-Friendly

FRP materials are durable, recyclable, and promote sustainability, making them an eco-friendly choice for construction.

Why Choose Resin Concrete?



Corrosion & Chemical Resistance

Excellent resistance to acids, alkalis, and salts. Provides long service life in harsh environments like sewage plants and coastal areas.



High Strength & Lightweight

Higher compressive strength and lower weight than conventional concrete. Reduces structural loads and installation costs.



Precision Molding & Design

Precise molding creates smooth finishes and accurate dimensions. Ideal for gratings, covers, and aesthetic applications.



Environmental Benefits

Lower cement use reduces CO₂ emissions. High durability minimizes maintenance. Some products use recycled materials.

Solution



Drainage system

All Leader provides a range of drainage system products, including Ditch Cover and Body, Manhole, Railing, and Manhole Base, designed to handle pedestrian, vehicular, and industrial traffic. Our drainage systems are built using durable, corrosion-resistant materials, ensuring long-lasting performance and minimal maintenance.



Environmental & Landscaping

All Leader offers a comprehensive range of products for environmental and landscaping projects, including Sidewalks, Fences, Trails, Street Lamps, Observation Decks, Benches, Pavilions, Gardens, and Street Tree Grilles. These products are designed to enhance the aesthetic and functional aspects of public and private spaces, contributing to the creation of sustainable, eco-friendly environments.



Industrial Solution

All Leader provides a wide range of industrial solutions, including Factory Platforms, Railings, Stairs, Feedlot Platforms, Roofs, Brackets, Ladders, Cable Trunking, and Trails. These products are designed to meet the demanding requirements of industrial environments, ensuring safety, durability, and efficiency in various applications.

Solution



Marine & Coastal

All Leader offers specialized Marine & Coastal products, including Ship & Yacht Work Platforms, Railings, and Protection Facilities. These products are specifically designed to withstand the harsh marine environment, providing long-lasting and reliable solutions for maritime operations.



Oil and Gas Facilities

All Leader offers specialized products for Oil and Gas Facilities, including Oil Tanks, Oil Pipes, and Railings. These products are designed to meet the stringent requirements of the oil and gas industry, ensuring safety, reliability, and long-term performance in demanding environments.



Building materials and interior design solutions

All Leader offers innovative Interior Design products, including Shelters and Salons, that combine aesthetic appeal with exceptional durability. These products are designed to enhance both the functionality and beauty of interior spaces, making them ideal for a wide range of design applications.

Fiber Grating

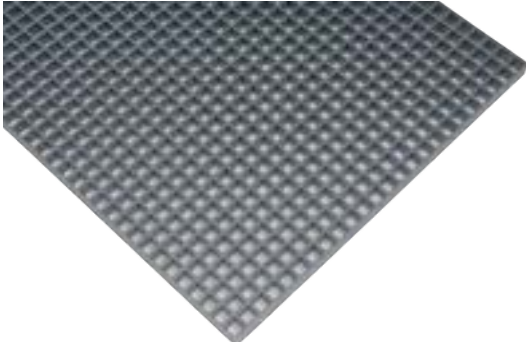

All Leader fiberglass grating utilizes advanced FRP composite technology, weighing 70% less than steel and concrete while delivering exceptional strength performance. Various grid specifications range from 13×13 to 38×38 square mesh, plus specialized rectangular grids to meet diverse engineering requirements. With 40 years of expertise, we provide reliable building material solutions to over 200 government agencies worldwide.

Square Grating 38 x 38

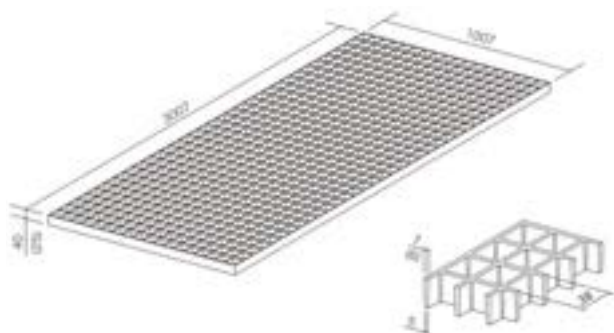

Thickness mm	Mesh Dimensions (mm)	Load Bar Top Width (mm)	Open Area Ratio	Approximate Weight (kg/m ²)	Standard Dimensions
13	38×38	5.7	72%	6.5	1220×3660 1524×3048
25	38×38	6.2	69%	8.5	1220×3660 1524×3048
30	38×38	6.5	67%	10.0	1220×3660 1524×3048
38	38×38	7.0	65%	12.5	1220×3660 1524×3048
50	38×38	8.0	62%	16.0	1220×3660 1524×3048



Ceiling



Industrial Working Platforms



Marine Platforms

Square Grating 25 x 25

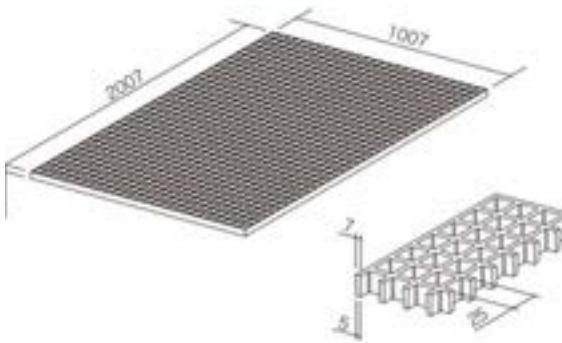

Thickness mm	Mesh Dimensions (mm)	Load Bar Top Width (mm)	Open Area Ratio	Approximate Weight (kg/m ²)	Standard Dimensions
13	25×25	3.8	68%	8.5	1220×3660 1524×3048
25	25×25	4.2	65%	12.0	1220×3660 1524×3048
30	25×25	4.5	63%	14.5	1220×3660 1524×3048
38	25×25	5.0	61%	17.5	1220×3660 1524×3048
50	25×25	6.0	58%	23.0	1220×3660 1524×3048



Drainage Grating



Accessible Surfaces

Square Grating 13 x 13

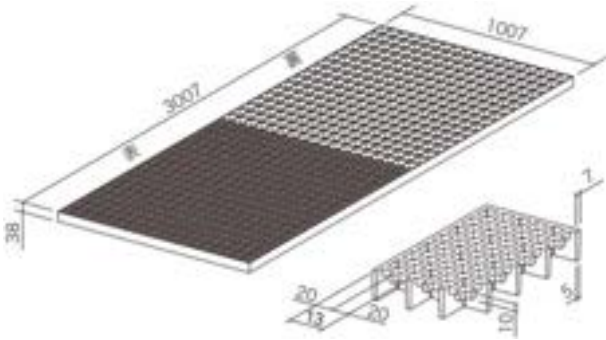

Thickness mm	Mesh Dimensions (mm)	Load Bar Top Width (mm)	Open Area Ratio	Approximate Weight (kg/m ²)	Standard Dimensions
13	13×13	2.0	63%	11.5	1220×3660 1524×3048
25	13×13	2.5	60%	16.5	1220×3660 1524×3048
30	13×13	2.8	58%	19.5	1220×3660 1524×3048
38	13×13	3.0	56%	23.0	1220×3660 1524×3048
50	13×13	3.5	53%	29.0	1220×3660 1524×3048



High heels can easily step over it too

Rectangular Grating 13 x 40

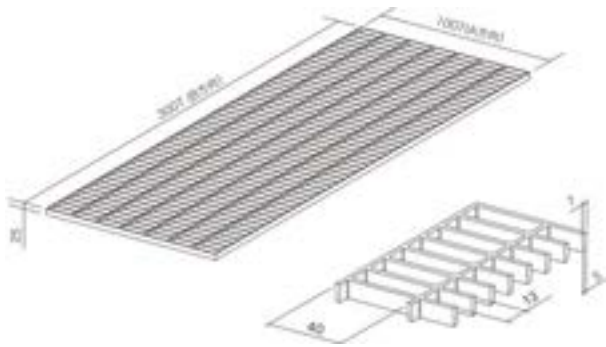

Thickness mm	Mesh Dimensions (mm)	Load Bar Top Width (mm)	Open Area Ratio	Approximate Weight (kg/m ²)	Standard Dimensions
13	13×40	7	72%	7.0	1220×3660 1524×3048
25	13×40	8	70%	9.5	1220×3660 1524×3048
30	13×40	9	68%	11.5	1220×3660 1524×3048
38	13×40	10	66%	14.0	1220×3660 1524×3048
50	13×40	11	64%	18.0	1220×3660 1524×3048



Roadway Drainage Covers



Roadway Drainage Covers

Pultruded Profiles

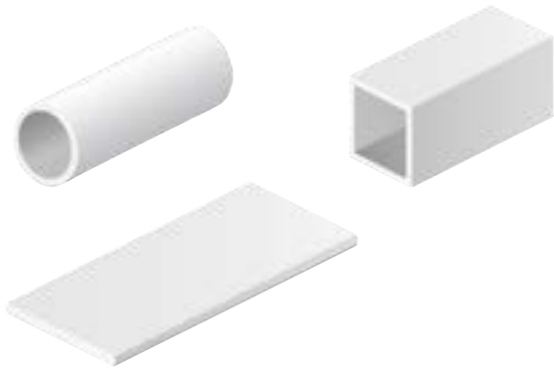

All Leader pultruded profiles demonstrate remarkable application versatility, from safety handrails and industrial ladders to solar mounting systems, from greenhouse structural frames to HVAC ventilation grilles, and even precision cable tray systems. Whether for outdoor observation decks, retaining wall projects, or indoor HVAC louvers, they provide stable and reliable structural support, making them ideal materials for cross-industry engineering.

Round Tube

Model	Dimensions D × T (mm)	Weight(kg/m)
RT25	25 × 3.2	0.44
RT26A	26 × 3.0	0.42
RT26B	26 × 4.8	0.63
RT32A	32 × 3.2	0.55
RT32B	32 × 5.0	0.81
RT38A	38 × 3.2	0.65
RT38B	38 × 4.0	0.81
RT41	41 × 4.5	0.98
RT42A	42 × 3.2	0.70
RT42B	42 × 5.0	1.11
RT48	48 × 6.4	1.58

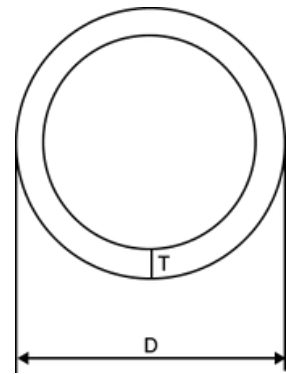

Ladder



Tool Handles



Fence

Square Tube

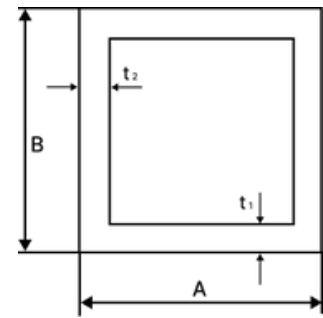

Model	Dimensions A × B × T1 × T2 (mm)	Weight(kg/m)
ST25A	25 × 25 × 3.2 × 3.2	0.53
ST25B	25 × 25 × 6.4 × 6.4	0.90
ST32A	32 × 32 × 3.2 × 3.2	0.70
ST32B	32 × 32 × 6.4 × 6.4	1.24
ST38A	38 × 38 × 3.2 × 3.2	0.85
ST38B	38 × 38 × 5.0 × 5.0	1.25
ST38C	38 × 38 × 6.4 × 6.4	1.54
ST44A	44 × 44 × 3.2 × 3.2	1.01
ST44B	44 × 44 × 6.4 × 6.4	1.83
ST50A	50 × 50 × 3.2 × 3.2	1.14
ST50B	50 × 50 × 3.5 × 3.5	1.24
ST50C	50 × 50 × 4.0 × 4.0	1.42



Solar Panel Mounting Systems



Observation Decks

Chamfered Flat Bar

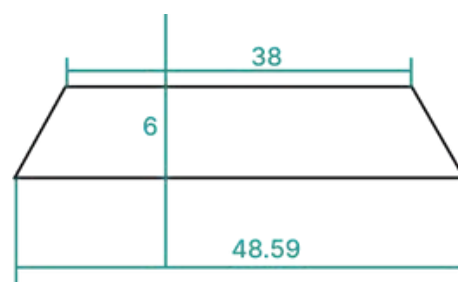

Model	Dimensions Thickness × Width (mm)	Weight(kg/m)
FS250A	250 × 12.0	5.70
FS280A	280 × 10.0	5.32
FS300A	300 × 24.0	14.40
FS355A	355 × 5.0	3.50
FS555A	555 × 5.0	5.40
FS751A	751 × 5.0	7.20
FS762A	762 × 9.5	13.80
FS50A (Rounded Edge Profile)	50 × 3.2	0.29
FS60A (Rounded Edge Profile)	60 × 3.2	0.36
FS70 (Rounded Edge Profile)	70 × 4.0	0.54
FS90A (Rounded Edge Profile)	90 × 3.2	0.54



Air Conditioning Louvers



HVAC Ventilation Grilles

Resin Concrete Drainage Channel



Facing chemical attack from acids, alkalis, and salts, All Leader resin concrete drainage channels exhibit excellent resistance performance, particularly suitable for harsh environments like wastewater treatment plants and coastal areas. Superior weather resistance and chemical stability ensure long-term use without frequent maintenance, significantly reducing lifecycle costs. From urban streets to industrial zones, providing durable and reliable drainage protection.

Standard Drain



Model	Channel Width(mm)	Channel Depth(mm)	Length(mm)	Bottom Width(mm)	Wall Thickness(mm)	Weight(kg)
SD-100	130	150	1000	100	15	25
SD-150	180	180	1000	150	15	35
SD-200	230	200	1000	200	20	55
SD-250	280	250	1000	250	20	72
SD-300	360	300	1000	300	30	95
SD-400	460	400	1000	400	30	135
SD-500	560	500	1000	500	30	180



Sidewalks Drainage Channel

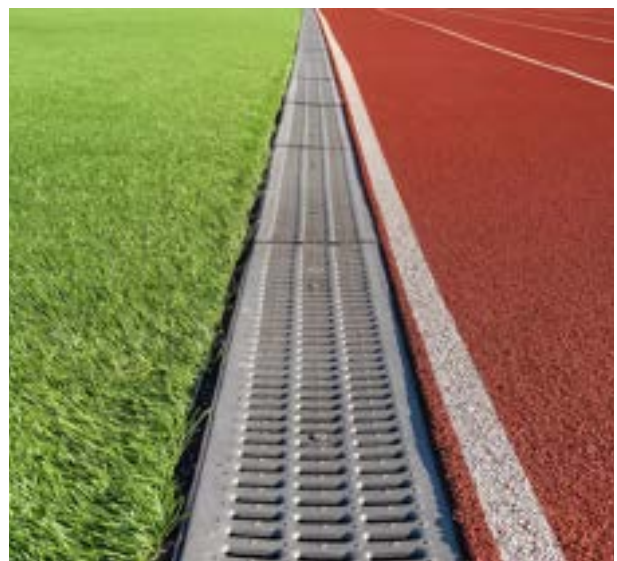

Sports Fields Drainage Channel

ForceDrain



Model	Channel Width(mm)	Channel Depth(mm)	Length(mm)	Bottom Width(mm)	Wall Thickness(mm)	Weight(kg)
FD-100	180	100	1000	100	20	38
FD-200	280	200	1000	200	25	95
FD-300	380	300	1000	300	30	165



Racing Circuits Drainage Channel



Airport Taxiways Drainage Channel

SlotDrain



Model	Channel Width (mm)	Channel Depth (mm)	Length (mm)	Bottom Width (mm)	Slot Width (mm)	Wall Thickness (mm)	Weight (kg)
SD-100 (Single Slot)	130	100	1000	100	12	15	25
DSD-100 (Double Slot Adjacent)	230	100	1000	200	12×2	15	45
DSD-200 (Double Slot Adjacent)	330	200	1000	300	15×2	20	85
TSD-200 (Double Slot Separated)	230	200	1000	200	10×2	18	72



Plaza Flooring Drainage Channel



Urban Streets Drainage Channel

PlateDrain

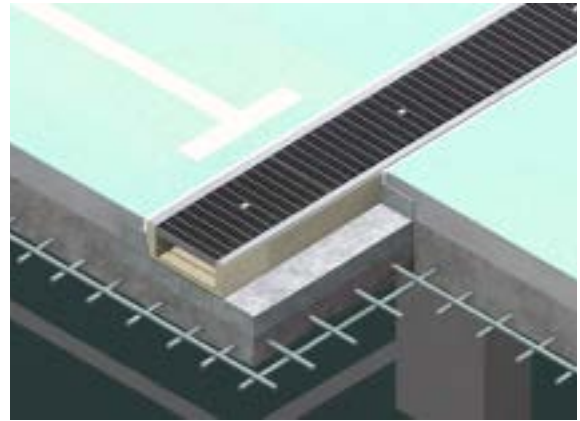

Model	Channel Width (mm)	Channel Depth (mm)	Length (mm)	Bottom Width (mm)	Plate Thickness (mm)	Side Wall Thickness (mm)	Weight (kg)
PD-100	150	100	1000	120	25	15	32
PD-200	250	200	1000	220	30	15	72
PD-300	350	300	1000	320	35	15	118



Sidewalks Drainage Channel

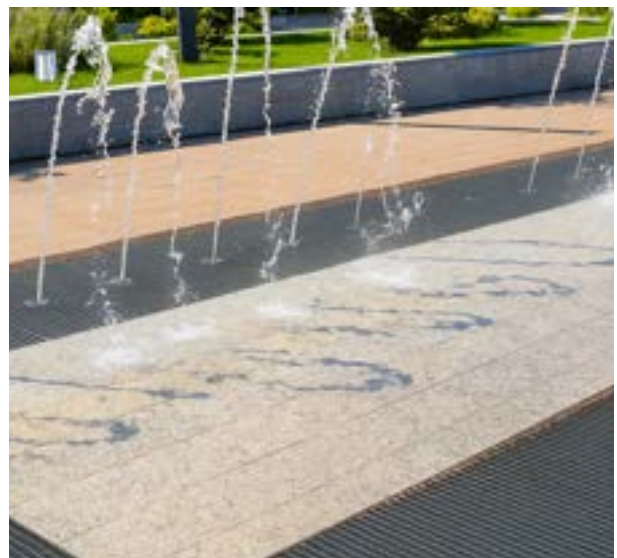

Fountain Plazas Drainage Channel

CurbDrain



Model	Total Width (mm)	Curb Height (mm)	Channel Depth (mm)	Length (mm)	Curb Width (mm)	Channel Width (mm)	Wall Thickness (kg)
CD-100	250	150	100	1000	150	100	18
CD-200SF	350	200	200	1000	150	200	25
CD-200SM	350	200	200	1000	150	200	25
CD-200B	350	200	200	1000	150	200	25



Central Medians Drainage Channel



Sidewalk Curbs Drainage Channel

RoadDrain



Model	Channel Width (mm)	Channel Depth (mm)	Length (mm)	Bottom Width (mm)	Wall Thickness (mm)	Reinforcement Rib Width(mm)	Weight (kg)
RD-200	280	200	1000	200	30	20	85
RD-300	380	300	1000	300	40	30	155



Sidewalks Drainage Channel



Roadways Drainage Channel

UrbanLeaf

Sidewalks Drainage Channel



Model	Length(mm)	Width(mm)	Thickness(mm)	Weight(kg)
UL-1215-15	1200	150	15	8.5
UL-1215-20	1200	150	20	10.2
UL-1218-15	1200	180	15	9.8
UL-1218-20	1200	180	20	11.5
UL-2415-15	2400	150	15	8.5
UL-2415-20	2400	150	20	10.2

Sound Absorption Coefficient Table (NRC Values)

Frequency(Hz)	UL-15mm Thick	UL-20mm Thick	Standard Value	Test Standard
125	0.15	0.20	≥0.15	ISO 354
250	0.45	0.55	≥0.40	ISO 354
500	0.80	0.88	≥0.75	ISO 354
1000	0.92	0.95	≥0.85	ISO 354
2000	0.88	0.92	≥0.80	ISO 354
4000	0.75	0.82	≥0.70	ISO 354
NRC	0.75	0.83	≥0.70	Average

SGS & Academic Certifications



Case Study

Public Works



Category	Region	Project Name
Public Works	Taoyuan City	桃園航空計畫區段徵收工程 C1 分標統包工程[其餘區]
Public Works	Taoyuan City	桃園航空計畫區段徵收工程 B1 分標統包工程[優先開發區]
Public Works	Taoyuan City	污水下水道內壢地區管網明挖暨用戶接管工程 3-2H-2 標
Public Works	New Taipei City	新北市新店地區污水下水道系統(第二期) 新建工程第五標分支管網及用戶接管(含一期未納戶)
Public Works	New Taipei City	新北市樹林地區污水下水道系統第一期工程 第七-2、八、九、十、十二標(支)分管及用戶接管
Public Works	New Taipei City	新竹市污水下水道系統公道五路分支管網及用戶接管工程暨指定地區-3
Public Works	Miaoli County	苗栗縣後龍鎮污水下水道管網及用戶接管工程(一)
Public Works	Taichung City	臺中市烏日門門地區區段徵收工程第一標及四標合併工程
Public Works	Changhua City	彰化市污水下水道第一期用戶接管工程第二標
Public Works	Yunlin County	雲林縣北港梧寮中地里劃區
Public Works	Changhua County	彰化濱海工業區開發工程鹿港廢水處理二期增設除臭設施工程
Public Works	Chiayi City	嘉義市污水系統第一期-分支管網及用戶接管第 4、5 標工程
Public Works	Kaohsiung City	陸軍第一地區支援指揮部[光華營區]下水道整體工程]
Public Works	Tainan City	臺南市柳營區污水下水道系統(西新營分區)分支管網及用戶接管工程第一標
Public Works	Taitung County	台東縣知平鐵路車站附近地區污水下水道系統官線工程第一標
Public Works	Taitung County	台東看守所舊址(含宿社區)污水下水道暨接管工程案
Public Works	Taitung County	知平溫泉風景特定區污水下水道系統用戶接管工程
Public Works	Hualien City	花蓮市及吉安鄉地區用戶接管開口契約(第三標)
Public Works	Hualien County	花蓮縣新城(北埔地區)污水下水道系統工程第二標
Public Works	Penghu County	馬公市元采果污區內機關及學校污水下水道用戶接管新建工程
Public Works	Penghu County	澎湖縣馬公地區污水下水道系統第一期工程刀文官網及用戶接管工程第二標
Public Works	Penghu County	澎湖縣馬公地區機關及學校污水下水道用戶接管工程
Public Works	Kinmen County	金沙鎮第六標污水下水道及用戶接管工程暨 自來水管線汰換及電力管線預埋工程

The above represents partial project records. For complete project portfolio, please refer to our official website.

Case Study

Private Projects



Category	Region	Project Name
Private Projects	Taoyuan City	促進民間參與桃園市壠頂計畫區 污水下水道系統建設之興建、營運、移轉(BOT)
Private Projects	Taoyuan City	促進民間參與桃園縣桃園地區 污水下水道系統建設之興建、營運、移轉計畫(BOT)
Private Projects	Taoyuan City	桃園污水處理廠 BOT 案-忠孝西路新建房屋管線工程
Private Projects	Kaohsiung City	高雄宋氏總管
Private Projects	Kaohsiung City	健1-醫院
Private Projects	Kaohsiung City	加定運動公園整理改造工程
Private Projects	Kaohsiung City	楠梓區-杏美診所私人後巷
Private Projects	Kaohsiung City	高雄市鳳山區文昌一街18巷(透天住家社區)
Schools	Kaohsiung City	高雄市中區楠山國民中學
Schools	New Taipei City	新北市板橋區沙崙國小
Schools	Taoyuan City	桃園市立育英國民中學
Schools	Taichung City	臺中市東勢區新成國小
Schools	Taichung City	國立中興大學附屬臺中高級農業職業學校
Schools	Hualien County	國立花蓮女子高級中學
Schools	Kinmen County	金門縣金湖鎮怕厝國小
Construction Companies		上揚建設
Construction Companies		貝誠建設
Construction Companies		太普建設
Construction Companies		隆大建設
Construction Companies		日立建設
Construction Companies		城揚建設
Construction Companies		宋峰國際建設有限公司
Construction Companies		北揚開發股份有限公司

The above represents partial project records. For complete project portfolio, please refer to our official website.

Case Study



Kaohsiung Veterans General Hospital



Chongqing, China



Wanluan Industrial Road, Pingtung

Case Study



Back Alley of Yukang Road,
Chiayi



Back Alley of Guo'an 1st Street,
Chiayi



Back Alley of Zili Street, Changhua City

Case Study



Back Alley of Zhongmei 12th Street, Hualien City



Back Alley of Pinghe 9th Street, Changhua City



Back Alley of Meilun Road, Changhua City

ESG

Low Carbon Footprint for a Sustainable Future



Empowering Communities Through Social Responsibility



Compliance and Ethical Production







歐利達國際有限公司

All Leader International CO., LTD

Website

www.all-leader.com

Phone

+886-7-7905553

E-mail

info@all-leader.com

Address

10th Floor, No. 388, Guanzhong South Road,
Qianzhen District, Kaohsiung City, TAIWAN(R.O.C)