

LEYAD



NIAGARA PEN CENTRE

St. Catharines, Ontario



Population Size
215,945



Median Age
42.7



Average Household Income
\$106,744



Trade Area
150,000+



GLA. SF
1,100,000



Number of Stores
154



Annual Foot Traffic
7,000,000



Daily Car Traffic
37,694

Contact

Hugo Moller
Commercial Leasing
+1 514 608 1893
hugo@leyad.ca

NIAGARA PEN CENTRE St. Catharines, ON

Highway 406

LEVAD
October 2025

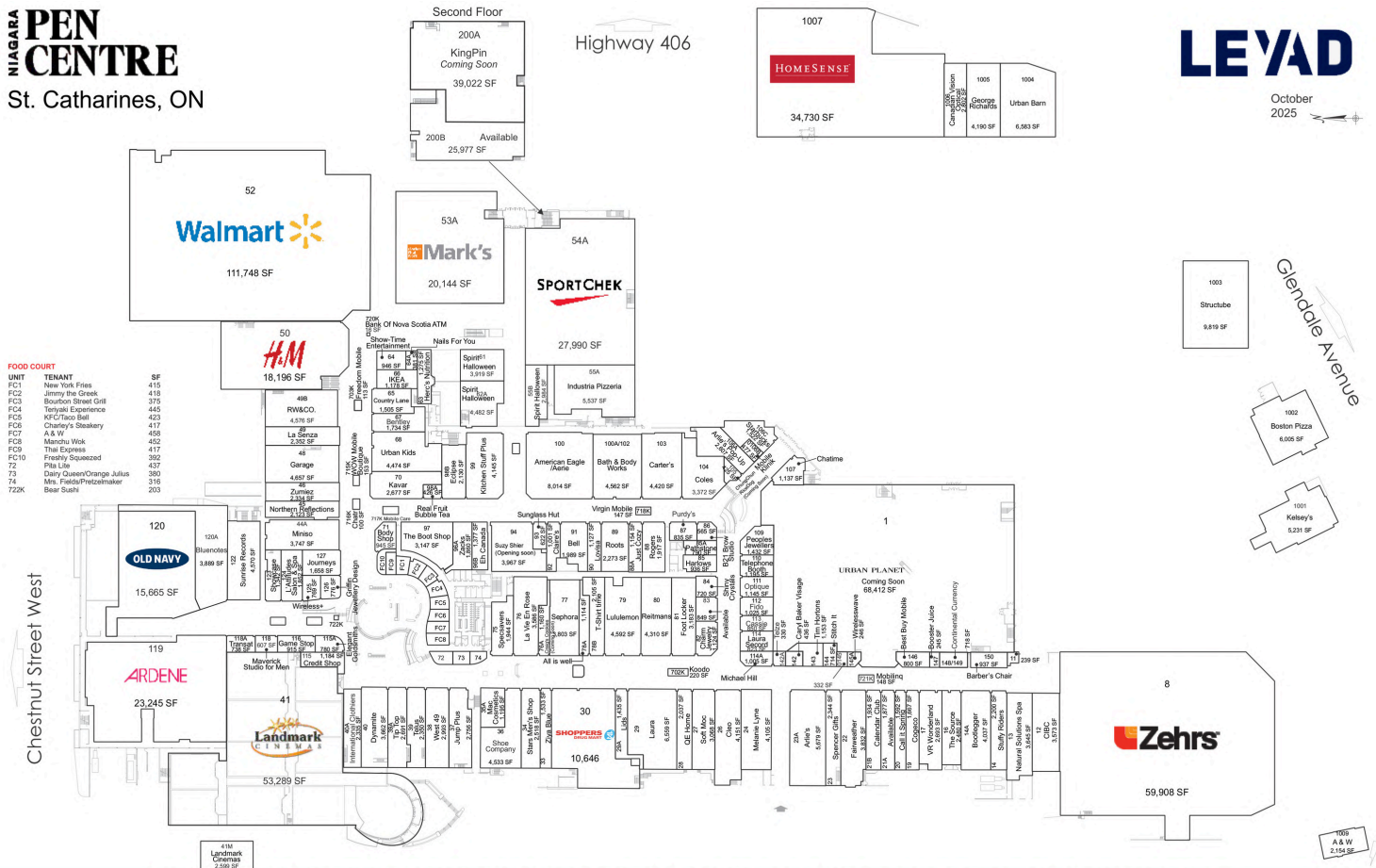

This site plan is presented solely for the purpose of identifying the approximate location of the buildings as presently contemplated by the owner/landlord. Building dimensions, access and parking areas, existing tenant locations and identities are approximate and subject to change at the owner's discretion from time to time without notice. The information provided herein should be otherwise verified and is not intended to be relied upon in the form presented.

NIAGARA PEN CENTRE
 Lower Level
 St. Catharines, ON

Highway 406

LEYAD
 October 2025

Chestnut Street West

Glendale Avenue

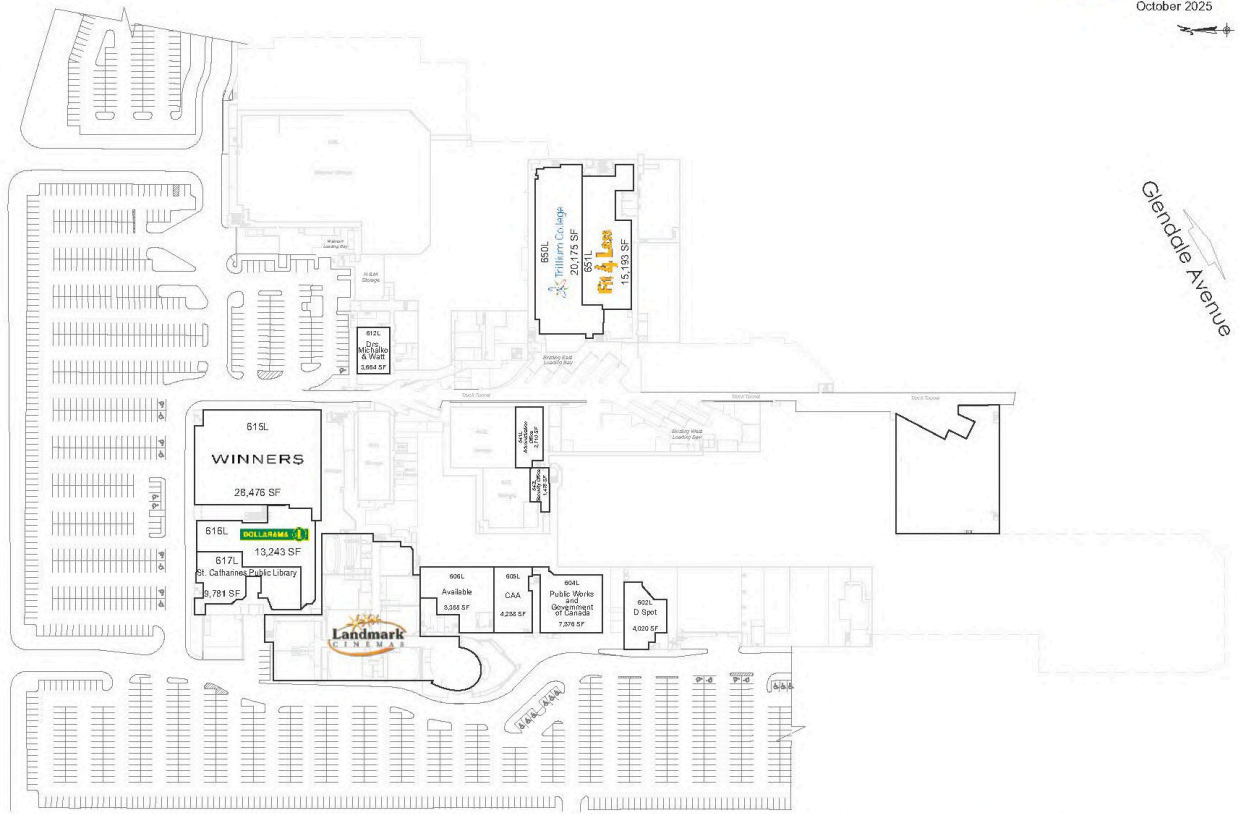

This site plan is presented solely for the purpose of identifying the approximate location of the buildings as presently contemplated by the owner/landlord. Building dimensions, access and parking areas, existing tenant locations and identities are approximate and subject to change at the owner's discretion from time to time without notice. The information provided herein should be otherwise verified and is not intended to be relied upon in the form presented.

NIAGARA PEN CENTRE

221 Glendale Ave, St. Catharines, ON L2T SK9



LEYAD

Shaping Skylines, Driving Value

Hugo Moller

+1 514 608 1893

hugo@leyad.ca