



**Huts & Decks WA**  
TRANSFORMING SPACES

# Coco 5m x 4m

## \$23900



Coco is one of our most popular designs.

This timber cabin is a harmonious fusion of style and functionality in a compact package.

In keeping with our commitment to quality, all doors & windows are double-glazed so you can enjoy peace & tranquility within the cabin walls.

### Features:

- High quality Nordic spruce timber (heat-treated)
- Engineered tongue and groove interlocking system for easy assembly
- Foundation timbers are impregnated with arsenic-free wood preservative
- Colonial style windows & doors
- 2 x modern European-style tilt & turn windows
- 40mm wall thickness – naturally insulating & no need for internal lining

### Included in your kit:

- Double glazed doors and windows
- Precut timber components
- Roof cover is steel roofing with a choice of colours
- Roofing insulation
- Hardware for doors and windows
- Fixings (nails, screws, etc)
- 18mm ceiling and flooring boards
- Sealer & Primer (to be applied after assembly)
- Rubber mallet
- Detailed instructions
- Delivery to site (within metro area)

### Kit Building Info:

- Assembly by DIY or handyman, however we do recommend trade skills and good building knowledge background. (Or we can send out our friendly building team to do the job for you!)
- Timeframe – 4 to 7 days (min 2 person)
- Tools suggested
  - Hammer and Nail Punch.
  - Battery Drill.
  - Drill bits & Screw Bit.
  - Tape Measure
  - Level
  - Power Saw/hand saw.
  - Ladder.
  - Stanley Knife.
  - Paint to seal and finish.
  - Tin Snips
  - Rivet gun

*Please Note: You will need either to be an approved owner-builder or use a registered builder to install this cabin.*



**Huts & Decks WA**  
TRANSFORMING SPACES

# Coco 5m x 4m

## \$23900

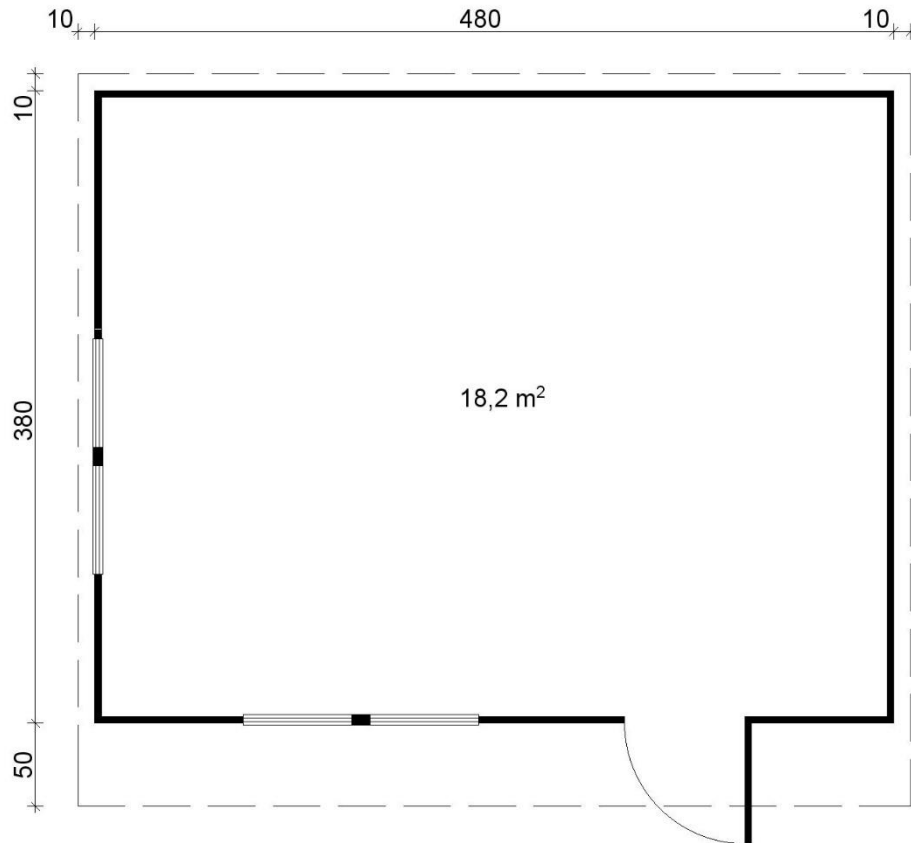

### Specifications:

External Log Dimensions (W x D):	5m x 4m
External Board Dimensions (W x D):	4.8m x 3.8m
Floor surface area:	18.2 m <sup>2</sup>
Wall thickness:	40 mm
Roof pitch	5 °
Side wall height:	211 / 245 cm
Ridge Height:	254 cm
Roof surface area:	23m <sup>2</sup>
Roof and floor board thickness:	18 mm
Double glazed window size:	2 @ 1472 x 990mm
Double glazed door size:	840 x 1955 mm
Kit weight:	1400 kg
Flat-packed kit size:	L 540 cm x W 108 cm x H 72 cm