

PROPERTY HIGHLIGHTS**Lease Rate:** \$7.95 SF, NNN**Total Size:** 6,000 SF**Office:** 3,540 SF**Mezzanine:** 1,500 SF**Land:** 1.88 Acres**Zoning:** M-1 Light Manufacturing**Year Built:** 1989**Grade Level Door:** 1 - 14'x14' with Opener**Docks:** 1**Eave Height:** 16'**Warehouse Dimensions:** 60' x 100'**Construction:** Pre-engineered Steel**Roof:** Standing Seam Metal**Column Spacing:** Clear Span**Power:** 240v/400a/3 Phase**Lighting:** LED & T-5 Fluorescent**Heating:** Radiant**Air-Conditioning:** Office Only**Fire Protection:** Yes, wet system**Restrooms:** 2**Utilities:** City water & sewer**Taxes:** \$13,387.66**Occupancy:** 30 days**2509 Ada Drive
Elkhart, IN 46514****PROPERTY DETAILS**

Great building on the north side of Elkhart just off CR 6 with easy access to CR 17, SR 19, and I-80/90. The building features 8 offices with a large training/conference room, reception area with a lobby and vestibule, breakroom, and two restrooms. The warehouse has a dock and a grade level door, a tool crib/storage room, and a 1,500/SF mezzanine over the offices. There is a fenced in storage yard and additional land for expansion. The building is currently set up great for a service/office type business with a small amount of warehouse space but could be altered to add additional warehouse and less office if needed. Owner will carpet and paint the office space for the new tenant.

*Note: One of the principals is an Indiana licensed real estate broker.

Make contact.

Brent C. Miller, SIOR
Principal, Managing Broker
Cell: 574-536-4438
Direct: 574-501-3202
brentm@endeavour-grp.com

Endeavour Commercial
22047 Endeavour Dr., Elkhart, IN 46514
P 574-292-7995
endeavour-grp.com





ENDEAVOUR
COMMERCIAL

INDUSTRIAL BUILDING FOR LEASE



The information contained herein was obtained from sources believed to be reliable. We cannot be responsible for errors, omissions, prior sale or lease, change of price or withdrawal from the market without notice. No liability of any kind is to be imposed on the broker herein.



SITE PLAN

1.88 ACRE

400.00'

205.00'

WOODED AREA
27,582 S.F.

LAWN AREA

DRIVEWAY
3,840 S.F.

60'x100' BUILDING

CONC. DOCK

ASPHALT PARKING

LAWN AREA

ASPHALT PARKING

LAWN AREA

INSPECT N/H

COOPER DRIVE

ADA DRIVE

UTILITY LINES:
GAS
SEWER
W (WATER)
T (TELEPHONE)
P (POWER)

Dimensions:
400.00'
205.00'
56'
42'
19'
52'
6.8'



ENDEAVOUR
COMMERCIAL

INDUSTRIAL BUILDING FOR LEASE

FLOOR PLAN

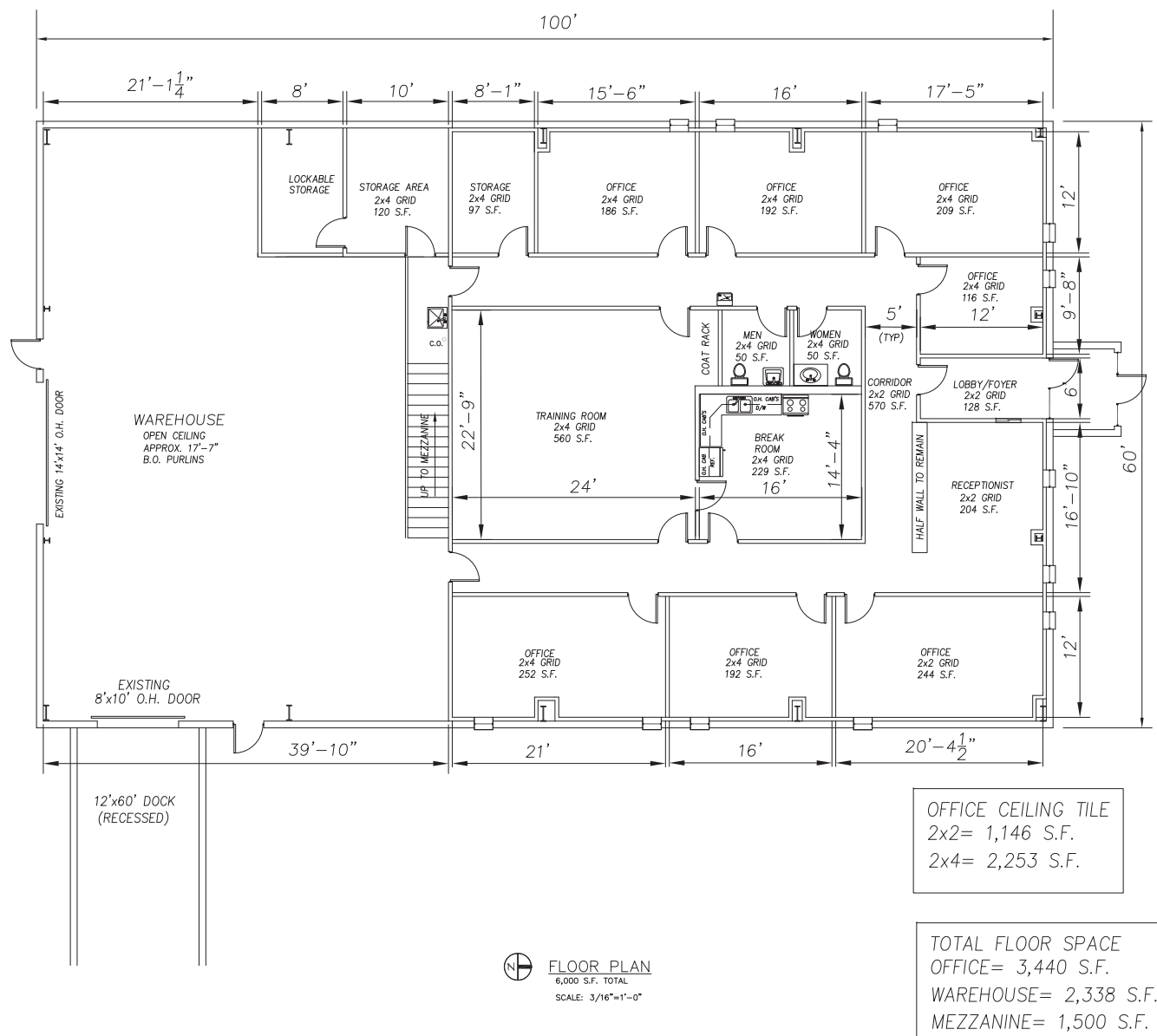



ENDEAVOUR
COMMERCIAL

INDUSTRIAL BUILDING FOR LEASE

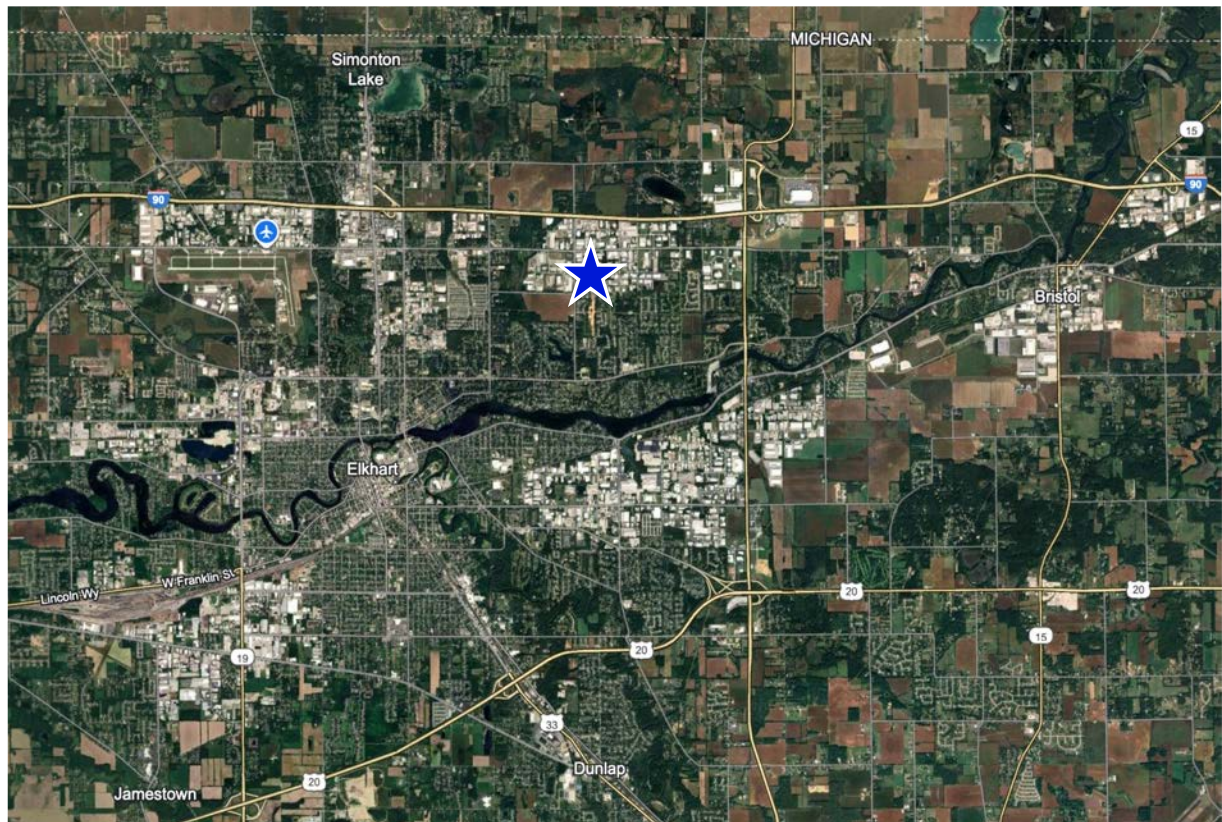
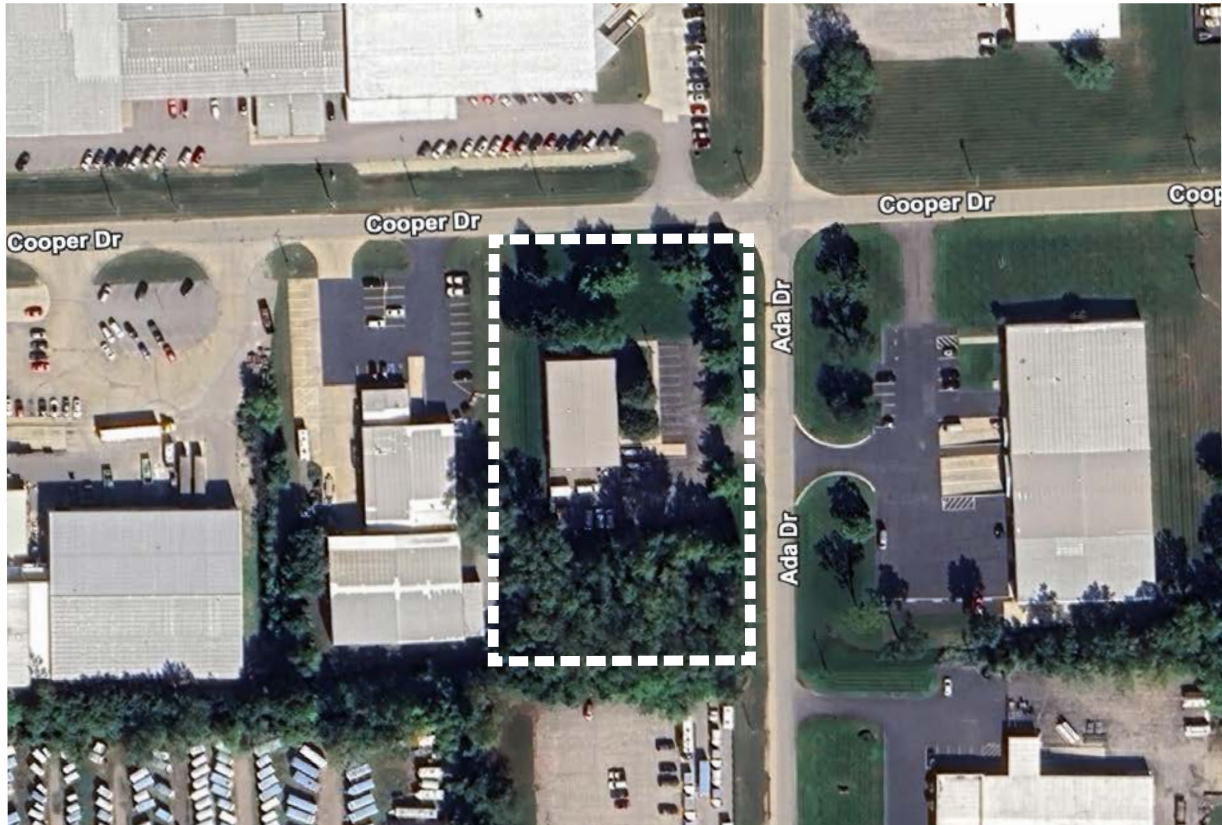

The information contained herein was obtained from sources believed to be reliable. We cannot be responsible for errors, omissions, prior sale or lease, change of price or withdrawal from the market without notice. No liability of any kind is to be imposed on the broker herein.