



Vulcan Seals Type 292
S.P.X.® A.P.V.®
Technical Data Sheet



Product Description

The **Vulcan Seals Type 292 S.P.X.® A.P.V.®** is a bearing set without elastomer or metal parts and is intended to suit APV® agitators, formerly sold as “Osborne Craig®” brand.
The **Vulcan Seals Type 292 S.P.X.® A.P.V.®** is intended as a direct alternative to the original OEM design.

Why Choose the Vulcan Seals Type 292 S.P.X.® A.P.V.®?

- The features include a Brass self-aligning face set in a Carbon cup bearing.
- It is a direct replacement design to suit the original equipment, produced to Vulcan Seals’ manufacturing standards.

Pump Ranges

The S.P.X.® A.P.V.® pump model includes the following pump ranges: "Osborne Craig®" side entry agitators.

Standard Face Material Combinations

Elastomers	Rotary Face	Stationary Face	Metals	Complete Seal Code
--	Brass IS350 Group1	VCP1 Carbon	--	.X.CB.

Dimensional Data

DØ (Imperial)	Seal Size Code	D1 (mm)	D3 (mm)	L1 (mm)
1.125	0286	57.00	44.44	32.50

Dimensions in mm
*Non-stock guarantee

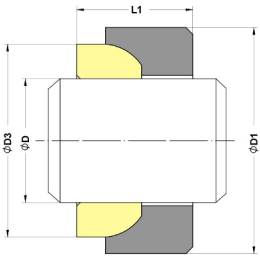

® ™ All product names, brands and trademarks shown are property of their respective owners, are for identification purposes only, and do not imply affiliation nor endorsement.
** All dimensional and identification information shown is given in good faith and is based on extensive experience gained in business. Performance data is not provided for this product range based on the Vulcan Seals design being a replacement of, or an improvement on, a design that has originally proved suitable for the equipment and service concerned.