

# FOR LEASE | 14,800 SF - RITE AID

SWC E Broadway & Cherry Ave | Long Beach



For leasing, please contact:

**Richard Rizika**

Lic. 01044064

T 310 430 7790 x101

Richard.Rizika@BetaAgency.com

**Brittany Freeman**

Lic. 02254356

T 310 430 7790 x133

Brittany.Freeman@BetaAgency.com

**Jake Gordon**

Lic. 02225974

T 310 430 7790 x140

Jake.Gordon@BetaAgency.com

**beta.**

[BetaAgency.com](https://www.BetaAgency.com)

137 Eucalyptus Dr, El Segundo, CA 90245

©2025 Beta Agency, Inc. The information contained in this document (or provided verbally) has been obtained from sources believed reliable. While Beta Agency Inc. does not doubt its accuracy, Beta Agency Inc. has not verified it and makes no guarantee warranty or representation about it. It is your responsibility to independently confirm its accuracy. Any projections, opinions, assumptions or estimates used are for example only and do not represent the current or future performance of the property. The value of this transaction to you depends on tax and other factors which hold be evaluated by your tax, financial and legal advisors. You and your advisors should conduct a careful, independent investigation of the property to determine to your satisfaction the suitability of the property meet your needs.



# PROPERTY HIGHLIGHTS

- **Dense Urban Infill** – 56,000+ residents within 1-mile
- **Supply Constrained Area** – Very few comparable boxes in immediate vicinity and barriers to new development
- **Prominent Intersection** – Cherry Ave and Broadway delivers convenient access to the dense residential area
- **Dedicated Surface Parking** – 62 dedicated parking spaces at grade
- **Signalized intersection** that sees over 32,000 cars per day



## POPULATION

1 mile	2 mile	3 mile
<b>56,111</b>	<b>168,816</b>	<b>241,950</b>



## AVG. HOUSEHOLD INCOME

1 mile	2 mile	3 mile
<b>\$105,203</b>	<b>\$104,754</b>	<b>\$114,039</b>



## AREA EMPLOYMENT

1 mile	2 mile	3 mile
<b>21,268</b>	<b>94,339</b>	<b>150,562</b>





## | Property Description



### LOCATION

211 Cherry Ave, Long Beach, CA 90802



### RENTABLE AREA

14,824 SF



### LAND AREA

0.91 AC (39,772 SF)



### OWNERSHIP

Fee Simple (Land & Building)



### ACCESS

There are 2 access points. 1 via E Broadway, 1 via 2nd St



### REMODELED

Location was remodeled in 2000



### PARKING

62 spaces (4.18 per 1000 SF)



### TRAFFIC COUNTS

E Broadway	±20,866 CPD
Cherry Ave	±10,384 CPD



### ZONING

Building is zoned CNR  
(Neighborhood Commercial & Residential)



### PARCEL MAP

APN: 7265-020-034

## SWC E Broadway & Cherry Ave | Long Beach





E BROADWAY ST ±20,866 CPD



CHERRY AVE ±10,384 CPD



AVAILABLE  
14,824 SF

2ND ST ±1600 CPD



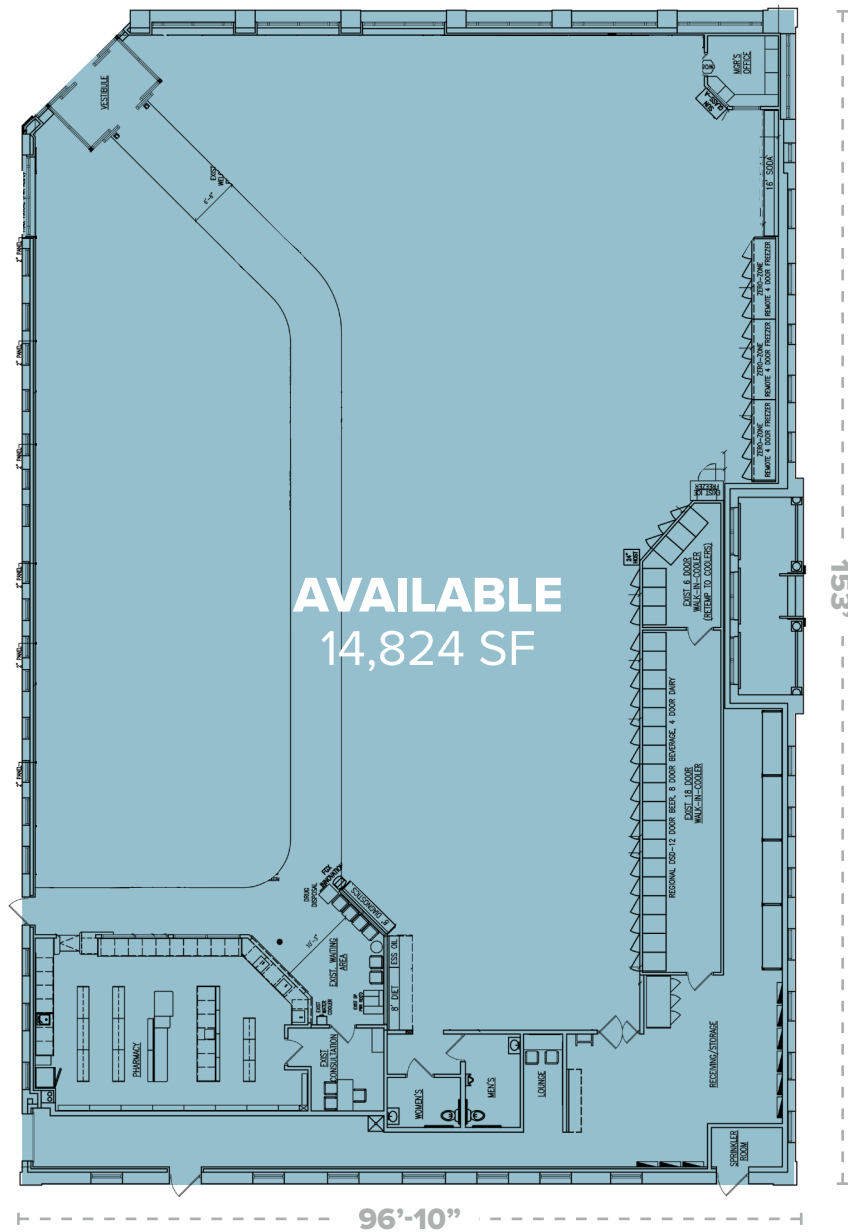



## Trade Area Map

SWC E Broadway & Cherry Ave | Long Beach

Demographics	1 mile	2 mile	3 mile
Population	56,111	168,816	241,950
Average Household Income	\$105,203	\$104,754	\$114,039
Median Household Income	\$83,579	\$83,977	\$87,676
White	38.5%	33.8%	34.5%
Black or African American	12.9%	13.6%	13.2%
Asian	11.2%	13.5%	13.8%
Hispanic or Latino	57.9%	57.3%	56.1%
Median Age	36	36	36
Median Home Value	\$1.67M	\$1.61M	\$1.55M
Average Household Size	2.1	2.2	2.0
College Degree + (Bachelor Degree or Higher)	64%	59%	66%

[Click here for full demographic report](#)

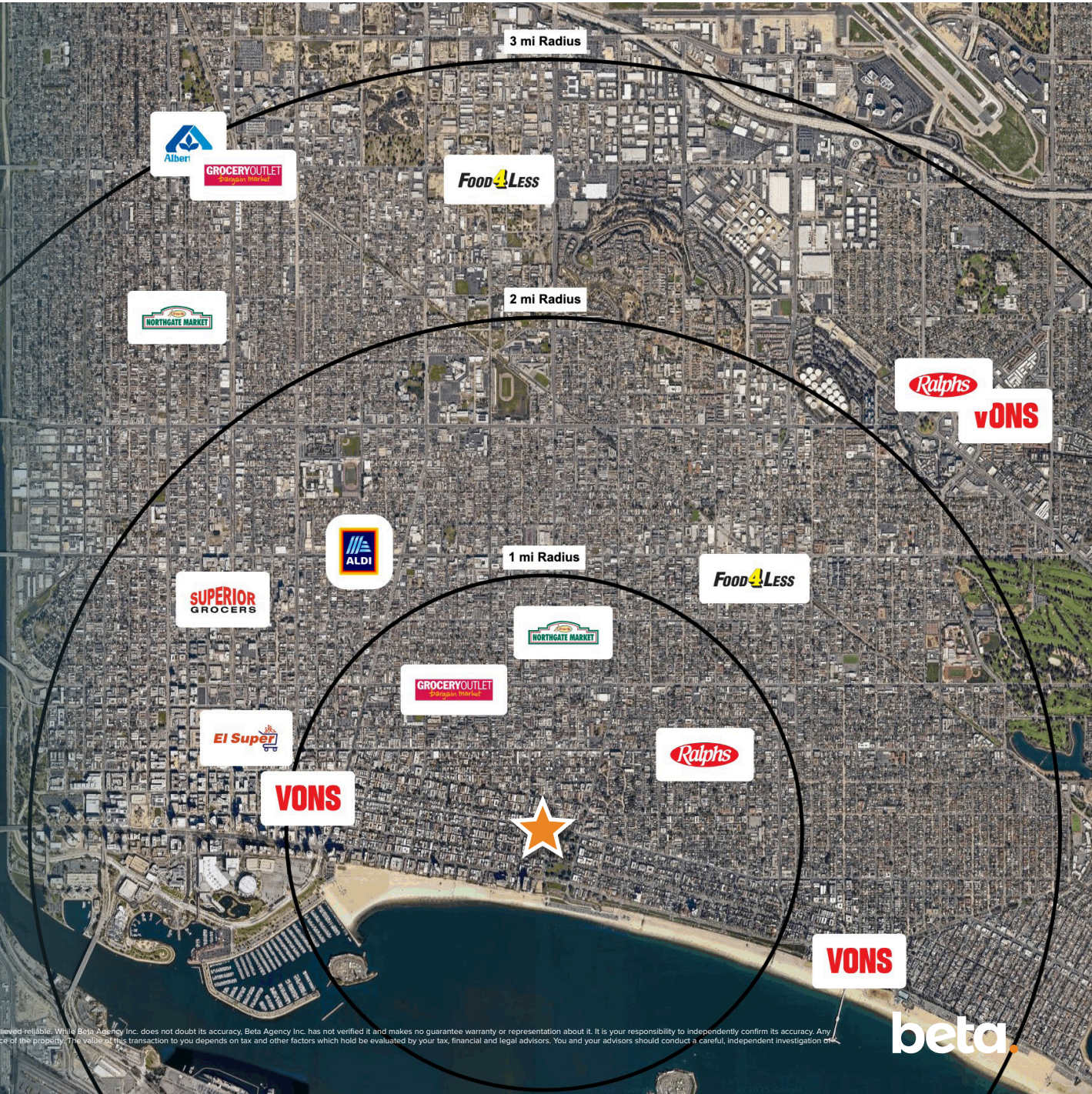





# beta.

*For leasing, please contact:*

**Richard Rizika**

Lic. 01044064

T 310 430 7790 x101

Richard.Rizika@BetaAgency.com

**Brittany Freeman**

Lic. 02254356

T 310 430 7790 x133

Brittany.Freeman@BetaAgency.com

**Jake Gordon**

Lic. 02225974

T 310 430 7790 x140

Jake.Gordon@BetaAgency.com

©2025 Beta Agency, Inc. The information contained in this document (or provided verbally) has been obtained from sources believed reliable. While Beta Agency Inc. does not doubt its accuracy, Beta Agency Inc. has not verified it and makes no guarantee warranty or representation about it. It is your responsibility to independently confirm its accuracy. Any projections, opinions, assumptions or estimates used are for example only and do not represent the current or future performance of the property. The value of this transaction to you depends on tax and other factors which hold be evaluated by your tax, financial and legal advisors. You and your advisors should conduct a careful, independent investigation of the property to determine to your satisfaction the suitability of the property meet your needs.

**BetaAgency.com**

137 Eucalyptus Dr, El Segundo, CA 90245