

## Self-Storage **9530**

Designed for ease of installation, the **9530 Series** requires minimal steps and tools, reducing the time it takes to install the door. The 9530 Series is ideal for light-duty or self-storage applications, carports, barns, and sheds.



### Max opening size 10' x 10'

Available in sizes up to 10' x 10' and in a variety of colors.



### Warranty

Three-year door warranty. For paint, 35-year no-fade, 40-year film integrity.



### Options

Insulated options available.



### Easy to Use Tensioning Device

Each 9530 door uses a worm gear tensioning device that does not require special tools to apply or remove tension.



### Installation & Operation

Wear strips combined with a symmetrical headstop and round drum for quieter operation and an easier installation.



### Industry Standard Seamed Panel Profile

The panels are seamed together with the highest quality seaming process.

**1 Brackets:** 12-gauge reinforced galvanized steel

**2 Door Curtain:** Industry standard profile, 26-gauge, Grade 80 prepainted steel

**3 Bottom Bar:** 6063-T6 Aluminum extruded bottom bar with T-Bulb astragal

**4 Drums:** 9.5" stamped steel drum

**5 Head Stops:** 12-gauge galvanized mounted by keyhole design for ease of installation

**6 Guides:** The 18-gauge galvanized steel guides are secured to the brackets and are fitted with polyethylene guide strips to provide smooth and quiet operation

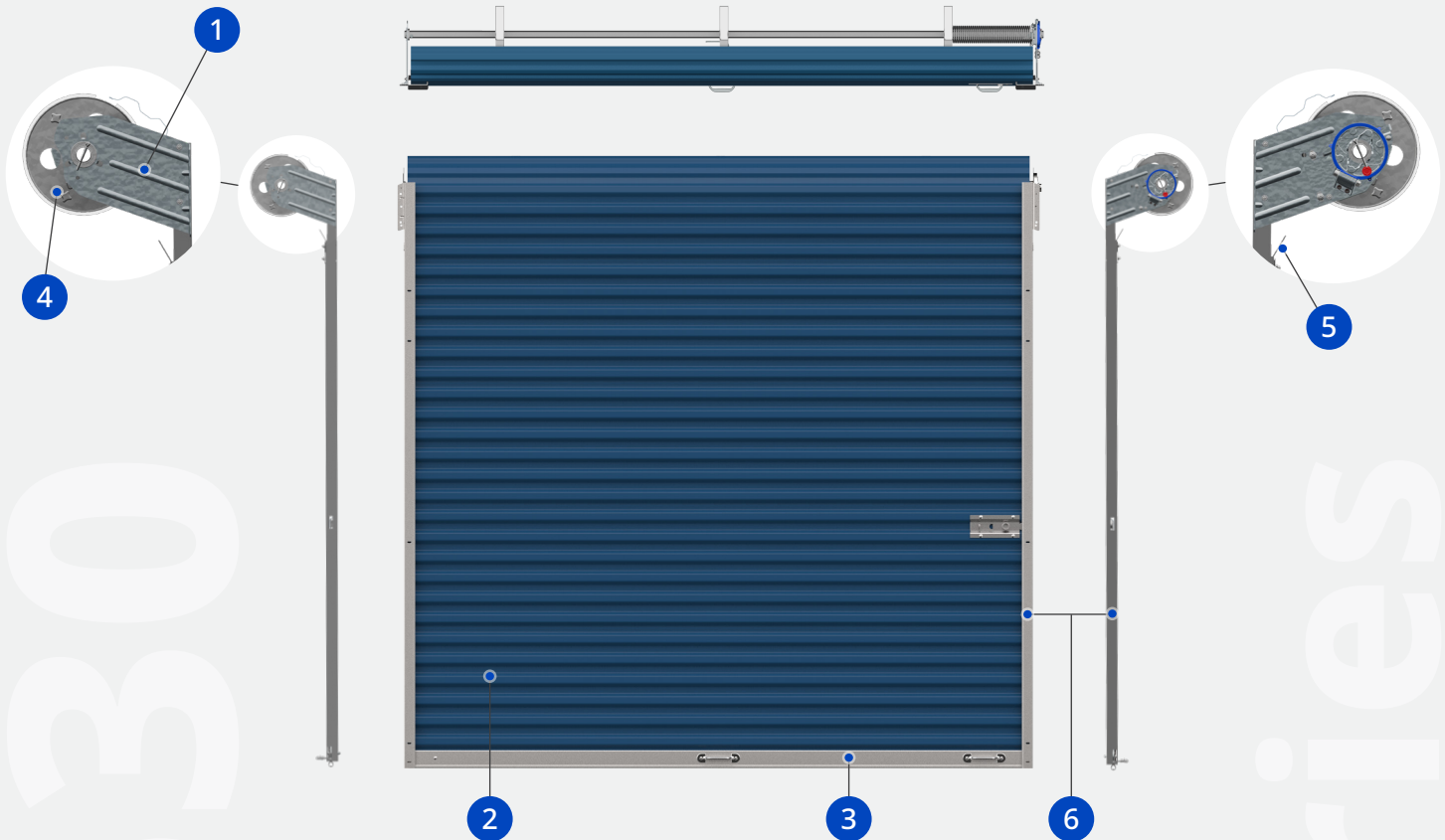

Steel Drum for Live Axle

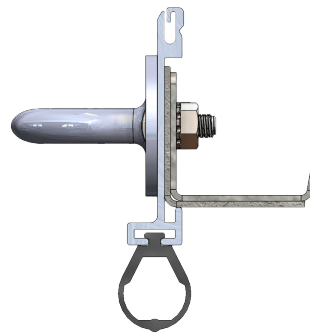

T-bulb Astragal System