

## MIX HEROIN IDENTIFICATION

### Substance & Trace Test



#### Read Before Use

As a precaution, gloves and eye protection should be worn when handling drug substances and using test units. Do not puncture any part of unit. Do not remove probe once a capsule is broken. In the unlikely event of a spill, rinse affected area thoroughly with water. Keep out of reach of children. All results are presumptive. If necessary, further testing by a competent drug testing lab can provide additional identification.

#### Test Preparation

1

Remove the probe from test unit.

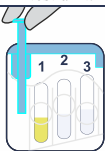

#### Testing Options

1. If the suspected substance is a **brown powder**, proceed to **Steps 2-5 on Side 1**.
2. If the suspected substance is a **white powder** or a **tablet**, proceed to **Steps 6-11 on Side 2**.

### Brown Heroin Test

#### Brown Heroin Test Preparation

2

Sample suspected substance or surface.

Touch or Swipe

Touch probe to the suspected substance.



Swipe either side of the probe across the suspect surface.



3

Secure probe into test unit. Press firmly.

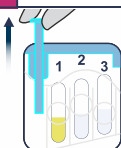

Do not continue unless probe is secured properly in place.

#### Brown Heroin Identification

4

From both sides of the kit, squeeze on the circle of **Chamber 1** until the capsule breaks.

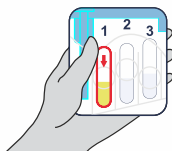

5

Gently shake test unit for 2-3 seconds.

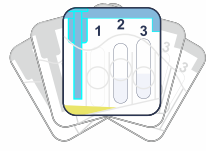

#### Brown Heroin Results



If a brown powder is present, the appearance of a purple-red color strongly indicates the presence of **Brown Heroin**.



If no purple-red color develops, Brown Heroin is not present.

\* Regardless of whether or not a purple-red color developed, do not continue to White Heroin testing. Proceed to Disposal.



#### Disposal

The test kit is safe to dispose of in the trash.

01-19

## MIX HEROIN IDENTIFICATION

### Substance & Trace Test

## SIDE 2

### White Heroin Test

#### White Heroin Prep.

6

Sample suspected substance or surface.

Touch or Swipe or Dig

Touch probe to the suspected substance.



Swipe either side of the probe across the suspect surface.



Firmly press probe on the tablet while scrubbing in a circular motion until the tip is completely covered with substance.

7 Secure probe into test unit. Press firmly.

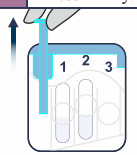

Do not continue unless probe is secured properly in place.

#### White Heroin Identification

8

From both sides of the kit, squeeze on the circle of **Chamber 2** until the capsule breaks.

**DO NOT BREAK CHAMBER 1**

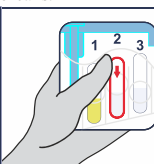

9

Gently shake test unit for 2-3 seconds.

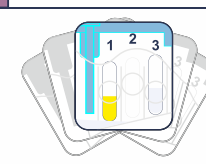

#### White Heroin Results



If the substance is a powder, the appearance of a purple color indicates the presence of an opiate such as **Heroin**.

If the substance is a tablet, the appearance of a purple color indicates the presence of an opiate such as **Morphine** or **Codeine**.

If no purple color develops, an opiate is not present.



\* Regardless of whether or not a purple color developed, do not continue to Brown Heroin testing. Proceed to Dilution & Disposal.

#### Dilution

10

From both sides of the kit, squeeze on the circle of **Chamber 3** until the capsule breaks.

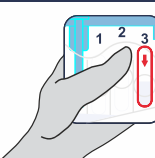

11

Gently shake test unit for 2-3 seconds.

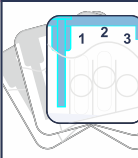

The test window will warm up. This is normal.



#### Disposal

After Dilution, the test kit is safe to dispose of in the trash.

01-19