



#### Read Before Use

As a precaution, gloves and eye protection should be worn when handling drug substances and using test units. Do not puncture any part of unit. Do not remove probe once a capsule is broken. In the unlikely event of a spill, rinse affected area thoroughly with water. Keep out of reach of children. All results are presumptive. If necessary, further testing by a competent drug testing lab can provide additional identification.

#### Test Preparation

1

Remove the probe from test unit.

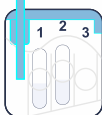

2

Sample suspected substance or surface.

Touch or Swipe

Touch probe to the suspected substance.



Swipe either side of the probe across the suspect surface.



3

Secure probe into test unit. Press firmly.

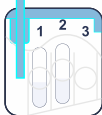

STOP

Do not continue unless probe is secured properly in place.

#### Identification

4

From both sides of the kit, squeeze on the circle of **Chamber 1** until the capsule breaks.

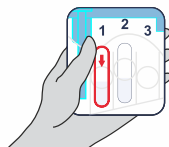

5

Gently shake test unit for 5 seconds.

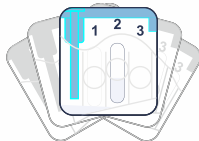

#### Identification

6

From both sides of the kit, squeeze on the circle of **Chamber 2** until the capsule breaks.

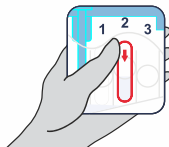

7

Gently shake test unit for 5 seconds.

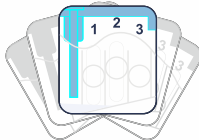

#### Results



The appearance of a red color within a few seconds indicates the presence of **Cannabis (Marijuana/Hashish)**.



If no red color appears within a few seconds, Cannabis (Marijuana/Hashish) is not present.

\* **Also Note:** The appearance of a yellow color that darkens to a reddish color after 1 minute, does not indicate the presence of Marijuana or Hashish.



#### Disposal

The test kit is safe to dispose of in the trash.

01-19