

Data Sheets

# ExcluDoor® 3

# ExcluDoor® 3

## Applications

- MoD
- Banks
- Utility buildings
- Hospitals
- Police stations
- ExcluWall®



## Data Sheets

# ExcluDoor® 3

## Features

- Security rated steel pedestrian doorsets. Strong, lightweight and attack resistant.
- Tested and certified to LPS 1175 Issue 7. Security Classification SR3. Secured by Design accredited.
- Single, equal-leaf double and unequal leaf double doorset configurations. Market leading maximum door leaf sizes.
- Vision panel and louvre vent options.
- Knock-down butt joint or welded frames. Single or double rebate frame profiles.
- Premium quality hardware options including ASSA ABLOY branded products. Non-fire rated.
- External range CE/UKCA marked in accordance with harmonised standard BS EN 14351-1.
- Architectural grade polyester powder coat finishes.

## Sizes

Custom produced doorset sizes to suit as-built or specified structural opening dimensions.

## Door Leaf

45mm thick twin tray construction with internal armoured steel plate reinforcement. Door skins manufactured from 1.5mm thick zinc coated mild steel for enhanced corrosion resistance. Light weight, impact resistant honeycomb core supplied as standard or mineral wool and vertical stiffeners when required. Anti-pry astragal fitted to leading edge for lock bolt protection. Hardware preparations suitably reinforced and prethreaded for required fasteners.

## Door frame

100mm x 45mm single rebate profile supplied as standard. Double rebate profile and increased frame depth sizes available on request. Manufactured from 1.5mm thick zinc coated mild steel. Knock-down butt joint frame assembly method for ease of site installation as standard. Butt welded option available on request. Factory prepared hinge, strike plate and door closer mounting plates.

## Weather Seal & Thresholds

Silicone self-adhesive weather seal to frame and Approved Doc M compliant low profile steel threshold c/w rain deflector and wiper seal supplied as standard. Clear threshold option and alternative steel profile designs available on request.

# ExcluDoor® 3

## Finish

Silicone self-adhesive weather seal to frame and Approved Doc M compliant aluminium low profile threshold c/w integral seal supplied as standard. Clear threshold option and alternative aluminium or steel profile designs available on request.

## Vision Panels

Range of square and rectangular shaped vision panel designs. Glazing units tested and certified in accordance with LPS 1270 for intruder resistance. Alternative door viewer option.

## louvre Vents

Square and rectangular shaped heavy duty louvre vents. Hardened steel louvre blades welded in position to resist attack and deformation. Vermin mesh available on request. 40% free area excluding vermin mesh. Vision panels and louvres may be combined within the same door leaf.

## Fixing Method

Door frames second fixed within structural openings using packing shims and expansion anchors to masonry/concrete openings or machine screws to drilled and tapped holes in steelwork. Frame fixing holes infilled with snap-fit low-profile plastic hole plugs. Frame to wall joints sealed with mastic sealant.

## Security Rating

Tested and certified to Loss Prevention Standard LPS 1175 Issue 8. Security Classification A1 (SR1). Certificate No. 234p.

## Thermal Rating

Thermal transmittance certified in accordance with BS EN ISO 10077-1 by Element Materials Technology. U-value for plain single doorsets: 3.0 W/m<sup>2</sup>.K. U-value for plain double doorsets: 3.1 W/m<sup>2</sup>.K

## Hardware

Comprehensive selection of attack tested and approved, CE/UKCA marked, high security locking systems including ASSA ABLOY Kaye HS100 Series, MICO Abryll and INT (942) ranges, Surelock McGill Sterling, Purbrook and Slimline range locks. Panic escape, emergency escape and access control options. ASSA ABLOY DC300 heavy duty door closers. Minimum of three BS EN 1935 Class 13 stainless steel thrust bearing butt hinges fitted to each door leaf. Sunray barrel bolts to double door passive leaves. All hardware factory fitted as standard.

## Data Sheets

# ExcluDoor® 3

## Finishes

Top coat: Architectural grade polyester powder coat. 30% gloss level. 60-80 microns thickness. Optional marine grade zinc rich primer for enhanced corrosion resistance. 60-80 microns thickness. Stocked range of 58 standard colours. Other colours and finishes available on request.

## Bespoke Design services

Complementing our standard door ranges we also offer a complete, bespoke design service to suit specific client needs or to overcome site/building constraints.

## Sunray Installation Service

We offer a full installation service covering our complete range of steel door and louvre systems. Work is carried out by our own qualified factory-skilled operatives and not sub-contractors.

Procedures are audited and our installation process is approved and certified by CHAS, Safe Contractor, Achilles Building Confidence and Achilles UVDB.

Sunray's Installation Service is certified by the LPCB/BRE to LPS 1271 for security and fire doors.

## Nationwide Delivery Service

Specialist transport service includes curtain sider lorries with Moffett facility, flat bed lorries with HIAB facility and lightweight vans as applicable.

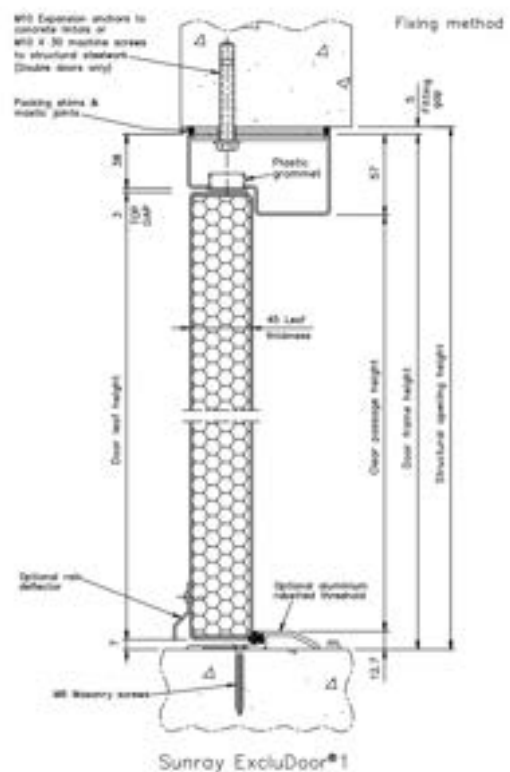
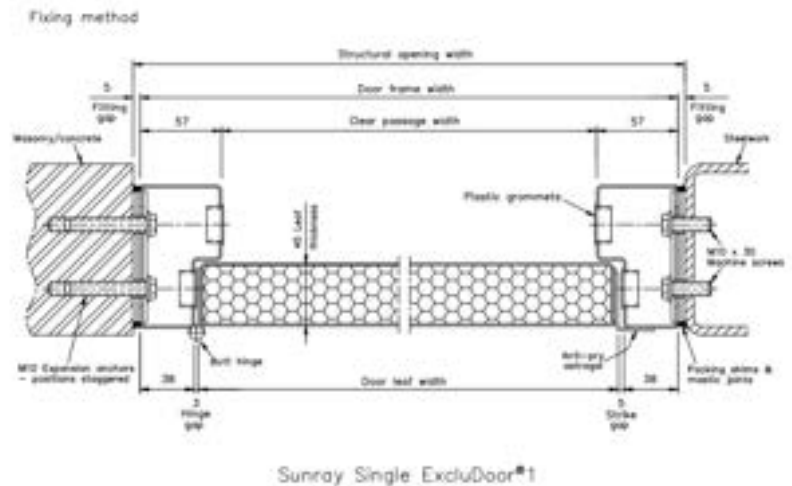

For further information or questions about installation of this product contact our installation team:

**01233 656648**



Access this document on your device

Scan the QR code on the left using a phone or tablet to access the digital version of this document.



## Contact Information:

### **Sunray Doors**

An Assa Abloy Group Company  
Sunray Engineering Ltd  
Kingsnorth Industrial Estate  
Wotton Road, Ashford  
Kent TN23 6LL

+44 (0)1233 639039  
[sales@sunraydoors.co.uk](mailto:sales@sunraydoors.co.uk)  
[www.sunraydoors.co.uk](http://www.sunraydoors.co.uk)