



42^{AR}CHER



It's time for a GREAT LOOP BOAT



3000+NM, Range @ 11.0 Knots



1 or 2 Engines



2 Cabins



2 Heads

Ready for the 'Great Loop' and Beyond

As our entry model cruiser, the Selene 42 Archer builds on the success of its popular predecessor, the Selene 40 Archer. Featuring a Cruisers Stern(TM) to house the steering quadrant and battery banks, this innovative design adds to the vessel's water line to provide better speed and efficiency. With its deep keel and large rudder, the 42 also provides great stability and tracking, especially at low speeds.

Designed as a true coastal cruiser, the Selene 42 Archer provides the same quality and safety of her larger siblings, but in a more compact package. It comes standard with a 230 HP Cummins diesel engine, bow thruster, anchor windlass, full galley, island master berth, separate shower, full guest stateroom with head, and so much more.

Outside, the Selene 42 deck plan is thoughtfully arranged to be both safe and comfortable. The walk-around decks are spacious and the foredeck allows for anchors to be safely deployed and retrieved. Taken altogether, it's no wonder that the Archer has become a popular option for the 'Great Loop' and coastal cruising in the Americas and beyond.

The Selene 42 Archer offers you:

- Choice of single or twin engines from John Deere or Cummins
- Option of 'Wide Body' configuration for increased living/entertaining space
- Robust systems and standard remote monitoring
- Expansive flybridge with optional built in BBQ, sink, and refrigerator
- Spacious lazarette accessible directly from the cockpit
- Choice of wood finishes, premium stone or Corian countertops and optional teak decking
- Integral swim platform
- FRP hardtop for shade and protection from the elements
- High-end appliances and equipment throughout

Upper Deck

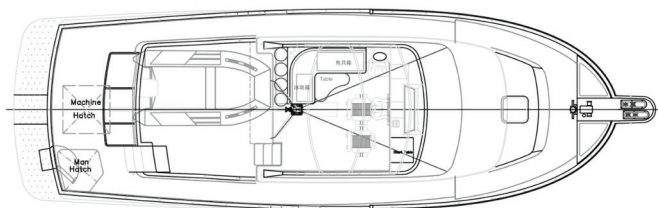

Main Deck

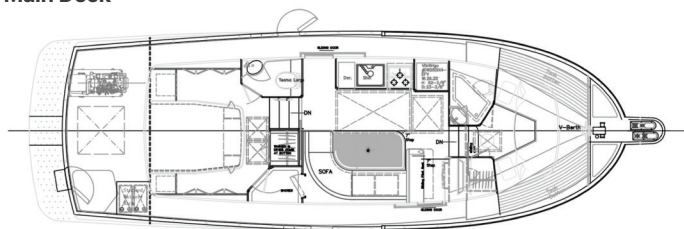

Lower Deck

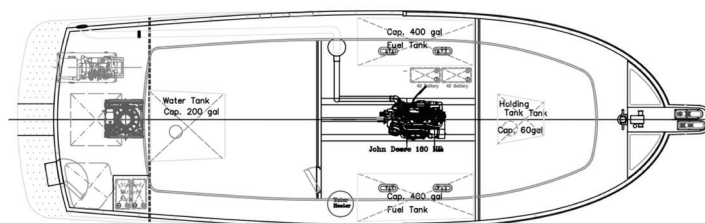

Technical Specs

LOA

45' 2" (13.77m)

LWL

38' 5" (11.71 m)

BEAM

14' 6" (4.42 m)

DRAFT

13' 10" (3.99 m)

DISPLACEMENT

40,000 lbs (18.6 t)

RANGE

3,000+ NM @ 6 kn

POWER

230 hp

FUEL

600 gal (2,271 L)

WATER

180 gal (681L)

INTERIOR

2 Cabins, 2 Heads

AIR DRAFT MAST UP

23' 0" (7.01 m)

AIR DRAFT MAST DOWN

16' 2" (4.92 m)

Specifications, features, and images are for general reference only and may change without notice. Actual yacht details may vary. Contact Selene Yachts Americas for the latest information.

Service & Support

Selene Yachts Americas offers comprehensive support before and after your purchase, including vessel management, servicing, and maintenance through our trusted network of service providers.

Features

- Electrical stabilizers
- Bow & stern thrusters
- Furuno navigation package
- Webasto air-conditioning
- Victron lithium house batteries
- Solar on hardtop
- Fuel polishing system
- Watermaker
- Hydraulic davit



SELENE
YACHTS
AMERICAS

SeleneAmericas.com

info@seleneamericas.com

1 877-689-3979

