



# 78 OCEAN EXPLORER



## LONG RANGE CRUISING *in* COMFORT



3,600+NM, Range @ 8 Knots



2 Engines



6 Cabins



5 Heads

As part of our new Ocean Explorer series, the Selene 78 Ocean Explorer features a more open layout, larger windows and sleeker exterior lines than a comparable Selene Classic Explorer.

Beyond the contemporary look and brighter interior, the 78 Ocean Explorer maintains the performance and safety trademarks of every Selene. This includes a powerful raised pilothouse, a Portuguese bridge, and a seaworthy 'Deep Hull' designed for long-range yachting.

Like the Selene 72, the Selene 78 features standard twin engines, four luxury staterooms, a walk-in closet, and a standard bar on the flybridge. However, with the added length comes significantly more space for operating, living, and entertaining. With its perfect balance of spaciousness and long-range performance, the Selene 78 is a fantastic choice for owners who plan to do extensive passage-making or live aboard their yachts.

Like with all Selene yachts, the Selene 78 Ocean Explorer can be customized to your needs and lifestyle. In addition to a choice of propulsion system and interior finishings, there are three deck configurations to choose from; Full Wide Body, Port-Side Wide Body, and Standard Two Side Decks.

Put simply, by combining contemporary luxury, traditional craftsmanship and advanced engineering, the Selene 78 Ocean Explorer creates a new benchmark for trawler yachts.

### The Selene 78 Ocean Explorer offers you:

- Standard twin engines from John Deere or Cummins
- Option of three different deck configurations
- Bright contemporary interior with choice of finishes
- Larger windows throughout boat
- Robust systems and standard remote monitoring
- Expansive flybridge with settee that seats 10
- Spacious lazarette accessible directly from swim step
- FRP hardtop for shade and protection from the elements
- High-end appliances and equipment throughout

Upper Deck

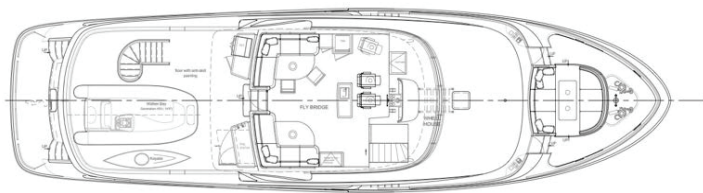

Main Deck Galley Down

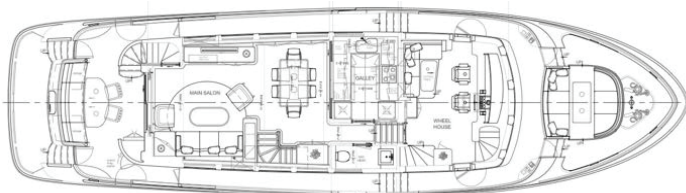

Lower Deck

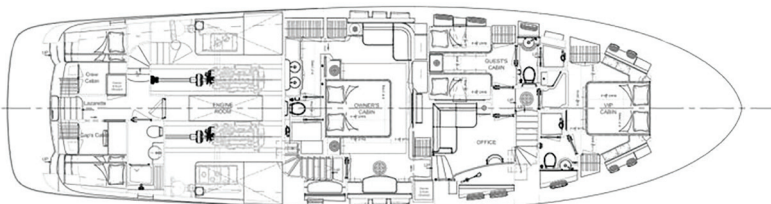

## Technical Specs

### LOA

78' 6" (23.93 m)

### LWL

70' 11" (21.62 m)

### BEAM

21' 9" (6.63 m)

### DRAFT

6' 4" (1.93 m)

### DISPLACEMENT

238,099 lbs (108 t)

### RANGE

3,600+ NM @ 8 kn

### POWER

405 hp (Twin)

### FUEL

4,200 gal (15,900 L)

### WATER

600 gal (2,270 L)

### INTERIOR

6 Cabins, 5 Heads

### AIR DRAFT MAST UP

31' 0" (9.5m)

### AIR DRAFT MAST DOWN

23' 0" (7 m)

Specifications, features, and images are for general reference only and may change without notice. Actual yacht details may vary. Contact Selene Yachts Americas for the latest information.

## Service & Support

Selene Yachts Americas provide comprehensive before and after sales service and support on Selene Yachts. This includes vessel management, servicing, and maintenance.

## Features

- Bulbous bow
- Electric stabilizers at anchor
- Electric bow & stern thrusters
- Hydraulic davit
- Chilled water air-conditioning
- Watermaker
- Furuno navigation package
- Maretron vessel monitoring
- Victron lithium house batteries
- Solar on hardtop
- Fuel polishing system
- Opt. hydraulic swim platform



SELENE  
YACHTS  
AMERICAS

SeleneAmericas.com

info@seleneamericas.com

1 877-689-3979

