

# 62 CLASSIC EXPLORER

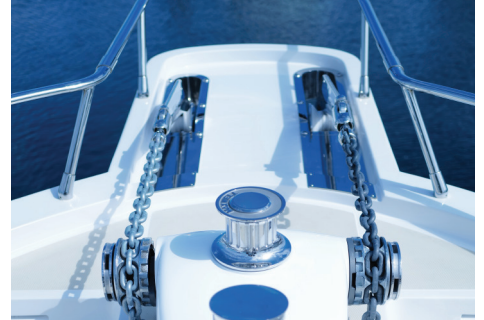

## *Exceptional* COMFORT, STYLE *and* SEAWORTHINESS



3000+NM, Range @ 8.0 Knots

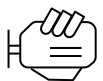

1 or 2 Engines



4 Cabins



3 Heads

As part of our Classic Explorer series, the Selene 62 Classic Explorer combines timeless trawler yacht styling with next-generation performance.

Featuring the exceptional safety, comfort, and reliability that every Selene is known for, the Selene 62 provides significantly more space than a Selene 60 Classic Explorer thanks to its wider beam. Standard twin engines provide greater power, enhanced redundancy, and added confidence for long-range cruising.

Along with the option of a generous crew quarters, the Selene 62 provides owners and their guests an all-around more spacious yachting experience. Likewise, the larger Deep Hull structure provides more stability on extended voyages. These traits have made the Selene 62 Classic Explorer an ideal vessel for those who want to live aboard their vessels.

Like with all Selene yachts, the Selene 62 is built to your needs and lifestyle. From galley configuration and number of engines to custom bathtubs, we go to great lengths to make sure you get the Selene you desire.

Put simply, by combining luxurious accommodations, advanced engineering, and exceptional craftsmanship, the Selene 62 Classic Explorer stands as a true pinnacle of passage-making.

### **The Selene 62 Classic Explorer offers you:**

- Standard twin engines from John Deere or Cummins
- Option of 'Wide Body' configuration for increased living/entertaining space
- Robust systems and standard remote monitoring
- Expansive flybridge with large settee, built in BBQ, sink, and optional refrigerator
- Flexible placement of galley ('galley up' in pilothouse or 'galley down' in salon)
- Spacious lazarette accessible directly from swim platform
- Choice of premium stone countertops and wood finishes for interior styling
- FRP hardtop for shade and protection from the elements
- High-end appliances and equipment throughout

**Upper Deck**

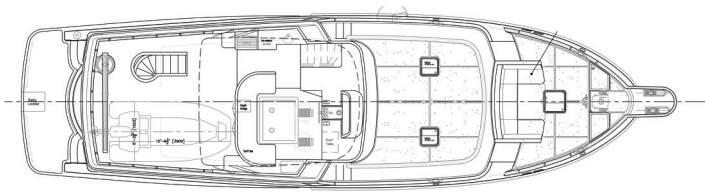

**Main Deck, Galley Up**

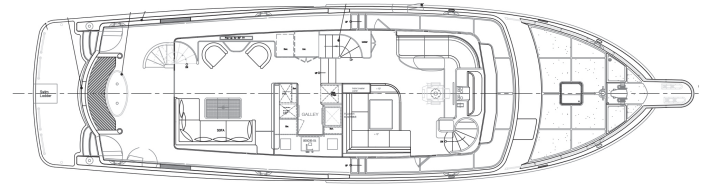

**Lower Deck**

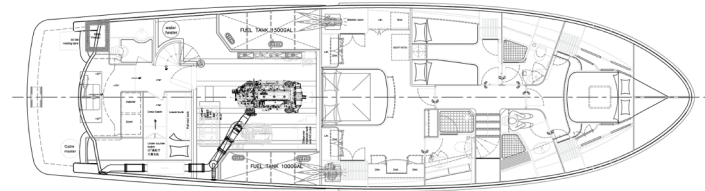

**Wide Body, Galley Down**

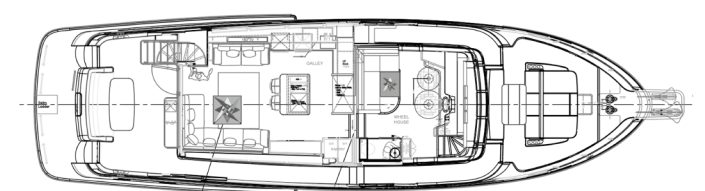

## Technical Specs

**LOA**

68' 10" (21.0 m)

**LWL**

60' 0" (18.3 m)

**BEAM**

18' 8" (5.7 m)

**DRAFT**

6' 6" (2.0 m)

**DISPLACEMENT**

142,860 lbs (64.8 t)

**RANGE**

3,000+ NM @ 8 kn

**POWER**

530 hp (Twin)

**FUEL**

2,200 gal (8,327 L)

**WATER**

530 gal (2,006 L)

**INTERIOR**

4 Cabins, 3 Heads

**AIR DRAFT MAST UP**

26' 8" (8.2 m)

**AIR DRAFT MAST DOWN**

20' 0" (6.1 m)

Specifications, features, and images are for general reference only and may change without notice. Actual yacht details may vary. Contact Selene Yachts Americas for the latest information.

## Service & Support

Selene Yachts Americas offers comprehensive support before and after your purchase, including vessel management, servicing, and maintenance through our trusted network of service providers.

## Features

- Bulbous bow
- Electric stabilizers at anchor
- Electric bow & stern thrusters
- Hydraulic davit
- Chilled water air-conditioning
- Watermaker
- Furuno navigation package
- Maretron vessel monitoring
- Victron lithium house batteries
- Solar on hardtop
- Fuel polishing system
- Opt. hydraulic swim platform



SELENE  
YACHTS  
AMERICAS

SeleneAmericas.com

info@seleneamericas.com

1 877-689-3979

