

72 OCEAN EXPLORER



A new BENCHMARK for TRAWLER YACHTS



3600+NM, Range @ 8 kn



2 Engines



4 Cabins + Crew & Captain Cabins



4 Heads

As part of our new Ocean Explorer series, the Selene 72 Ocean Explorer features a more open layout, larger windows and sleeker exterior lines than a comparable Selene Classic Explorer.

Beyond the contemporary look and brighter interior, the Ocean Explorer maintains the performance and safety trademarks of every Selene. This includes a powerful raised pilothouse, a Portuguese bridge, and a seaworthy 'Deep Hull' designed for long-range yachting.

Featuring standard twin engines, four luxury staterooms, and a standard bar on the flybridge, the Selene 72 Ocean Explorer perfectly balances spaciousness and long-range performance. With a much larger hull than the Selene 64, the 72 provides owners with a smoother ride, as well as an extra state room with walk-in closets. These features make the Selene 72 ideal for owners who plan to live aboard or do extensive passage-making.

Like all Selene yachts, the Selene 72 Ocean Explorer can be customized to your needs and lifestyle. In addition to a choice of propulsion system and interior finishings, there are multiple deck configurations including wide body and galley configuration.

Put simply, by combining contemporary luxury, traditional craftsmanship and advanced engineering, the Selene 72 Ocean Explorer creates a new benchmark for trawler yachts.

The Selene 72 Ocean Explorer offers you:

- Standard twin engines from John Deere or Cummins
- Option of multiple different deck configurations
- Bright contemporary interior with choice of finishes
- Larger windows throughout the boat
- Robust systems and standard remote monitoring
- Expansive flybridge with large settee and bar with bar stools
- Spacious lazarette accessible directly from swim step
- FRP hardtop for shade and protection from the elements
- High-end appliances and equipment throughout

Upper Deck

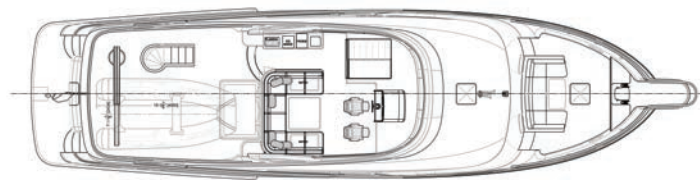

Main Deck, Galley Up

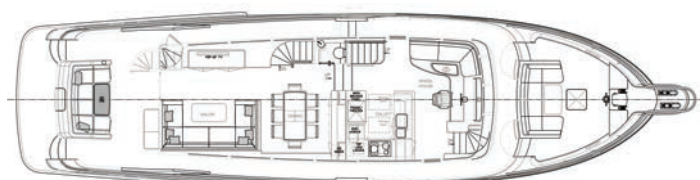

Lower Deck

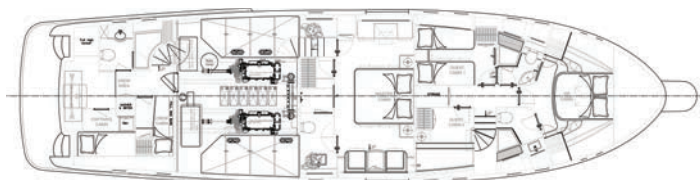

Main Deck, Galley Down

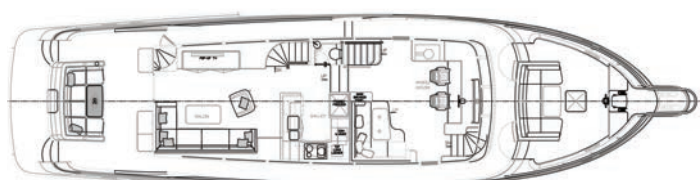

Technical Specs

LOA

75' 10" (23.11 m)

LWL

66' 4" (20.21 m)

BEAM

19' 5" (5.92 m)

DRAFT

6' 3" (1.90 m)

DISPLACEMENT

158,688 lbs (72 t)

AIR DRAFT MAST DOWN

20' 11" (6.38 m)

POWER

810 hp (Twin)

FUEL

2,800 gal (10,600 L)

WATER

600 gal (2,271 L)

INTERIOR

4 Cabins + crew & captain, 4 Heads

RANGE

3,600+ NM @ 8 kn

AIR DRAFT MAST UP

26' 3" (8.0 m)

Specifications, features, and images are for general reference only and may change without notice. Actual yacht details may vary. Contact Selene Yachts Americas for the latest information.

Service & Support

Selene Yachts Americas provides comprehensive support before and after your purchase, including vessel management, servicing, and maintenance through our trusted network of service providers.

Features

- Bulbous bow
- Electric stabilizers at anchor
- Electric bow & stern thrusters
- Hydraulic davit
- Chilled water air-conditioning
- Watermaker
- Furuno navigation package
- Maretron vessel monitoring
- Victron lithium house batteries
- Solar panels on hardtop
- Fuel polishing system
- Opt. hydraulic swim platform



SELENE
YACHTS
AMERICAS

SeleneAmericas.com

info@seleneamericas.com

1 877-689-3979

