



60⁰ OCEAN EXPLORER



New LOOK, Proven PERFORMANCE



3000+ NM, Range @ 7.5 kn

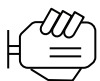

1 or 2 Engines



3 Cabins



2 or 3 Heads

As part of our new Ocean Explorer series, the Selene 60 Ocean Explorer features a more open layout, larger windows and sleeker exterior lines than a comparable Selene Classic Explorer. However, beyond the contemporary look and interior atmosphere, the Ocean Explorer maintains the performance and safety trademarks of every Selene. This includes a powerful raised pilothouse, a Portuguese bridge, and a seaworthy Deep Hull designed for long-range yachting.

Featuring three luxury staterooms and a choice of two or three heads, the Selene 60 Ocean Explorer perfectly balances the spaciousness and long-range performance of larger yachts with the ease of operation of smaller vessels. In fact, most owners are able to easily pilot their Selene 60s without additional help.

Like all Selene yachts, the Selene 60 Ocean Explorer can be customized to your needs and lifestyle. In addition to a choice of propulsion system and interior finishings, there are three deck configurations to choose from; Full Wide Body, Port-Side Wide Body, and Standard Two Side Decks.

Put simply, by combining contemporary luxury, traditional craftsmanship and advanced engineering, the Selene Ocean Explorer 60 creates a new benchmark for passage-making trawler yachts.

The Selene 60 Ocean Explorer offers you:

- Choice of single or twin engines from John Deere or Cummins
- Single hydraulic 'get-home' or wing engine
- Option of three different deck configurations
- Bright contemporary interior with choice of finishes
- Larger windows throughout
- Robust systems and standard remote monitoring
- Expansive flybridge with control station and large u-shaped settee
- Spacious lazarette accessible directly from swim step
- FRP hardtop for shade and protection from the elements
- High-end appliances and equipment throughout

Upper Deck

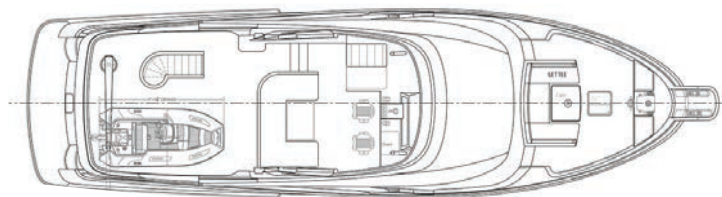

Main Deck, Galley Down

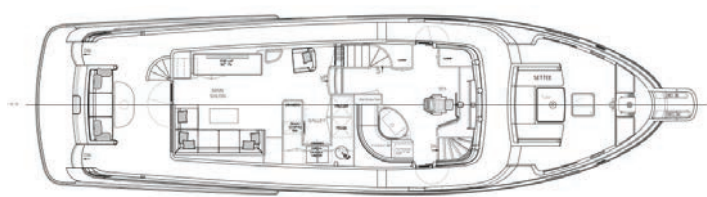

Lower Deck

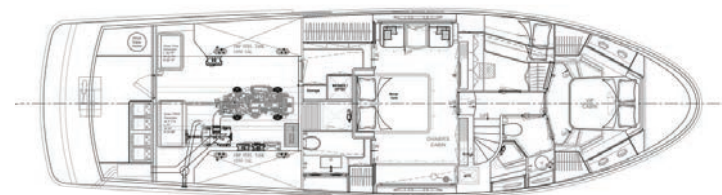

Main Deck, Wide Body Option

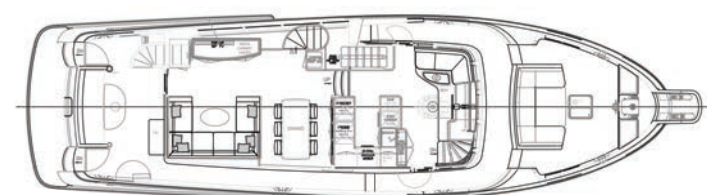

Technical Specs

LOA

65' 8.5" (20.0 m)

POWER

425 hp

LWL

56' 3" (17.2 m)

FUEL

2,000 gal (7,570 L)

BEAM

17' 10" (5.4 m)

WATER

500 gal (1,892 L)

DRAFT

6' 4" (1.9 m)

INTERIOR

3 Cabins, 2 or 3 Heads

DISPLACEMENT

126,760 lbs (57.5 t)

RANGE

3,000+ NM @ 7.5 kn

AIR DRAFT MAST DOWN

20' 2" (6.2 m)

AIR DRAFT MAST UP

27' 0" (8.2 m)

Specifications, features, and images are for general reference only and may change without notice. Actual yacht details may vary. Contact Selene Yachts Americas for the latest information.

Service & Support

Selene Yachts Americas provides comprehensive support before and after your purchase, including vessel management, servicing, and maintenance through our trusted network of service providers.

Features

- Bulbous bow
- Electric stabilizers at anchor
- Electric bow & stern thrusters
- Hydraulic davit
- Chilled water air-conditioning
- Watermaker
- Furuno navigation package
- Maretron vessel monitoring
- Victron lithium house batteries
- Solar panels on hardtop
- Fuel polishing system
- Opt. hydraulic swim platform



SELENE
YACHTS
AMERICAS

SeleneAmericas.com

info@seleneamericas.com

1 877-689-3979

