

64 OCEAN EXPLORER

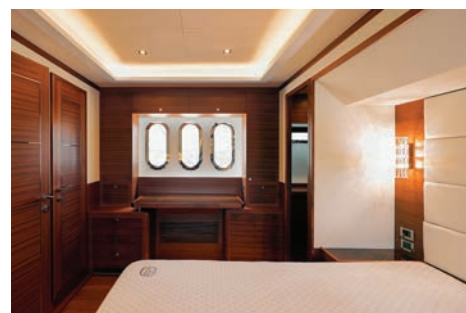

NEXT-GENERATION PASSAGEMAKER



3000+ NM, Range @ 8 kn



2 Engines



3 Cabins + Crew



3 or 4 Heads

As part of our new Ocean Explorer series, the Selene 64 Ocean Explorer features a more open layout, larger windows and sleeker exterior lines than a comparable Selene Classic Explorer.

Beyond the contemporary look and brighter interior, the Ocean Explorer maintains the performance and safety trademarks of every Selene. This includes a powerful raised pilothouse, a Portuguese bridge, and a seaworthy 'Deep Hull' designed for long-range yachting.

Featuring standard twin engines, three luxury staterooms and three heads, optional crew quarters with an additional head, the Selene 64 Ocean Explorer perfectly balances spaciousness and long-range performance. With a wider and longer hull than the Selene 60 Ocean Explorer, the 64 not only gives owners an optional crew quarters, it provides more room for the owners with a full walk-in closet for the owner's cabin and more space throughout the boat.

Like all Selene yachts, the Selene 64 Ocean Explorer can be customized to your needs and lifestyle. In addition to a choice of propulsion system and interior finishes, there are multiple deck configurations to choose from including; wide body, two side decks, and galley up or down.

Put simply, by combining contemporary luxury, traditional craftsmanship and advanced engineering, the Selene 64 Ocean Explorer creates a new benchmark for passage-making trawler yachts.

The Selene 64 Ocean Explorer offers you:

- Standard twin engines from John Deere or Cummins
- Option of three different deck configurations
- Bright contemporary interior with choice of finishes
- Larger windows throughout the boat
- Robust systems and standard remote monitoring
- Expansive flybridge with settee that seats 10
- Spacious lazarette accessible directly from the swim step
- FRP hardtop for shade and protection from the elements
- High-end appliances and equipment throughout

Upper Deck

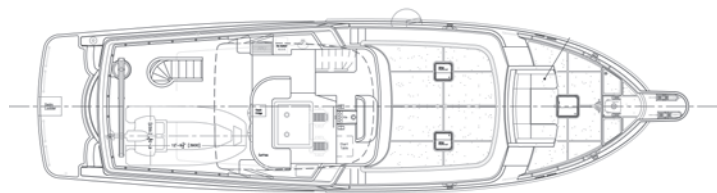

Main Deck, Galley Up

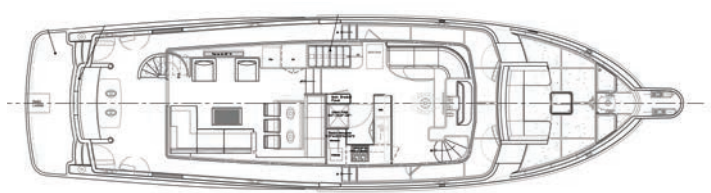

Lower Deck

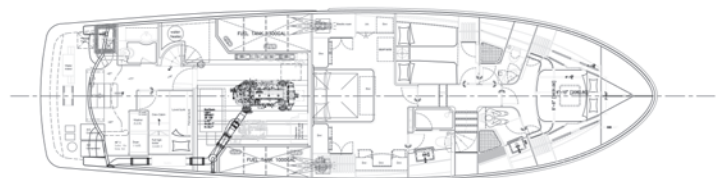

Main Deck, Wide Body

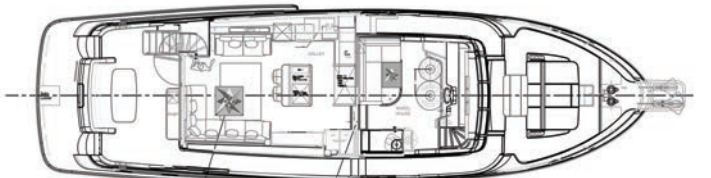

Technical Specs

LOA

65' 10" (20.98 m)

LWL

60' 0" (18.28 m)

BEAM

18' 8" (5.69 m)

DRAFT

6' 6" (1.98 m)

DISPLACEMENT

158,733 lbs (72 t)

RANGE

3,000+ NM @ 8 kn

POWER

530 hp (Twin)

FUEL

2,400 gal (9,000 L)

WATER

600 gal (2,270 L)

INTERIOR

3 Cabins + Crew, 3 or 4 Heads

AIR DRAFT MAST UP

26' 8" (8.2 m)

AIR DRAFT MAST DOWN

20' 0" (6.1 m)

Specifications, features, and images are for general reference only and may change without notice. Actual yacht details may vary. Contact Selene Yachts Americas for the latest information.

Service & Support

Selene Yachts Americas provides comprehensive support before and after your purchase, including vessel management, servicing, and maintenance through our trusted network of service providers.

Features

- Bulbous bow
- Electric stabilizers at anchor
- Electric bow & stern thrusters
- Hydraulic davit
- Chilled water air-conditioning
- Watermaker
- Furuno navigation package
- Maretron vessel monitoring
- Victron lithium house batteries
- Solar panels on hardtop
- Fuel polishing system
- Opt. hydraulic swim platform



SELENE
YACHTS
AMERICAS

SeleneAmericas.com

info@seleneamericas.com

1 877-689-3979

