

# 46 CLASSIC EXPLORER



## CLASSIC STYLE *for the* MODERN EXPLORER



3000+ NM, Range @ 6 kn



1 or 2 Engines



2 Cabins



2 Heads

As part of our Classic Explorer series, the Selene 46 Classic Explorer combines timeless trawler yacht styling with next-generation performance.

Featuring the exceptional safety, comfort, and reliability that every Selene is known for, the Selene 46 is just as at home on coastal waterways as it is on the open sea. Easy to handle and appointed with all the comforts of home, this is an ideal vessel for undertaking the legendary North American 'Great Loop.'

The Selene 46 features a surprising amount of living and storage space for a vessel of 46 feet. With two staterooms and two heads, this is also a wonderful yacht for hosting friends and family.

Like all Selene yachts, the Selene 46 is built to your needs and lifestyle. From galley configuration and number of engines to customizable wood and stone countertop finishes, we go to great lengths to ensure you get the Selene that suits your vision.

Put simply, by combining luxurious accommodations, advanced engineering, and exceptional craftsmanship, the Selene 46 Classic Explorer is a 'classic' passage-making yacht in every sense of the word.

### The Selene 46 Classic Explorer offers you:

- Choice of single or twin engines from John Deere or Cummins
- Option of 'Wide Body' configuration for increased living/entertaining space
- Robust systems and standard remote monitoring
- Expansive flybridge with optional built-in BBQ, sink, and refrigerator
- Spacious lazarette accessible directly from the cockpit
- Choice of wood finishes, premium stone or Corian countertops and optional teak decking
- Integral swim platform
- FRP hardtop for shade and protection from the elements
- High-end appliances and equipment throughout

Upper Deck

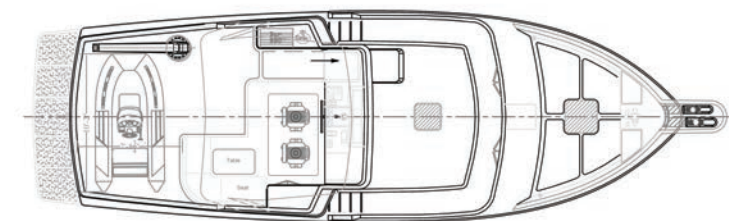

Main Deck

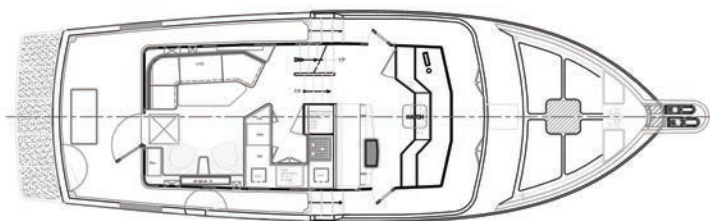

Lower Deck

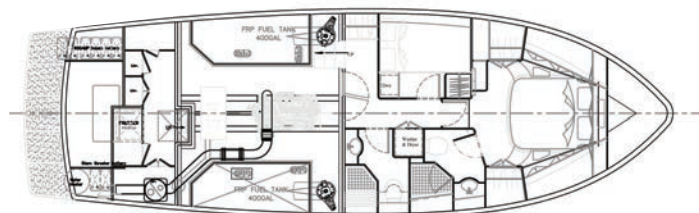

## Technical Specs

### LOA

50' 9" (15.5 m)

### LWL

43' 1" (13.1 m)

### BEAM

15' 8" (4.8 m)

### DRAFT

5' 6" (1.7 m)

### DISPLACEMENT

62,832 lbs (28.5 t)

### RANGE

3,000+ NM @ 6 kn

### POWER

230 hp

### FUEL

800 gal (3,028 L)

### WATER

210 gal (807 L)

### INTERIOR

2 Cabins, 2 Heads

### AIR DRAFT MAST UP

23' 0" (7.01 m)

### AIR DRAFT MAST DOWN

16' 2" (4.92 m)

Specifications, features, and images are for general reference only and may change without notice. Actual yacht details may vary. Contact Selene Yachts Americas for the latest information.

## Service & Support

Selene Yachts Americas provides comprehensive support before and after your purchase, including vessel management, servicing, and maintenance through our trusted network of service providers.

## Features

- Electrical stabilizers
- Bow & stern thrusters
- Furuno navigation package
- Webasto air-conditioning
- Victron lithium house batteries
- Solar panels on hardtop
- Fuel polishing system
- Watermaker
- Hydraulic davit



SELENE  
YACHTS  
AMERICAS

SeleneAmericas.com

info@seleneamericas.com

1 877-689-3979

