

# 49 CLASSIC EXPLORER



## *The GREAT LOOP and BEYOND*



3000+ NM, Range @ 7 kn



1 or 2 Engines



2 or 3 Cabins



2 Heads

As part of our Classic Explorer series, the Selene 49 Classic Explorer combines timeless trawler yacht styling with next-generation performance.

Featuring the exceptional safety, comfort, and reliability that every Selene is known for, the Selene 49 is just as at home along the coast as it is on the open sea. Noticeably more spacious than the Selene 46, the 'Classic' 49 remains easy for an owner to handle on their own. And as with both the 46 and 54, this vessel is ideal for undertaking the legendary North American 'Great Loop.'

With luxurious built-in comfort and an option of a third stateroom, the Selene 49 is a popular yacht for both entertaining and living aboard.

Like all Selene yachts, the Selene 49 is built to your needs and lifestyle. From galley configuration and number of engines to customizable wood finishes, we go to great lengths to make sure you get the Selene you desire.

Put simply, by combining luxurious accommodations, advanced engineering, and exceptional craftsmanship, the Selene 49 Classic Explorer is a 'classic' passage-making yacht in every sense of the word.

### **The Selene 49 Classic Explorer offers you:**

- Choice of single or twin engines from John Deere or Cummins
- Option of 'Wide Body' configuration for increased living/entertaining space
- Robust systems and standard remote monitoring
- Full beam flybridge with control station, tender deck, settee with table, optional built-in BBQ, sink, and refrigerator
- Spacious lazarette accessible directly from the cockpit
- Choice of premium stone or Corian countertops and wood finishes for interior styling
- Swim platform
- FRP hardtop for shade and protection from the elements
- High-end appliances and equipment throughout

### Upper Deck

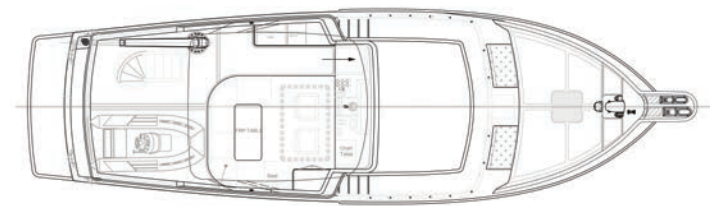

### Main Deck

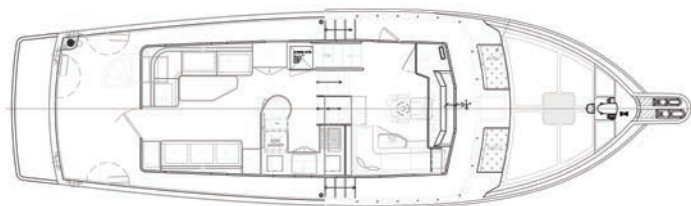

### Lower Deck

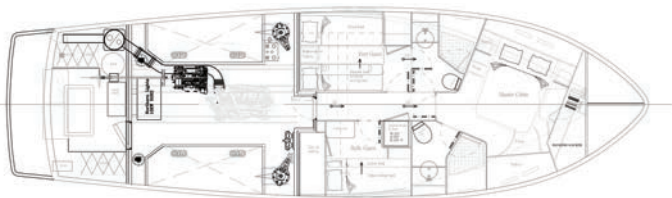

## Technical Specs

#### LOA

53' 11" (16.4 m)

#### LWL

46' 10" (14.3 m)

#### BEAM

15' 8" (4.8 m)

#### DRAFT

5' 11" (1.8 m)

#### DISPLACEMENT

68,800 lbs (31.2 t)

#### RANGE

3,000+ NM @ 7 kn

#### POWER

230 hp

#### FUEL

1,200 gal (4,542 L)

#### WATER

210 gal (807 L)

#### INTERIOR

2 or 3 Cabins, 2 Heads

#### AIR DRAFT MAST UP

23' 8" (7.2 m)

#### AIR DRAFT MAST DOWN

14' 2" (4.3 m)

Specifications, features, and images are for general reference only and may change without notice. Actual yacht details may vary. Contact Selene Yachts Americas for the latest information.

## Service & Support

Selene Yachts Americas provides comprehensive support before and after your purchase, including vessel management, servicing, and maintenance through our trusted network of service providers.

## Features

- Electric stabilizers at anchor
- Electric bow & stern thrusters
- Hydraulic davit
- Chilled water air-conditioning
- Furuno navigation package
- Maretron vessel monitoring
- Victron lithium house batteries
- Solar panels on hardtop
- Fuel polishing system
- Integral swim platform



SELENE  
YACHTS  
AMERICAS

SeleneAmericas.com

info@seleneamericas.com

1 877-689-3979

