

52 OCEAN EXPLORER



A NEW ERA OF PASSAGEMAKING



3000+ NM



1 Engine



2 Cabins



2 Heads

Inspired by feedback from the Selene owner community and blue water adventurers like the YouTube duo *The 71 Percent*, the new Selene 52 Ocean Explorer is the perfect marriage of capability and style.

As part of the Ocean Explorer series, this 52-foot vessel features a more open layout, larger windows and sleeker exterior lines than a comparable Selene Classic Explorer. However, beyond the contemporary look, the Ocean Explorer maintains the performance and safety trademarks of every Selene. This includes a powerful raised pilothouse, a Portuguese bridge, and a seaworthy Category A Deep Hull designed for long-range yachting.

Influenced by real-world cruising experiences and recent technological advancements, the Selene 52 Ocean Explorer comes standard with Selene America's most popular options, including lithium batteries, solar panels, power by Victron, Furuno electronics, CMC stabilizers, and a single powerful John Deere 6068 engine backed up by a get-home drive.

Built around a comfortable salon and galley-down configuration, the 52 features a pair of luxury staterooms, two heads, and a surprising amount of outdoor space. Whether you want to cross oceans, cruise the coast, or live aboard in modern luxury, the Selene Ocean Explorer 52 means passage-making *without compromise*.

The Selene 52 Classic Explorer offers you:

- John Deere 6068 single engine
- Hydraulic 'get-home' drive
- Premium finishes and choice of fabrics and countertops
- Bright contemporary interior
- Larger windows throughout
- Robust systems and standard remote monitoring
- Expansive flybridge with control station and large u-shaped settee
- FRP hardtop for shade and protection from the elements
- High-end appliances and equipment throughout

Upper Deck

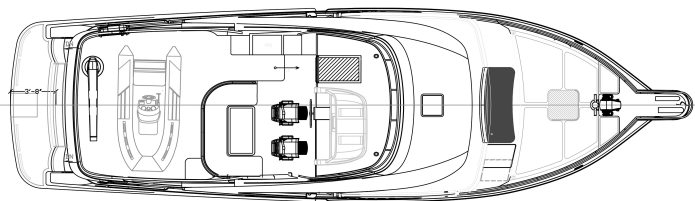

Main Deck, Wide Body

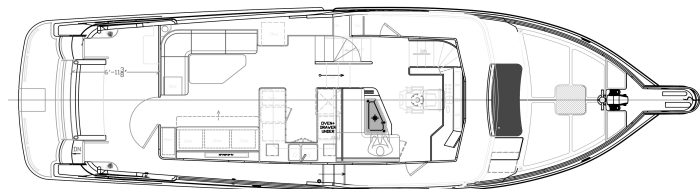

Lower Deck

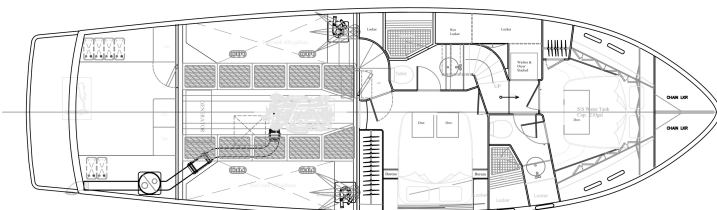

Technical Specs

LOA
54' 8" (16.66 m)

LWL
47' 9" (14.55 m)

BEAM
15' 6" (4.78 m)

DRAFT
5' 8" (1.72 m)

DISPLACEMENT
68,800 lbs (31.2 t)

RANGE
3,000+ NM

POWER
230 hp

FUEL
1,400 gal (5,299 L)

WATER
210 gal (795 L)

INTERIOR
2 Cabins, 2 Heads

AIR DRAFT MAST UP
23' 8" (7.2 m)

AIR DRAFT MAST DOWN
14' 2" (4.3 m)

Specifications, features, and images are for general reference only and may change without notice. Actual yacht details may vary. Contact Selene Yachts Americas for the latest information.

Features

- Electric stabilizers at anchor
- Electric bow & stern thrusters
- Hydraulic davit
- Chilled water air-conditioning
- Watermaker
- Furuno navigation package
- Vessel monitoring
- Lithium house batteries
- Solar panels on hardtop
- Fuel polishing system



Service & Support

Selene Yachts Americas provides comprehensive support before and after your purchase, including vessel management, servicing, and maintenance through our trusted network of service providers.



SELENE
YACHTS
AMERICAS

SeleneAmericas.com
info@seleneamericas.com
1 877-689-3979

