

# How to connect your diagnostic-kit with Epsilon batteries

EPSILON Standard kit - Also for Victron protocol configuration  
(with software 1.6.0 install)

1

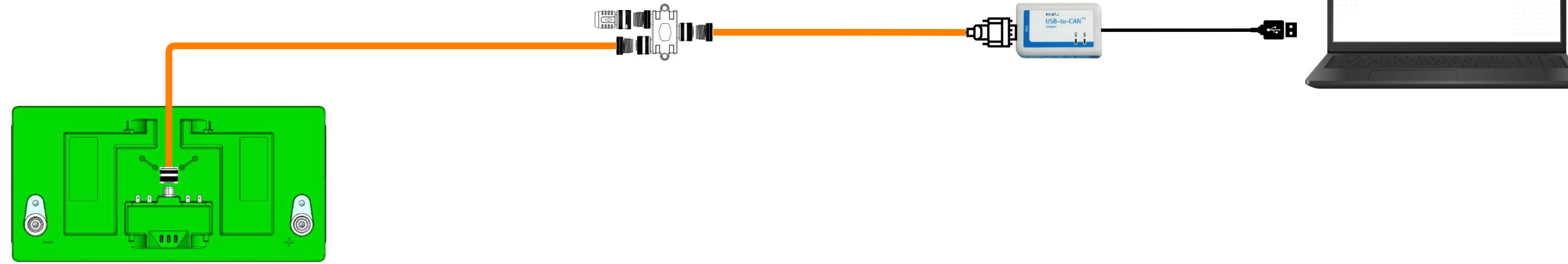

EPSILON inline termination cable kit

2

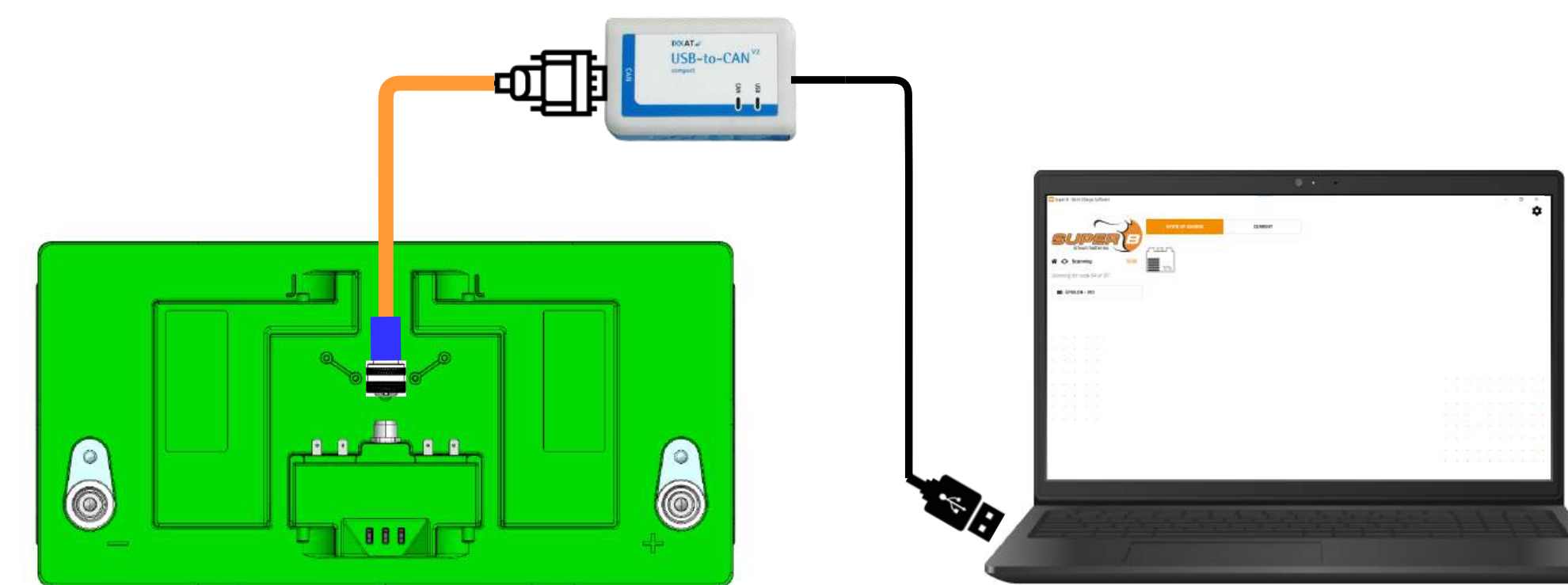

EPSILONS with Y-CAN cable and inline termination cable kit

3

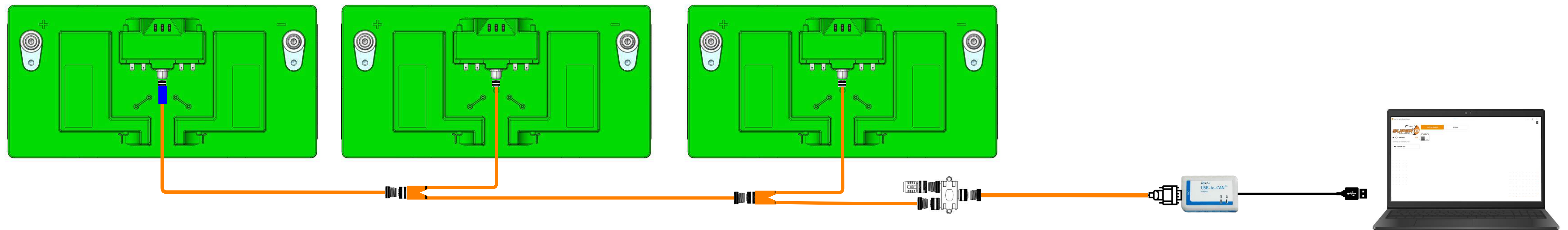

EPSILONS Standard kit

4

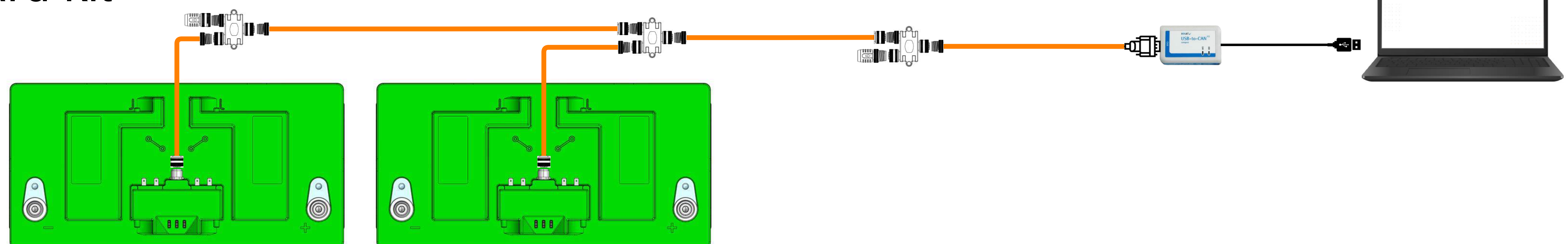

EPSILONS With BCI Standard kit - same for Victron integrated systems

5

